

WC45 - Greasing Glass Sunroof Seal (Workshop Campaign)

Vehicle Type: **911 Carrera (991)/911 Carrera S (991)**

Model Year: **As of 2012 up to 2013**

Equipment: Electric slide/tilt roof, glass (I-no. 653)

Concerns: **Seal for glass sunroof**

Information: This is to inform you of a voluntary Workshop Campaign on the above-mentioned vehicles. There is the possibility that noises can come from the glass sunroof on the affected vehicles while driving when the glass sunroof is closed. To prevent this from happening, the seal on the glass sunroof must be greased with sliding compound.

Action Required: Grease seal for glass sunroof.

Affected Vehicles: The VIN(s) can be checked by using PIWIS Vehicle Information link to verify if the campaign affects the vehicle. This Campaign is scope specific to the VIN! Failure to verify in PIWIS may result in an improper repair. This campaign affects 72 vehicles in the U.S. and Canada.

Materials: **NOTE: PLEASE FILE A PTEC FOR RELEASE OF REQUIRED PART. THERE WILL BE NO AUTOMATIC ALLOCATION OF PARTS FOR THIS CAMPAIGN.**

- | | | |
|----------------|--|--|
| 999.917.557.00 | ⇒ Grease
Special sliding compound Osixo Anti Squeak 557 | 50 ml container
(approx. 5 ml required per vehicle) |
| ... | Disposable gloves (commercially available) | 1 ea.* |

* The WWS Warranty system will automatically add into the "Miscellaneous item" section (sublet) of the claim after the claim has been submitted.

Work Procedure: See Attachment "A".

Claim Submission: See Attachment "B"

Attachment "A": **Work Procedure**

- 1 Open the glass sunroof.
 - 1.1 Switch on ignition.
 - 1.2 Open the glass sunroof completely by pressing the button in the center console.
 - 1.3 Switch off ignition.

- 2 Grease seal for glass sunroof.
 - 2.1 Place a suitable protective cover (e.g. paper towels) underneath the glass sunroof in the roof aperture area as shown in ⇒ *Figure 1* to prevent sliding compound from getting onto interior parts during application.
 - 2.2 Put on disposable gloves.

 - 2.3 Apply sliding compound **Osixo Anti Squeak** ⇒ *Figure 2 -2-*, Part No. **999.917.557.00**, to the tips of your fingers and coat the sealing surface (underside) of the seal for the glass sunroof cover ⇒ *Figure 2 -1-* with sliding compound all the way around ⇒ *Figure 2 -inset-*.
 - 2.4 Remove protective cover and remove any visible residual sliding compound from adjacent components.

- 3 Close the glass sunroof.
 - 3.1 Switch on ignition.
 - 3.2 Close the glass sunroof completely by pressing the button in the center console.
 - 3.3 Switch off ignition.

- 4 Enter the workshop campaign in the Warranty and Maintenance booklet.



Figure 1

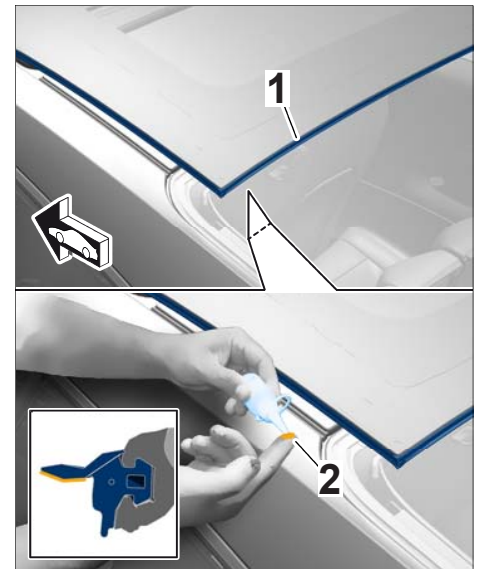

Figure 2

Attachment "B": **Claim Submission** - Workshop Campaign WC45
 Warranty claims should be submitted via WWS/PQIS. Open campaigns may be checked by using either the PIWIS Vehicle Information system or through PQIS Job Creation.

Labor, parts, and sublet will be automatically inserted when Technician is selected in WWS/PQIS. If necessary, the required part numbers will need to be manually entered into warranty system by the dealer administrator.

Working time:

Greasing seal for glass sunroof

Labor time: **13 TU**

Parts required:

999.917.557.00 Grease

0.01 ea.
(= 5 ml)

WC450000001 Disposable gloves

1 ea.*
(for warranty invoicing only)

* The WWS Warranty system will automatically add into the "Miscellaneous item" section (sublet) of the claim after the claim has been submitted.

⇒ **Damage code WC45 066 000 1**

Important Notice: Porsche Cars N.A Technical Bulletins are intended for use by professional technicians, not a "Do-it-yourselfer." They are written to inform these technicians of conditions that may occur on some vehicles, or to provide information that could assist in the proper service of a vehicle. Special tools may be required to perform certain operations identified in these bulletins. Use of tools and procedures other than those recommended in these bulletins may be detrimental to the safe operation of your vehicle. Properly trained technicians have the equipment, tools, safety instructions and know-how to do a job properly and safely. If a condition is described, do not assume that the bulletin applies to your vehicle, or that your vehicle will have that condition. See your Porsche Dealer for information on whether your vehicle may benefit from the information. Part numbers listed in these bulletins are for reference only. Always check with your authorized Porsche dealer to verify correct part numbers.

© Porsche Cars North America, Inc.

Dealership	Service Manager	Shop Foreman	Service Technician				
Distribution	Asst. Manager	Warranty Admin.	Service Technician				
Routing							

Dr. Ing. h.c. F. Porsche AG is the owner of numerous trademarks, both registered and unregistered, including without limitation the Porsche Crest®, Porsche®, Boxster®, Carrera®, Cayenne®, Cayman™, Panamera®, Tiptronic®, VarioCam®, PCM®, 911®, 4S®, FOUR, UNCOMPROMISED.® and the model numbers and distinctive shapes of Porsche's automobiles such as, the federally registered 911 and Boxster automobiles. The third party trademarks contained herein are the properties of their respective owners. Some vehicles may be shown with non-U.S. equipment. Porsche recommends seat belt usage and observance of traffic laws at all times.

Printed in the USA