

Technical Service Bulletin

Mazda North American Operations
Irvine, CA 92618-2922



© 2017 Mazda Motor of America, Inc.

Subject: AUTO A/C BLOWS WARM AIR	Bulletin No.: 07-003/17
	Last Issued: 03/24/2017

BULLETIN NOTES

This bulletin supersedes the previously issued bulletin(s) listed below: The changes are noted in Red.

Previously issued TSBs:	Date issued:
07-004/16	12/12/2016, 10/21/2016

APPLICABLE MODEL(S)/VINS

2016-2017 CX-3 vehicles with VINs lower than JM1 DK ***** 166429 (produced before February 1, 2017)
2016-2017 Mazda2 Mexico vehicles with VINs lower than 3MD DJ***** 109426 (produced before October 24, 2016)

DESCRIPTION

Some customers may complain that it is difficult to adjust the cabin temperature using the auto A/C. This may be more noticeable when the outside temperature is approximately 50 degrees Fahrenheit (10 Celsius).

Customer comment samples:

- The cabin temperature does not decrease to the customers desire (i.e. the set temperature on the temperature control dial). It is warmer in the vehicle cabin than the selected temperature.
- Even if adjusting the set temperature on the temperature control dial to decrease the cabin temperature, the air conditioner always blows warm air from the vents.
- When the outside temperature is approximately 50 degrees Fahrenheit (10 Celsius) as the seasons change, the customer first sets the temperature control dial to 72 degrees Fahrenheit (22 Celsius) to warm up the cabin. After the cabin temperature increases too warm, the customer decreases the set temperature but the vent air temperature does not change as expected and remains too warm. If it is adjusted to "Max. Cold" then too much cold air blows out and it is difficult to adjust the cabin temperature.

The climate control unit logic has been changed to correct this concern.

Customers having this concern should have their vehicle repaired using the following repair procedure.

REPAIR PROCEDURE

1. Verify customer concern.

CONSUMER NOTICE: The information and instructions in this bulletin are intended for use by skilled technicians. Mazda technicians utilize the proper tools/equipment and take training to correctly and safely maintain Mazda vehicles. These instructions should not be performed by "do-it-yourselfers." Customers should not assume this bulletin applies to their vehicle or that their vehicle will develop the described concern. To determine if the information applies, customers should contact their nearest authorized Mazda dealership. Mazda North American Operations reserves the right to alter the specifications and contents of this bulletin without obligation or advance notice. All rights reserved. No part of this bulletin may be reproduced in any form or by any means, electronic or mechanical---including photocopying and recording and the use of any kind of information storage and retrieval system ---without permission in writing.

2. Replace the climate control unit (A). Refer to **MGSS**online:

- CX-3 - CLIMATE CONTROL UNIT REMOVAL/INSTALLATION [FULL-AUTO AIR CONDITIONER].
- Mazda2- CLIMATE CONTROL UNIT REMOVAL/INSTALLATION [FULL-AUTO AIR CONDITIONER].

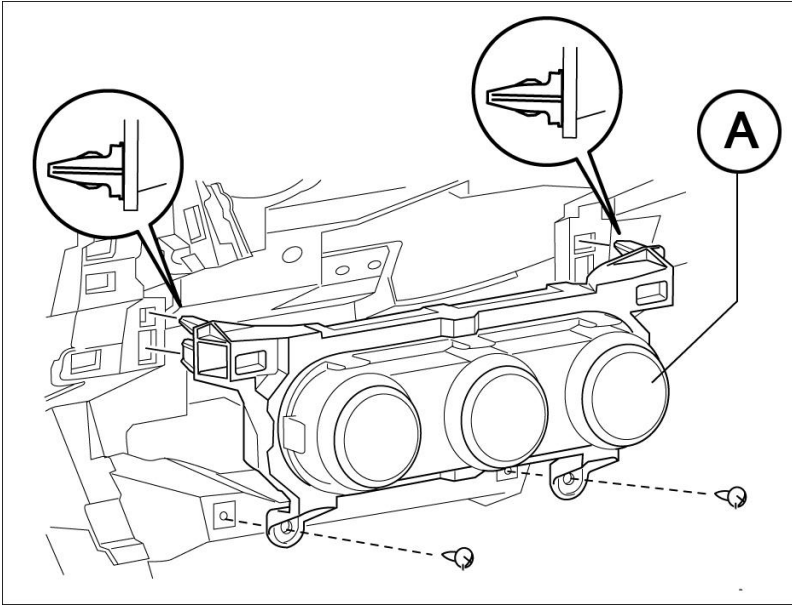

3. Verify repair.

PARTS INFORMATION

Part Number	Description	Qty.	Note
DD5C-61-190A	CONTROL ASSY-HEATER	1	CX-3 U.S.A. only (HVAC control in Fahrenheit)
DA6S-61-190B	CONTROL ASSY-HEATER	1	CX-3 Mexico and Canada only (HVAC control in Celsius)
DA6C-61-190C	CONTROL ASSY-HEATER	1	Mazda2 Mexico only (HVAC control in Celsius)

Note: Use GEPC with VIN to look up the correct part number.

WARRANTY INFORMATION

NOTE:

- This warranty information applies only to verified customer complaints on vehicles eligible for warranty repair.
- This repair will be covered under Mazda's New Vehicle Limited Warranty term.

- Additional diagnostic time cannot be claimed for this repair.

Warranty Type	A
Symptom Code	59
Damage Code	9W
Part Number Main Cause	**** 61 190*
Quantity	1
Operation Number / Labor Hours:	XXM9HXRX / 0.6 Hrs.