

# Short Pin Installation during PDS

**Service Category** General

**Section** Pre-Delivery Service

**Market** USA

Toyota Supports  
 ASE Certification 

## Applicability

| YEAR(S) | MODEL(S)        | ADDITIONAL INFORMATION |
|---------|-----------------|------------------------|
| 2016    | Camry, Camry HV |                        |

## Introduction

To minimize battery discharge during transportation and storage, the Short Pin has been removed at the assembly plant and temporarily stored in the engine compartment Relay Block. Reinstall the Short Pin into its original location and confirm all related Diagnostic Trouble Codes (DTCs) are cleared during Pre-Delivery Service (PDS).

### NOTE

The short pin is removed only on vehicles going to Hawaii, Puerto Rico, Saipan, Guam, and American Samoa.

## Required Tools & Equipment

| REQUIRED EQUIPMENT | SUPPLIER | PART NUMBER  | QTY |
|--------------------|----------|--------------|-----|
| Techstream 2.0*    | ADE      | TS2UNIT      | 1   |
| Techstream Lite    |          | TSLITEPDLR01 |     |

\* Essential SST.

### NOTE

- Only ONE of the Techstream units listed above is required.
- Software version 10.10.018 or later is required.
- Additional Techstream units may be ordered by calling Approved Dealer Equipment (ADE) at 1-800-368-6787.

## Warranty Information

| OP CODE | DESCRIPTION                | TIME | OFF | T1 | T2 |
|---------|----------------------------|------|-----|----|----|
| N/A     | Not Applicable to Warranty | –    | –   | –  | –  |

## Short Pin Installation during PDS

### Introduction

1. Remove the Short Pin from the blank space of the Relay Block in the engine compartment and install the Short Pin in the Relay Block as shown.

Figure 1

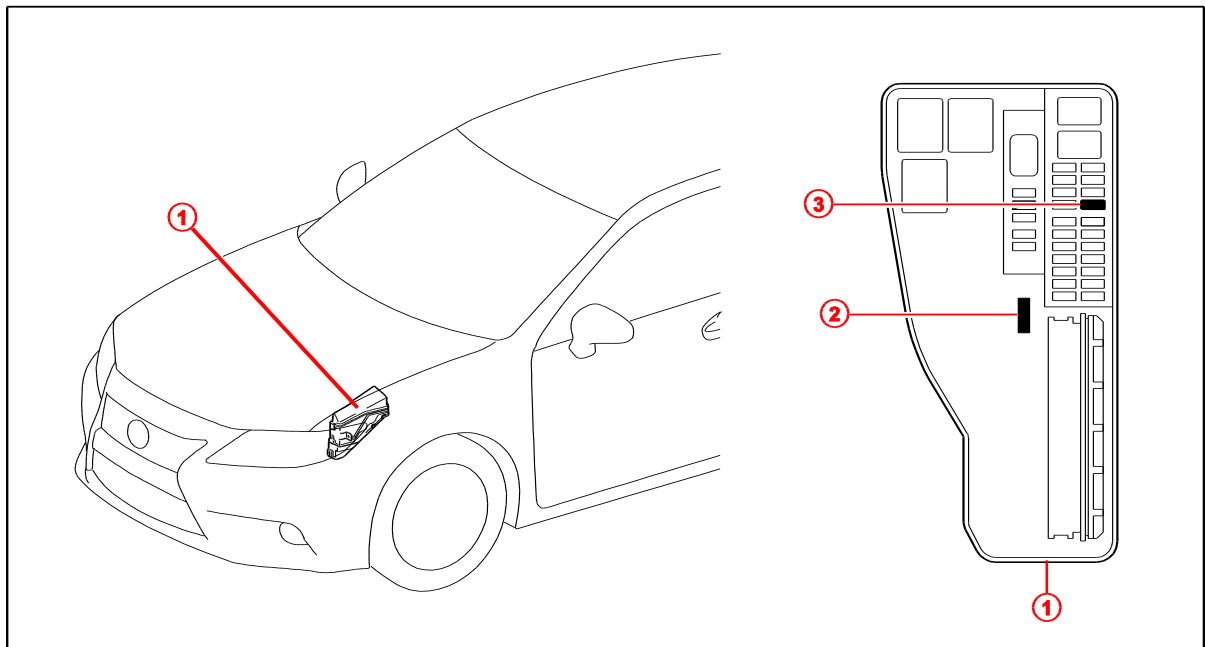

|   |                       |
|---|-----------------------|
| 1 | Relay Block           |
| 2 | Remove This Short Pin |

|   |  |
|---|--|
| 3 | Install Short Pin Here (Original Location) |
|---|--|

### NOTE

- The Short Pin does NOT function as a fuse, so install it only in the position shown.
- If the vehicle is stored after PDS, disconnect the negative (-) battery terminal to prevent battery discharge. Refer to Service Bulletin No. [PG001-06](#), "Battery Maintenance for In-Stock Vehicles & Pre-Delivery."

### DTC Clearing Procedure

With the Short Pin removed, the occupant classification ECU and Center Airbag Sensor Assembly (airbag ECU) may detect the interruption in battery voltage (B+) and store one or more DTCs. Clear DTCs B1650 and B1794 after installing the Short Pin.

1. Connect Techstream to the DLC3.
2. Cycle the ignition switch to the "IG-ON" position.

## Short Pin Installation during PDS

---

### DTC Clearing Procedure (Continued)

3. Using Techstream, check any other codes being output.

**NOTE**

If any DTCs other than B1650 and B1794 are found, repair the applicable system according to the Repair Manual.

4. Erase DTCs (B1650 and B1794) and Freeze Frame Data.