



**ATTENTION: This Technical Service Bulletin was issued by Southeast Toyota Distributors, LLC.**

**For Toyota Dealers located within the Southeast Region:** Please refer to SET Dealer Daily to obtain instructions on how to order parts and submit a warranty claim (If applicable).

**For Lexus Dealers or Toyota Dealers NOT located in Florida, Georgia, Alabama, South Carolina or North Carolina:** For Repair Authorization, Parts Ordering, and Warranty Claims please contact Southeast Toyota Distributors Warranty Claims Department:

(888)851-2722

Press 5, then Press 4 for Out of Region SET Repairs

[Accessory.Warranty@SEToyota.com](mailto:Accessory.Warranty@SEToyota.com)

Thank you for your continued support.

# Highlander Trailer Wiring

## Connecting Trailer Harness to Vehicle

### Applicability

YEAR(S)	MODEL(S)	INSTALLED ACCESSORY INFORMATION		
2014-16	Highlander	Trailer Hitch and Harness	DH1000	00016-48009

**\*\*This Publication does not apply to Vehicles Originally Equipped with a trailer hitch and harness from the factory.**

### REVISION NOTICE

12/22/2015

Format Edited for TIS publication

Any previous printed versions of this bulletin should be discarded.

### Introduction

Some owners may comment that they are unable to connect their flat 4 trailer wiring harness into the vehicles connector due to interference with the hitch pin. This document will clarify proper usage of the accessory trailer harness and temporary mounting bracket.



### Warranty Information

For Dealers located in the Southeast Region, Florida, Georgia, Alabama, South Carolina, or North Carolina, Submit Warranty claim utilizing the information below.

OP CODE	DESCRIPTION	TIME	OFF	T1	T2
NA	NA	NA	NA	NA	NA

If you are a dealer located outside of the Southeast Region, please contact the SET Accessory Warranty Department at (888)851-2722 Press 5, then Press 4 for Out of Region SET Repairs or email [Accessory.Warranty@SEToyota.com](mailto:Accessory.Warranty@SEToyota.com) for claim payment instructions.

## SET-TSB-15-015 Highlander Trailer wiring connector

### **Parts Information**

PART NUMBER	DISCRIPTION
NA	NA

If you are a dealer located outside of the Southeast Region, please contact the SET Accessory Warranty Department at (888)851-2722 Press 5, then Press 4 for Out of Region SET Repairs or email [Accessory.Warranty@SETToyota.com](mailto:Accessory.Warranty@SETToyota.com).

### **Repair Process**

#### **Concern**

Some owners may comment they are unable to connect their 4 pin trailer harness to the Vehicle's accessory trailer harness connection due to interference with the hitch Pin.



#### **Remedy**

Removal of connector from temporary holding bracket for trailer use.

- 1) Remove Cap from Connector



### SET-TSB-15-015 Highlander Trailer wiring connector

- 2) Grasp the back of the connector and pull connector from temporary bracket.



- 3) Using slack in harness, pull the connector from under the bumper cover and connect to the trailer's harness.



Storage of connector after use.

- 1) Verify the Connector Cap strap loop is positioned behind the groove in the connector for the holding bracket.

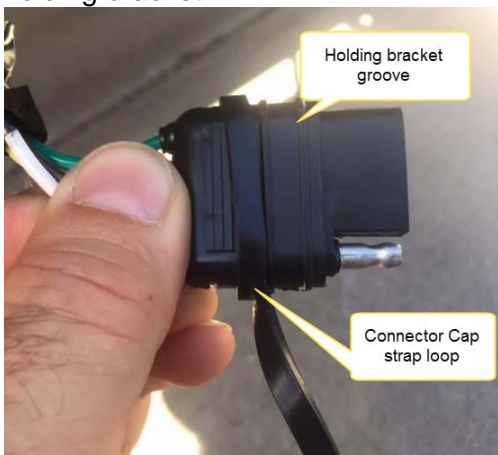

## SET-TSB-15-015 Highlander Trailer wiring connector

- 2) While Grasping the rear of the connector, push connector into holding bracket



- 3) Place protective cap over the connector.

