

WE57 - Reworking Sealing Channel and Side Panel (Workshop Campaign)

Model Line: **911 Carrera Cabriolet (991)/911 Carrera S Cabriolet (991)
911 Carrera 4 Cabriolet (991)/911 Carrera 4S Cabriolet (991)
911 Targa 4 (991)/911 Targa 4S (991)**

Model Year: **As of 2012 up to 2015**

Concerns: **Sealing channel and side panel**

Information: This is to inform you of a voluntary Workshop Campaign on the above-mentioned vehicles. **There is a possibility that the point at which the sealing channel meets the side panel was not protected sufficiently against corrosion on the affected vehicles.**

As a result, corrosion can appear at the joint between the sealing channel and side panel over the service life of the vehicle.

Action Required: Rework sealing channel and side panel using corrosion protection wax.

Affected Vehicles: The VIN(s) can be checked by using PIWIS Vehicle Information link to verify if the campaign affects the vehicle. This campaign is scope specific to the VIN! Failure to verify in PIWIS may result in an improper repair. This campaign affects 10,241 vehicles in North America.

Parts Info: **NOTE: PARTS FOR THIS CAMPAIGN WILL BE AUTOMATICALLY ALLOCATED FOR UP TO 50% OF THE VEHICLES THAT ARE SERVICED AT YOUR DEALERSHIP. ONCE YOUR DEALERSHIP IS OUT OF STOCK AND REQUIRES ADDITIONAL PARTS, YOU SHOULD SUBMIT A PTEC/PAV.**

Part No.	Designation	Qty.
999.915.686.00	⇒ Corrosion protection wax	250g can (approx. 25 grams required per vehicle)

Additional materials required:

...	Clean, lint-free cloth	1 ea. *
	Cleaning agent (e.g. isopropanol)	
	Disposable gloves	
	Paint brush (8 mm wide)	

* The WWS Warranty system will automatically add into the "Miscellaneous item" section (sublet) of the claim after the claim has been submitted.



Information

Use-by date and storage of corrosion protection wax.

- After opening corrosion protection wax, store it in a dark, dry place at temperatures of 30° to 86° F. (+10° to +30° C.).
- Corrosion protection wax has a shelf life of approx. 12 months after opening, depending on air and lighting conditions.
- Write the opening date on the can.
- After opening the can, corrosion protection wax can change over time (e.g. color change or skin formation). To prevent skin formation, seal the can tightly after use and stir the wax frequently.
- If a can of wax that has already been opened and is still good to use is used at a later time for further vehicles and a skin has formed on the surface in the interim period, remove this using a paint brush or spatula.
- The service employee is responsible for marking the use-by date after opening and recording the number of times the corrosion protection wax has been used.
- If the use-by date shown on an open can is exceeded, dispose of the entire can and use a new can.
- Always observe safety and processing instructions for corrosion protection wax.

Work
Procedure:

See Attachment "A".

Claim
Submission:

See Attachment "B".



Information

The procedure described here must be carried out on **both side panels** in the entire area behind the additional seal.

The figures show the work to be carried out on the **left** side of the vehicle in direction of travel. The work on the right side of the vehicle must be carried out in the same way.

Attachment "A": **Work Procedure**

- 1 Open convertible-top compartment lid.
 - 1.1 Switch on ignition.
 - 1.2 Open the convertible top electrically until the convertible top is at the center position.

- 1.3 Cancel the opening process.
- 1.4 Switch off ignition and remove ignition key.
- 2 Unclip additional seal on the inner side panel by pulling it upwards ⇒ *Removing additional seal -arrows-*.

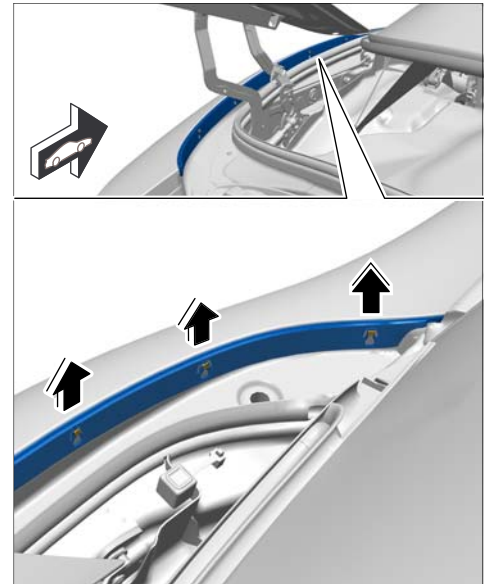

Removing additional seal

- 3 Clean the area to be treated on the sealing channel and side panel using a suitable cleaning agent (e.g. isopropanol) so that all traces of silicone, grease and oil are completely removed ⇒ *Cleaning side panel.*

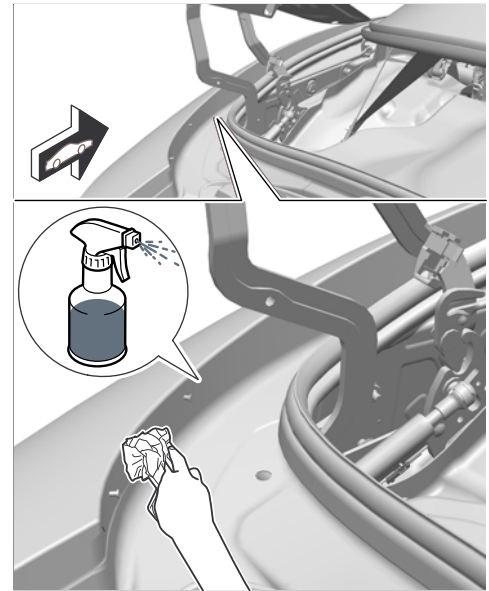

Cleaning side panel

- 4 Shake the can of corrosion protection wax well before use and apply corrosion protection wax evenly to the area marked in yellow at the joint between the sealing channel and side panel using a paint brush ⇒ *Applying corrosion protection wax.*

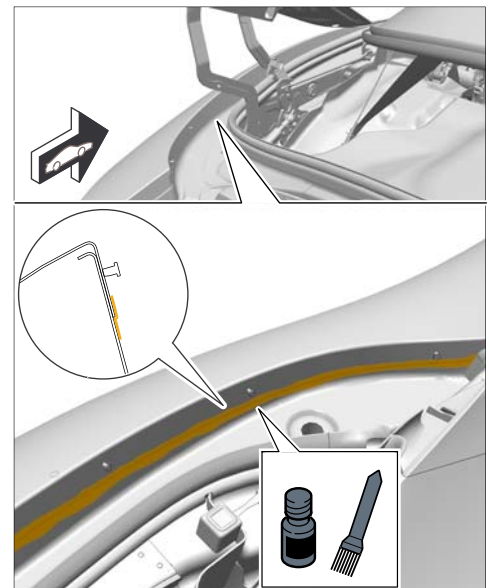

Applying corrosion protection wax

- 5 Position additional seal on the side panel and clip it in ⇒ *Installing additional seal -arrows-.*

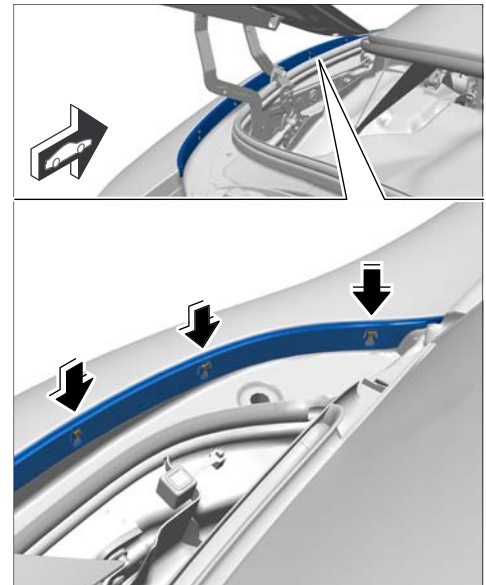

Installing additional seal

- 6 Remove any excess corrosion protection wax under the additional seal using a clean, lint-free cloth
 ⇒ *Removing corrosion protection wax.*

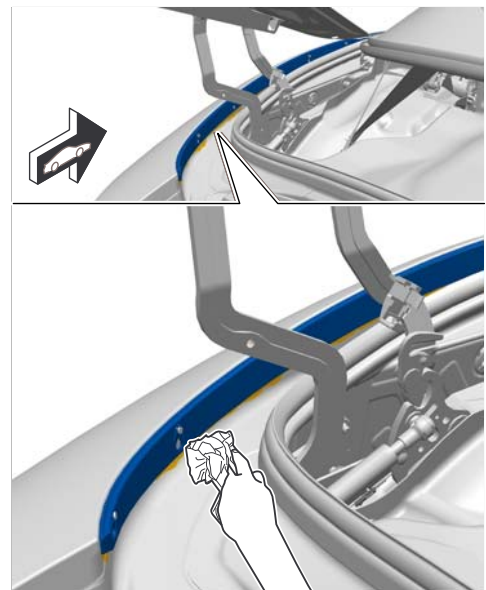

Removing corrosion protection wax

- 7 Close convertible-top compartment lid.
 - 7.1 Switch on ignition and close the convertible top electrically.
 - 7.2 Switch off ignition.

8 Enter the work shop campaign in the Warranty and Maintenance booklet.

Attachment "B": **Claim Submission** - Workshop Campaign WE57

Warranty claims should be submitted via WWS/PQIS.

Open campaigns may be checked by using either the PIWIS Vehicle Information system or through PQIS Job Creation.

Labor, parts, and sublet will be automatically inserted when Technician is selected in WWS/PQIS. If necessary, the required part numbers will need to be manually entered into warranty system by the dealer administrator.

Working time:

Reworking sealing channel and side panel

Labor time: **30 TU**

Parts required:

999.915.686.00	Corrosion protection wax	0.1 ea. * (= 25 grams)
WE570000001	Expendable items	1 ea. ** (for warranty invoicing only)

* Only **part** of the cost of the corrosion protection wax may be billed during **warranty invoicing** for each vehicle.

If an open can of wax is left over or can no longer be used because it has passed its use-by date, the remaining quantity can be invoiced using a **separate warranty claim**. The additional warranty claim must be invoiced by specifying ⇒ **Damage code 5355 097 000 1**.

Document the work involved in the related PQIS Job by specifying **53550** (Corrosion protection wax for sealing channel and side panel) under "Location" and **1213** (Repair in accordance with PAG instructions) as the "Damage category". Specify that the amount was invoiced due to campaign **WE57** under "Further Information" for the PQIS job.

** The WWS Warranty system will automatically add into the "Miscellaneous item" section (sublet) of the claim after the claim has been submitted.

⇒ Damage code WE57 066 000 1

Important Notice: Technical Bulletins issued by Porsche Cars North America, Inc. are intended only for use by professional automotive technicians who have attended Porsche service training courses. They are written to inform those technicians of conditions that may occur on some Porsche vehicles, or to provide information that could assist in the proper servicing of a vehicle. Porsche special tools may be necessary in order to perform certain operations identified in these bulletins. Use of tools and procedures other than those Porsche recommends in these bulletins may be detrimental to the safe operation of your vehicle, and may endanger the people working on it. Properly trained Porsche technicians have the equipment, tools, safety instructions, and know-how to do the job properly and safely. If a particular condition is described, do not assume that the bulletin applies to your vehicle, or that your vehicle will have that condition. See your authorized Porsche Dealer for the latest information about whether a particular technical bulletin applies to your vehicle. Part numbers listed in these bulletins are for reference only. Always check with your authorized Porsche dealer to verify the current and correct part numbers. The work procedures updated electronically in the Porsche PIWIS diagnostic and testing device take precedence and, in the event of a discrepancy, the work procedures in the PIWIS Tester are the ones that must be followed.

© Porsche Cars North America, Inc.

Dealership	Service Manager	_____	Shop Foreman	_____	Service Technician	_____	_____	_____	_____
Distribution									
Routing	Asst. Manager	_____	Warranty Admin.	_____	Service Technician	_____	_____	_____	_____

Dr. Ing. h.c. F. Porsche AG is the owner of numerous trademarks, both registered and unregistered, including without limitation the Porsche Crest®, Porsche®, Boxster®, Carrera®, Cayenne®, Cayman®, Macan®, Panamera®, Speedster®, Spyder®, 918 Spyder®, Tiptronic®, VarioCam®, PCM®, PDK®, 911®, RS®, 4S®, FOUR, UNCOMPROMISED®, and the model numbers and the distinctive shapes of the Porsche automobiles such as, the federally registered 911 and Boxster automobiles. The third party trademarks contained herein are the properties of their respective owners. Porsche Cars North America, Inc. believes the specifications to be correct at the time of printing. Specifications, performance standards, standard equipment, options, and other elements shown are subject to change without notice. Some options may be unavailable when a car is built. Some vehicles may be shown with non-U.S. equipment. The information contained herein is for internal authorized Porsche dealer use only and cannot be copied or distributed. Porsche recommends seat belt usage and observance of traffic laws at all times.

Printed in the USA