



Previous Screen

< Product: NO EQUIPMENT SELECTED  
Model: NO EQUIPMENT SELECTED  
Configuration: NO EQUIPMENT SELECTED

**Service Letter**

**PRODUCT SUPPORT PROGRAM FOR REPLACING THE CLUTCH LEVER AND ROD ASSEMBLY ON CERTAIN CT660 ON HIGHWAY TRUCK**

Media Number -REBE9932-00

Publication Date -05/07/2013

Date Updated -08/07/2013

Caterpillar: Confidential Yellow

REBE9932-00



**SERVICE LETTER**

05Jul2013

U-295  
A-202

*After Failure Only*

**PRODUCT SUPPORT PROGRAM FOR REPLACING THE CLUTCH LEVER AND ROD ASSEMBLY ON CERTAIN CT660 ON HIGHWAY TRUCK**

7000

**PS52477**

NOTE:

This Program can only be administered after a failure occurs. The decision whether to apply the Program is made by the dealer. When reporting the repair, use "PS52477" as the Part Number and "7755" as the Group Number. Use "96" as the Warranty Claim Description Code and use "Z" as the SIMS Description Code.

Caterpillar: Confidential Yellow

**NOTE:**

The information supplied in this service letter may not be valid after the termination date of this program. Do not perform the work outlined in this Service Letter after the termination date without first contacting your Caterpillar product analyst.

**TERMINATION DATE**

31Jul2015

**PROBLEM**

The existing clutch lever and rod assembly does not allow for proper clutch adjustment on certain CT660 On Highway Trucks. If the existing clutch lever components are not replaced, proper adjustment may not be able to be achieved.

**AFFECTED PRODUCT**

Model	Identification Number
CT660	TKL00102, 105, 109-110, 112-113, 115-116, 118-120, 122-126, 128, 136-137, 142-144, 146-147, 149, 152, 158-159, 161, 165-167, 170-171, 179-181, 183-189, 191-192, 196, 199-205, 207, 209, 211, 215-217, 220-223, 226-231, 234-264, 266-267, 269-271, 275-281, 283-288, 292-293, 296-298, 300, 303, 305-308, 310, 312-327, 329-338, 340, 342-347, 349-351, 354, 357-374, 376-389, 391-400, 402, 404-409  TRK00103-00104, 107, 109-110, 112, 114-116, 118, 120-123, 126-127, 133-135, 137-141, 144-145, 149, 153, 155, 157-166, 168-171, 174, 176-178, 180-181, 188-190, 192, 196-197, 199, 201, 203, 206-208, 211, 213, 215-217, 221-224, 227, 230-231, 233, 235-240, 244-245, 247-248, 250, 252-255, 257-258, 261, 263, 265-267, 269-271, 275-276, 278-280, 282, 287-288, 290-291, 293-296, 300-304, 306-307, 309-310, 312-314, 316-318, 320-322, 324, 326, 328, 333-337, 339, 341-349, 351-352, 355, 357, 359-361, 364-367, 369, 371-374, 376, 380, 383, 385-392, 400-401, 403-404, 406-412, 415-419, 421-422, 424-425, 429-430, 432, 435-437, 439, 443-445, 448-450, 452, 455-457, 462-465, 469, 472-475, 478, 481-483, 486, 488-492, 495,

Caterpillar: Confidential Yellow

497, 500-502, 504, 511, 516, 518, 524, 527-530, 536-541, 544, 546-547, 550-552, 557-559, 562-567, 569-570, 573, 577, 580, 582, 584, 586-588, 590-593, 595-598, 600, 603-605, 607-608, 610-614, 616, 618, 620-621, 623-625, 629-630, 632-633, 637, 639, 641-644, 647, 649, 651-652, 654-656, 658-661, 663-664, 670-671, 674-675, 677, 679-683, 685, 689, 692-693, 697-699, 701-703, 705, 707-709, 712-713, 715, 717, 719, 722-727, 731-732, 735, 737-738, 740-741, 744, 749-751, 753-754, 756, 759, 761, 763-766, 769-771, 773, 775, 777-778, 782, 790, 792-797, 799-802, 804-805, 809-810, 812-816, 818-819, 823-824, 826, 829-832, 835-839, 842, 845-846, 853-854, 856, 866-873, 876, 882, 888, 890-891, 897, 902-903, 906-907, 909, 911-914, 918, 920-922, 927, 929-930, 933-937, 942, 947, 953, 955-957, 961-963, 972, 974-975, 977, 981-983, 985-986, 988-990, 993, 996-999, 1001-1003, 1009, 1016-1017, 1019-1021, 1025, 1030-1031, 1036-1038, 1050, 1052, 1058, 1071, 1077, 1079-1080, 1082-1083, 1085-1086, 1090, 1094-1095, 1105-1107, 1113, 1124-1127, 1133-1134, 1136-1137, 1141-1142, 1144, 1146-1147, 1149-1150, 1153-1156, 1159, 1162-1164, 1166-1167, 1173-1176, 1179-1180, 1182, 1184-1185, 1187-1190, 1192, 1210-1215, 1223-1224

TSY00102-00107

## PARTS NEEDED

Qty	Part Number	Description
1	4312173	LEVER-CLUTCH
1	4335964	ROD AS-CL CONT

In order to allow equitable parts availability to all participating dealers, please limit your initial parts order to not exceed 1% of dealership population. This is an initial order recommendation only, and the ultimate responsibility for ordering the total number of parts needed to satisfy the program lies with the dealer.

Caterpillar: Confidential Yellow

## ACTION REQUIRED

Refer to the attached Rework Procedure.

## SERVICE CLAIM ALLOWANCES

Product smu/age whichever comes first	Caterpillar		Dealer Suggested		Customer Suggested	
	Parts %	Labor Hrs%	Parts %	Labor Hrs%	Parts %	Labor Hrs%
0-250000 miles, 0-24 mo	100.0%	100.0%	0.0%	0.0%	0.0%	0.0%
NOTE: This is a 1.5-hour job						

## PARTS DISPOSITION

Handle the parts in accordance with your Warranty Bulletin on warranty parts handling.

### Rework Procedure

#### Removal Procedure

1. Bring truck into shop and park on flat surface.
2. Shift transmission to Park or Neutral, set parking brake, and install wheel chocks.
3. Open hood.

NOTE: For additional information, refer to appropriate Service Manual.

Caterpillar: Confidential Yellow

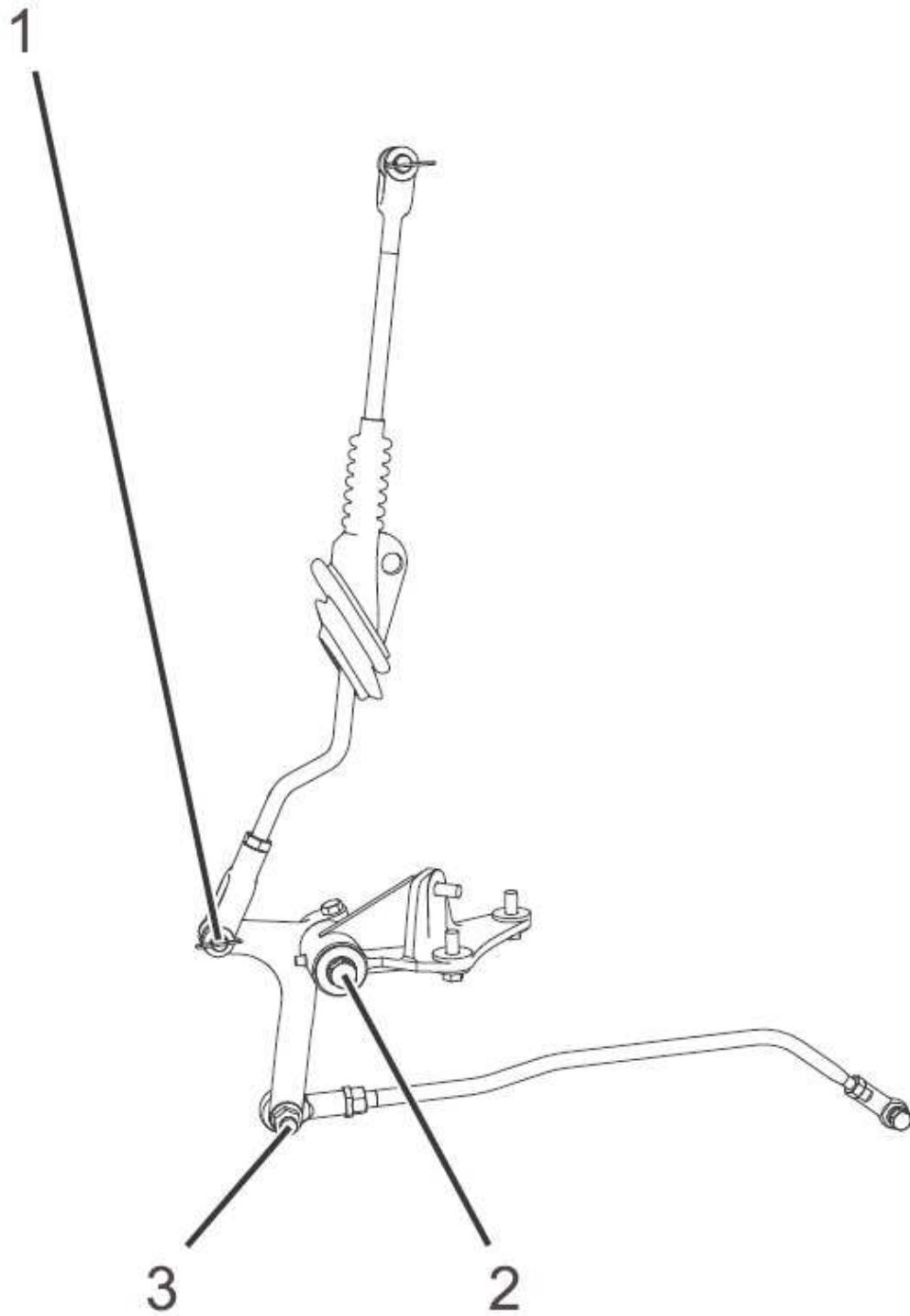

Image1.1.1

Image1.1.1: Clutch Relay Lever (Bell Crank Lever).

Item (1) Clutch rod vertical linkage

Item (2) Clutch relay lever connection to bracket

Item (3) Clutch relay lever horizontal linkage

4. Disconnect clutch rod vertical linkage (Image1.1.1, Item 1) from clutch relay lever (bell crank).

Caterpillar: Confidential Yellow

5. Disconnect horizontal linkage (Image1.1.1, Item 3) from clutch relay lever.
6. Remove clutch relay lever (Image1.1.1, Item 2) from clutch relay lever bracket.

#### Installation Procedure

1. Install new clutch relay lever (Image1.1.1, Item 2) on clutch relay lever bracket.
2. Install horizontal linkage (Image1.1.1, Item 3) to clutch relay lever.
3. Install new vertical clutch rod linkage (Image1.1.1, Item 1) to clutch relay lever.

NOTE: Make sure all spring clips are properly installed in the clevis pins.

4. Verify clutch adjustment. Refer to appropriate Service Manual for clutch adjustment.
5. Close and latch hood.
6. Remove wheel chocks.

---

[Copyright 1993 - 2013 Caterpillar Inc.](#)

Sat Aug 3 15:14:55 CDT 2013

[All Rights Reserved.](#)

[Private Network For SIS Licensees.](#)

Caterpillar: Confidential Yellow