

## Bevel Gear Compartment Cover CHU, CXU, GU, TD, LEU, MRU, LR, CMM, CXX, CSM, CMH, CLX

### FSB 465-003, Bevel Gear Compartment Cover

(August 2017)

Effective September 2016, a revised composite bevel gear compartment cover with steel threaded fill plug and face-mounted o-ring was implemented into production for MACK CRD202/203, CRD150/151 and CRD 125/126 carriers. The revised composite cover replaces the previous composite cover with the rubber fill plug.

The new style threaded fill plug (1) (part number 22686405) must be serviced with the new style cover (2) (part number 22685788). The old style rubber fill plug (3) (part number 20953259) must be serviced with the old style cover (part number 21658870).

**Note:** The new style cover (part number 22685788) is shown in the figure below.

**Note:** The old style cover (not shown) does not have the threaded fill hole used for the new style fill plug (1).

**Note:** This bulletin does apply to MACK Trucks Australia.

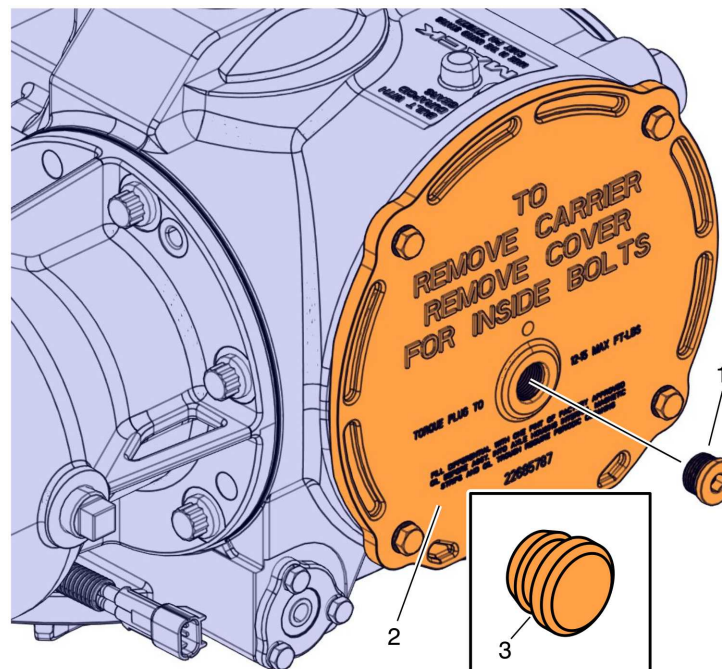

W4126795

Fig. 1 New Style Cover Shown with New Style Fill Plug

When removing the fill plug to check the oil level or fill the bevel gear compartment with oil, use a 9.5 mm (.375 in) hex driver. Always ensure the fill plug's face-mounted o-ring and the cover's threaded hole is free of damage to avoid any oil leaks. Lubricate the face-mounted o-ring with gear oil prior to installation if removed. Tighten the fill plug 16 – 20 Nm (12 – 15 ft-lb) max.

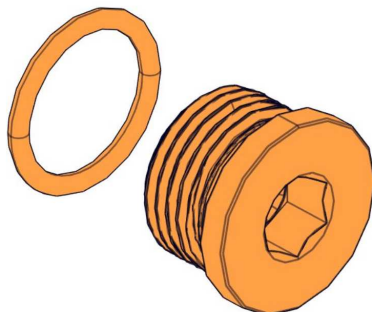

W4126796

Fig. 2 New Style Fill Plug and Face-Mounted O-Ring Shown



W4126797

Fig. 3 New Style Cover With Threaded Fill Hole Shown