

WC18 - Reworking Motor for Rear Side Section Flaps (Workshop Campaign)

Vehicle Type: **911 Carrera (991)/911 Carrera S (991)**

Model Year: **2012**

Concerns: **Motor for rear side section flaps**

Information: This is to inform you of a voluntary Workshop Campaign on the above-mentioned vehicles. There is the possibility that motors for controlling the rear side section flaps, on which the pinion shaft is not connected properly to the motor due to a manufacturing defect, were installed in the affected vehicles.

In the event of emergency operation, the convertible top cannot therefore be closed manually as described in the Owner's Manual.

Action Required: Glue the pinion shaft to the motor for rear side section flaps.

Affected Vehicles: The VIN(s) can be checked by using PIWIS Vehicle Information link to verify if the campaign affects the vehicle. This campaign is scope specific to the VIN! Failure to verify in PIWIS may result in an improper repair. At the present time, this campaign affects only one (1) vehicle in the N.A.

Parts Info: 000.043.110.20 ⇒ Loctite 480 adhesive, 20g bottle (impact-resistant) 1 ea.
Commerically available from W.W. Grainger (Grainger.com), p/n 2VFH2

The bottle of Loctite 480 must only be claimed for one vehicle at each Porsche dealership. The remainder of the campaigns claimed must be submitted without parts.

Tools: **Nr.90 Pos.1 - Torque wrench**
Screwdriver/socket-wrench insert, Torx 25
Screwdriver/socket-wrench insert, Torx 20
Screwdriver (Philips)

Work Procedure: See Attachment "A".

Claim Submission: See Attachment "B".

Attachment "A": **Work Procedure****Information**

The convertible top may still be in transport mode and may not therefore be functional. Since the convertible top will have to be operated as part of the campaign, it must not be in transport mode. See ⇒ *Technical Information '610100 Sales check: Restoring convertible top function'*.

1 Remove motor for rear side section flaps ⇒ *Workshop Manual '614019 Removing and installing flap motor - section on "Removing"*.

2 Rework motor for rear side section flaps.

2.1 Pull pinion shaft out of the guide for the motor ⇒ *Figure 1 -A-*.

2.2 Clean contact surfaces on the pinion shaft and motor.

2.3 Coat the end of the pinion shaft with **Loctite 480 adhesive** all the way around ⇒ *Figure 1 -B-*.

2.4 Insert the coated pinion shaft into the motor immediately (adhesion time: 10 to 150 sec.) and slide it in as far as it will go ⇒ *Figure 1 -C-*.

The glued pinion shaft must stick securely to the motor. Check that the pinion shaft is adhered correctly (glue it on again if necessary).

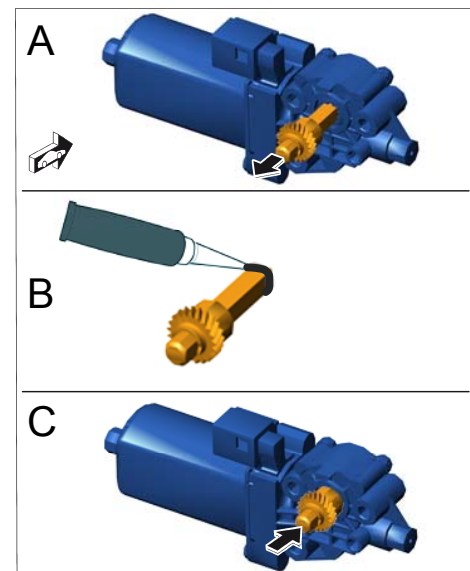

Figure 1

3 Install motor for rear side section flaps ⇒ *Workshop Manual '614019 Removing and installing flap motor - section on "Installing"*.

4 Enter the workshop campaign in the Warranty and Maintenance booklet.

Attachment "B": **Claim Submission** - Workshop Campaign WC18

Warranty claims should be submitted via WWS/PQIS.

Open campaigns may be checked by using either the PIWIS Vehicle Information system or through PQIS Job Creation.

Labor, parts, and sublet will be automatically inserted when Technician is selected in WWS/PQIS. If necessary, the required part numbers will need to be manually entered into warranty system by the dealer administrator.

