

Intermittent Low Coolant Warning In The Instrument Cluster

ATI Binder – Group 1
 This ATI replaces ATI Group 9, #1616,
 dated 6-17-2016.

Vehicle Type: **991**

Model Year: **2016 built after 11/01/2016**

Part Number: 991 106 157 05

Issue: Intermittent low coolant warning on this instrument cluster.

Information: The customer states that the low coolant warning came on the instrument cluster and the temperature gauge went to full hot (or overheated). Fault “OOA046 Warning: Coolant level” may also be stored in the instrument cluster.

- Note: When the vehicle thinks the coolant level is low it will move the temperature gauge to full hot. The vehicle has NOT overheated. It does this because it cannot get an accurate coolant temperature if the coolant level is low, therefore it moves the temperature gauge to full hot as a precautionary measure.

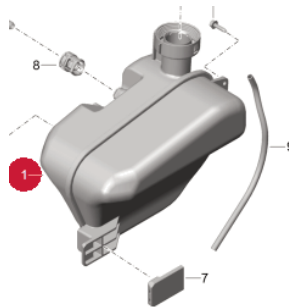

There is a plastic float in the coolant reservoir that can bind, causing a false low coolant level warning.

Check the cooling system as per WM190101. If no leaks or other defects in the cooling system can be found, then replace the coolant reservoir with the above part number.

Dealership Distribution Routing	Service Manager	_____	Shop Foreman	_____	Service Technician	_____	_____	_____	_____
	Asst. Manager	_____	Warranty Admin.	_____	Service Technician	_____	_____	_____	_____

Dr. Ing. h.c. F. Porsche AG is the owner of numerous trademarks, both registered and unregistered, including without limitation the Porsche Crest®, Porsche®, Boxster®, Carrera®, Cayenne®, Cayman®, Macan®, Panamera®, Speedster®, Spyder®, Tiptronic®, VarioCam®, PCM®, PDK®, 911®, RS®, 4S®, 718®, 918 Spyder®, FOUR UNCOMPROMISED®, and the model numbers and distinctive shapes of the Porsche automobiles such as, the federally registered 911 and Boxster automobiles. The third party trademarks contained herein are the properties of their respective owners. Porsche Cars North America, Inc. believes the specifications to be correct at the time of printing. However, specifications, standard equipment and options are subject to change without notice. Some options may be unavailable when a car is built. Some vehicles may be shown with non-U.S. equipment. Please ask your authorized Porsche dealer for advice concerning the current availability of options and verify the optional equipment that you ordered. Porsche recommends seat belt usage and observance of traffic laws at all times.