

Classification:

EL16-031a

Reference:

ITB16-033a

COPYRIGHT© NISSAN NORTH AMERICA, INC.
Date:

October 10, 2016

2017 QX30; MAIN 12 VOLT BATTERY TESTING WITH MIDTRONICS GR8 OR EXP800

This bulletin has been amended to update the Service Information for main 12 volt battery testing.
Please discard previous versions of this bulletin.

APPLIED VEHICLES: 2017 QX30 (H15)

SERVICE INFORMATION

When testing the main 12V battery of an Applied Vehicle with the Midtronics GR8 or EXP800, the test leads must be connected directly to the posts on the main 12V battery (**NOT the remote terminal check points**) to avoid incorrect CCA measurements.

- Please see Figure 1 and Figure 2 on page 2 for correct connections to the 12 volt main battery.

IMPORTANT: Do not contact any surrounding components when connecting the test leads.

CAUTION: Never connect the Midtronics GR8 or EXP800 as shown in Figure 4 on page 2. This can damage the pyro fuse connector.

NOTE: The remote terminal check points can be used for all other battery charging or voltage checking procedures, but will give inaccurate CCA measurements due to voltage drops between them and the main 12V battery.

Infiniti Bulletins are intended for use by qualified technicians, not 'do-it-yourselfers'. Qualified technicians are properly trained individuals who have the equipment, tools, safety instruction, and know-how to do a job properly and safely. NOTE: If you believe that a described condition may apply to a particular vehicle, DO NOT assume that it does. See your Infiniti retailer to determine if this applies to your vehicle.

- Connect the Midtronics GR8 or EXP800 as shown in Figure 1.

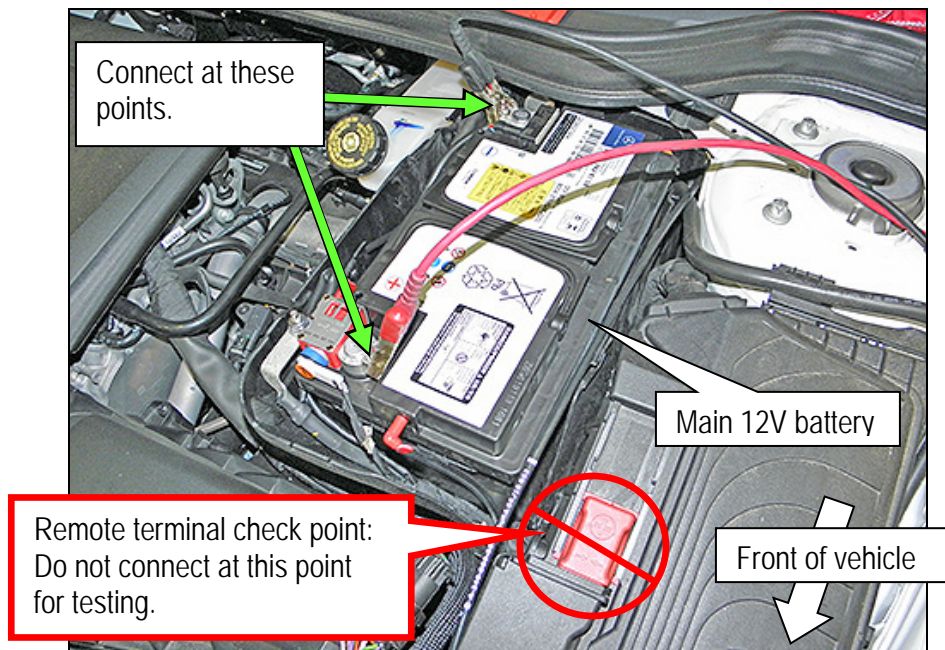

Figure 1

- Figure 2 shows a correct positive battery terminal connection.

CAUTION:

- Never connect the Midtronics GR8 or EXP800 to the positive battery terminal as shown in Figure 3 or 4.
- The pyro fuse may be damaged by the open/close operation of the clamp.

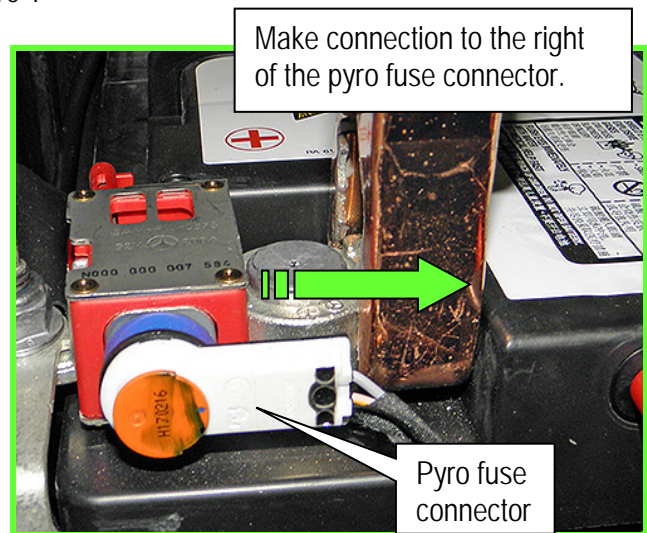

Figure 2

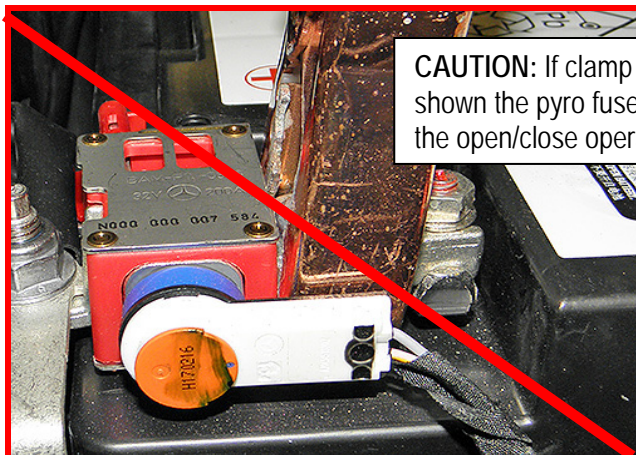

Figure 3

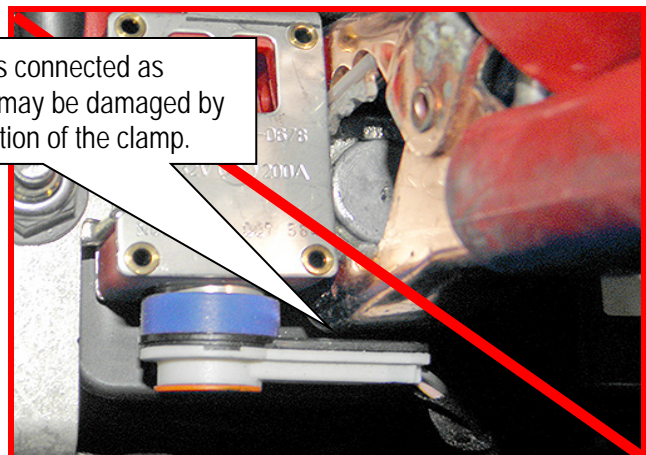

Figure 4

CAUTION: If clamp is connected as shown the pyro fuse may be damaged by the open/close operation of the clamp.