

For questions, comments, or to submit an inquiry, go to
DDCSN.com > [Warranty](#) > [Warranty Applications](#) > [Inquiries](#) > [Submit an Inquiry](#)

Please distribute to:
Dealer Principal, Warranty Manager, Service Manager, Parts Manager, Sales Manager

- | | | |
|--|---|---|
| <input checked="" type="checkbox"/> Freightliner Dealers | <input checked="" type="checkbox"/> Thomas Built Bus Dealers | <input type="checkbox"/> Sales Terms (DTR) |
| <input checked="" type="checkbox"/> Western Star Dealers | <input checked="" type="checkbox"/> Direct Warranty Customers | <input checked="" type="checkbox"/> Used Product (DTR) |
| <input checked="" type="checkbox"/> Sterling Dealers | <input checked="" type="checkbox"/> Export | <input type="checkbox"/> Travel Centers of America/Petro:Lube |
| <input checked="" type="checkbox"/> FCCC Dealers | <input checked="" type="checkbox"/> DDC Distributors | |

IMPORTANT WARRANTY INFORMATION

REF 14-038
 Effective 10/27/2014
 Release 10/27/2014
 SUBJECT Additional Detroit Standard Repair Times

❖ **Overview**

As a result of collaboration with the Standard Repair Time (SRT) Joint Application Development (JAD) committee and in an effort to support the service network and streamline the claims submittal process, DTNA is pleased to announce the creation of several new SRTs. The new SRTs are available for immediate use in the Detroit Warranty System.

❖ **Additional Labor Operations**

New Detroit SRTs

| Engine SRTs Created for Engine Series: DD13, DD15, D13E10, D16E10, DD13GHG14, DD15GHG14AT, DD15GHG14TC, and DD16GHG14 | |
|--|---|
| SRT Code: 042301 | Oil Thermostat Cover Plate/Seal - R&R |
| SRT Code: 021805 | Sensor, Coolant Inlet Temperature Sensor - R&R |
| SRT Code: 021806 | Sensor, Coolant Outlet Temperature Sensor - R&R |
| SRT Code: 021820 | Sensor, Coolant Inlet and Outlet Temperature Sensor - R&R |

**After Treatment System SRTs Created for Engine Series:
DD13GHG14, DD15GHG14AT, DD15GHG14TC, and DD16GHG14**

| | |
|------------------|--|
| SRT Code: 061505 | After Treatment System (ATS) - Diesel Exhaust Fluid (DEF) Pump Main Filter - R&R |
| SRT Code: 061507 | ATS-DEF Pressure Relief Valve (PRV) in the DEF Pump - R&R |
| SRT Code: 061509 | ATS-DEF Pump Inlet Screen - R&R |
| SRT Code: 061515 | ATS-DEF Dosing Unit Screen - R&R |
| SRT Code: 061520 | ATS-DEF Dosing System Kit - R&R |
| SRT Code: 062640 | ATS-DOC Face Plug Cleaning Routine - GHG14 |

**After Treatment System SRTs Created for Engine Series:
D13E10, D16E10, DD13GHG14, DD15GHG14AT, DD15GHG14TC, and DD16GHG14**

| | |
|------------------|--|
| SRT Code: 061300 | ATS-After Treatment Device Harness (One Box) - R&R |
| SRT Code: 061320 | ATS-After Treatment Device Harness (Two Box) - R&R |

The new SRTs are available in the applicable Labor Time Guide as well as at www.ddcsn.com > Warranty > Warranty Applications > Labor > SRTs > SRT Search. Any questions regarding SRTs may be addressed through the Warranty Support Center > Detroit Inquiries.

IMPORTANT WARRANTY INFORMATION LETTER

Verify latest version on-line: [Warranty Operation Letters](#) are available at DDCSN.com > [Literature](#) > [Service Letters/Bulletins](#) > [Warranty Operations](#)

DISCLAIMER: The information contained in this letter supersedes and supplements any related policies and procedures in the Warranty Manual and/or previously released letters. Failure to read or distribute this letter will not exempt addressees from compliance with the information contained herein.

❖ New Engine Labor Operations

Oil Thermostat Cover Plate /Seal

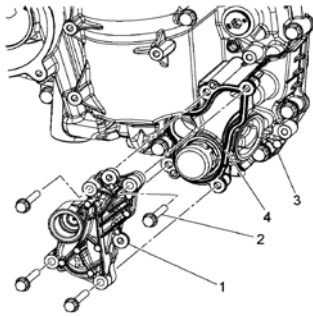

1. Oil Thermostat Cover
2. Oil Thermostat Cover Bolts (4)
3. Oil Coolant Module
4. Oil Thermostat Seal

| SRT Code | Description |
|---|---|
| 042301 | OIL THERMOSTAT COVER PLATE / SEAL – R&R |
| <p>Summary: Includes repositioning the engine sensor harness and/or engine oil dipstick, if required. Removing the oil thermostat cover, removing the seal, clean/inspecting surfaces, installing a new seal and/or cover.</p> | |

Coolant Inlet Temperature Sensor

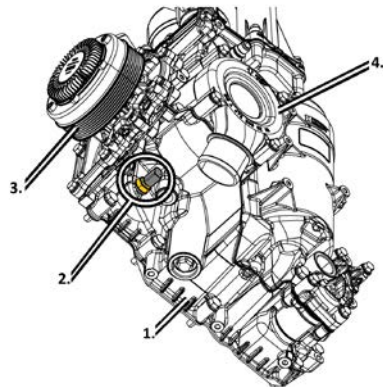

1. Oil Coolant Module
2. Coolant Inlet Temperature Sensor
3. Water Pump
4. Coolant Thermostat

| SRT Code | Description |
|--|--|
| 021805 | SENSOR, COOLANT INLET TEMPERATURE SENSOR - R&R |
| <p>Summary: Includes draining the cooling system to the appropriate level, removing the old coolant inlet temperature sensor, installing a new coolant inlet temperature sensor, and filling the cooling system to the appropriate level.</p> <p>Note: This SRT should only be used if the coolant inlet temperature sensor is replaced.</p> | |

IMPORTANT WARRANTY INFORMATION LETTER

Verify latest version on-line: [Warranty Operation Letters](#) are available at DDCSN.com> [Literature](#)> [Service Letters/Bulletins](#)> [Warranty Operations](#)

DISCLAIMER: The information contained in this letter supersedes and supplements any related policies and procedures in the Warranty Manual and/or previously released letters. Failure to read or distribute this letter will not exempt addressees from compliance with the information contained herein.

For questions, comments, or to submit an inquiry, go to
DDCSN.com> [Warranty](#)> [Warranty Applications](#)> [Inquiries](#)> [Submit an Inquiry](#)

Coolant Outlet Temperature Sensor

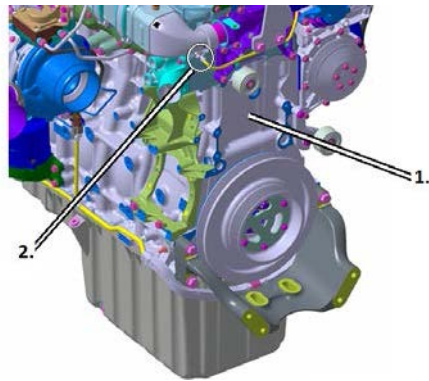

1. Front of the Engine Block
2. Coolant Outlet Temperature Sensor

| SRT Code | Description |
|---|--|
| 021806 | SENSOR, COOLANT OUTLET TEMPERATURE SENSOR - R&R |
| <p>Summary: Includes draining the cooling system to the appropriate level, removing the old coolant outlet temperature sensor, installing a new coolant outlet temperature sensor, and filling the cooling system to the appropriate level.</p> <p>Note: This SRT should only be used if the coolant outlet temperature sensor is replaced.</p> | |

Coolant Inlet and Outlet Temperature Sensors

| SRT Code | Description |
|---|--|
| 021820 | SENSORS, COOLANT INLET AND OUTLET TEMPERATURE SENSORS - R&R |
| <p>Summary: Includes draining the cooling system to the appropriate level, removing the old coolant inlet and outlet temperature sensors, installing a new coolant inlet and outlet temperature sensors, and filling the cooling system to the appropriate level.</p> <p>Note: This SRT should only be used if the coolant inlet and outlet temperature sensors are replaced.</p> | |

IMPORTANT WARRANTY INFORMATION LETTER

Verify latest version on-line: [Warranty Operation Letters](#) are available at DDCSN.com> [Literature](#)> [Service Letters/Bulletins](#)> [Warranty Operations](#)

DISCLAIMER: The information contained in this letter supersedes and supplements any related policies and procedures in the Warranty Manual and/or previously released letters. Failure to read or distribute this letter will not exempt addressees from compliance with the information contained herein.

For questions, comments, or to submit an inquiry, go to
DDCSN.com> [Warranty](#)> [Warranty Applications](#)> [Inquiries](#)> [Submit an Inquiry](#)

❖ New After Treatment System Labor Operations

ATS–DEF Pump Main Filter

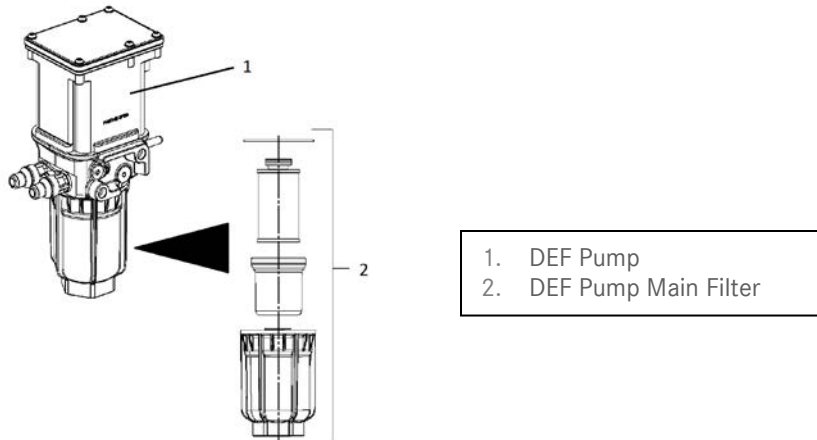

- 1. DEF Pump
- 2. DEF Pump Main Filter

| SRT Code | Description |
|---|--------------------------------|
| 061505 | ATS–DEF PUMP MAIN FILTER - R&R |
| <p>Summary: Includes removing the DEF pump protective cover to access the filter. Removing the DEF main filter cap from the DEF pump. Removing the frost compensation membrane and the filter cartridge from the DEF pump. Installing the filter cartridge in the DEF pump. Installing the frost compensation membrane over the DEF filter cartridge. Lubricating the sealing bead and threads with Biolube. Installing the DEF main filter cap onto the DEF pump. Installing the DEF pump protective cover.</p> | |

ATS–DEF Pump Pressure Relief Valve

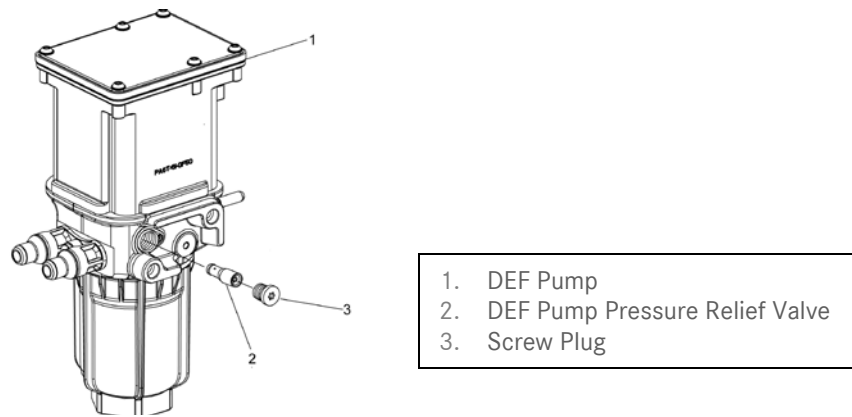

- 1. DEF Pump
- 2. DEF Pump Pressure Relief Valve
- 3. Screw Plug

| SRT Code | Description |
|---|--|
| 061507 | ATS–DEF PUMP PRESSURE RELIEF VALVE – R&R |
| <p>Summary: Includes removing DEF pump protective cover. Removing the DEF pump from the DEF tank and bracket with the lines still attached. Removing the screw plug from the DEF pump. Using a ¼ inch fine thread bolt to remove the pressure relief valve. Installing the new pressure relief valve into the DEF pump. Installing the screw plug. Attaching the DEF pump onto the bracket and DEF tank. Installing the DEF pump protective cover.</p> | |

IMPORTANT WARRANTY INFORMATION LETTER

Verify latest version on-line: Warranty Operation Letters are available at DDCSN.com> [Literature](#)> [Service Letters/Bulletins](#)> [Warranty Operations](#)

DISCLAIMER: The information contained in this letter supersedes and supplements any related policies and procedures in the Warranty Manual and/or previously released letters. Failure to read or distribute this letter will not exempt addressees from compliance with the information contained herein.

For questions, comments, or to submit an inquiry, go to
DDCSN.com> [Warranty](#)> [Warranty Applications](#)> [Inquiries](#)> [Submit an Inquiry](#)

ATS-DEF Pump Inlet Screen

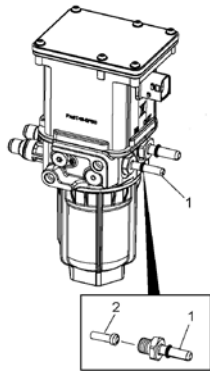

1. DEF Inlet Fitting
2. DEF Inlet Screen

| SRT Code | Description |
|---|--|
| 061509 | ATS-DEF PUMP INLET SCREEN - R&R |
| <p>Summary: Includes removing DEF Pump protective cover. Removing the DEF supply line and inlet fitting from the DEF pump. Removing the DEF pump inlet screen from the DEF pump. Installing a new DEF pump inlet screen. Installing the DEF inlet fitting and supply line. Installing the DEF pump protective cover.</p> | |

ATS-DEF Dosing Unit Screen

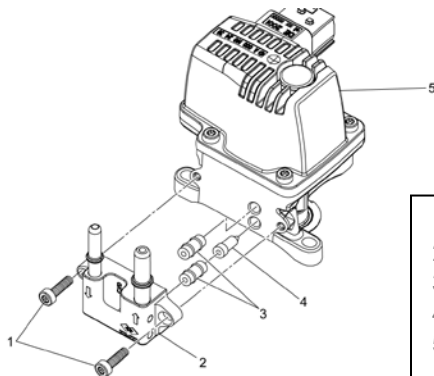

1. DEF Flange Bolts
2. DEF Flange
3. DEF Flange Connectors
4. DEF Dosing Unit Inlet Screen
5. DEF Dosing Unit

| SRT Code | Description |
|---|---|
| 061515 | ATS-DEF DOSING UNIT SCREEN - R&R |
| <p>Summary: Includes disconnecting the DEF inlet and outlet line from the dosing unit. Removing the DEF flange from the DEF dosing unit. Removing the inlet screen. Installing a new inlet screen and DEF flange connectors. Installing the flange onto the DEF dosing unit and reconnecting the lines.</p> <p>Notes:</p> <ul style="list-style-type: none"> • Removing the DEF dosing unit from the ATS is not required • Includes removing the chassis side fairing and/or heat shield, if equipped | |

IMPORTANT WARRANTY INFORMATION LETTER

Verify latest version on-line: [Warranty Operation Letters](http://DDCSN.com) are available at DDCSN.com> [Literature](#)> [Service Letters/Bulletins](#)> [Warranty Operations](#)

DISCLAIMER: The information contained in this letter supersedes and supplements any related policies and procedures in the Warranty Manual and/or previously released letters. Failure to read or distribute this letter will not exempt addressees from compliance with the information contained herein.

For questions, comments, or to submit an inquiry, go to
DDCSN.com> [Warranty](#)> [Warranty Applications](#)> [Inquiries](#)> [Submit an Inquiry](#)

ATS–DEF Dosing System Kit

| SRT Code | Description |
|---|---|
| 06 1520 | ATS–DEF DOSING SYSTEM KIT (DEF/DOSER KIT) - R&R |
| <p>Summary: Includes replacing the DEF pump main filter, DEF pump inlet screen, DEF pump pressure relief valve, and DEF dosing unit inlet screen.</p> <p>Notes:</p> <ul style="list-style-type: none"> • Removing the DEF dosing unit from the ATS is not required • Includes removing the chassis side fairing and/or heat shield, if equipped | |

ATS–After Treatment Device Harness (One Box)

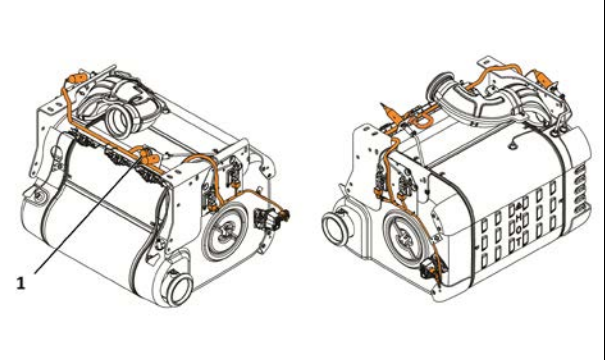
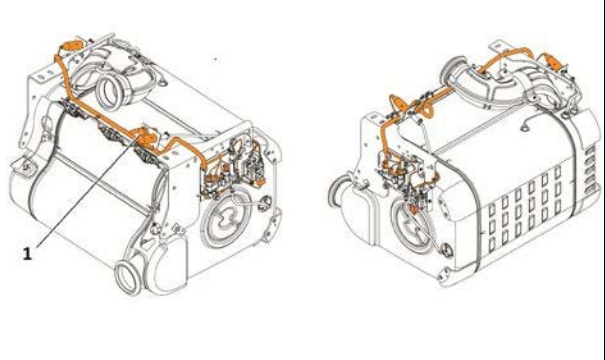
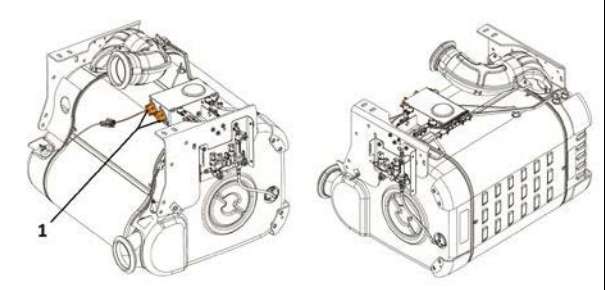
| | |
|---|---|
|  | <div style="border: 1px solid black; padding: 5px; width: fit-content; margin: 0 auto;"> 1. After Treatment Device Harness One Box, GHG14 </div> |
|  | <div style="border: 1px solid black; padding: 5px; width: fit-content; margin: 0 auto;"> 1. After Treatment Device Harness One Box without sensor box, EPA10 </div> |
|  | <div style="border: 1px solid black; padding: 5px; width: fit-content; margin: 0 auto;"> 1. After Treatment Device Harness One Box with sensor box, EPA10 </div> |

IMPORTANT WARRANTY INFORMATION LETTER

Verify latest version on-line: [Warranty Operation Letters](http://DDCSN.com) are available at DDCSN.com> [Literature](#)> [Service Letters/Bulletins](#)> [Warranty Operations](#)

DISCLAIMER: The information contained in this letter supersedes and supplements any related policies and procedures in the Warranty Manual and/or previously released letters. Failure to read or distribute this letter will not exempt addressees from compliance with the information contained herein.

For questions, comments, or to submit an inquiry, go to
DDCSN.com> [Warranty](#)> [Warranty Applications](#)> [Inquiries](#)> [Submit an Inquiry](#)

| SRT Code | Description |
|--|---|
| 06 1300 | ATS—AFTER TREATMENT DEVICE HARNESS (ONE BOX) – R&R |
| <p>Summary: Includes gaining access the One Box. Disconnecting the harness connectors. Removing the harness and installing the after treatment device harness.</p> <p>Notes:</p> <ul style="list-style-type: none"> • Includes removing the chassis side fairing and/or heat shield, if equipped • The configuration of the after treatment device can be identified in the Detroit Warranty System under major components | |

ATS—After Treatment Device Harness (Two Box)

| SRT Code | Description |
|--|---|
| 06 1320 | ATS—AFTER TREATMENT DEVICE HARNESS (TWO BOX) – R&R |
| <p>Summary: Includes gaining access the DOC/DPF and/or SCR. Disconnecting the harness connectors. Removing the harness and installing the after treatment device harness.</p> <p>Notes:</p> <ul style="list-style-type: none"> • Includes removing the chassis side fairing and/or heat shield, if equipped. • The configuration of the after treatment device can be identified in the Detroit Warranty System under major components | |

DOC Face Plug Cleaning Routine

| SRT Code | Description |
|---|--|
| 062640 | DOC FACE PLUG CLEANING ROUTINE – GHG 14 |
| <p>Summary: Includes the necessary time to complete the DOC face plug cleaning routine</p> <p>Notes:</p> <ul style="list-style-type: none"> • Does not include programming control modules if required | |

IMPORTANT WARRANTY INFORMATION LETTER

Verify latest version on-line: [Warranty Operation Letters](http://DDCSN.com) are available at DDCSN.com> [Literature](#)> [Service Letters/Bulletins](#)> [Warranty Operations](#)

DISCLAIMER: The information contained in this letter supersedes and supplements any related policies and procedures in the Warranty Manual and/or previously released letters. Failure to read or distribute this letter will not exempt addressees from compliance with the information contained herein.