

TECHNICAL INSTRUCTIONS

FOR

SPECIAL SERVICE CAMPAIGN H0P

YARIS INSTRUMENT PANEL WIRE HARNESS

CERTAIN 2017 MY YARIS M/T (With Immobilizer)

The repair quality of covered vehicles is extremely important to Toyota. All dealership technicians performing this recall are required to successfully complete the most current version of the E-Learning course “Safety Recall and Service Campaign Essentials”. To ensure that all vehicles have the repair performed correctly; technicians performing this recall repair are required to currently hold at least one of the following certification levels:

- Certified Technician (Electrical)
- Expert Technician (Any Specialty)
- Master Technician
- Master Diagnostic Technician

It is the dealership’s responsibility to select technicians with the above certification level or greater to perform this recall repair. Carefully review your resources, the technician skill level, and ability before assigning technicians to this repair. It is important to consider technician days off and vacation schedules to ensure there are properly trained technicians available to perform this repair at all times.

I. OPERATION FLOW CHART

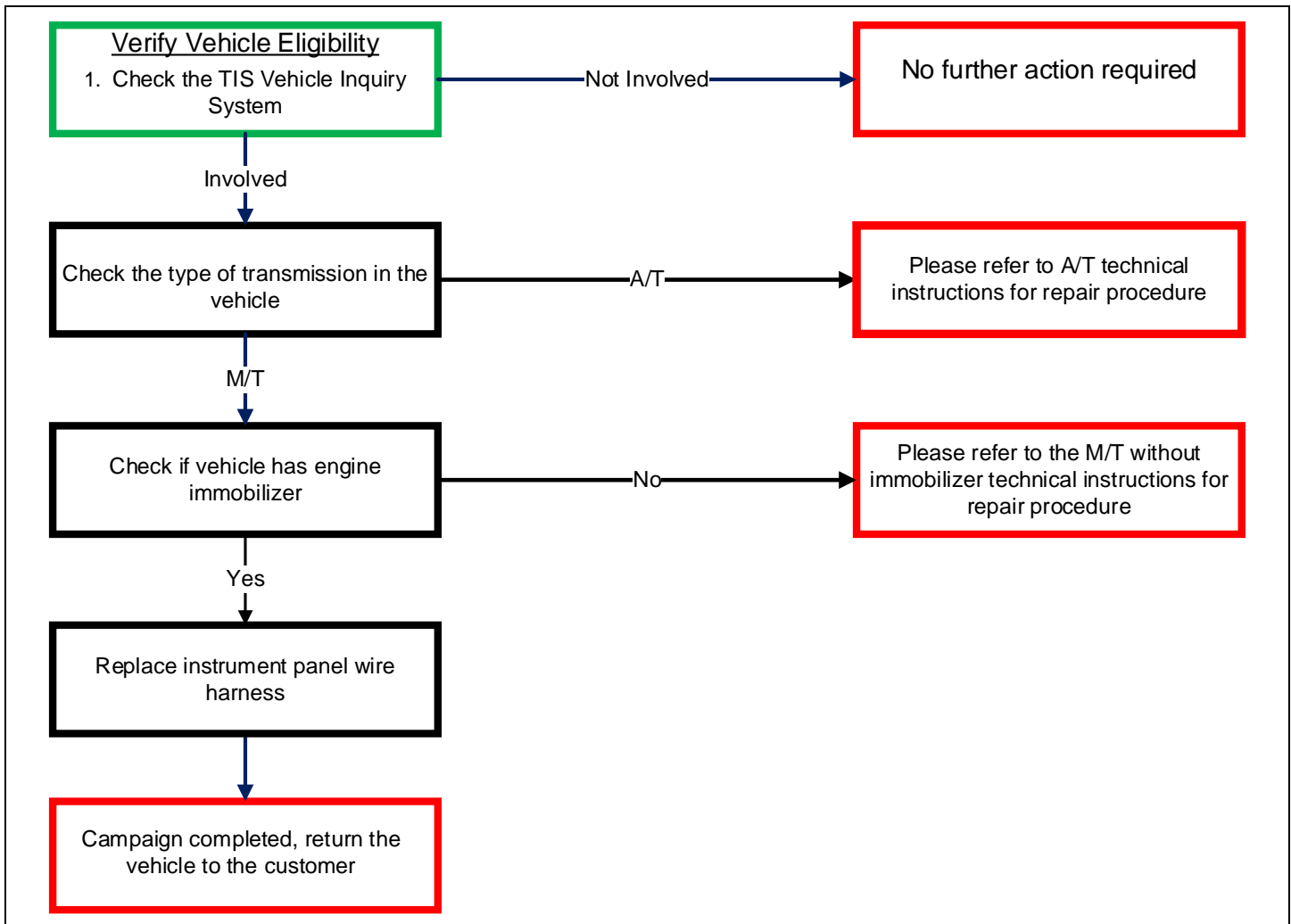

II. IDENTIFICATION OF AFFECTED VEHICLES

- Check the TIS Vehicle Inquiry System to confirm the VIN is involved in this Safety Recall, and that the Campaign has not already been completed prior to dealer shipment or by another dealer.
- TMS warranty will not reimburse dealers for repairs completed on vehicles that are not affected or were completed by another dealer.

ONLY THE TWO VINs SHOWN IN THE TABLE BELOW ARE APPLICABLE TO THIS REPAIR PROCEDURE

VINs	
VNKKTUD34HA072893	VNKKTUD3XHA073367

III. PREPARATION

A. PARTS

Part Number	Part Description	Quantity
04007-5910U	WIRE KIT, INSTRUMENT PANEL	1
90099-14119	A/C O-Ring	1
90099-14121		1

B. TOOLS & EQUIPMENT

- Techstream
- Protective Gloves
- Standard Hand Tools
- Refrigerant Recovery Unit
- Torque Wrench

SST – These Special Service Tools required for this repair:

Part Number	Tool Name	Quantity
09950-50013	UNIVERSAL PULLER SET "C"	1
*The set above includes the following tools needed for the repair:		
09951-05010	HANGER 150	1
09952-05010	SLIDE ARM	2
09953-05020	CENTER BOLT 100	1
09954-05021	CENTER BOLT 150	1

C. MATERIALS

- Protective Tape
- Marker Pen

IV. BACKGROUND

In the subject vehicles, an incorrect instrument panel wire harness may have been installed during the vehicle assembly process. The incorrect instrument panel wire harness may not be compatible with the Pre-Collision system front sensor. As a result, the Automatic High Beam and Pre-Collision system may be inoperative

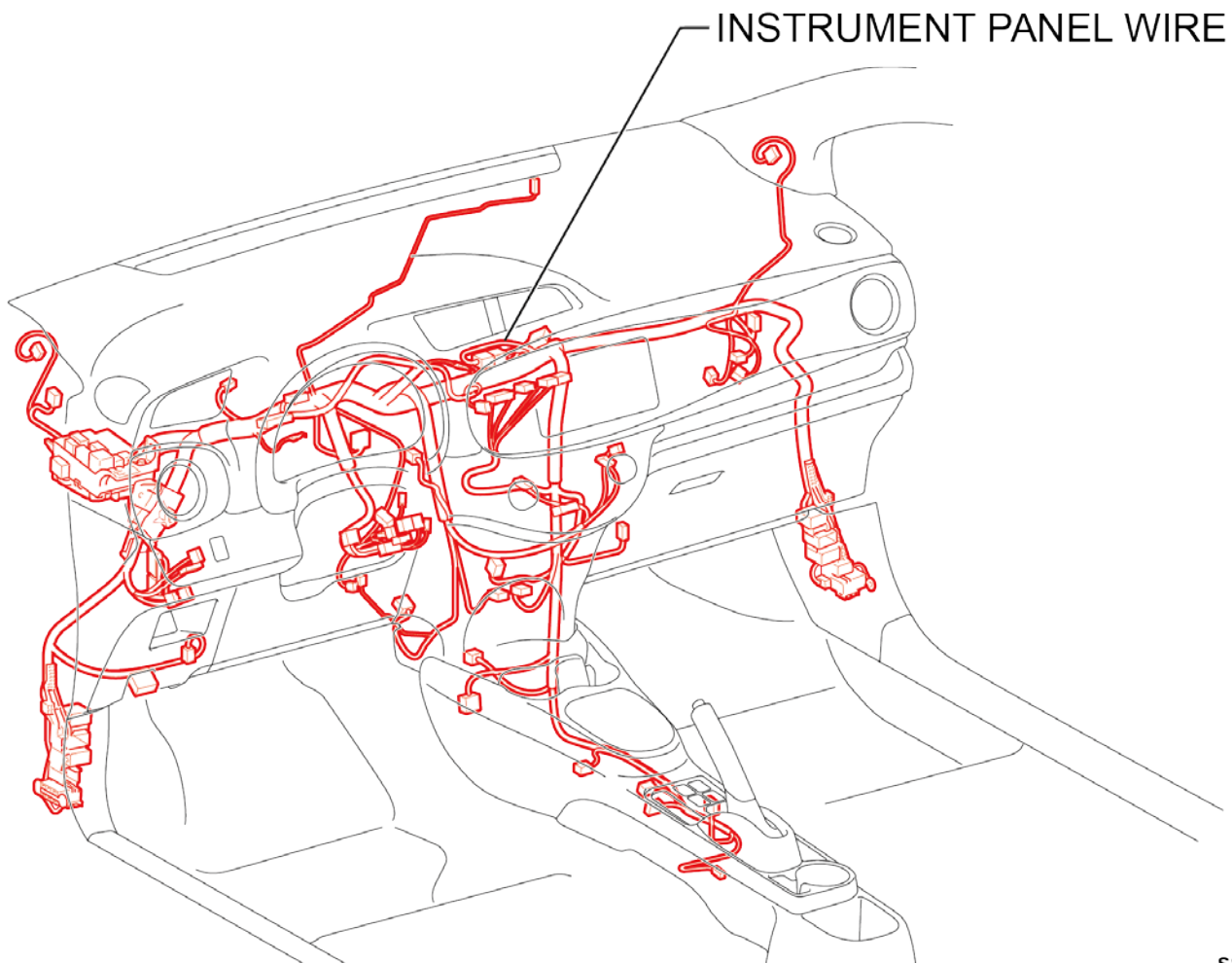

S86

V. WORK PROCEDURE

A. COMPONENTS

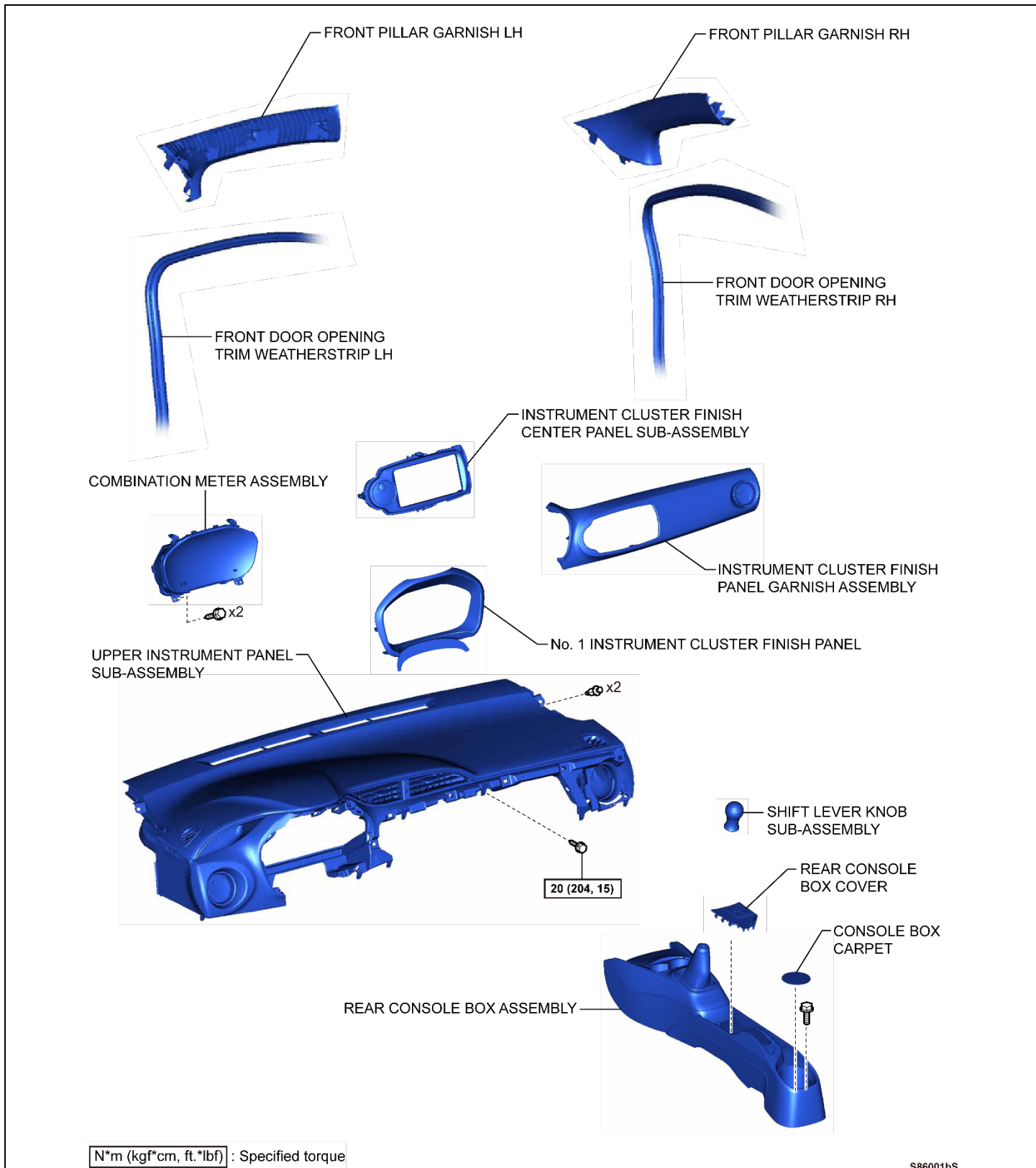

STEREO OPENING COVER WITH BRACKET



LOWER INSTRUMENT PANEL SUB-ASSEMBLY

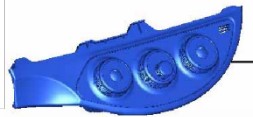

AIR CONDITIONING PANEL ASSEMBLY

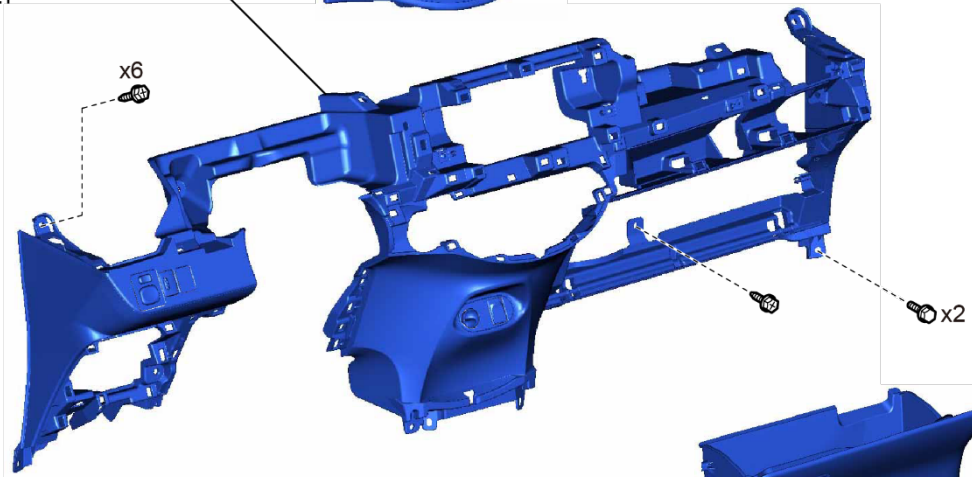

HOOD LOCK CONTROL LEVER SUB-ASSEMBLY



LOWER STEERING COLUMN COVER

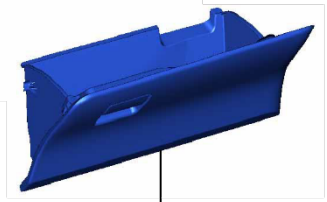
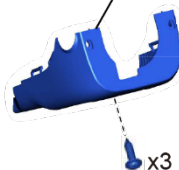

GLOVE COMPARTMENT DOOR ASSEMBLY

LOWER No. 2 INSTRUMENT PANEL FINISH PANEL

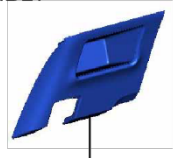

x3

No. 2 INSTRUMENT PANEL UNDER COVER SUB-ASSEMBLY



10 (102, 7)

x4

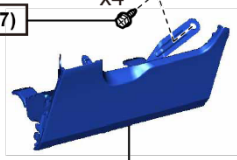

LOWER No. 1 INSTRUMENT PANEL AIRBAG ASSEMBLY

COWL SIDE TRIM BOARD RH

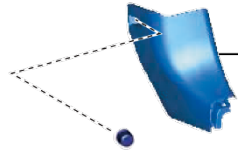

COWL SIDE TRIM BOARD LH



FRONT DOOR SCUFF PLATE RH



FRONT DOOR SCUFF PLATE LH



No. 1 INSTRUMENT PANEL UNDER COVER SUB-ASSEMBLY

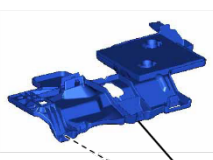

x2

N*m (kgf*cm, ft.*lbf) : Specified torque

S86002aS

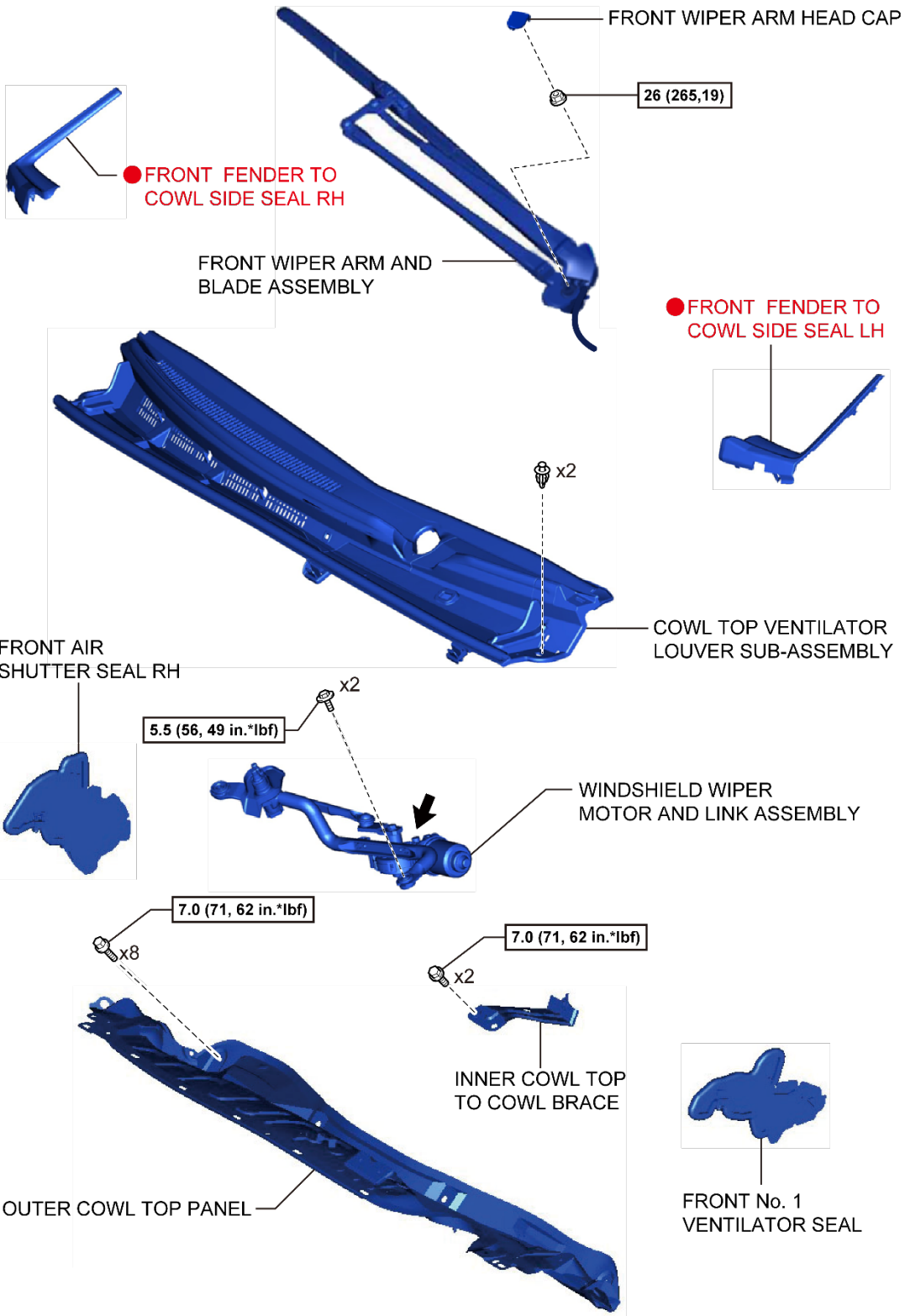

← : MP grease

N*m (kgf*cm, ft.*lbf) : Specified torque

S86040bS

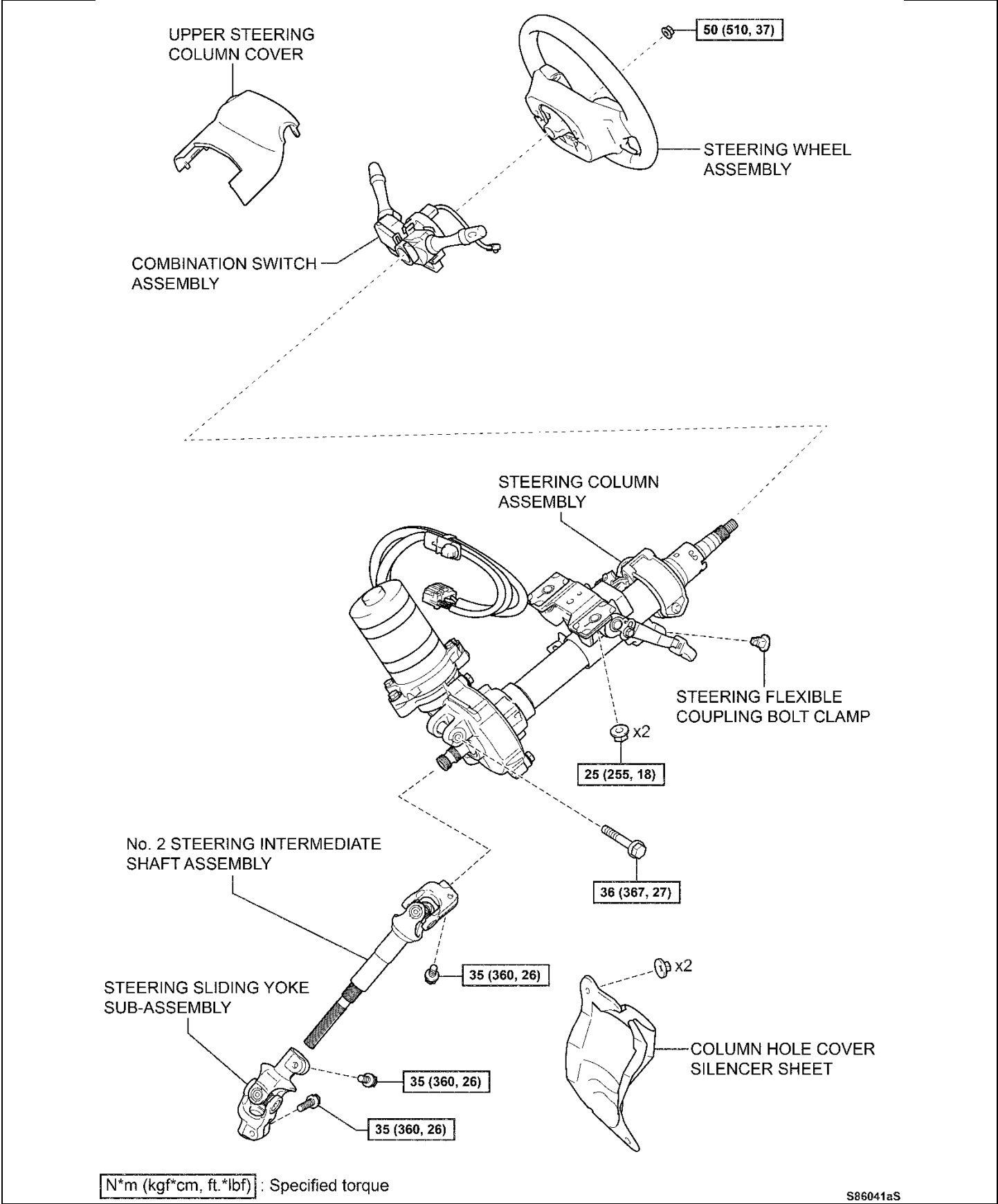

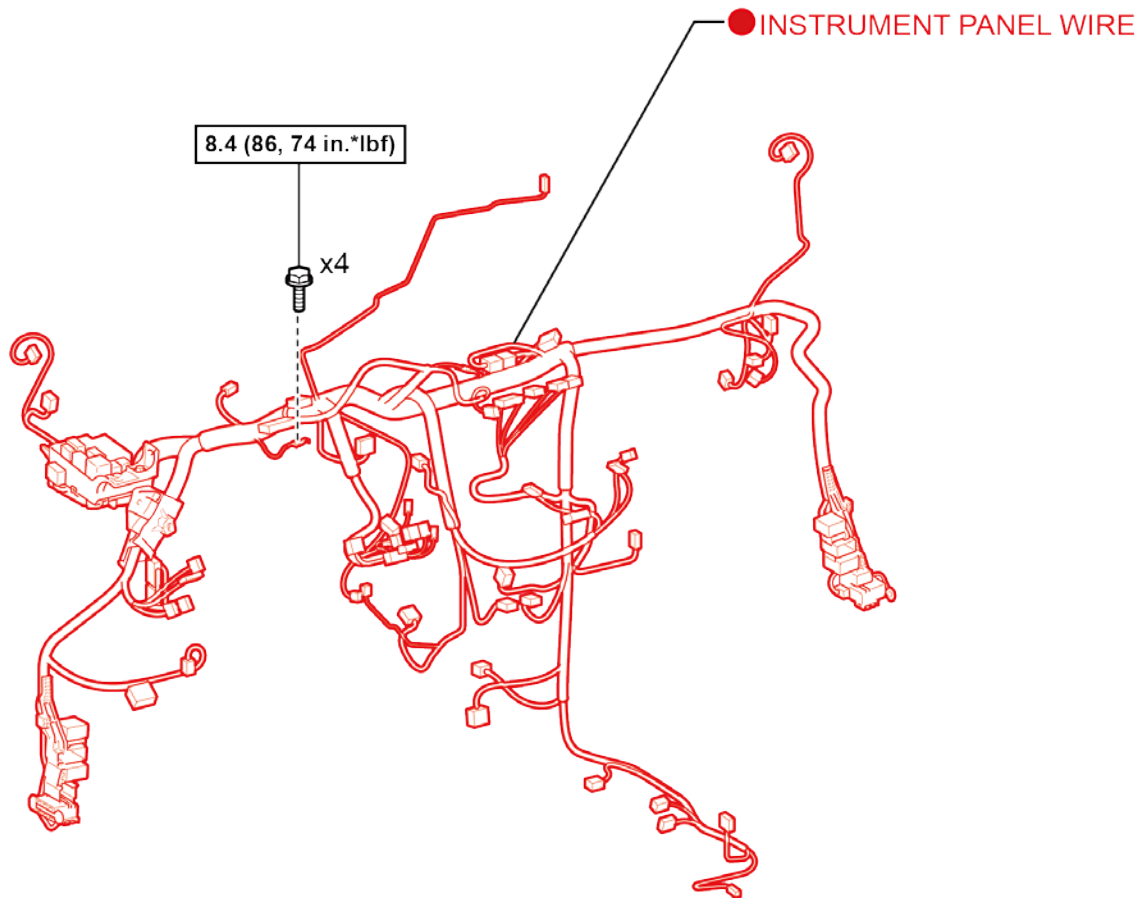

● : Component to be replaced

N*m (kgf*cm, ft.*lbf) : Specified torque

S86008aS

VI. REMOVE INSTRUMENT PANEL WIRE HARNESS

1. PLACE FRONT WHEELS FACING STRAIGHT AHEAD
2. CHECK FOR DTC's
 - a. If a DTC(s) is displayed, record the DTC(s) and the freeze frame data and perform the repairs as necessary
3. RECORD AUDIO AND AIR CONDITIONING SETTINGS
 - a. When the battery cable is disconnected, the settings for the audio, air conditioning, etc. may be reset. Therefore, make a note of the settings before disconnecting the cable from the negative (-) battery terminal
4. RECOVER REFRIDGERANT FROM THE REFRIGERATION SYSTEM
[Refer to TIS for instructions on Vehicle Interior / HEATING/AIR CONDITIONING / REFRIGERANT \(for Hatchback\) / REPLACEMENT](#)
5. DRAIN ENGINE COOLANT
6. DISCONNECT CABLE FROM NEGATIVE BATTERY TERMINAL



For models with a navigation system, wait at least 6 minutes before disconnecting the battery. It takes approximately 6 minutes for the system to save information and settings after the ignition switch is turned off.



7. WEAR PROTECTIVE GLOVES



Be sure to wear protective gloves. Sharp edges on components such as burrs may injure your hands.

8. REMOVE FRONT WIPER ARM HEAD CAP

a. Use a screwdriver with its tip wrapped in tape to disengage the 3 claws and remove the front wiper arm head cap

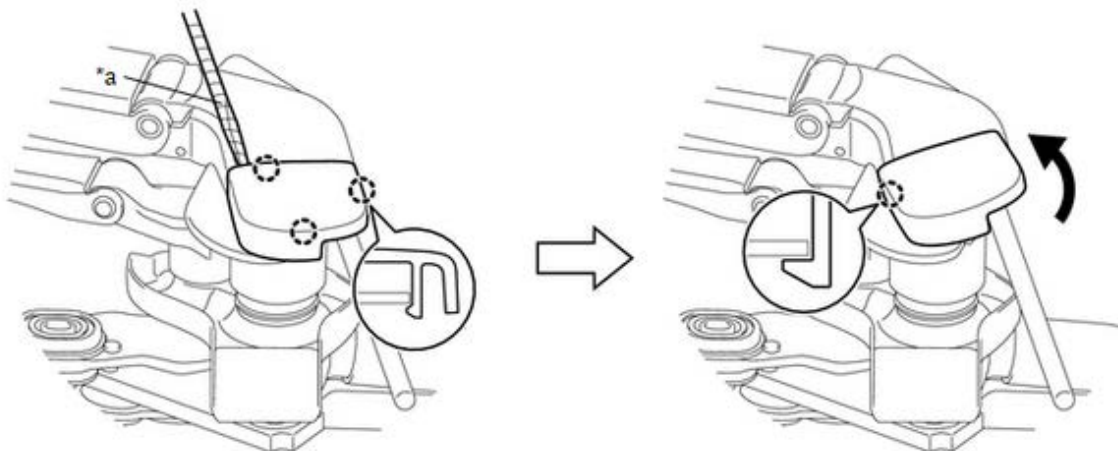

9. REMOVE FRONT WIPER ARM AND BLADE ASSEMBLY

a. Disconnect the washer hose

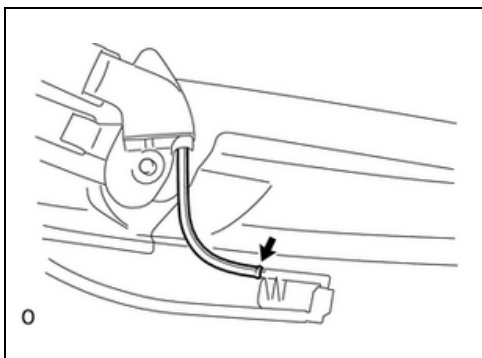

b. Remove the nut and the front wiper main arm

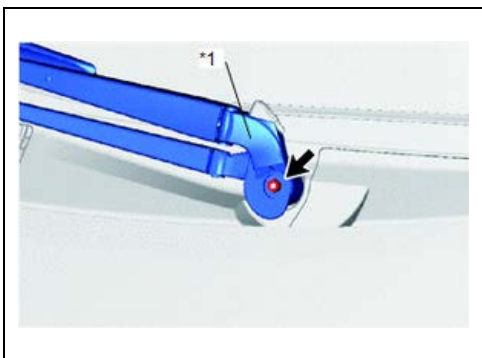

*1	Front wiper main arm
----	----------------------

c. Apply protective tape to the areas shown in the illustration

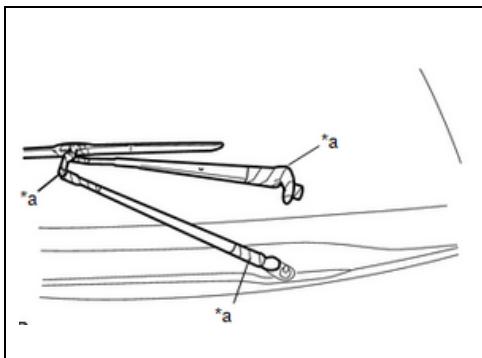

*a	Protective Tape
----	-----------------

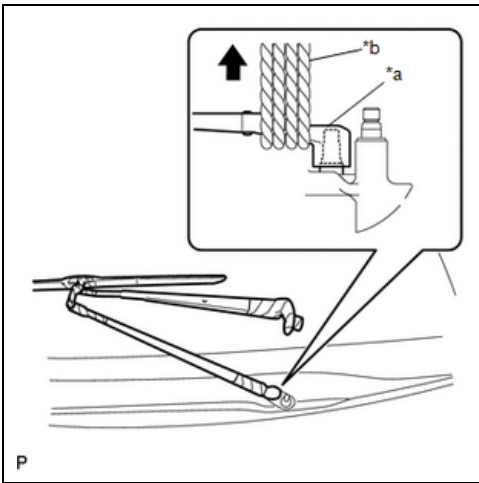

d. Twist a rope around the front wiper sub arm and pull the rope upward to disengage and remove the front wiper arm blade assembly

*a	Head of the front wiper sub arm
*b	Rope



-If you forcibly remove the wiper arm it could be damaged
-If you forcibly pry off the wiper arm or the joint it could be damaged

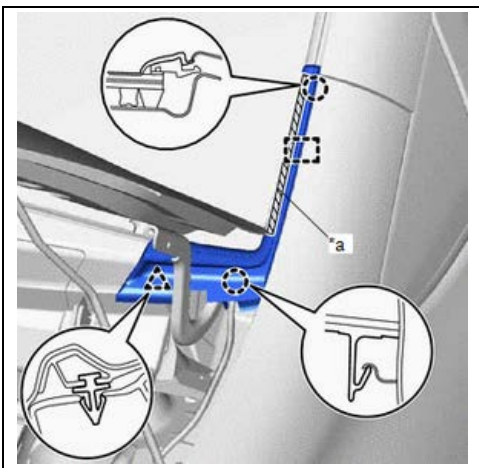

10. DISENGAGE THE END OF THE FRONT FENDER TO COWL SIDE SEAL RH / LH

a. Disengage the clip and claw at the bottom of the front fender to cowl side seal

*a	Double-sided tape
----	-------------------



Do NOT separate the double sided tape the upper portion of the front fender to cowl side seal. If removed it will require replacement.

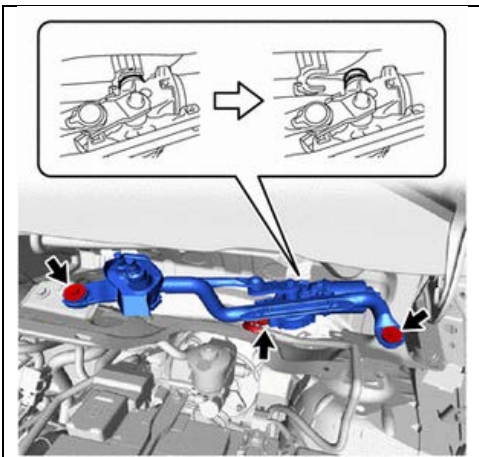

11. REMOVE THE WINDSHIELD WIPER MOTOR AND LINK ASSEMBLY

a. Remove the 2 bolts
 b. Disengage the grommet as shown in the illustration
 c. Disconnect the connector to remove the windshield wiper motor and link assembly

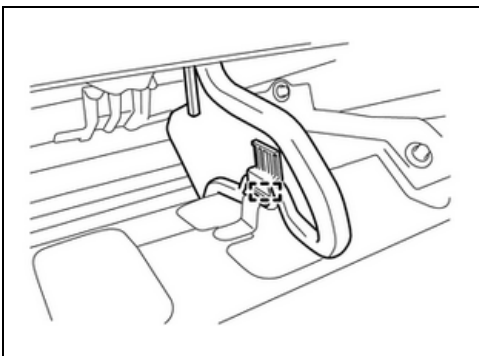

12. REMOVE THE FRONT NO.1 VENTILATOR SEAL

a. Disengage the clamp and to remove the No.1 ventilator seal

13. REMOVE THE FRONT AIR SHUTTER SEAL RH

a. Disengage the clamp and remove the air shutter seal RH

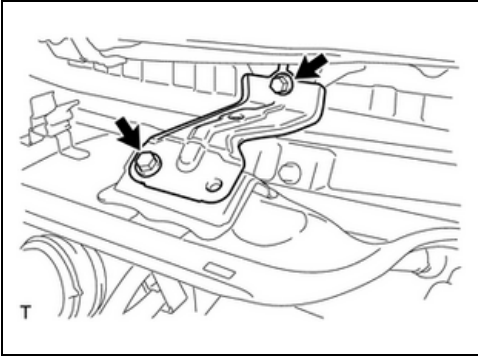

- 14. REMOVE THE INNER COWL TOP TO COWL BRACE**
 a. Remove the 2 bolts and the inner cowl top to cowl brace

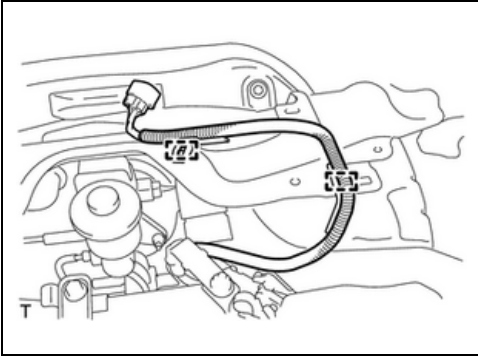

- 15. REMOVE THE OUTER COWL TOP PANEL**
 a. Disengage the 2 clamps and separate the wire harness

- b. Remove the 8 bolts and the outer cowl top panel

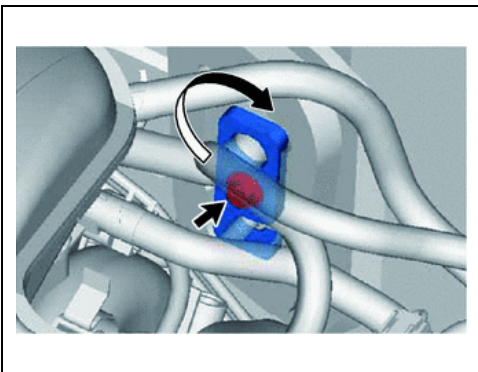
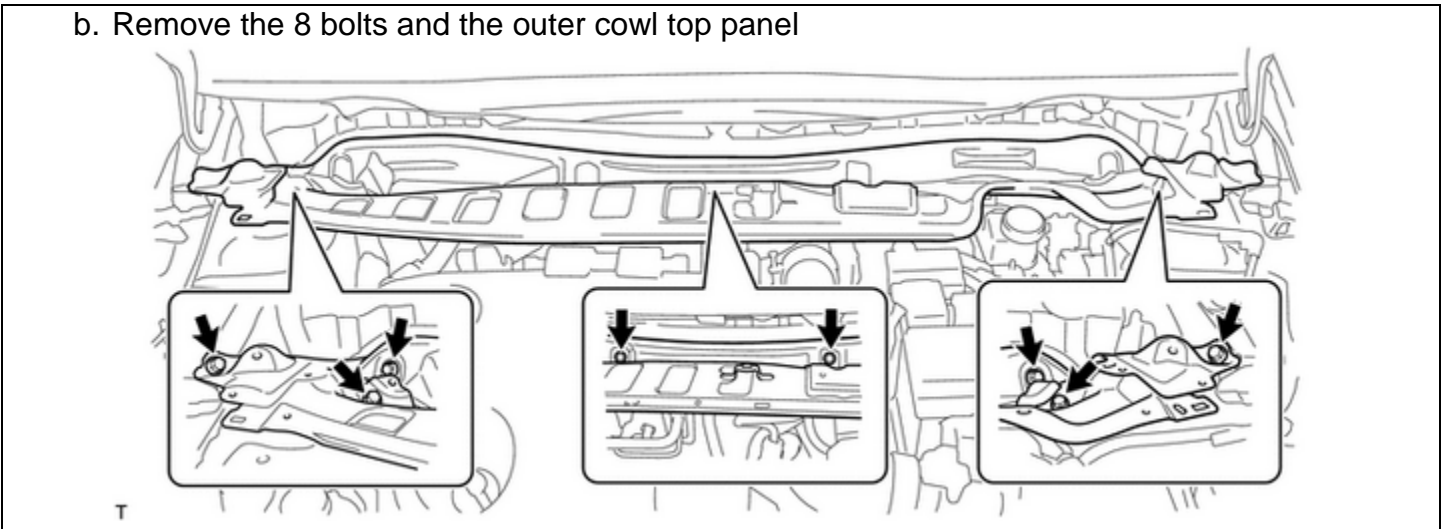

- 16. DISCONNECT AIR CONDITIONER TUBE AND ACCESSORY ASSEMBLY**
 a. Remove the bolt
 b. Turn the hook connector clockwise and disconnect the air conditioner tube and liquid tube
 c. Remove the O-ring from the air conditioner tube and liquid tube

NOTE: Seal the openings of the disconnected parts using vinyl tape to prevent the entry of moisture and foreign matter

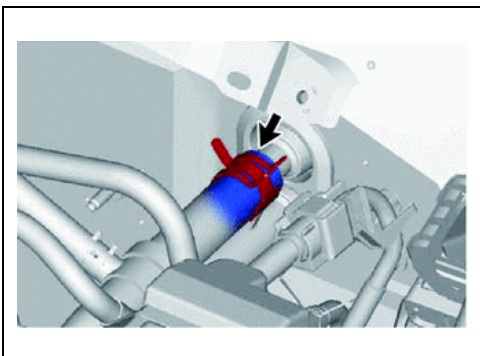

- 17. DISCONNECT THE HEATER WATER OUTLET HOSE A**
- a. Slide the clip and disconnect the heater water outlet hose from the air conditioning unit

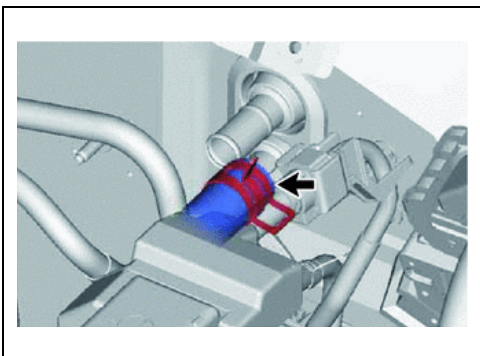

- 18. DISCONNECT THE HEATER WATER INLET HOSE A**
- a. Slide the clip and disconnect the heater water inlet hose from the air conditioning unit

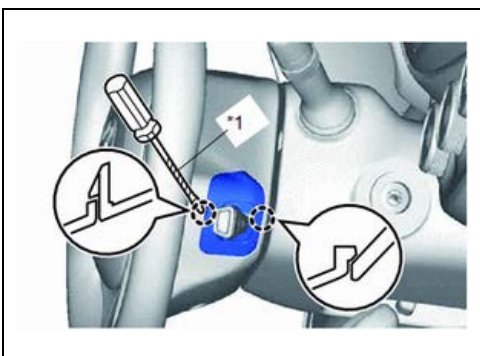

- 19. REMOVE LOWER NO.2 STEERING WHEEL COVER**
- a. Using a screwdriver with its tip wrapped with protective tape, disengage the 2 claws and remove the lower No.2 steering wheel cover

*1	Protective Tape
----	-----------------

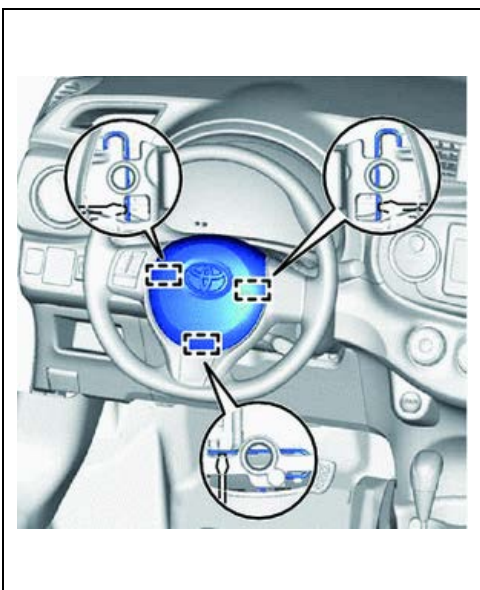

- 20. REMOVE THE STEERING PAD**
- a. Check that the ignition switch is off
 - b. Check that the cable is disconnected from the negative (-) battery terminal



Wait at least 90 seconds after disconnecting the cable from the negative (-) battery terminal to disable the SRS system

- c. Using a "TORX" driver, push in the 3 snap rings to disengage it from the 3 pins
- d. Pull the steering pad towards the rear

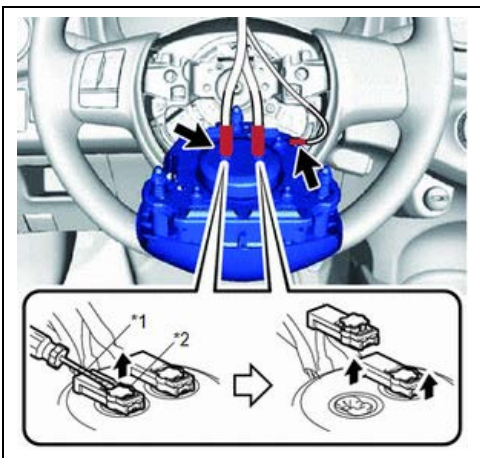

- e. Using a screwdriver with its tip wrapped with protective tape, release the 2 locking buttons.
- f. Disconnect the 2 airbag connectors

*1	Protective Tape
*2	Locking button

- g. Disconnect the horn terminal

21. REMOVE STEERING WHEEL ASSEMBLY

- a. Remove the steering wheel assembly set nut.
- b. Put matchmarks on the steering wheel assembly and the top of the steering main shaft

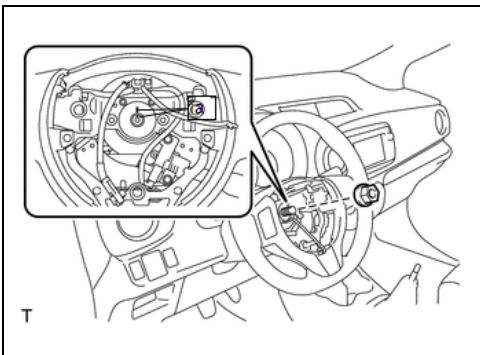

*a	Matchmark
----	-----------

- c. Disconnect the connectors from the spiral cable sub-assembly

- d. Using SST: **09950-50013**, remove the steering wheel assembly

NOTE: Apply a small amount of grease to the threads and tip of the SST (center bolt) before use

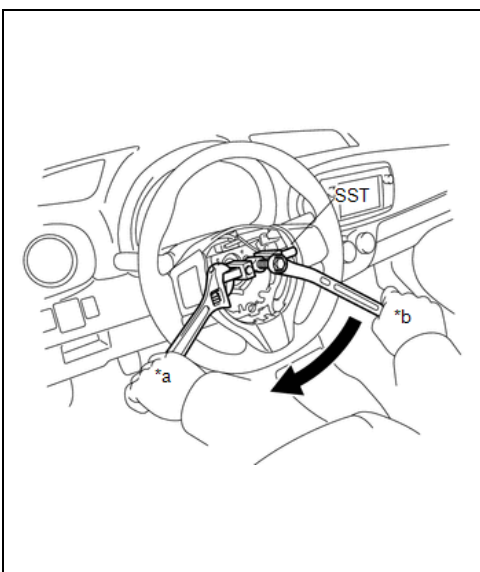

*a	Hold
*b	Turn

NOTE: You will need the following tools from SST kit number **09950-50013**

- 09951-05010
- 09952-05010
- 09953-05020
- 09954-05021

22. REMOVE THE LOWER STEERING COLUMN COVER

- a. Remove the 3 screws

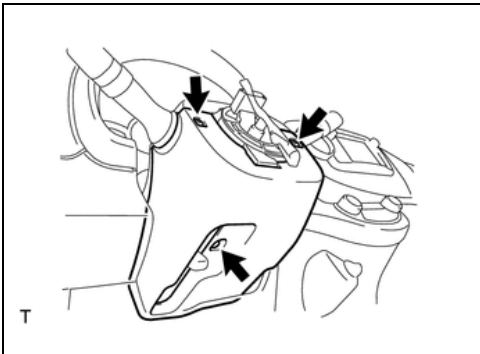

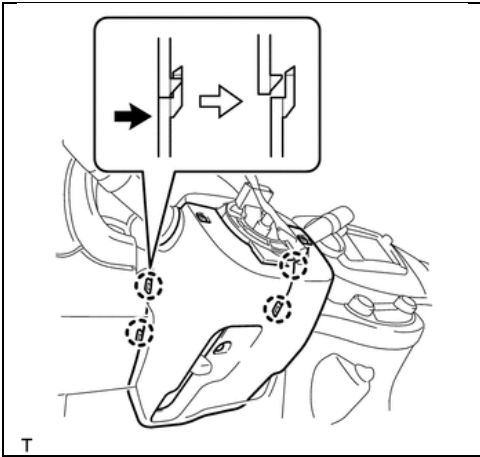

- b. Disengage the 4 claws and remove the lower steering column cover

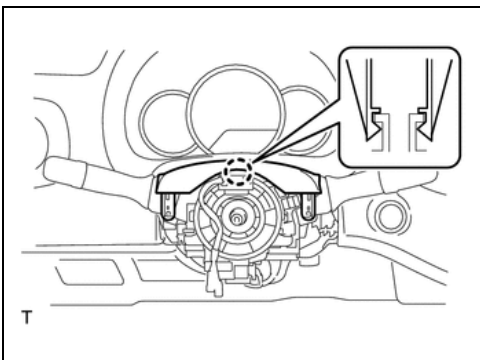

23. REMOVE UPPER STEERING COLUMN COVER

- a. Disengage the claw and remove the upper steering column cover.

24. SEPARATE FRONT DOOR OPENING TRIM WEATHERSTRIP RH AND LH

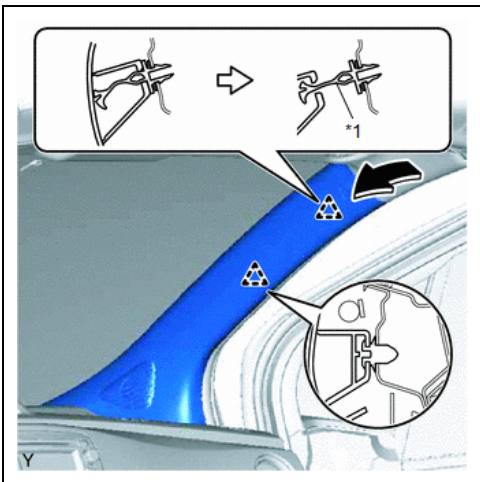

25. REMOVE FRONT PILLAR GARNISH RH

- a. Disengage the front pillar garnish clips

NOTE: The front pillar garnish clip should remain between the front pillar garnish and the pillar

*1	Front Pillar Garnish Clip
----	---------------------------

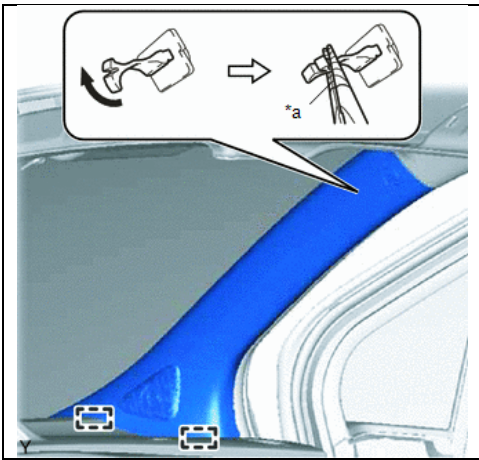

- b. Using needle nose pliers with its tip wrapped in tape, turn the front pillar garnish clip 90° and disengage it from the front pillar garnish

*a	Protective Tape
----	-----------------

NOTE: Do NOT remove the front pillar garnish clip from the vehicle as long as it is not damaged. If removed, the front pillar garnish clip will require replacement.

- c. Disengage the 2 guides to remove the front pillar garnish

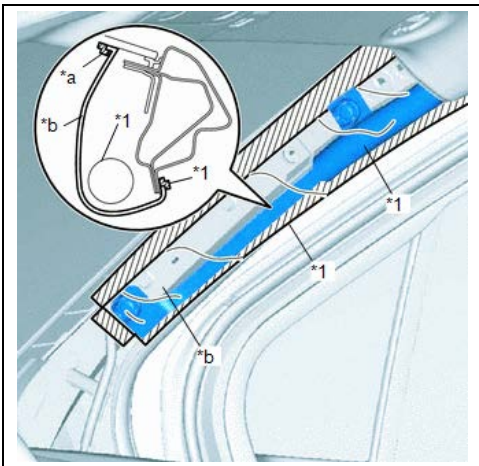

- d. Disconnect the connector for the speaker (w / 6 speakers)
 e. Protect the curtain shield airbag assembly by covering it with a cloth or piece of nylon and secure the ends of the cover with tape as shown in the illustration.

*1	Curtain Shield Airbag Assembly
*a	Adhesive Tape
*b	Protective Cover

26. REMOVE THE FRONT PILLAR GARNISH LH

- a. Use the same procedure as the RH side

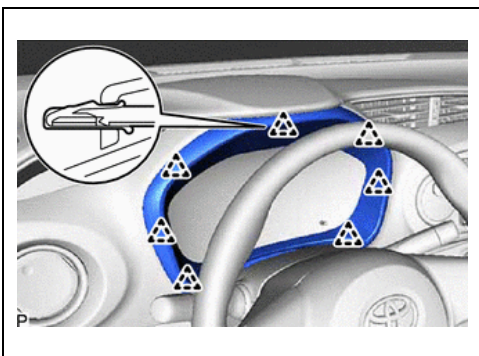

27. REMOVE NO. 1 INSTRUMENT CLUSTER FINISH PANEL

- a. Disengage the 7 clips to remove the No.1 instrument cluster finish panel

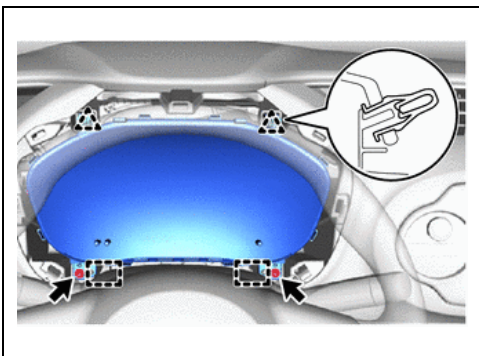

28. REMOVE THE COMBINATION METER ASSEMBLY

- a. Remove the 2 screws
 b. Disengage the 2 clips and 2 guides
 c. Disconnect the 2 connectors to remove the combination meter assembly

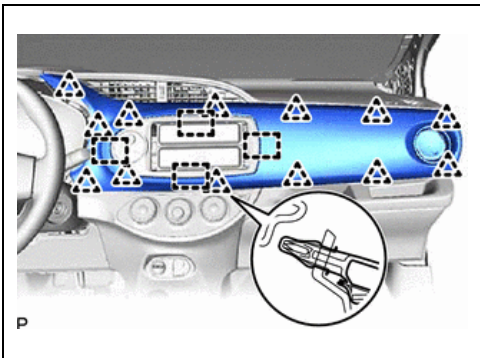

29. REMOVE THE INSTRUMENT CLUSTER FINISH PANEL GARNISH ASSEMBLY

- a. Disengage the 13 clips and 4 guides to remove the instrument cluster finish panel garnish assembly

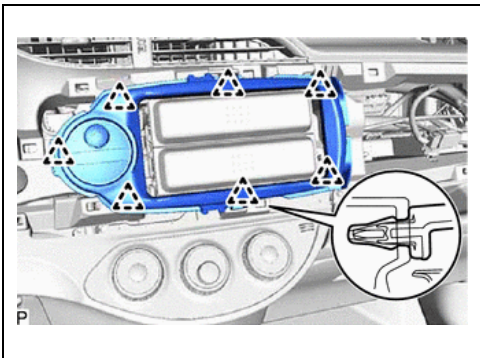

30. REMOVE INSTRUMENT CLUSTER FINISH CENTER PANEL SUB-ASSEMBLY

- a. Disengage the 7 clips
- b. Disconnect the connector to remove the instrument cluster finish center panel sub-assembly

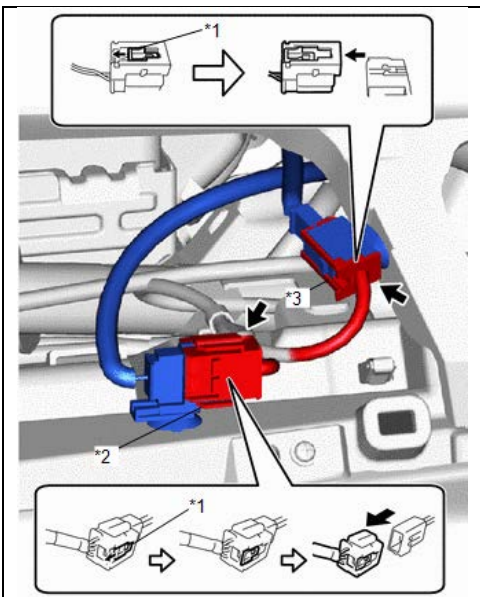

31. REMOVE INSTRUMENT PANEL SUB-ASSEMBLY

- a. Slide the slider and disconnect the front passenger airbag connector
- b. Slide the slider and disconnect the vent hole connector

*1	Slider
*2	Airbag Connector
*3	Vent Hole Connector

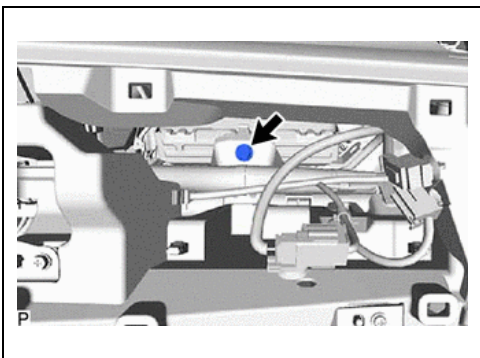

- c. Remove the bolt

- d. Disengage the clamps
- e. Disconnect the connectors
- f. Remove the 2 clips
- g. Disengage the 8 clips while lifting the rear instrument panel up
- h. While lifting the instrument panel, slide it toward the rear of the vehicle. Disengage the 5 guides of the front side of the instrument panel to remove the upper instrument panel

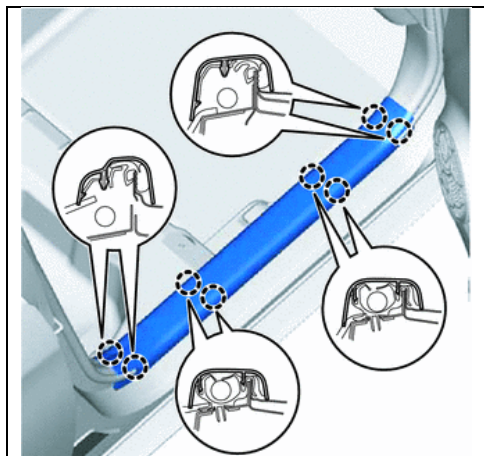
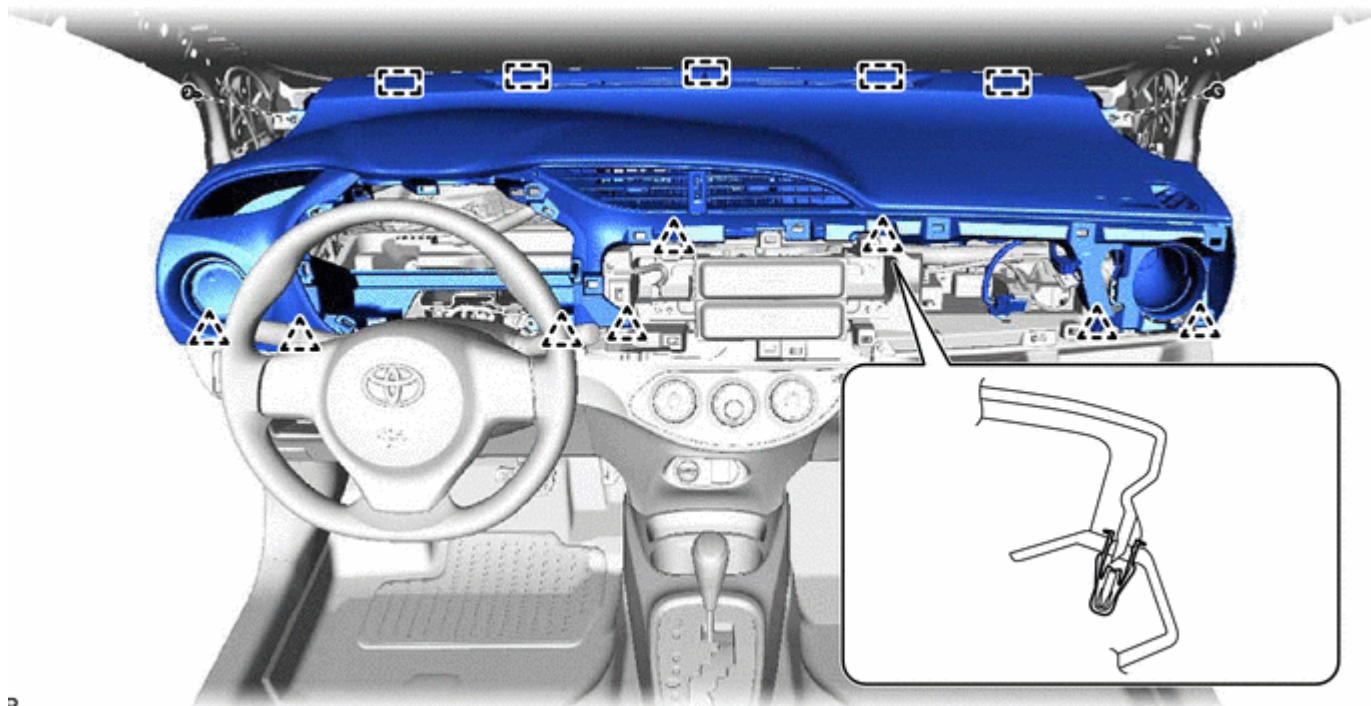

32. REMOVE FRONT DOOR SCUFF PLATE RH

- a. Disengage the 8 claws to remove the front door scuff plate RH

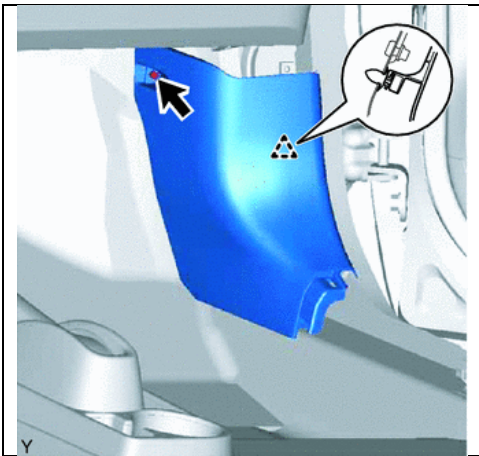

33. REMOVE COWL SIDE TRIM BOARD RH

- a. Remove the clip
- b. Disengage the clip to remove the cowl side trim board RH

34. REMOVE FRONT DOOR SCUFF PLATE LH

- a. Use same procedure as RH side

35. REMOVE COWL SIDE TRIM BOARD LH

- a. Use the same procedure as RH side

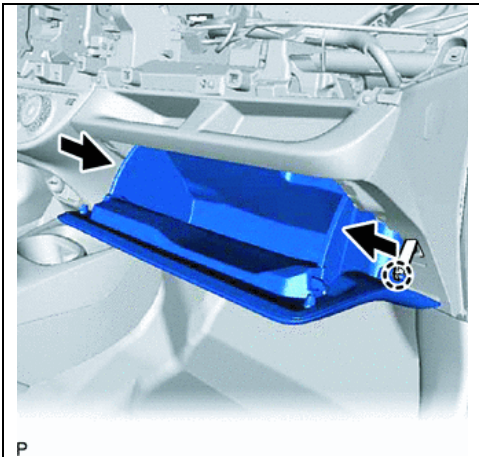

36. REMOVE GLOVE COMPARTMENT DOOR ASSEMBLY

- a. Disengage the claw to separate the glove compartment door stopper from the glove compartment door
- b. Slightly flex the upper part of the glove compartment door to release the 2 stoppers and open the glove compartment door until it is horizontal

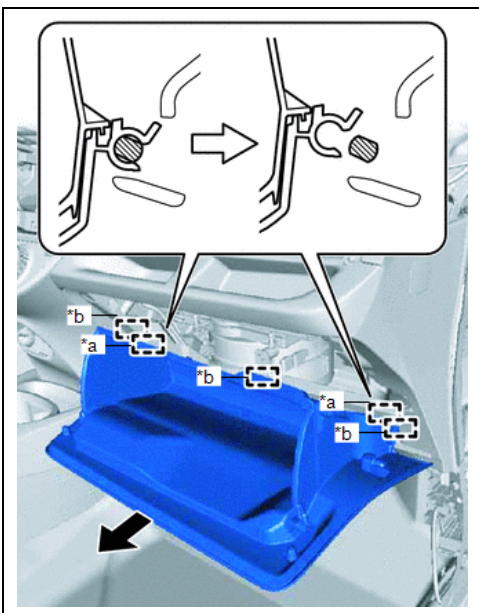

- c. Pull the glove compartment door out horizontally to disengage the 2 hinges and 3 guides to remove the glove compartment door

*a	Hold
*b	Turn

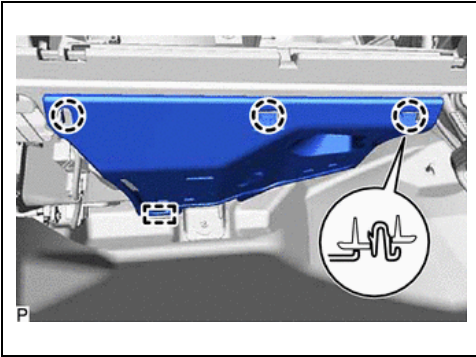

37. REMOVE NO.2 INSTRUMENT PANEL UNDER COVER SUB-ASSEMBLY

- a. Disengage the 3 claws and guide to remove the No. 2 instrument panel under cover
- b. (w/ Footwell Light) Disconnect the connector

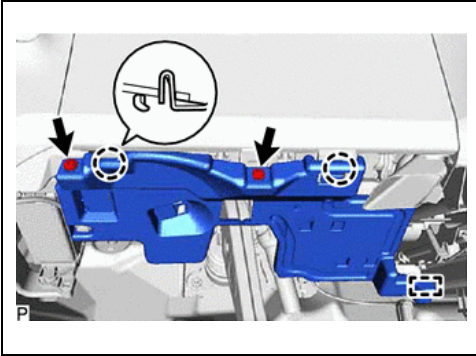

38. REMOVE THE NO.1 INSTRUMENT PANEL UNDER COVER SUB-ASSEMBLY

- a. Remove the 2 <A> screws
- b. Disengage the 2 claws and guide to remove the No. 1 instrument panel under cover sub-assembly
- c. (w/ Footwell Light) Disconnect the connector

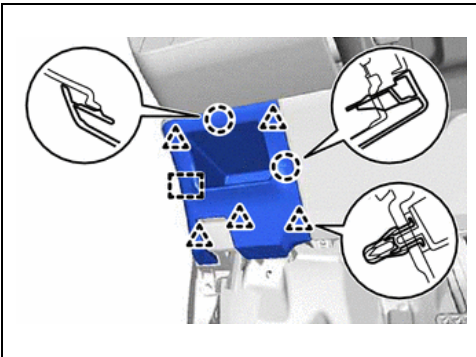

39. REMOVE THE LOWER NO.2 INSTRUMENT PANEL FINISH PANEL

- a. Disengage the 5 clips, 2 claws and guide to remove the No.2 instrument panel finish panel

NOTE: The number of clips varies depending on vehicle options

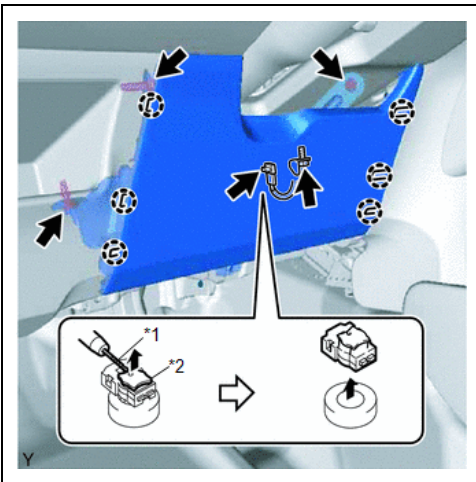

40. REMOVE THE LOWER NO.1 INSTRUMENT PANEL AIRBAG ASSEMBLY

- a. Remove the 4 bolts
- b. Disengage the 6 claws to separate the lower No.1 instrument panel airbag assembly
- c. Using a screwdriver with its tip wrapped in protective tape, release the locking button
- d. Disconnect the airbag connector to remove the lower No.1 instrument panel airbag assembly

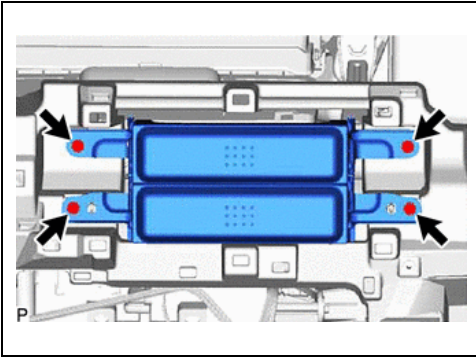

41. REMOVE THE STEREO

- a. Remove the 4 screws and stereo
- b. Disconnect the connectors behind the stereo

NOTE: Depending on the vehicle options there will be a various number of connectors located behind the stereo

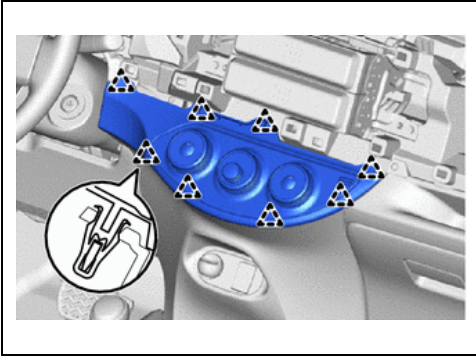

42. SEPARATE THE AIR CONDITIONING PANEL ASSEMBLY

- a. Disengage the 8 clips
- b. Disconnect the connector to separate the air conditioning panel assembly

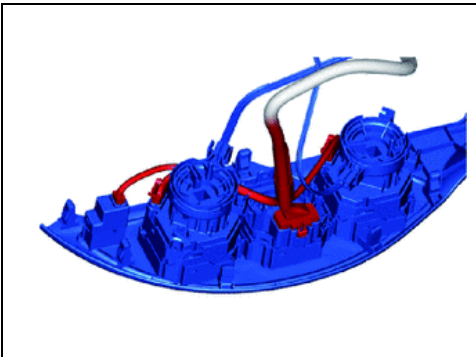

- c. Disconnect the connector to separate the air conditioning panel assembly

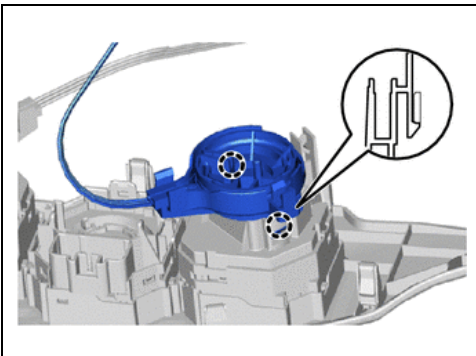

43. DISCONNECT THE DEFROSTER DAMPER CONTROL CABLE SUB-ASSEMBLY

- a. Disengage the 2 claws to disconnect the defroster damper control cable sub-assembly

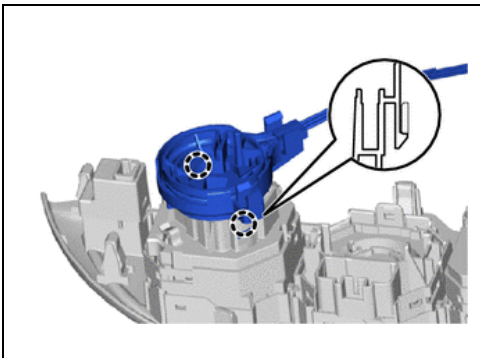

44. DISCONNECT THE AIR MIX DAMPER CONTROL CABLE SUB-ASSEMBLY

- a. Disengage the 2 claws to disconnect the air mix damper control cable sub-assembly

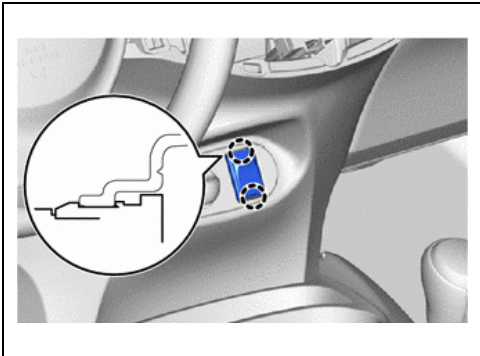

45. REMOVE NO.1 STEREO JACK ADAPTER ASSEMBLY

- a. Disconnect the connector
- b. Disengage the 2 claws to remove the No.1 Stereo jack adapter assembly

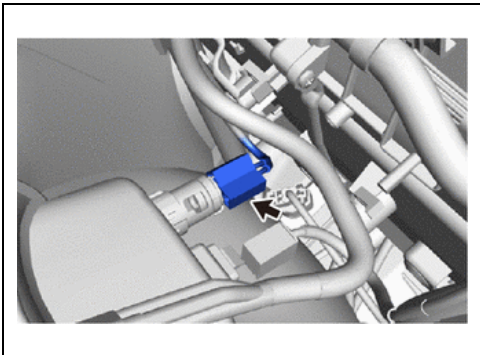

46. REMOVE NO.1 POWER OUTLET SOCKET ASSEMBLY

- a. Disconnect the connector

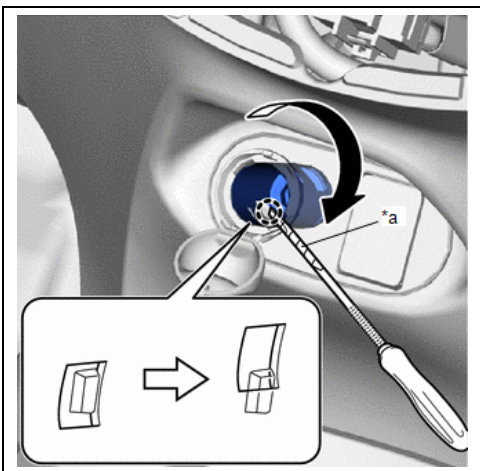

- b. Using a screwdriver wrapped in protective tape, disengage the claw, then turn the No.1 power outlet socket clockwise and pull the power outlet socket half way out.

*a	Protective Tape
----	-----------------

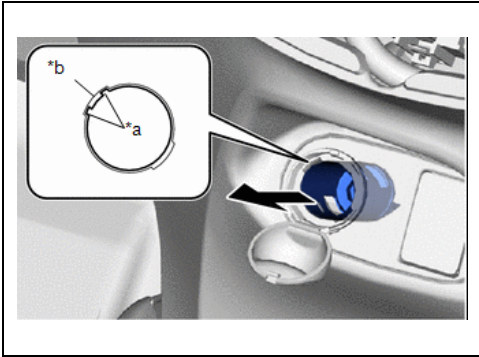

c. Align the protrusion of the No.1 power outlet socket cover with the cutout of the No.1 power outlet socket cover and then pull the No.1 power outlet socket assembly out

*b	Protrusion
*a	Cutout

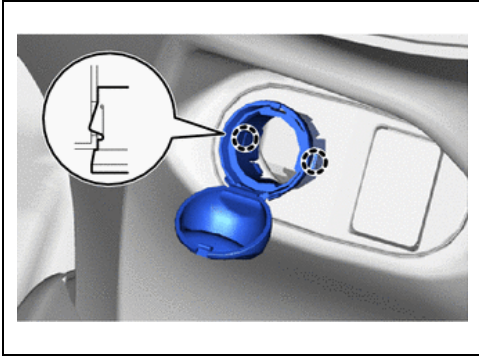

47. REMOVE NO.1 POWER OUTLET SOCKET COVER

a. Disengage the 2 claws to remove the No. 1 power outlet socket cover

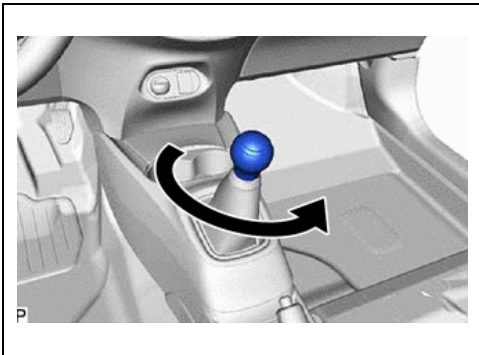

48. REMOVE SHIFT LEVER KNOB SUB-ASSEMBLY

a. Turn the shift lever knob sub-assembly counterclockwise and remove the shift lever knob sub-assembly

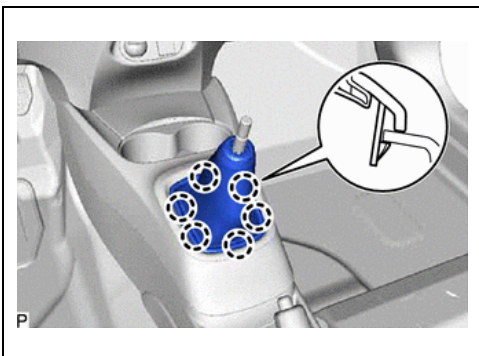

49. REMOVE THE SHIFTING HOLE COVER SUB-ASSEMBLY

a. Disengage the 6 claws to remove the shifting hole cover sub-assembly

NOTE: Do not remove the cover. It is not necessary for repair

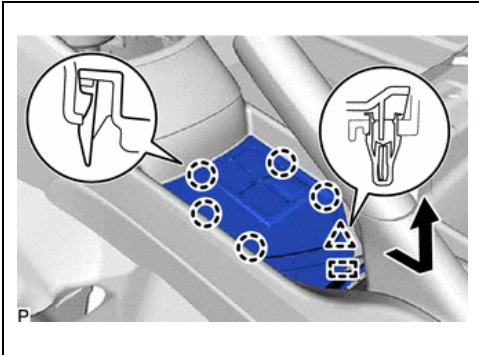

50. REMOVE THE REAR CONSOLE BOX COVER

- a. Disengage the 5 claws and clip
- b. Disengage the guide and pull out the rear console box cover as shown in the illustration
- c. Disconnect the connectors to remove the rear console box cover

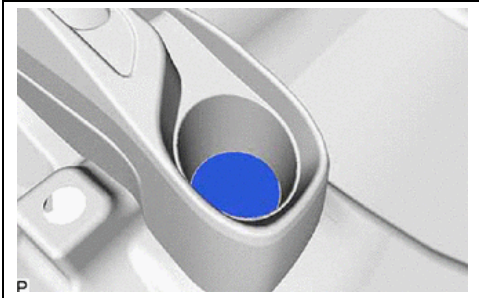

51. REMOVE CONSOLE BOX CARPET

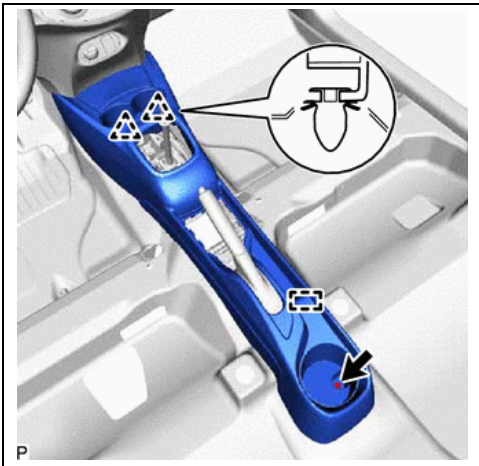

52. REMOVE REAR CONSOLE BOX ASSEMBLY

- a. Remove the bolt
- b. Disengage the 2 clips and guide to remove the rear console box assembly

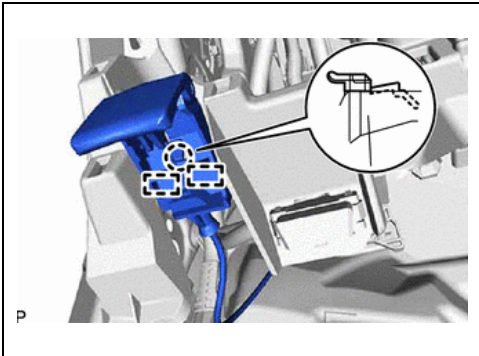

53. SEPARATE HOOD LOCK CONTROL LEVER SUB-ASSEMBLY

- a. Disengage the claw and 2 guides to separate the hood lock control lever

54. REMOVE LOWER INSTRUMENT PANEL SUB-ASSEMBLY

a. Disengage the 2 claws to disconnect the DLC3 connector

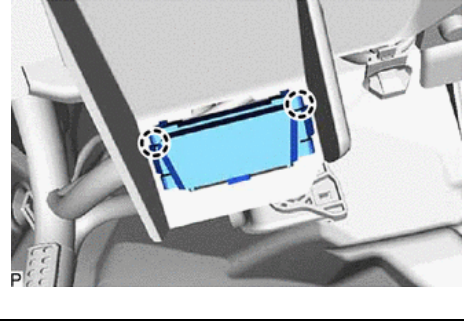

b. Disengage the clamps

c. Disconnect the connectors

d. Remove the 6 or <C> bolts, <D> or <E> screw, and 2 <F> bolts from the lower instrument panel sub-assembly

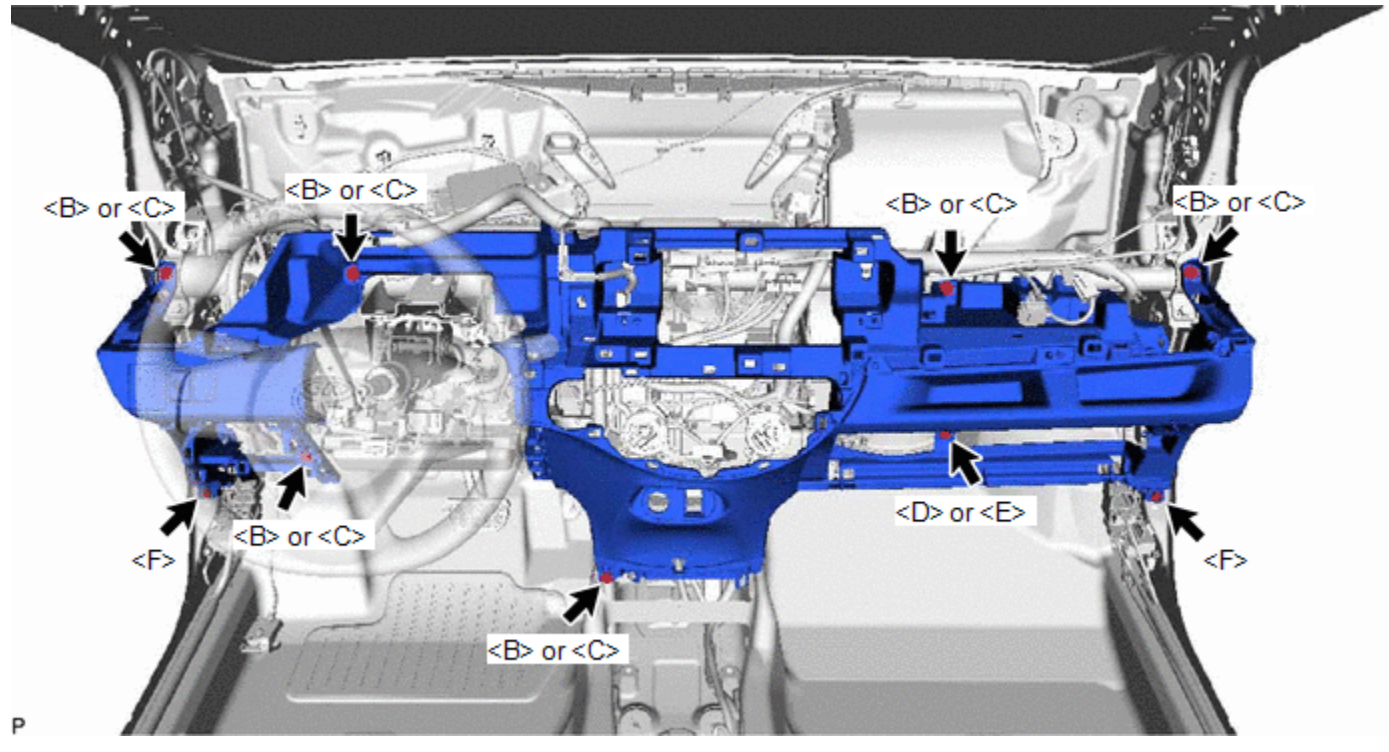

e. Disengage the 10 guides to remove the lower instrument panel sub-assembly

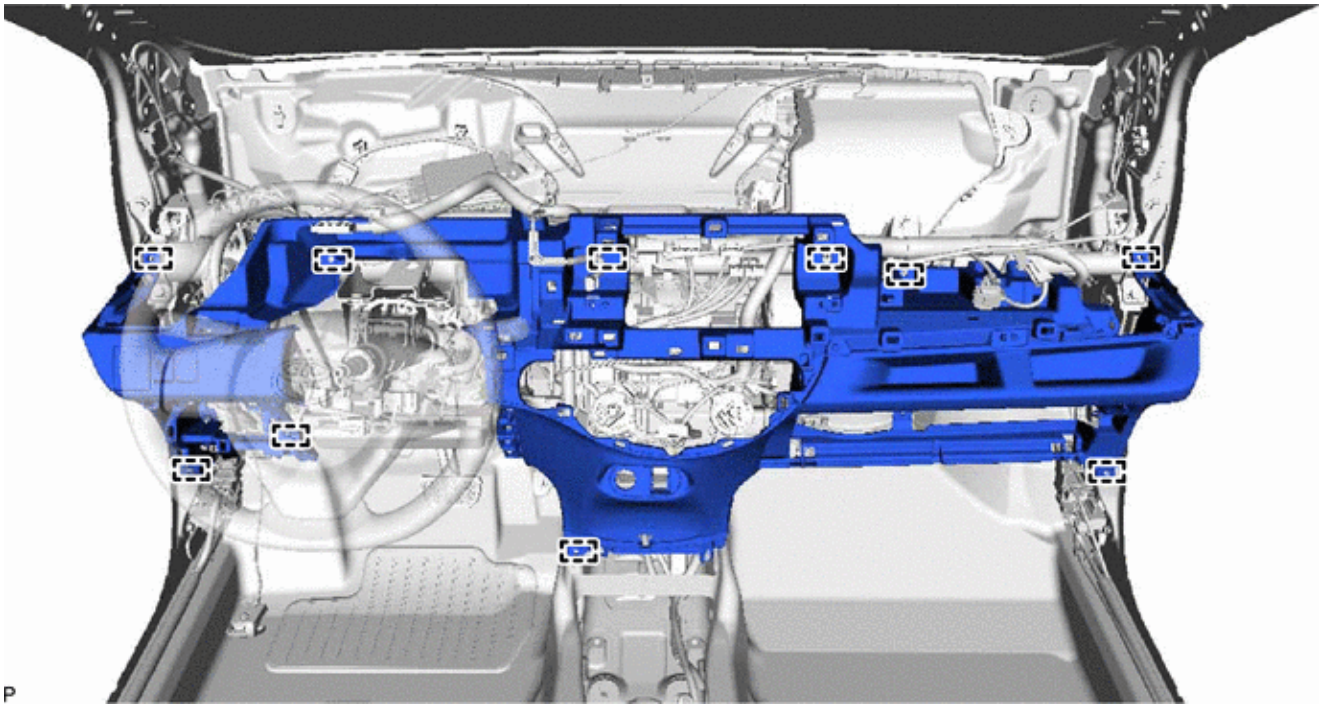

55. REMOVE INSTRUMENT PANEL WIRE

- a. Disconnect the connectors, disengage the clamps, and remove the screws, bolts etc. shown in the illustration

NOTE:

- Print this page as a check sheet, and put a mark after each disconnection or removal.
- **DO NOT** dispose of the check sheet but use it also when installing a **NEW** instrument panel wire.
- See the following pages for detailed information on sections 1) to 4) in the illustration below.

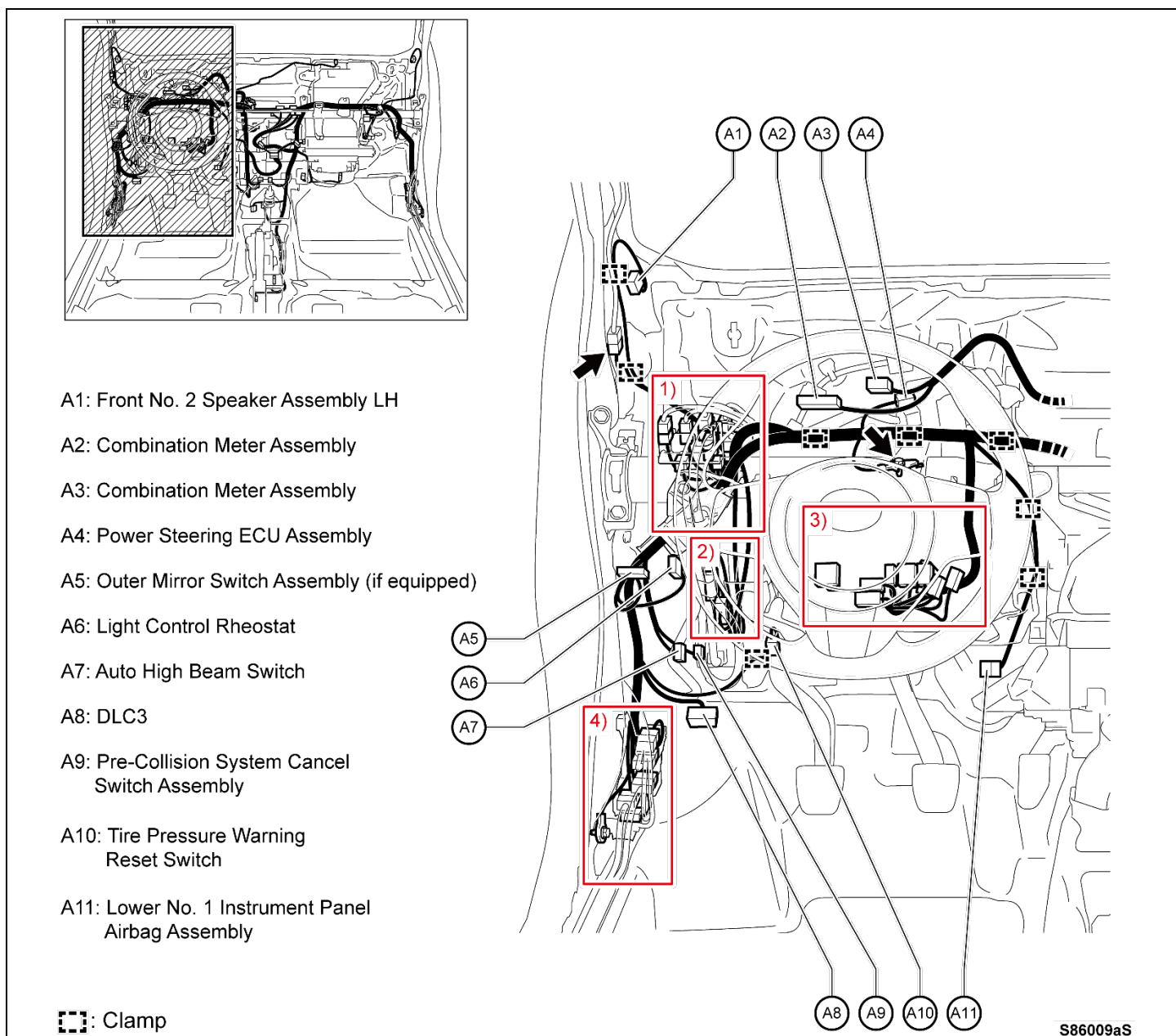

1) Instrument panel relay box

- i. Disconnect the 6 engine room main wire connectors from the instrument panel relay box
- ii. Disengage the 3 clamps
- iii. Remove the 2 screws and disengage the clamp to separate the relay box

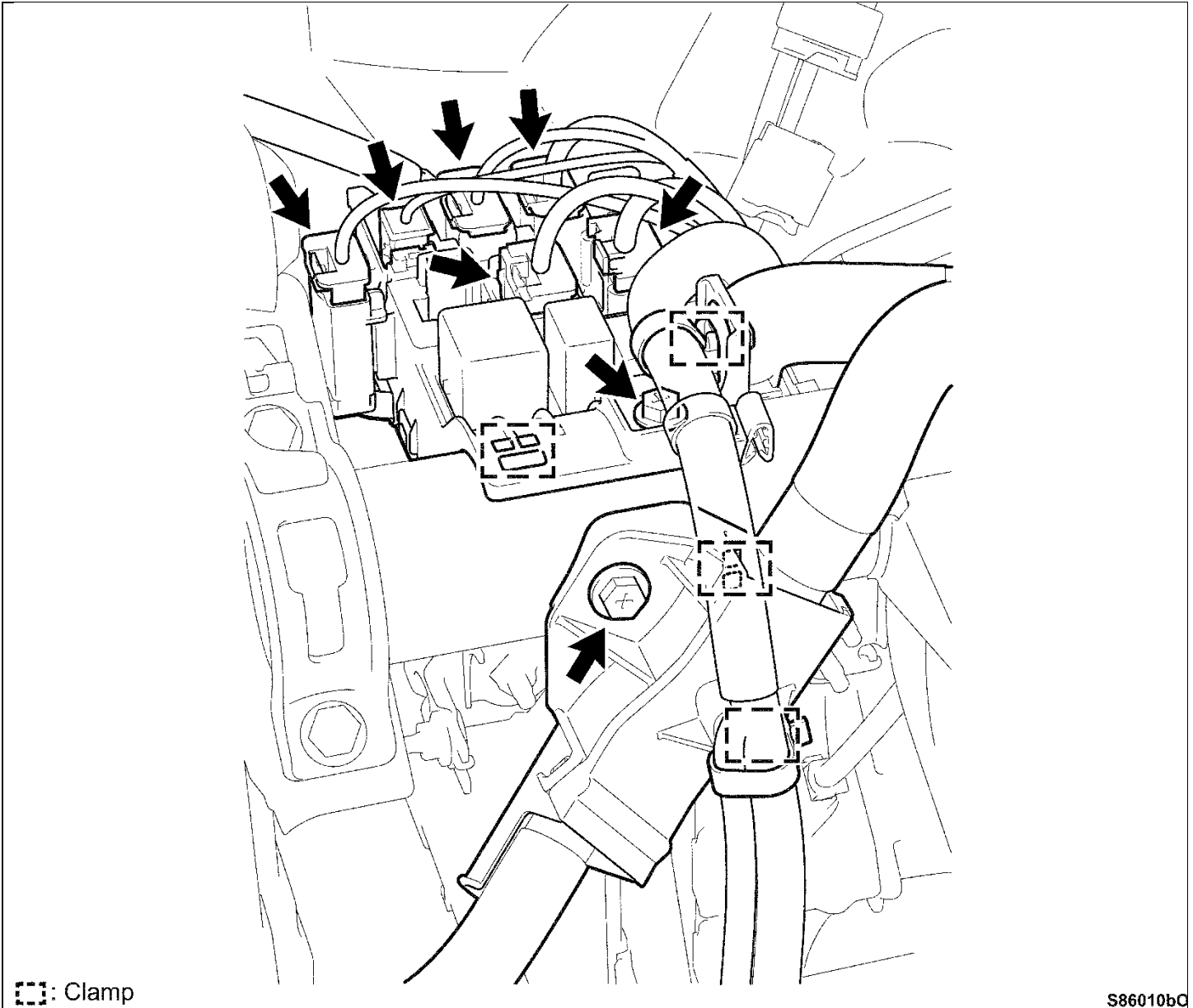

- iv. Remove the 3 relays from the detached instrument panel relay box, and then install them to the relay box of the **NEW** instrument panel wire as shown



DO NOT install the small relays in opposite positions. One is a 4 pole relay and the other is a 5 pole relay.

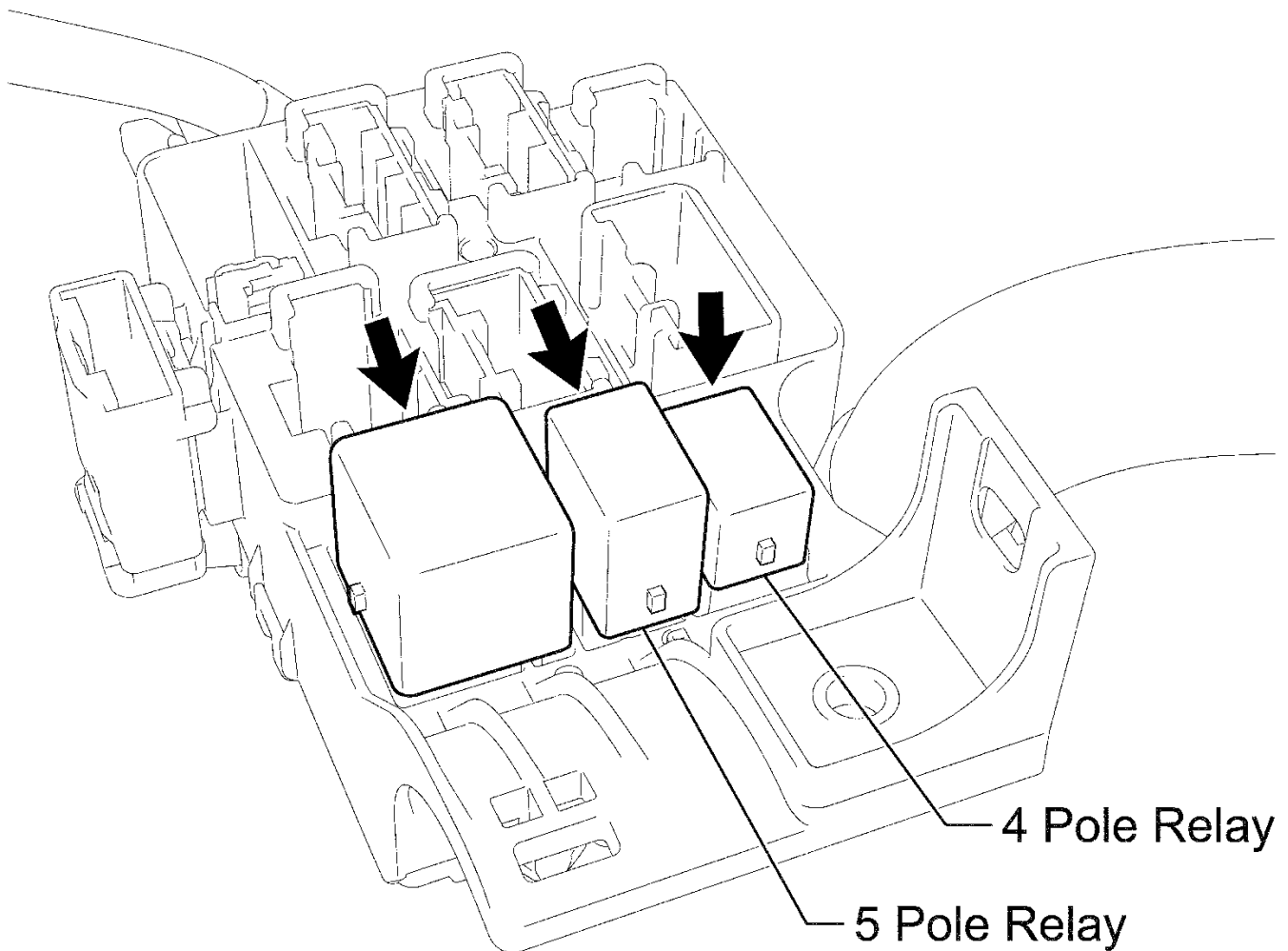

S86023b0

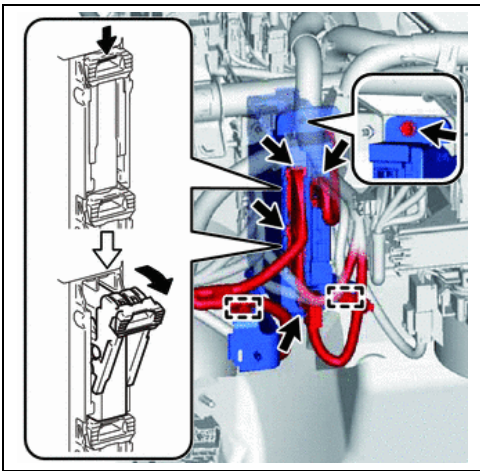

- 2) Instrument panel junction block
- i. Disengage the clamps
 - ii. Disconnect the connectors on the front side
 - iii. Remove the bolt and separate the junction block

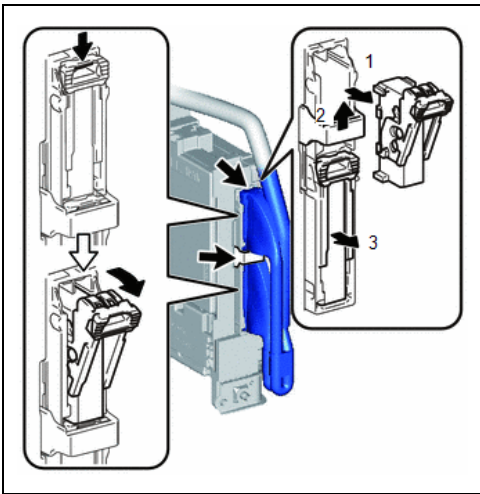

- iv. Disconnect the back-side connectors and remove the junction block as shown in the illustration

- 3) Disconnect steering column lower section connectors and clamps
 - i. Disconnect the connectors
 - ii. Disengage the 3 clamps and separate the instrument panel wire

C1: Headlight Dimmer Switch Assembly

C2: Spiral with Sensor Cable Sub-Assembly

C3: Spiral with Sensor Cable Sub-Assembly

C4: Steering Sensor (Spiral with Sensor Cable Sub-Assembly)

C5: Windshield Wiper Switch Assembly

C6: Windshield Wiper Switch Assembly

C7: Un-Lock Warning Switch Assembly

C8: Transponder Key Coil

C9: Key Interlock Solenoid

NOTE:

Connected on AT models only

C10: Ignition or Starter Switch Assembly

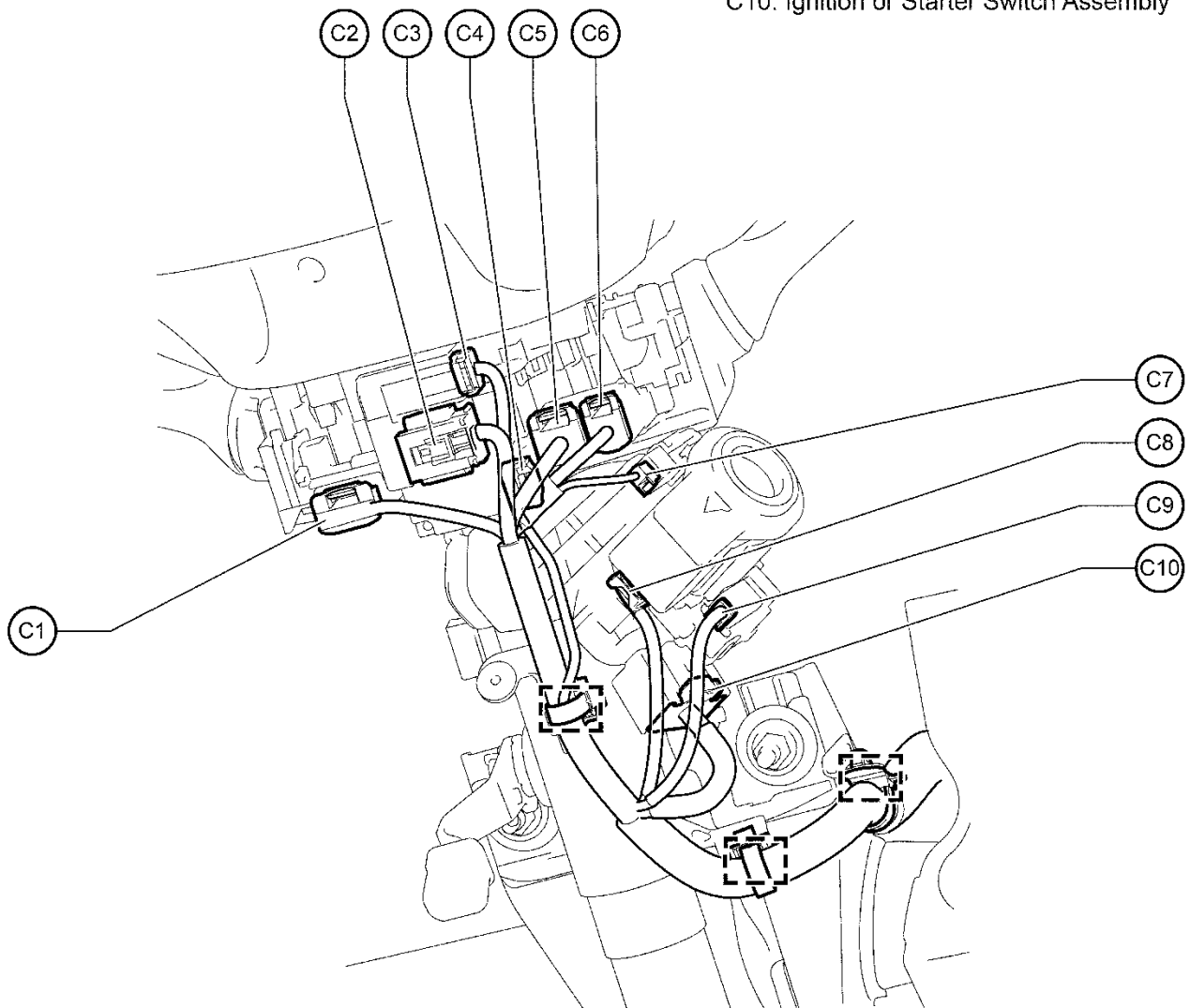

: Clamp

S86012a

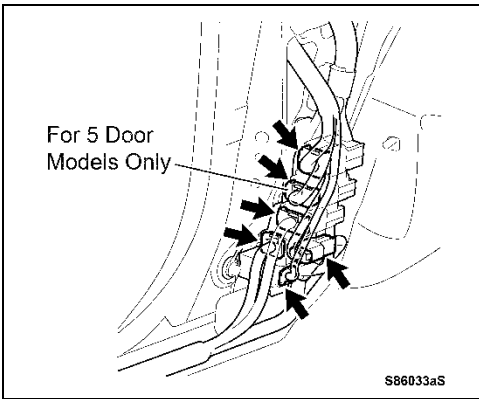

- 4) Disconnect the connectors on the RH cowl side section
 - i. Disconnect the floor wire connectors from the connector holder on the LH cowl side

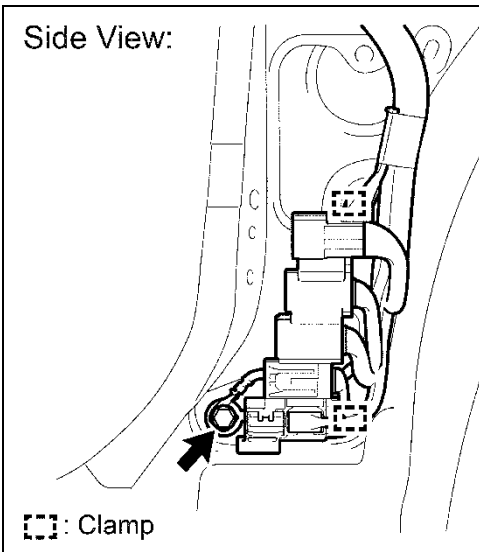

- ii. Disengage the 2 clamps
 - iii. Remove the ground bolt and separate the connector holder

- a. Disconnect the connectors, disengage the clamps, and remove the bolts shown in the illustration

NOTE:

- Print this page as a check sheet, and put a mark after each disconnection or removal.
- **DO NOT** dispose of the check sheet but use it also when installing the **NEW** instrument panel wire.
- See the following pages for detailed information on sections 1) and 2) in the illustration below.
- For Section 1) go to the Transponder ECU section

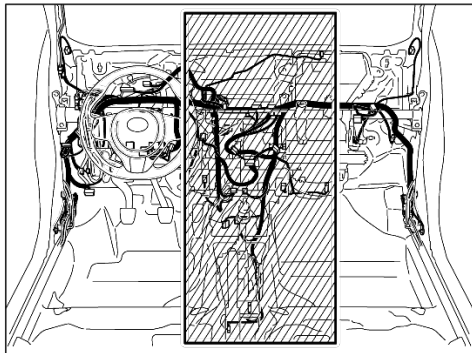

- D1: Telltale Light Assembly
- D2: Radio Receiver Assembly (if equipped)
- D3: Radio Receiver Assembly
- D4: Radio Receiver Assembly
- D5: Radio Receiver Assembly
- D6: Theft Warning Indicator Light Assembly

- D7: Pre-Collision Safety City Buzzer
- D8: No. 1 Heater Control Sub-Assembly
- D9: No. 2 Heater Control Sub-Assembly
- D10: No. 1 Cooler Thermistor
- D11: A/C Amplifier Assembly
- D12: Airbag Sensor Assembly
- D13: Oxygen Sensor (Bank 1 Sensor 2)
- D14: Shift Lock Control Unit Assembly
- D15: Shift Position Light (Indicator Light Wire Sub-Assembly)
- D16: Shift Lock Control Unit Assembly
- NOTE:**
Connected on AT models only
- D17: VSC Off Switch
- D18: Parking Brake Switch Assembly

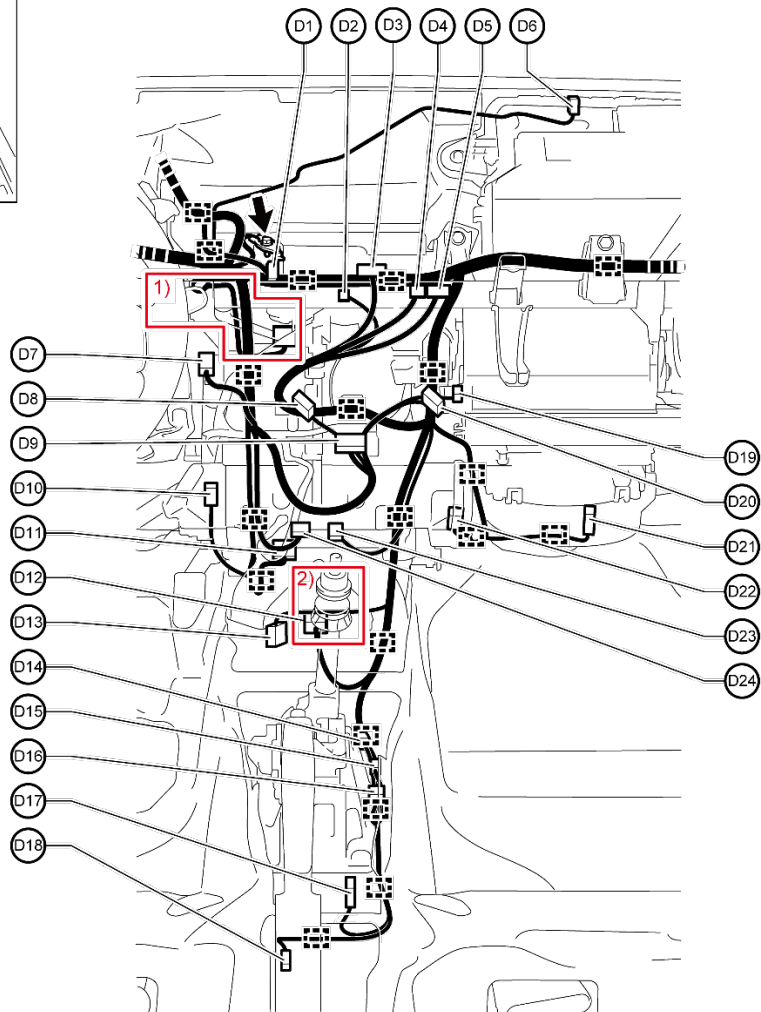

- D19: Amplifier Microphone Assembly (if equipped)
- D20: No. 3 Heater Control Sub-Assembly
- D21: Blower with Fan Motor Sub-Assembly
- D22: Blower Assembly
- D23: No. 1 Stereo Jack Adapter Assembly (if equipped)
- D24: Power Outlet Socket

 Clamp

S86014aS

2) Airbag sensor assembly connector

- i. Disconnect the connector from the airbag sensor assembly
- ii. Using a thin-bladed screwdriver, lift the retainer to unlock the connector

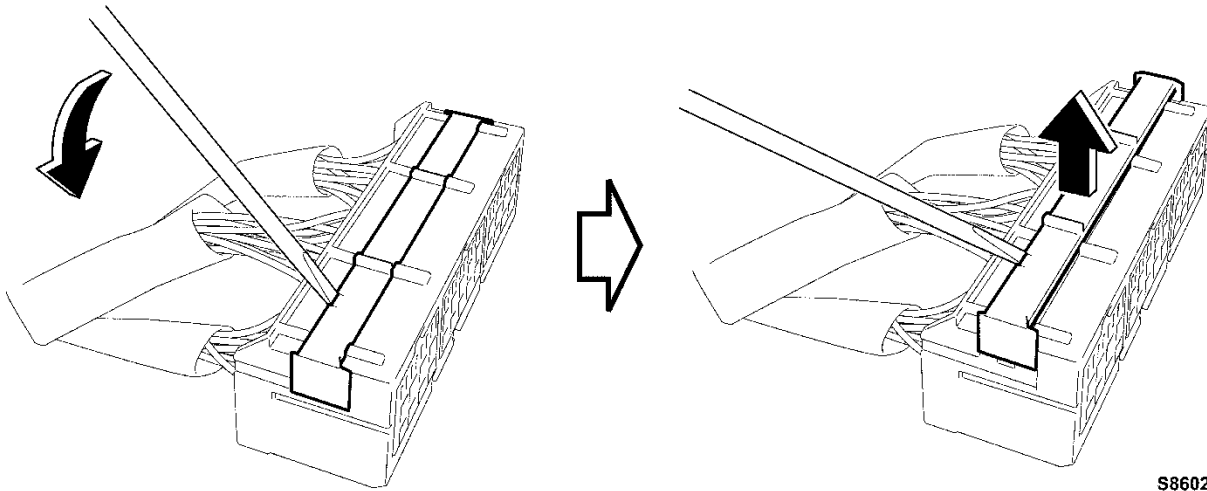

S86029aO

- iii. Insert a thin-bladed screwdriver to the location shown in the illustration below and lift up the claw inside the connector housing
- iv. While lifting up the claw, push the airbag sensor assembly connector shown in the illustration out from the connector housing

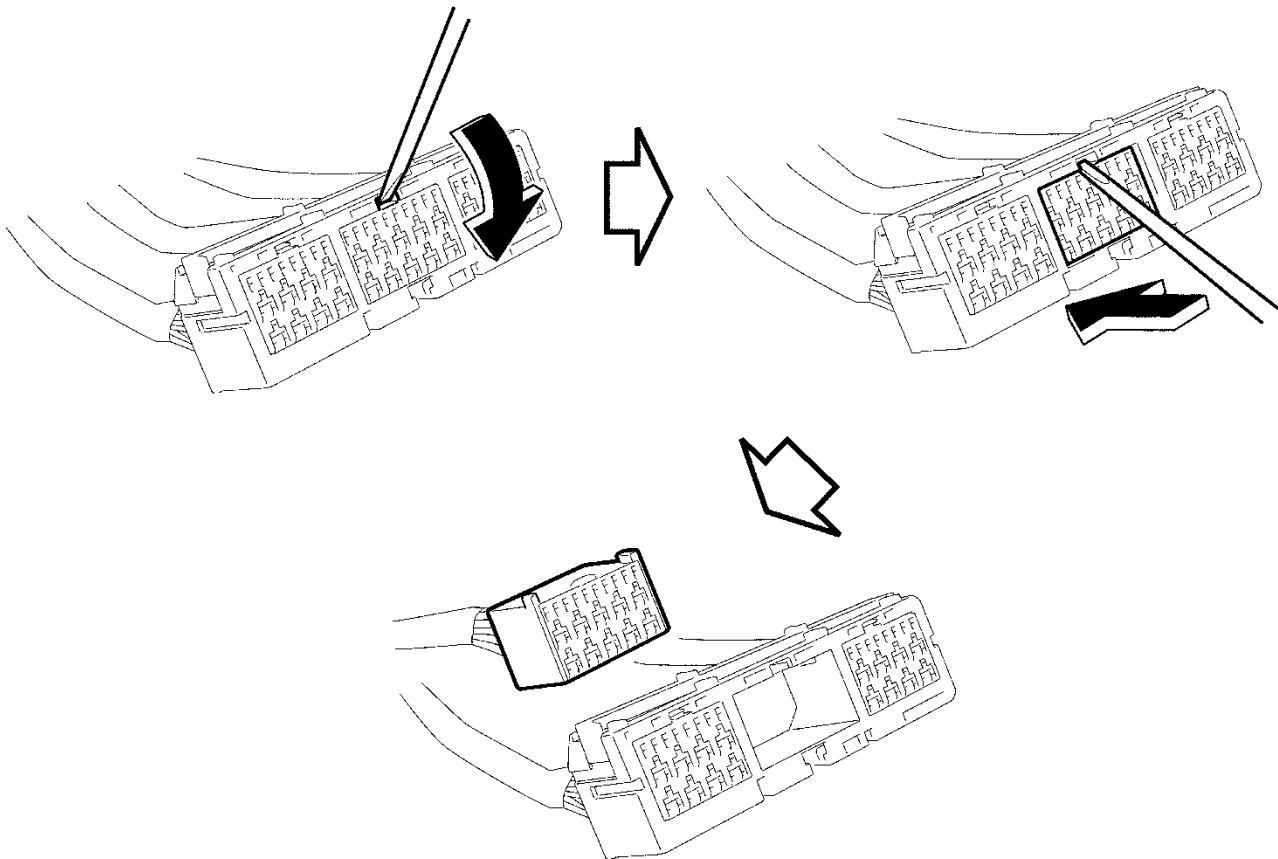

S86031aO

- c. Disconnect the connectors, disengage the clamps and remove the bolt shown in the illustration

NOTE:

- Print this page as a check sheet, and put a mark after each disconnection or removal.
- **DO NOT** dispose of the check sheet but use it also when installing the **NEW** instrument panel wire.
- See the next page for detailed information on section 1) in the illustration below.

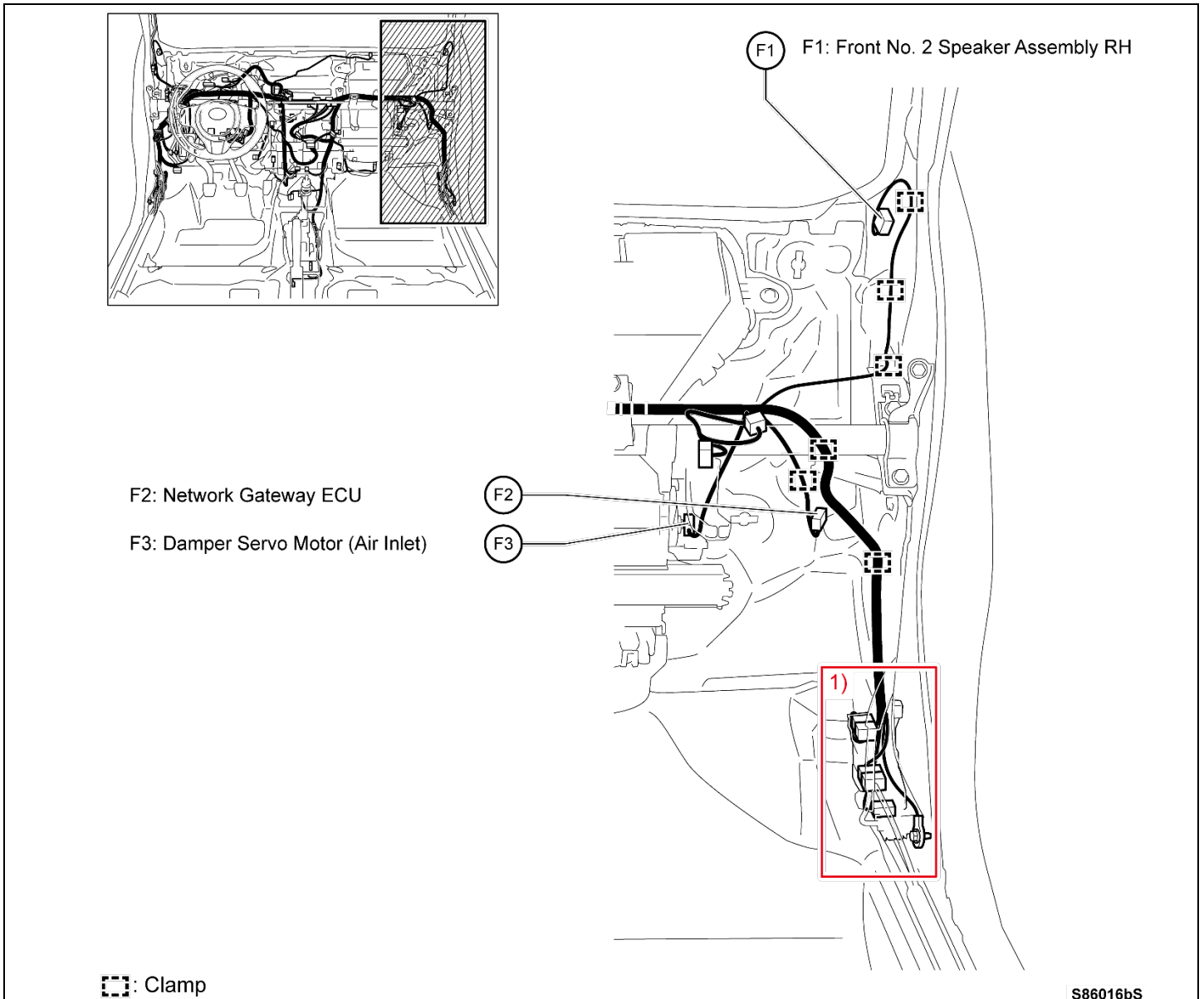

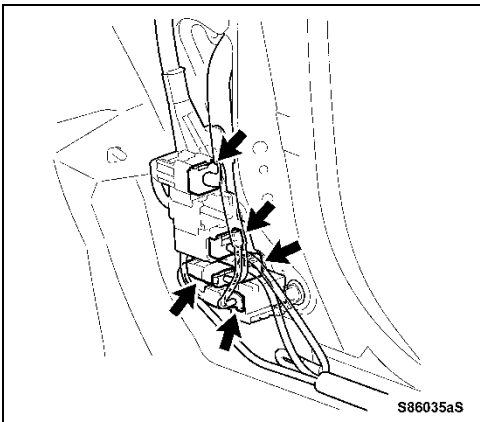

- 1) Disconnect the connectors on the RH cowl side section
 - i. Disconnect the 5 floor wire connectors from the connector holder on the RH cowl side

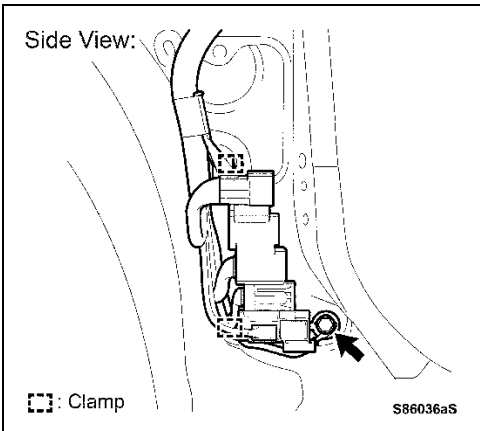

- ii. Disengage the 2 clamps
 - iii. Remove the ground bolt and separate the connector holder

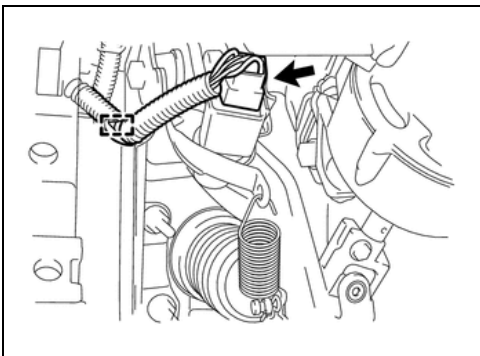

56. REMOVE STOP LIGHT SWITCH ASSEMBLY

- a. Disconnect the connector from the stop light switch assembly
- b. Disengage the harness from the brake pedal support

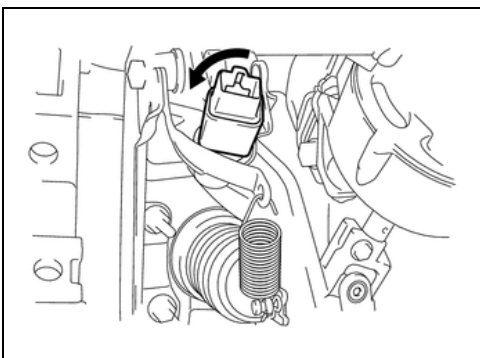

- c. Turn the stop light switch counterclockwise and remove the stop light switch assembly

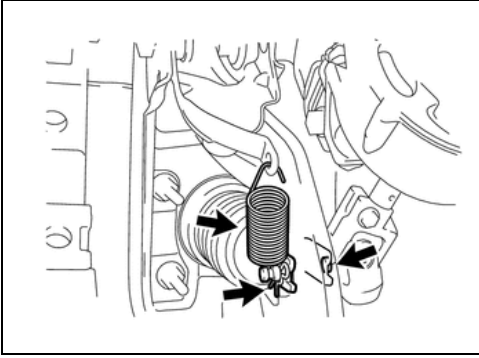

57. SEPARATE BRAKE MASTER CYLINDER PUSH ROD CLEVIS

- a. Remove the brake pedal return spring
- b. Remove the clip and push rod pin and separate the push rod clevis from the brake pedal

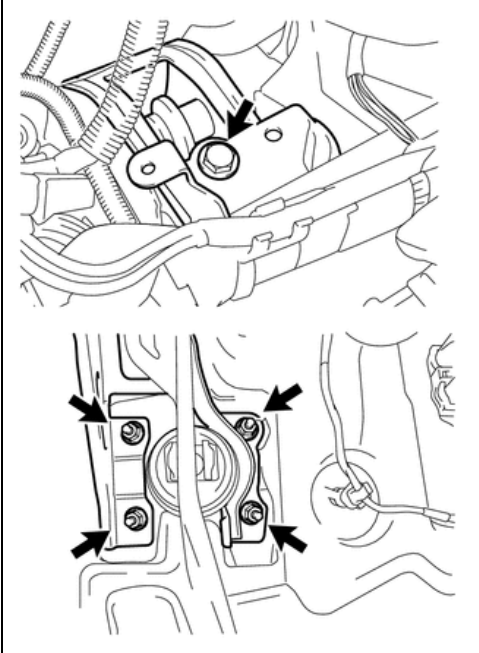

58. REMOVE BRAKE PEDAL SUPPORT SUB-ASSEMBLY

- a. Remove the 4 nuts, bolt and the brake pedal support

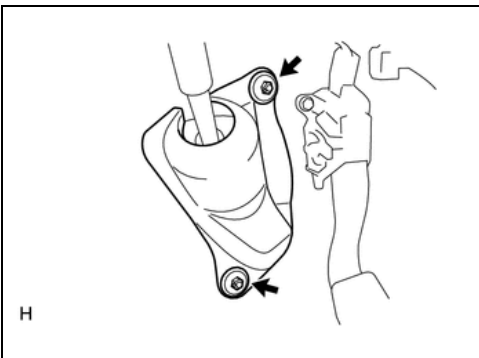

59. REMOVE COLUMN HOLE COVER SILENCER SHEET

- a. Remove the 2 clips and the column hole cover silencer sheet.

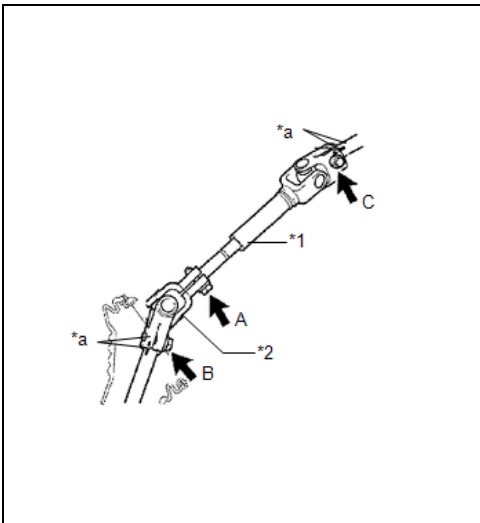

60. REMOVE STEERING SLIDING YOKE SUB-ASSEMBLY

- a. Place matchmarks on the No.2 steering intermediate shaft assembly and steering column assembly

*1	No.2 Steering Intermediate Shaft Assembly
*2	Steering Sliding Yoke Sub-Assembly
*a	Matchmark

- b. Place matchmarks on the steering sliding yoke sub-assembly and steering gear assembly
- c. Loosen bolt A
- d. Loosen bolt C
- e. Remove bolt B and detach the steering sliding yoke sub-assembly from the steering gear assembly

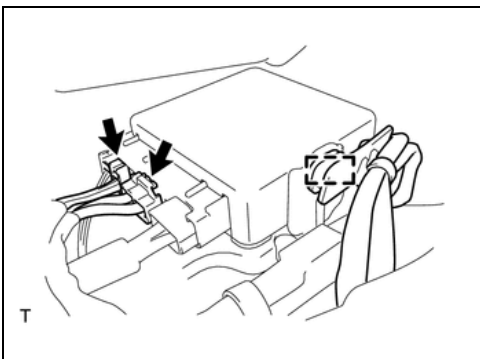

61. REMOVE STEERING COLUMN ASSEMBLY

- a. Separate the wire harness clamp from the power steering ECU assembly.
- b. Disconnect the 2 steering column connectors from the power steering ECU assembly
- c. Disconnect all the remaining connectors and disengage all wire harness clamps from the steering column assembly

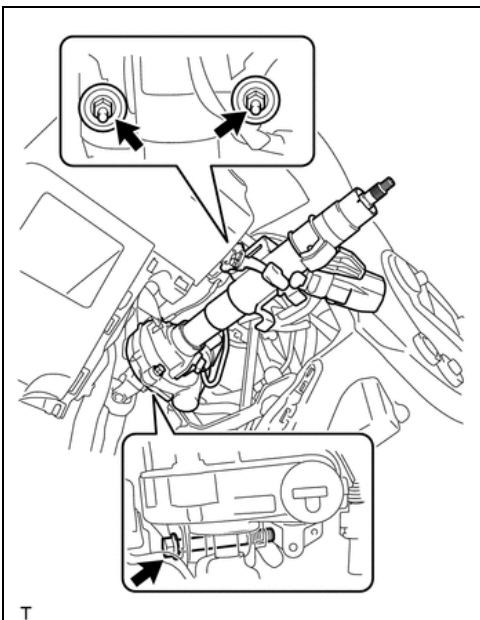

- d. Remove the bolt, 2 nuts and steering column assembly from the instrument panel reinforcement assembly

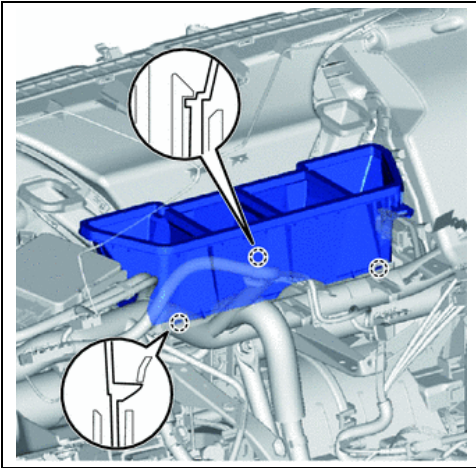

62. REMOVE HEATER TO REGISTER DUCT ASSEMBLY

- a. Disengage the 3 claws and remove the heater to register duct

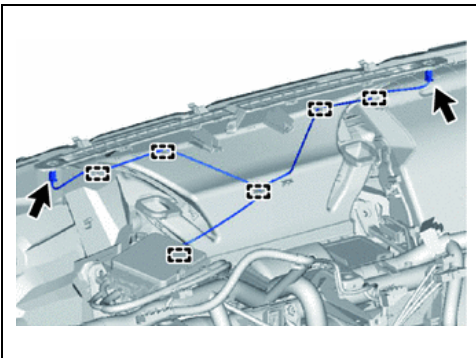

63. REMOVE DEFROSTER NOZZLE ASSEMBLY

- a. Disconnect the connectors and disengage the clamps, then disconnect the wire harness

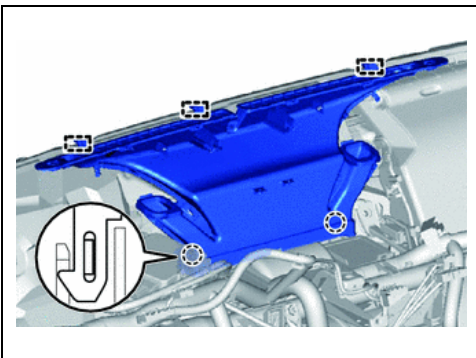

- b. Disengage the 2 claws and 3 guides and remove the defroster nozzle

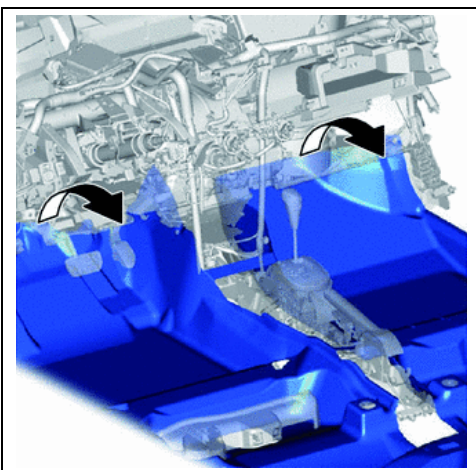

64. REMOVE REAR NO.2 AIR DUCT (for Cold Area Spec. Vehicles)

- a. Peel back the carpet so that air duct can be removed and installed from the vehicle

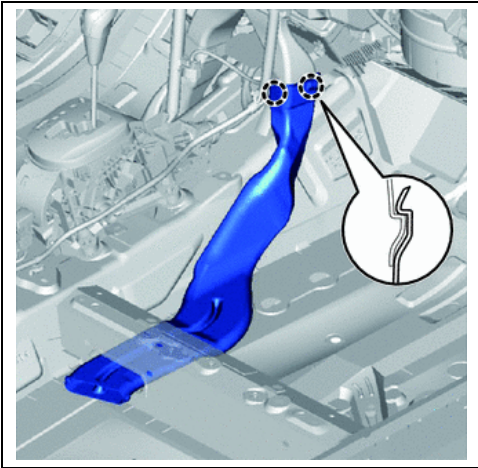

b. Disengage the 2 claws and remove the air duct

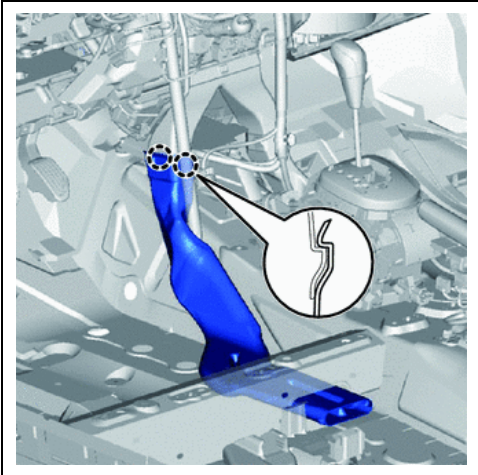

65. REMOVE REAR NO.3 AIR DUCT (for Cold Area Spec. Vehicles)

a. Disengage the 2 claws and remove the air duct

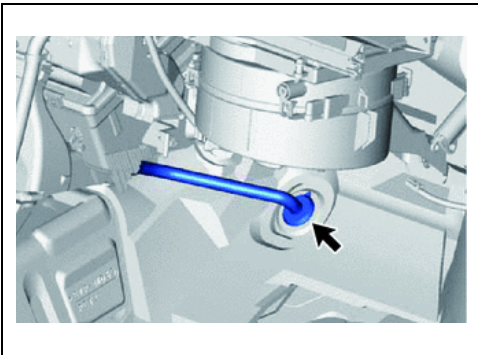

66. SEPARATE THE DRAIN COOLER HOSE

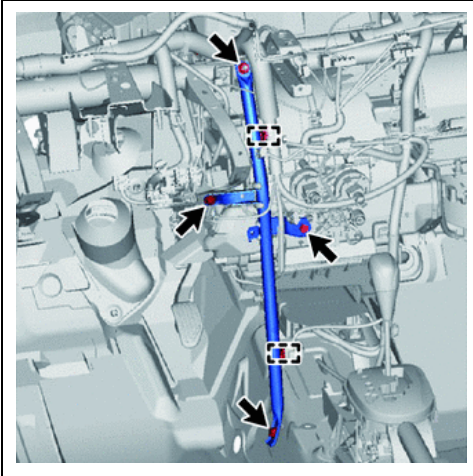

67. REMOVE NO.1 INSTRUMENT PANEL BRACE SUB-ASSEMBLY (Except Cold Area Spec Vehicles)

- a. Disengage the 2 clamps
- b. Remove the 2 bolts, nut, and screw, then remove the instrument panel brace.
- c. Remove the knee airbag mounting bolt

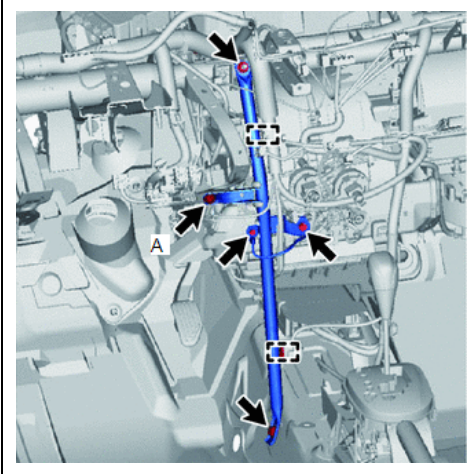

68. REMOVE NO.1 INSTRUMENT PANEL BRACE SUB-ASSEMBLY (for Cold Area Spec Vehicles)

- a. Disengage the 2 clamps
- b. Remove the bolt and disconnect the ground wire
- c. Remove the 2 bolts, nut, and screw, then remove the instrument panel brace.
- d. Remove the knee airbag mounting bolt A

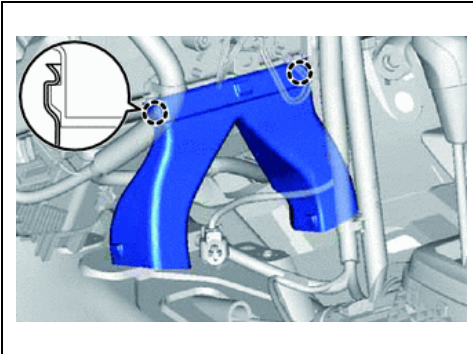

69. REMOVE REAR NO.1 AIR DUCT (for Cold Area Spec Vehicles)

- a. Disengage the 2 claws and remove the air duct

70. REMOVE INSTRUMENT PANEL REINFORCEMENT

- a. Remove the 8 bolts and 3 screws, then remove the instrument panel reinforcement

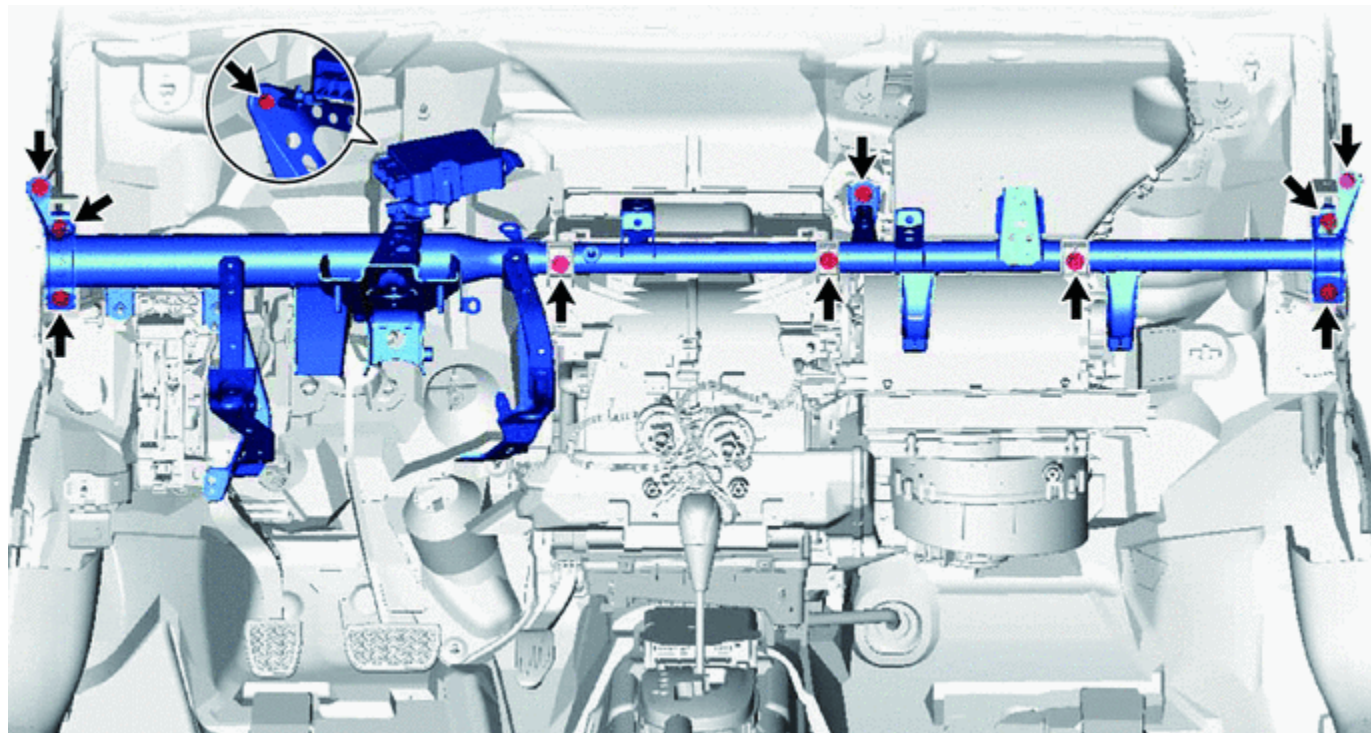

71. REMOVE AIR CONDITIONER UNIT ASSEMBLY

- a. Remove the 3 bolts and nut, then remove the air conditioner unit

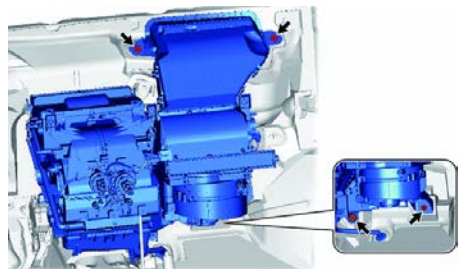

72. REMOVE TRANSPONDER KEY ECU ASSEMBLY

- a. Move the transponder key ECU in the direction of the arrow in the illustration to disengage the guide.

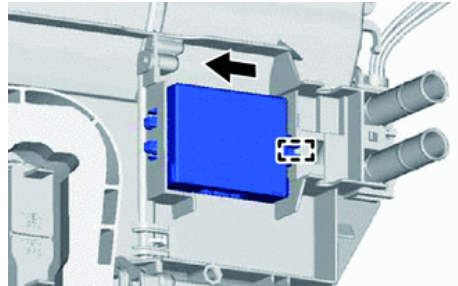

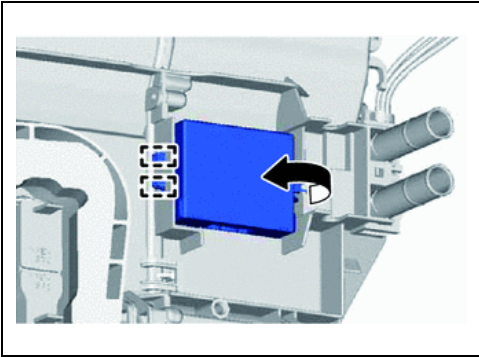

- b. Move the transponder key ECU in the direction of the arrow to disengage the 2 guides and remove the transponder key ECU
- c. Disconnect the connector

73. REMOVE INSTRUMENT PANEL WIRE HARNESS

- a. Remove the Instrument panel wire harness from the vehicle

VII. REMOVE INSTRUMENT PANEL WIRE HARNESS

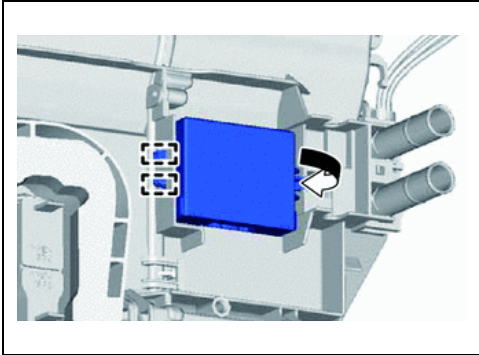

1. INSTALL TRANSPONDER KEY ECU ASSEMBLY

- Connect the transponder key ECU connector
- Engage the 2 guides and move the transponder key ECU in the direction of the arrow

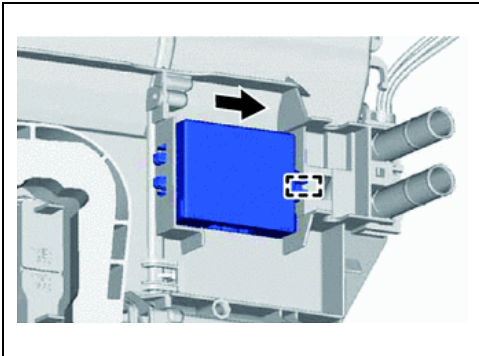

- Move the transponder key ECU in the direction of the arrow to engage the guide and install the transponder key ECU

2. TEMPORARILY TIGHTEN THE AIR CONDITIONER UNIT ASSEMBLY

- Temporarily tighten the air conditioner unit with the 3 bolts and nuts



Be sure to support the air conditioning unit to prevent damage to the installation bracket

3. INSTALL THE INSTRUMENT PANEL REINFORCEMENT

- Install the instrument panel reinforcement with the 8 bolts

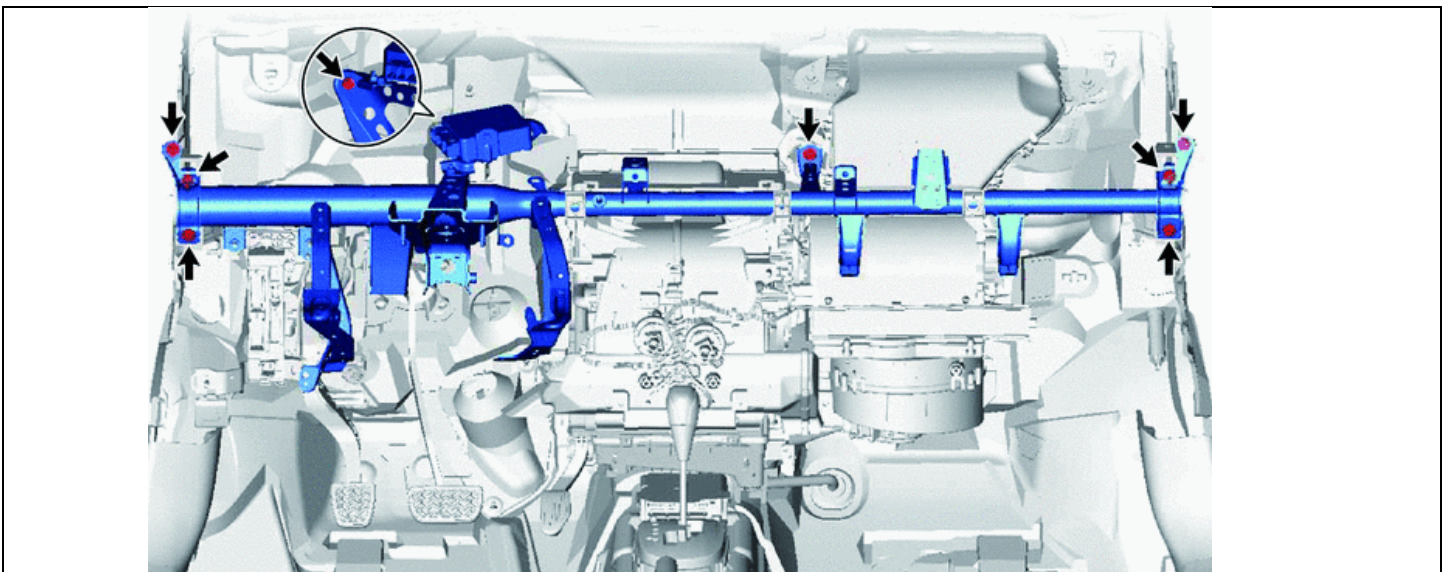

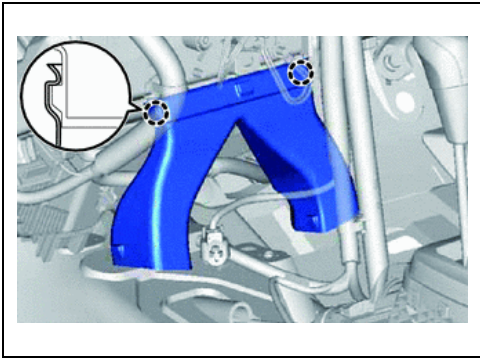

4. INSTALL REAR NO.1 AIR DUCT (for Cold Area Spec Vehicles)

- a. Engage the 2 claws and install the rear No.1 air duct

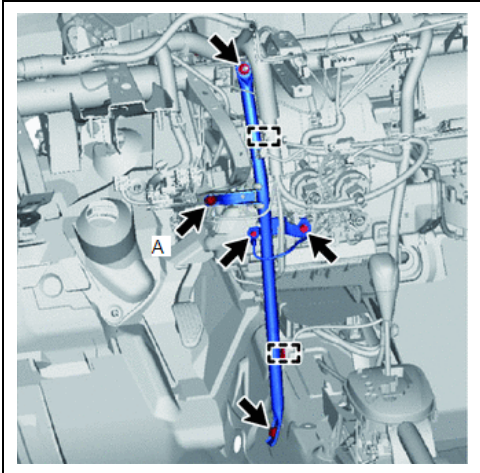

5. INSTALL NO.1 INSTRUMENT PANEL BRACE SUB-ASSEMBLY (for Cold Area Spec Vehicles)

- a. Engage the 2 clamps
- b. Install the bolt and connect the ground wire
- c. Install the 2 bolts, nut, and screw, then install the instrument panel brace.
- d. Install the knee airbag mounting bolt A

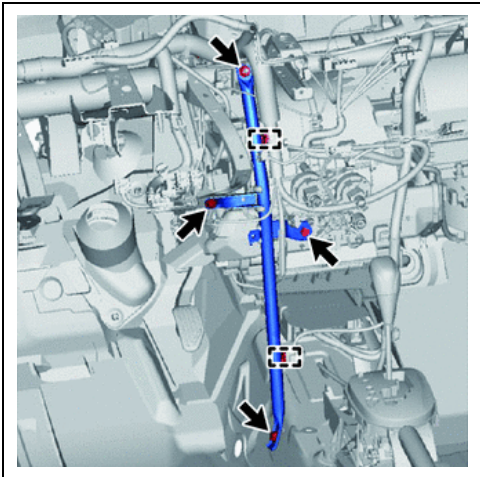

6. INSTALL NO.1 INSTRUMENT PANEL BRACE SUB-ASSEMBLY (Except Cold Area Spec Vehicles)

- b. Engage the 2 clamps
- c. Install the 2 bolts, nut, and screw, then install the instrument panel brace.
- d. Install the knee airbag mounting bolt

7. INSTALL AIR CONDITIONER UNIT ASSEMBLY

- a. Install the air duct with the 2 bolts

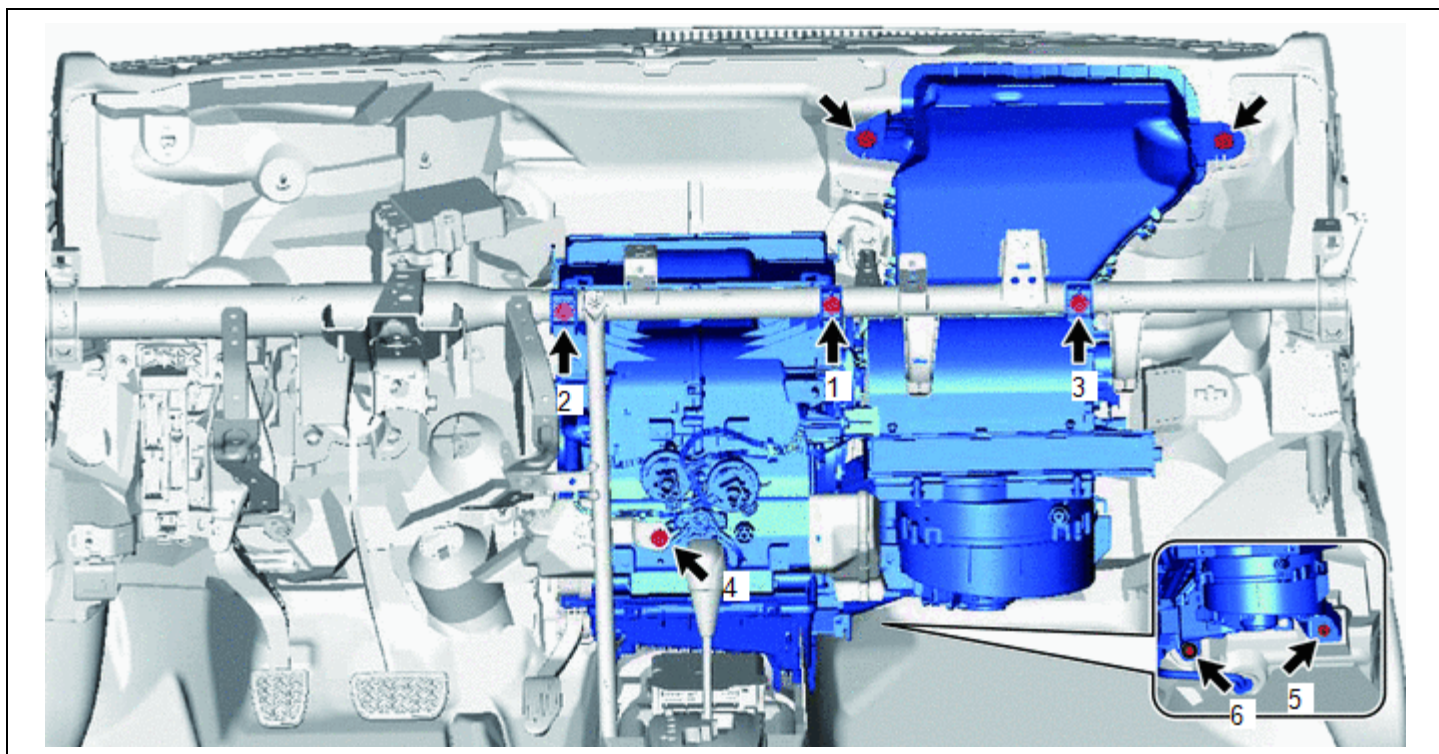

Torque:

87 in-lbf {9.8 N.m, 100 kgf-cm} for bolt

Torque:

35 in-lbf {4.0 N.m, 41 kgf-cm} for nut

Torque:

35 in-lbf {4.0 N.m, 41 kgf-cm} for screw 1, 2, 3

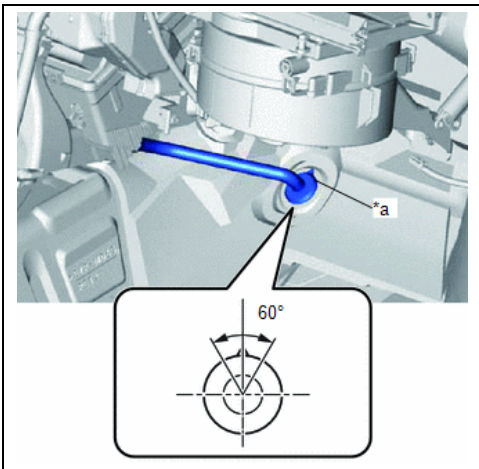

8. CONNECT COOLER DRAIN HOSE

a. Install the drain cooler hose as shown in the illustration

*a	UP Mark
----	---------

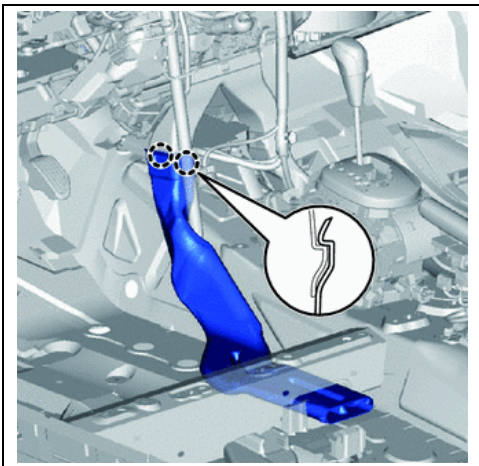

9. INSTALL THE REAR NO.3 AIR DUCT (for Cold Area Spec Vehicles)

a. Install the 2 claws and install the air duct

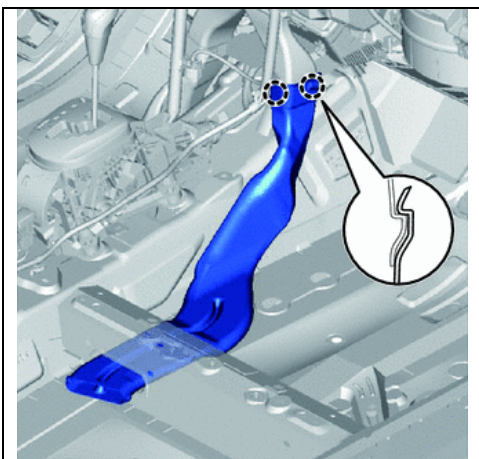

10. INSTALL REAR NO.2 AIR DUCT (for Cold Area Spec Vehicles)

a. Install the 2 claws and install the air duct

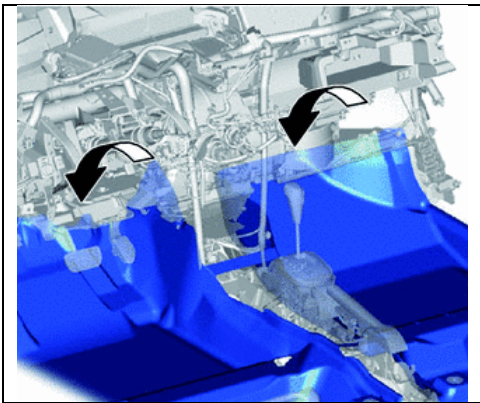

b. Return the floor carpet

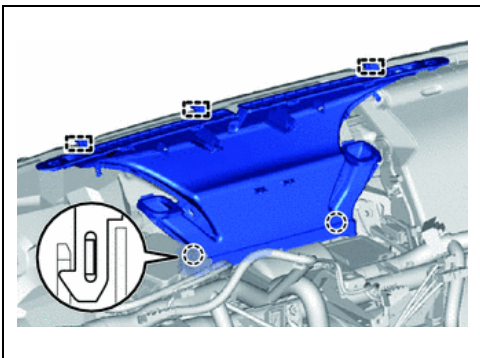

11. INSTALL THE DEFROSTER NOZZLE ASSEMBLY

a. Engage the 2 claws and 3 guides, then install the defroster nozzle

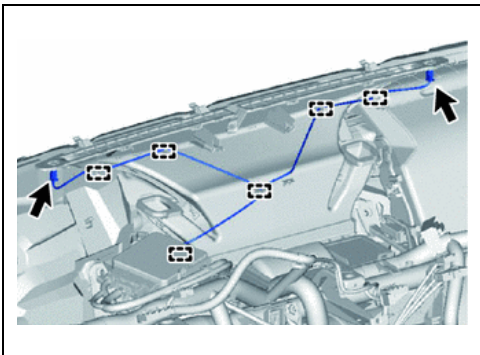

b. Engage the clamps and connect the connectors, then connect the wire harness

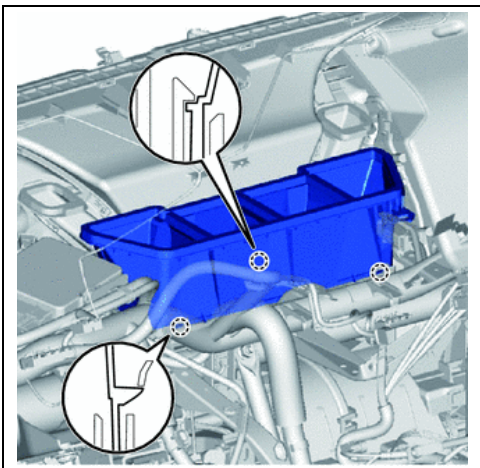

12. INSTALL HEATER TO REGISTER DUCT ASSEMBLY

a. Engage the 3 claws and install the heater to register duct

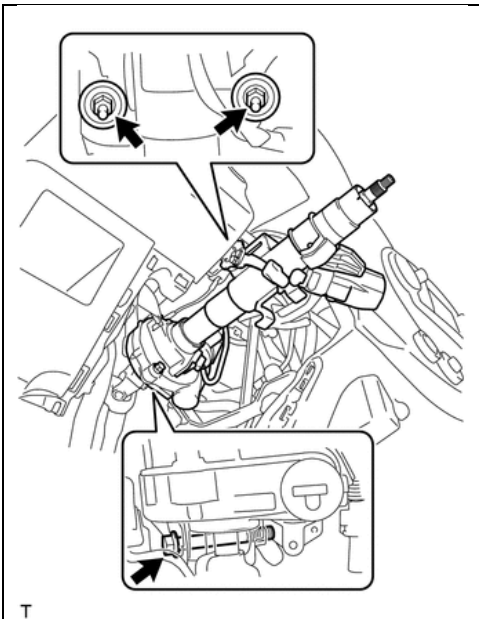

13. INSTALL STEERING COLUMN ASSEMBLY

- a. Install the steering column assembly to the instrument panel reinforcement assembly with the 2 nuts and bolt

Torque (Bolt) :
27 ft·lbf {36 N·m, 367 kgf·cm}

Torque (Nut) :
18 ft·lbf {25 N·m, 255 kgf·cm}



Be sure there is no interference around the wire harness

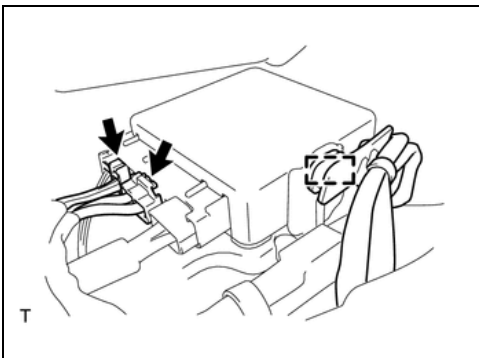

- b. Connect all the connectors and engage all the wire harness clamps to the steering column assembly bracket
- c. Install the wire harness clamp to the power steering ECU assembly
- d. Connect the 2 steering column assembly connectors to the power steering ECU assembly

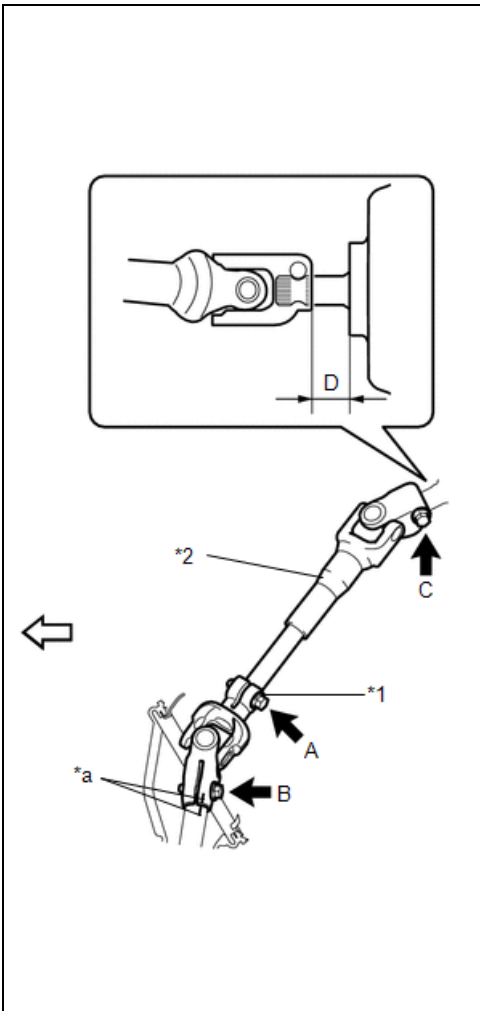

14. INSTALL STEERING SLIDING YOKE SUB-ASSEMBLY

- a. Tighten the bolt C while aligning the No.2 steering intermediate shaft assembly with the position D as shown in the illustration
- b. Align the matchmarks on the steering sliding yoke sub assembly and the steering gear assembly

*1	Steering Sliding Yoke Sub-assembly
*2	No.2 Steering Intermediate Shaft Assembly
*a	UP Mark
	Front of Vehicle

Standard D:
18.5 to 19.7mm (0.728 to 0.776 in)

Torque:
26 ft-lbf {35 N.m, 360 kgf.cm}

- c. Install bolt B
Torque:
26 ft-lbf {35 N.m, 360 kgf.cm}

- d. Tighten bolt A
Torque:
26 ft-lbf {35 N.m, 360 kgf.cm}

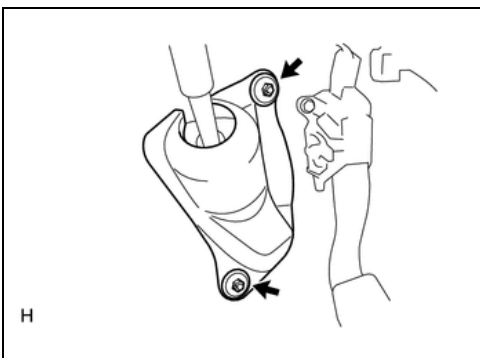

15. INSTALL COLUMN HOLE COVER SILENCER SHEET

- a. Install the column hole cover silencer sheet with the 2 clips

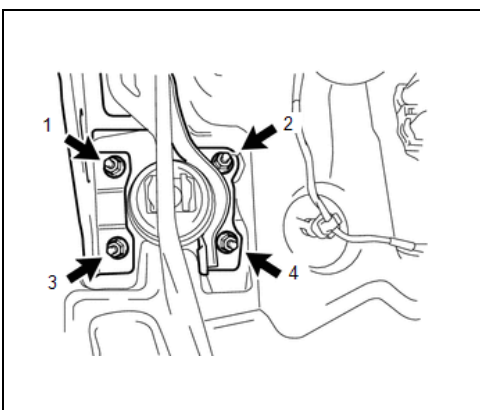

16. INSTALL BRAKE PEDAL SUPPOERT SUB-ASSEMBLY

- a. Temporarily install the pedal support with the bolt and 4 nuts
- b. Tighten the 4 nuts in the order shown in the illustration
Torque:
80 in-lbf {9.0 N.m, 92 kgf.cm}

- c. Tighten the bolt
Torque:
17 ft-lbf {24 N.m, 241 kgf.cm}

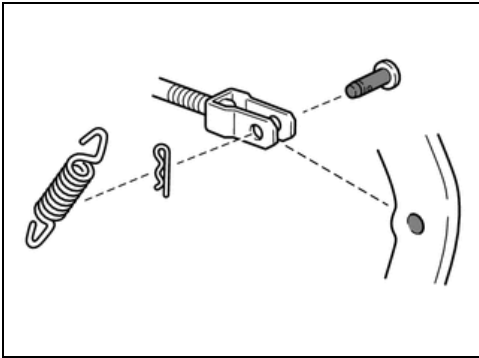

17. INSTALL BRAKE MASTER CYLINDER PUSH ROD CLEVIS

- a. Apply lithium soap base glycol grease to the push rod pin
- b. Install the push rod clevis with the push rod pin and a new clip

	Apply Lithium Soap Base Glycol Grease
--	---------------------------------------

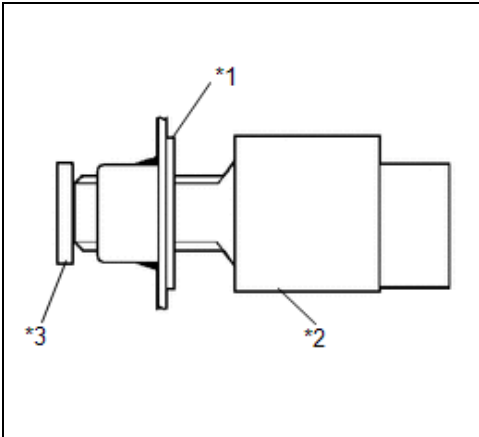

18. INSTALL STOP LIGHT SWITCH ASSEMBLY

- a. Insert the stop light switch into the adjuster until it just touches the brake pedal

*1	Adjuster
*2	Stop Light Switch Assembly
*3	Brake Pedal



Do NOT depress the brake pedal

- b. Make a quarter turn clockwise to install the stop light switch

*1	Stop Light Switch Assembly
*a	Stop Light Switch Clearance

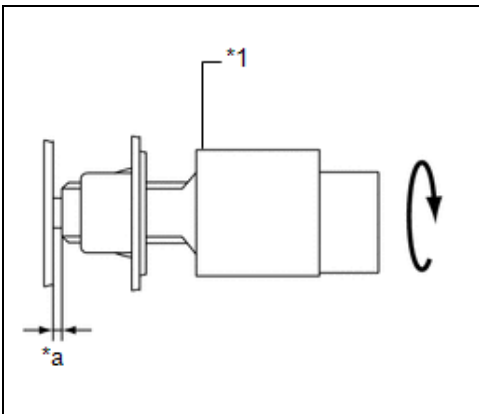

- c. Check the stop light switch clearance:
0.5 to 2.6 mm (0.020 to 0.102 in.)

- d. Engage the harness clamp to the pedal support
- e. Connect the connector to the stop light switch

19. INSTALL NEW INSTRUMENT PANEL WIRE

- a. Connect the connectors, engage the clamps and install the screws, bolt etc. shown in the illustration

Torque:

74 in-lbf {8.4 N.m, 86 kgf.cm}

NOTE:

- Put a mark on the check sheet after each connection or installation, to ensure that all parts are connected.
- See the following pages for detailed information on sections 1) to 4) in the illustration below.

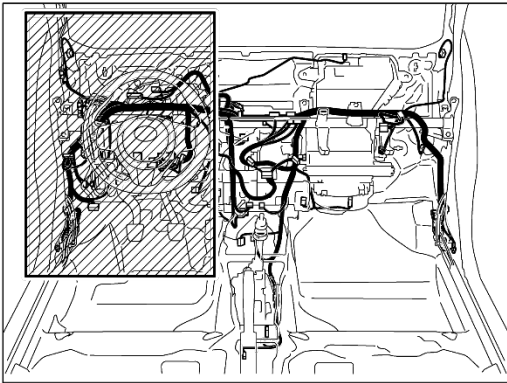

- A1: Front No. 2 Speaker Assembly LH
 A2: Combination Meter Assembly
 A3: Combination Meter Assembly
 A4: Power Steering ECU Assembly
 A5: Outer Mirror Switch Assembly (if equipped)
 A6: Light Control Rheostat
 A7: Auto High Beam Switch
 A8: DLC3
 A9: Pre-Collision System Cancel Switch Assembly
 A10: Tire Pressure Warning Reset Switch
 A11: Lower No. 1 Instrument Panel Airbag Assembly

: Clamp

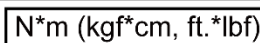
: Specified torque

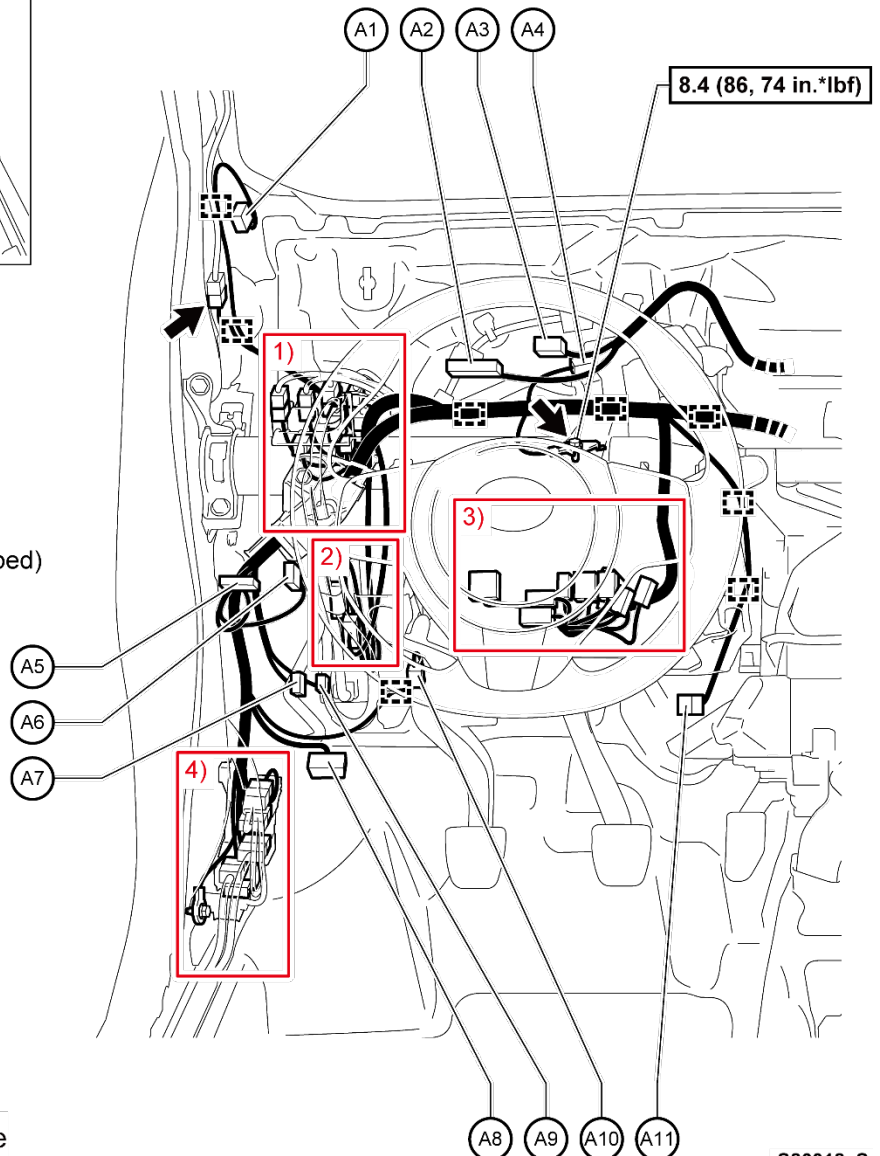

S86018aS



Confirm that the 3 relays are installed to the relay box of the *NEW* instrument panel wire.

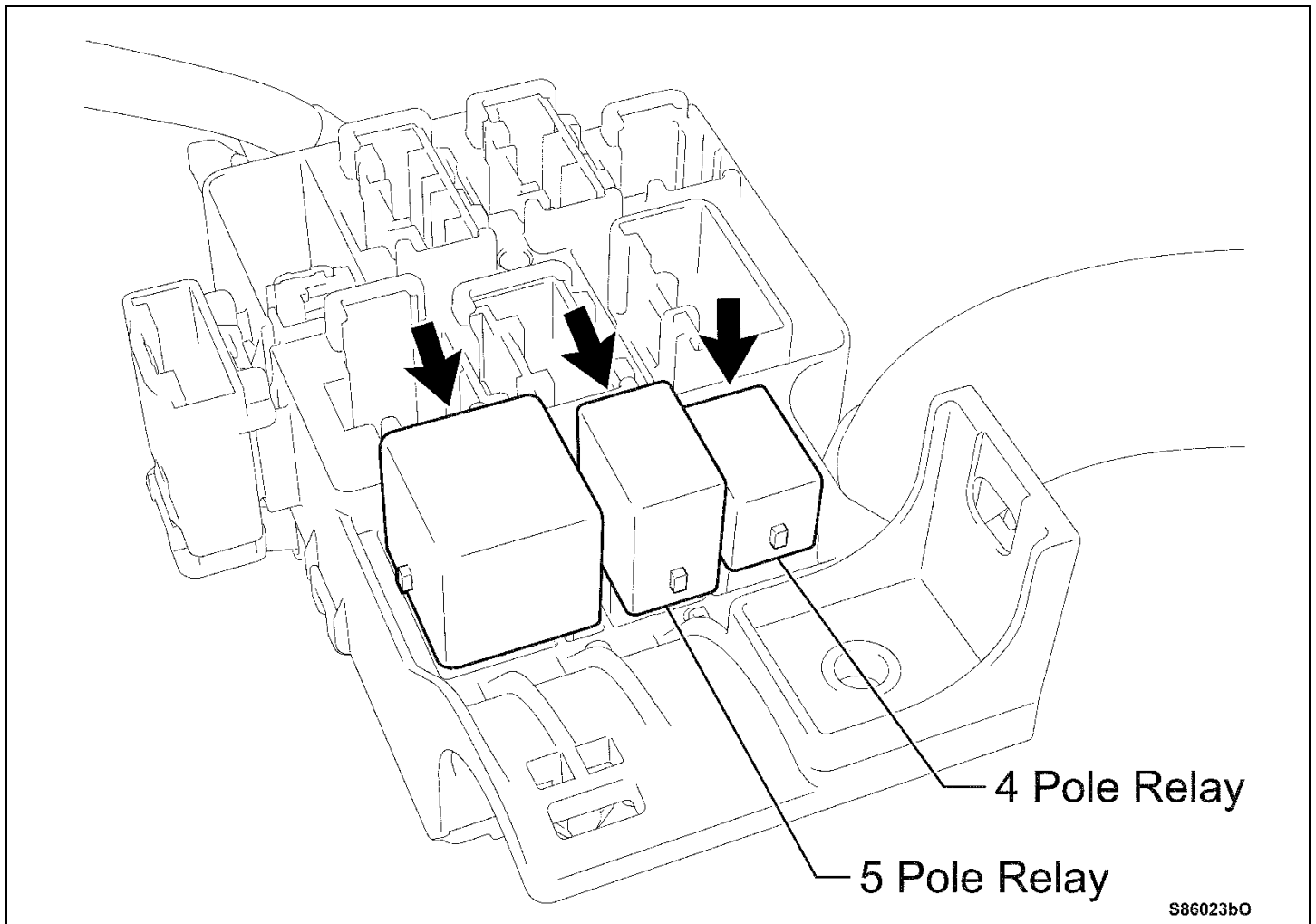

S86023b0

- 1) Instrument panel relay box
 - i. Install the 2 screws and engage the clamp

Torque:

27 in-lbf {3.0 N.m, 31 kgf.cm}

- ii. Engage the 3 clamps
- iii. Connect the 6 engine room main wire connectors to the instrument panel relay box of the **NEW** instrument panel wire.

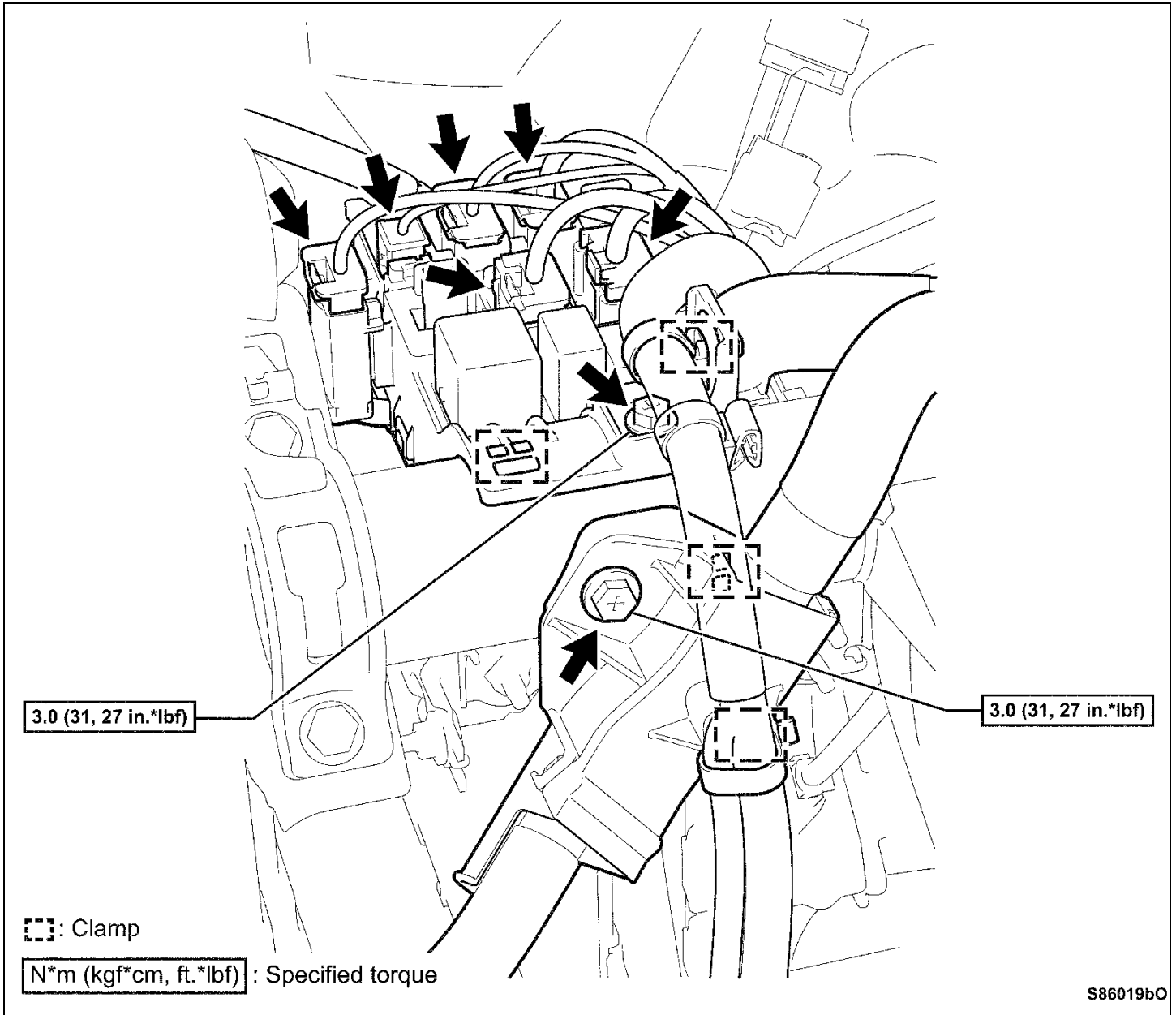

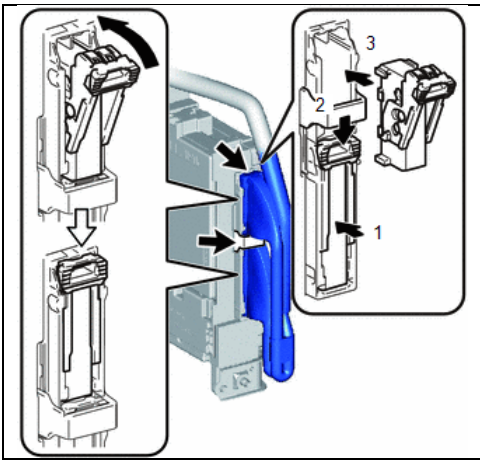

- 2) Instrument panel junction block
- i. Connect the back-side connectors and install the instrument panel junction block as shown in the illustration

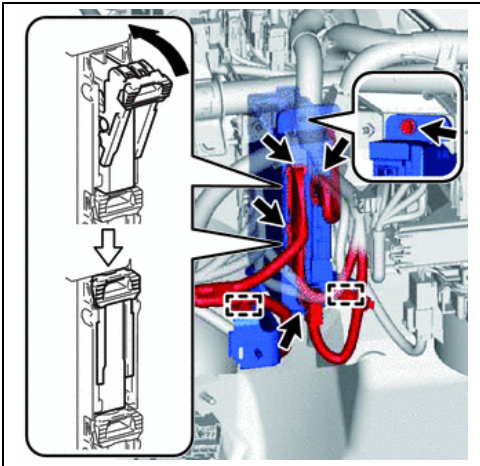

- ii. Install the instrument panel junction block with the bolt

Torque:
74 in-lbf {8.4 N.m, 86 kgf.cm}

- iii. Connect the front side connectors as shown in the illustration
- iv. Engage the clamps

3) Steering column lower section

- i. Engage the 3 clamps
- ii. Connect the connectors

C1: Headlight Dimmer Switch Assembly

C2: Spiral with Sensor Cable Sub-Assembly

C3: Spiral with Sensor Cable Sub-Assembly

C4: Steering Sensor (Spiral with Sensor Cable Sub-Assembly)

C5: Windshield Wiper Switch Assembly

C6: Windshield Wiper Switch Assembly

C7: Un-Lock Warning Switch Assembly

C8: Transponder Key Coil

C9: Key Interlock Solenoid

NOTE:
Connected on AT models only

C10: Ignition or Starter Switch Assembly

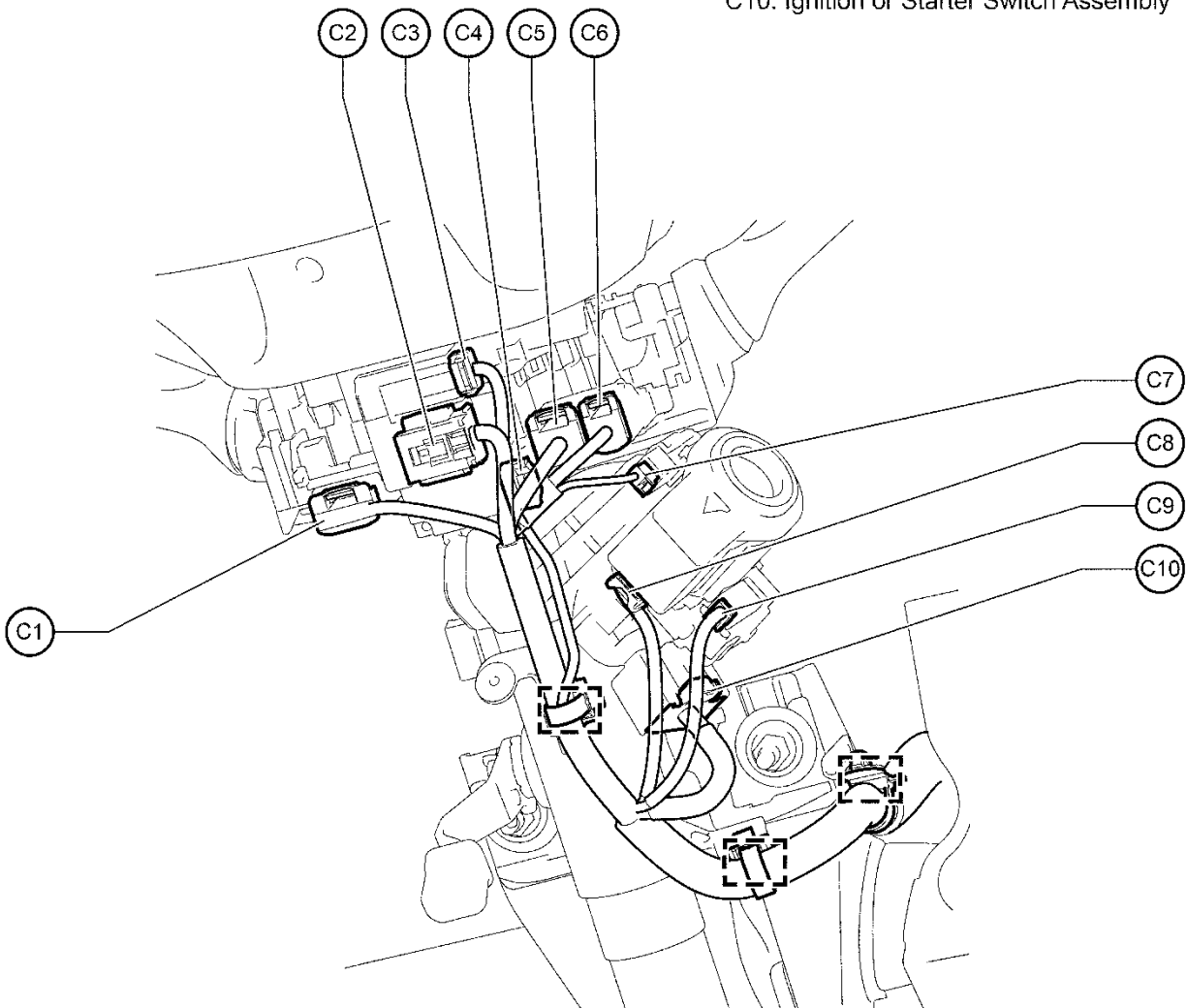

: Clamp

S86012aS

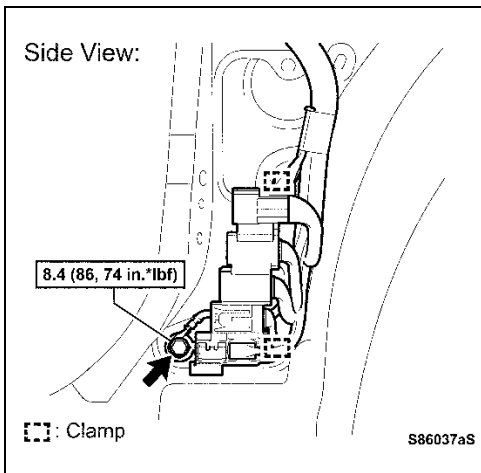

- 4) LH cowl side section
- i. Engage the 2 clamps and install the ground bolt

Torque:

74 in-lbf {8.4 N.m, 86 kgf.cm}

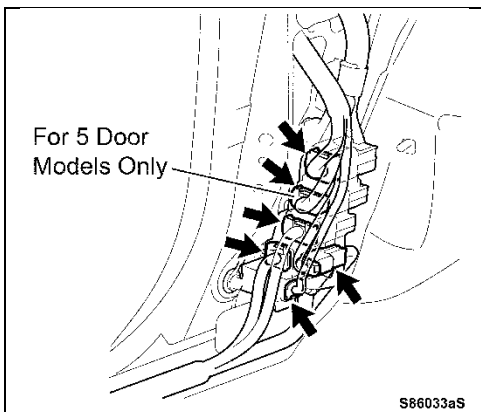

- ii. Connect the floor wire connectors to the connector holder of the **NEW** instrument panel wire on the LH cowl side

a. Connect the connectors, engage the clamps and install the bolt shown in the illustration.

Torque:

74 in-lbf {8.4 N.m, 86 kgf.cm}

NOTE:

- Put a mark on the check sheet after each connection or installation, to ensure that all parts are connected.
- See the following pages for detailed information on section 2) in the illustration below.

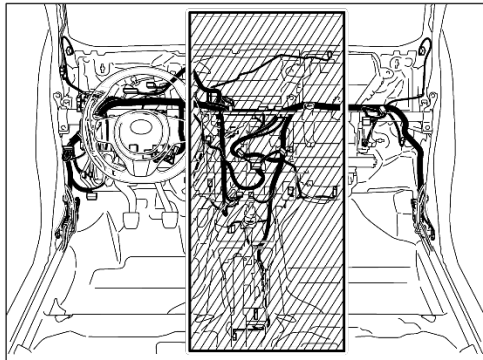

- D1: Telltale Light Assembly
- D2: Radio Receiver Assembly (if equipped)
- D3: Radio Receiver Assembly
- D4: Radio Receiver Assembly
- D5: Radio Receiver Assembly
- D6: Theft Warning Indicator Light Assembly

- D7: Pre-Collision Safety City Buzzer
- D8: No. 1 Heater Control Sub-Assembly
- D9: No. 2 Heater Control Sub-Assembly
- D10: No. 1 Cooler Thermistor
- D11: A/C Amplifier Assembly
- D12: Airbag Sensor Assembly
- D13: Oxygen Sensor (Bank 1 Sensor 2)
- D14: Shift Lock Control Unit Assembly
- D15: Shift Position Light (Indicator Light Wire Sub-Assembly)
- D16: Shift Lock Control Unit Assembly
- NOTE:
Connected on AT models only
- D17: VSC Off Switch
- D18: Parking Brake Switch Assembly

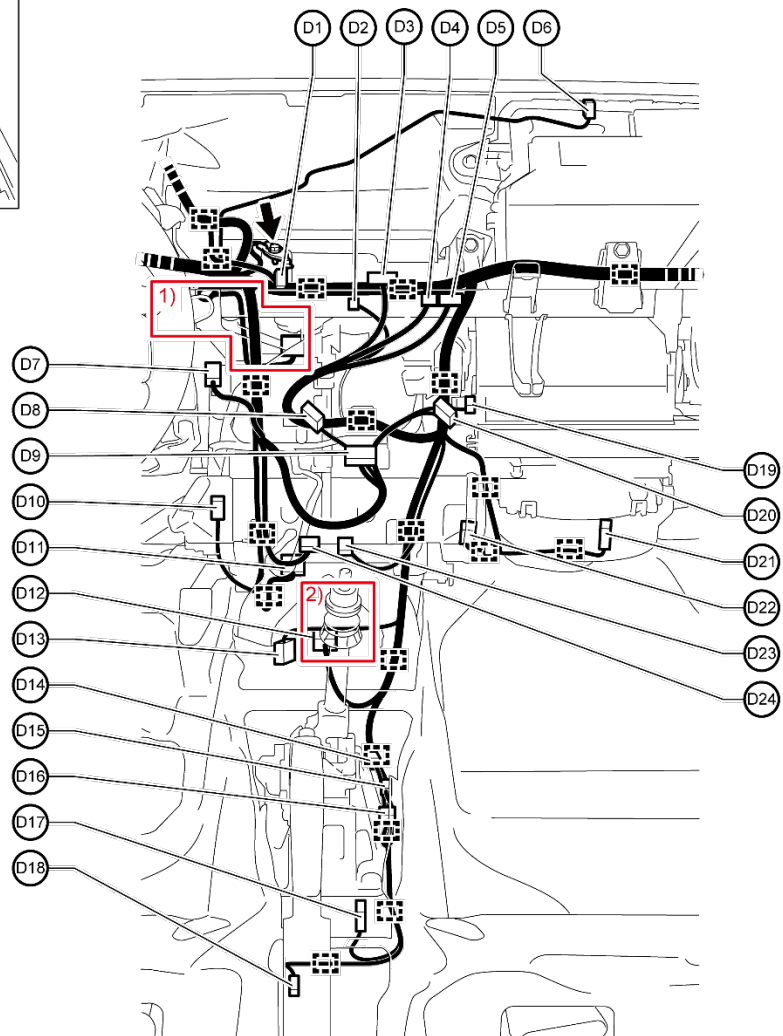

- D19: Amplifier Microphone Assembly (if equipped)
- D20: No. 3 Heater Control Sub-Assembly
- D21: Blower with Fan Motor Sub-Assembly
- D22: Blower Assembly
- D23: No. 1 Stereo Jack Adapter Assembly (if equipped)
- D24: Power Outlet Socket

 Clamp

S86014aS

2) Airbag sensor assembly connector section

- i. Push the airbag sensor assembly connector into the connector housing until it clicks

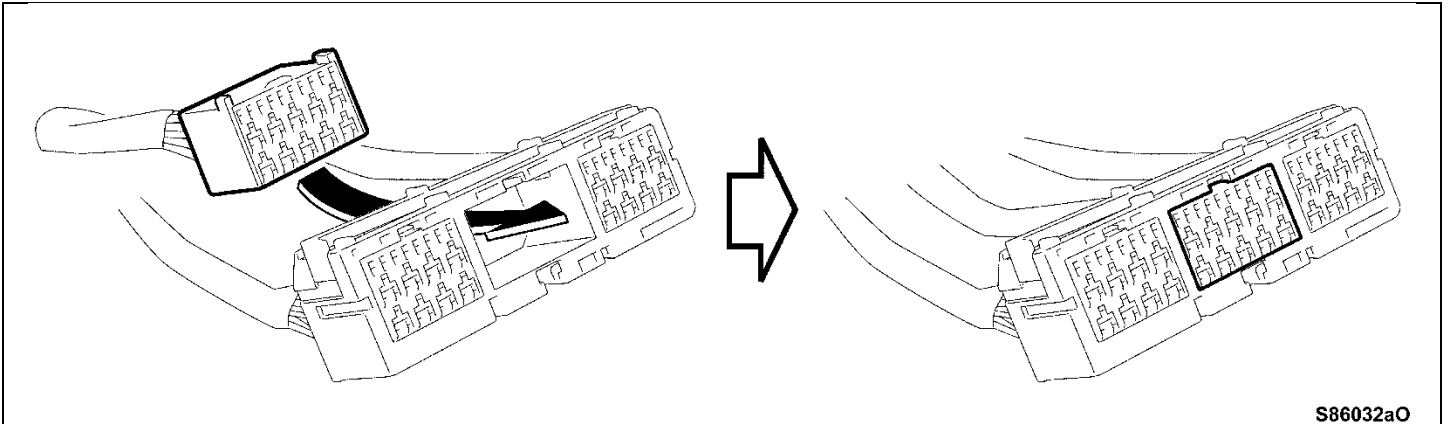

- ii. Reinstall the retainer to lock the connector

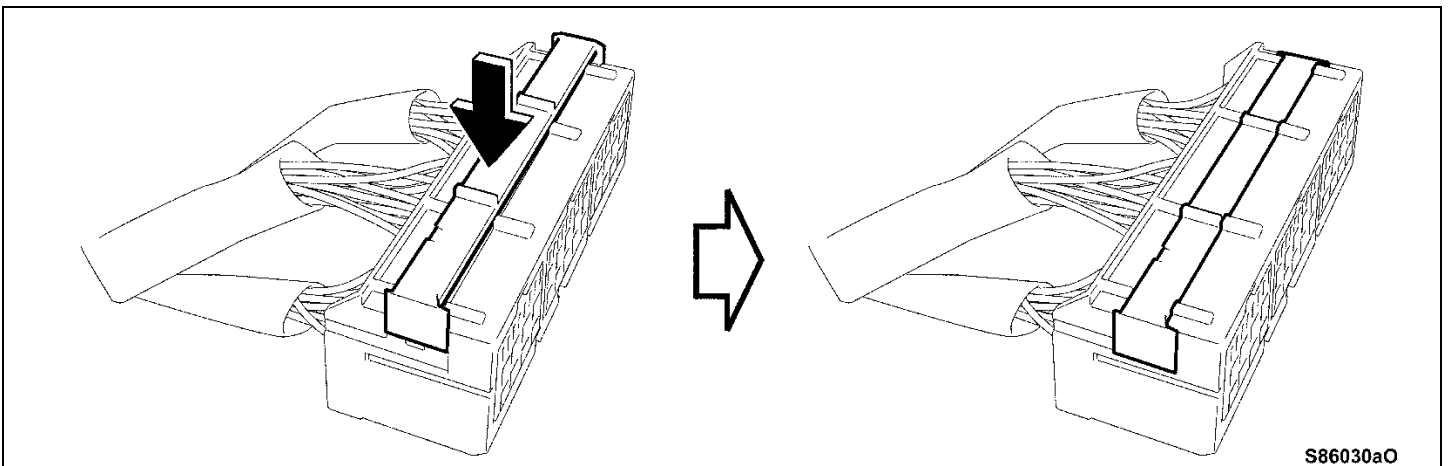

b. Connect the connectors, engage the clamps, and install the bolt shown in the illustration

NOTE:

- Put a mark on the check sheet after each connection or installation, to ensure that all parts are connected.
- See the following pages for detailed information on sections 1) in the illustration below.

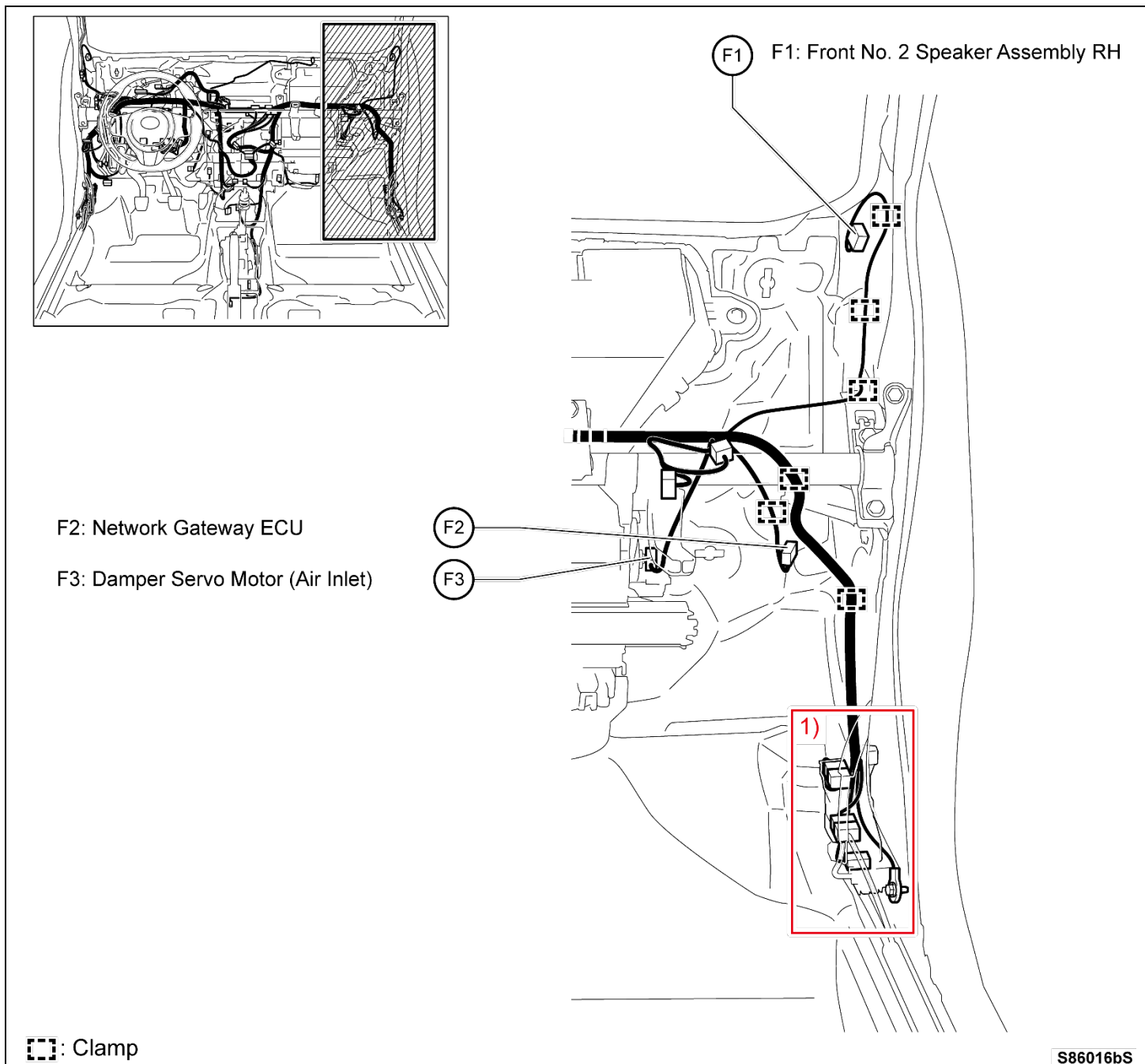

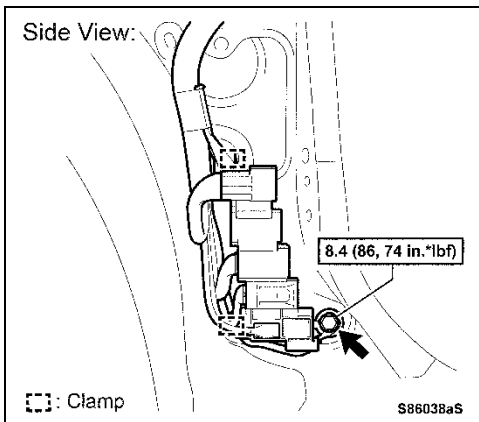

- 5) RH cowl side section
- i. Engage the 2 clamps and install the ground bolt

Torque:
74 in-lbf {8.4 N.m, 86 kgf.cm}

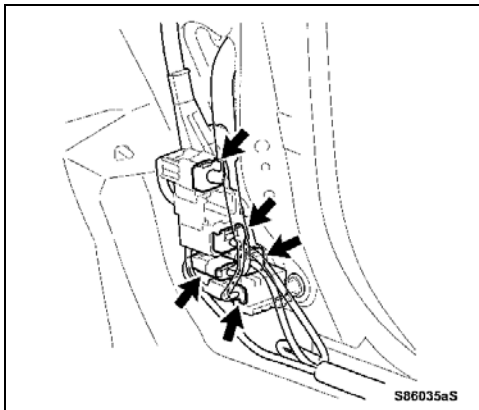

- ii. Connect the 5 floor wire connectors to the connector holder of the NEW instrument panel wire on the RH cowl side

20. REINSTALL THE LOWER INSTRUMENT PANEL SUB-ASSEMBLY
[2017 Yaris Lower Instrument Panel](#)

21. REINSTALL THE UPPER INSTRUMENT PANEL SUB-ASSEMBLY
[2017 Yaris Upper Instrument Panel](#)

22. REINSTALL THE STEERING WHEEL ASSEMBLY
[2017 Yaris Steering Wheel](#)

23. REINSTALL THE STEERING PAD
[2017 Yaris Steering Pad](#)

24. REINSTALL THE COWL TOP OUTER PANEL
[2017 Yaris Cowl Top Outer Panel](#)

25. REINSTALL THE COWL TOP TO COWL INNER BRACE
[2017 Yaris Cowl Top to Cowl Inner Brace](#)

26. REINSTALL THE FRONT AIR SHUTTER SEAL RH
[2017 Yaris Front Air Shutter Seal RH](#)

27. REINSTALL THE FRONT NO.1 VENTILATOR SEAL
[2017 Yaris Front No.1 Ventilator Seal](#)

28. REINSTALL THE WINDSHIELD WIPER MOTOR AND LINK
[2017 Yaris Windshield Wiper Motor and Link](#)

29. RECONNECT THE CABLE TO THE NEGATIVE BATTERY TERMINAL

30. ADD ENGINE COLLANT
31. CHARGE REFRIGERANT
[2017 Yaris Charge Refrigerant](#)
32. INSPECT FOR COOLANT LEAK
[2017 Yaris Coolant Leak Inspection](#)
33. INSPECT FOR REFRIGERANT LEAK
[2017 Yaris Refrigerant Leak Inspection](#)
34. PERFORM HEALTH CHECK USING TECHSTREAM
35. INSPECT SRS WARNING LIGHT
36. RESTORE SETTINGS AFTER RECONNECTING CABLE TO NEGATIVE BATTERY TERMINAL
[2017 Yaris Initialization](#)

◀ VERIFY REPAIR QUALITY ▶

Check for proper HVAC Operation
Check for proper operation of headlights and turn signals
Check for proper operation of the radio
Check for proper operation of the horn

If you have any questions regarding this update, please contact your regional representative.

VIII. APPENDIX

A. PARTS DISPOSAL

As required by Federal Regulations, please make sure all recalled parts (original parts) removed from the vehicle are disposed of in a manner in which they will not be reused, unless requested for parts recovery return.

B. CAMPAIGN DESIGNATION DECORDER

