



Applies To: **See VEHICLES AFFECTED**

February 13, 2014

MIL Is On With DTC P0420 or P0430

(Supersedes , *MIL Is On With DTC P0420 or P0430*, dated January 18, 2014, to revise the information marked by the black bars)

REVISION SUMMARY

Under VEHICLES AFFECTED, vehicle years were changed.

SYMPTOM

The MIL is on with DTC P0420 or DTC P0430 (catalyst system efficiency below threshold) with a possible DTC P2243 or DTC P2247 (A/F sensor 1 circuit high voltage).

POSSIBLE CAUSE

One or both primary A/F Sensor (Air Fuel Ratio) caps may have fallen off and bored a hole through the affected WU-TWC (Warm Up Three Way Catalyst).

VEHICLES AFFECTED

2010 Accord 2-door A/T:

From VIN 1HGCS2B..AA008601 thru
1HGCS2B..AA009464

2010 Accord 2-door M/T:

From VIN 1HGCS2A..AA008781 thru
1HGCS2A..AA008840

2010 Accord 4-door A/T:

From VIN 1HGCP3...AA023009 thru
1HGCP3...AA025113

From VIN 5KBCP3...AB016172 thru
5KBCP3...AB016473

2010 Crosstour 2WD:

From VIN 5J6TF1...AL011378 thru
5J6TF1...AL012391

2010 Crosstour 4WD:

From VIN 5J6TF2...AL009991 thru
5J6TF2...AL011551

2010 Odyssey EX, EX-L, EX RES:

From VIN 5FNRL3...AB069816 thru
5FNRL3...AB086414

2011 Pilot 2WD:

From VIN 5FNYP3...BB006605 thru
5FNYP3...BB007888

2011 Pilot 4WD:

From VIN 5FNYP4...BB00001 thru
5FNYP4...BB017640

2010 Ridgeline:

From VIN 5FPYK1...AB012510 thru
5FPYK1...AB013080

CORRECTIVE ACTION

Replace the affected primary A/F sensor and WU-TWC, then find the missing A/F sensor cap from the under floor TWC.

PARTS INFORMATION

All Models

EGR Pipe Lower Gasket (front WU-TWC replacement):
P/N 18719-R70-A01

EGR Pipe Upper Gasket (front WU-TWC replacement):
P/N 18716-R70-A01

Lower WU-TWC Gasket:
P/N 18212-SA7-003

Self-Locking Nut (8 mm) (four required):
P/N 90212-RCA-A01

Self-Locking Nut (10 mm)(12 required):
P/N 90212-SA5-003

Upper WU-TWC Gasket:
P/N 18115-R70-A01

Under Floor TWC Gasket (Front):
P/N 18393-SDB-A00

Accord

Front A/F Sensor:
P/N 36531-R70-A02

Front WU-TWC:
P/N 18190-R70-A10

Rear A/F Sensor:
P/N 36541-R70-A01

Rear WU-TWC:
P/N 18290-R70-A00

Under Floor TWC Gasket:
P/N 18393-SDB-A00

Crosstour

Front A/F Sensor:
P/N 36531-R70-A02

Front WU-TWC:
P/N 18190-RBR-A00

Rear A/F Sensor:
P/N 36541-R70-A01

Rear WU-TWC:
P/N 18290-RBR-A00

Under Floor TWC Gasket:
P/N 18393-SDB-A00

Odyssey

Cotter Pin (rear WU-TWC replacement):
P/N 90701-S3V-A01

Front A/F Sensor:
P/N 36531-RGW-A01

Front WU-TWC:
P/N 18190-RN0-A01

Intermediate Shaft Snap-Ring
(rear WU-TWC replacement):
P/N 44319-SD4-010

Lower Ball Joint Castle Nut
(rear WU-TWC replacement):
P/N 90363-S3V-A01

Rear A/F Sensor:
P/N 36541-RGW-A01

Rear WU-TWC:
P/N 18290-RGW-A01

Spindle Nut:
P/N 90305-S3V-A11

Under Floor TWC Gasket:
P/N 18302-SP0-003

Pilot

Cotter Pin (rear WU-TWC replacement):
P/N 90701-S3V-A01

Front A/F Sensor:
P/N 36531-R70-A02

Front WU-TWC:
P/N 18190-RN0-A01

Intermediate Shaft Snap-Ring
(rear WU-TWC replacement):
P/N 44319-SD4-010

Lower Ball Joint Castle Nut
(rear WU-TWC replacement):
P/N 90363-S3V-A01

Rear A/F Sensor:
P/N 36541-R70-A01

Rear WU-TWC:
P/N 18290-RGW-A01

Spindle Nut:
P/N 90305-SD4-003

Under Floor TWC Gasket:
P/N 18393-SDB-A00

Ridgeline

Cotter Pin (rear WU-TWC replacement):
P/N 90701-S3V-A01

Front A/F Sensor:
P/N 36531-R70-A02

Front WU-TWC:
P/N 18190-RN0-A01

Intermediate Shaft Snap-Ring
(rear WU-TWC replacement):
P/N 44319-SD4-010

Lower Ball Joint Castle Nut
(rear WU-TWC replacement):
P/N 90363-S3V-A01

Rear A/F Sensor:
P/N 36541-R70-A01

Rear WU-TWC:
P/N 18290-RGW-A01

Spindle Nut:
P/N 90305-S3V-A11

Under Floor TWC Gasket:
P/N 18393-SDB-A00

REQUIRED MATERIALS

Moly 60 Paste: (Odyssey, Pilot, Ridgeline)
P/N 08734-0001

High Temp Urea Grease: (Odyssey, Pilot, Ridgeline)
P/N 08798-9002

TOOL INFORMATION

Ball Joint Remover:
T/N 07MAC-SL0A102

Ball Joint Thread Protector:
T/N 071AF-SZVA000

O2 Sensor Socket Wrench (commercially available)

WARRANTY CLAIM INFORMATION

The normal warranty applies.

Accord

OP#	Description	FRT
1201K5	Procedure A -Replace the front WU-TWC, primary A/F sensor, and check the TWC for cap (includes diagnosis).	1.6 hr
1201K6	Procedure B -Replace the rear WU-TWC, primary A/F sensor, and check the TWC for cap (includes diagnosis, no alignment needed).	1.6 hr

Crosstour

OP#	Description	FRT
1201K5	Procedure A -Replace the front WU-TWC, primary A/F sensor, and check the TWC for cap (includes diagnosis).	1.6 hr
1201K6	Procedure B -Replace the rear WU-TWC, primary A/F sensor, and check the TWC for cap (includes diagnosis, no alignment needed).	1.6 hr

Odyssey

OP#	Description	FRT
1201K5	Procedure A -Replace the front WU-TWC, primary A/F sensor, and check the TWC for cap (includes diagnosis).	1.7 hr
1201K6	Procedure B -Replace the rear WU-TWC, primary A/F sensor, and check the TWC for cap (includes diagnosis and alignment).	1.6 hr

Pilot

OP#	Description	FRT
1201K5	Procedure A -Replace the front WU-TWC, primary A/F sensor, and check the TWC for cap (includes diagnosis).	1.6 hr
1201K6	Procedure B -Replace the rear WU-TWC, primary A/F sensor, and check the TWC for cap (includes diagnosis and alignment).	2.1 hr

Ridgeline

OP#	Description	FRT
1201K5	Procedure A -Replace the front WU-TWC, primary A/F sensor, and check the TWC for cap (includes diagnosis).	1.4 hr
1201K6	Procedure B -Replace the rear WU-TWC, primary A/F sensor, and check the TWC for cap (includes diagnosis and alignment).	1.5 hr

Failed Part: P/N 36541-R70-A01

Defect Code: 07801

Symptom Code: 03203

Skill Level: Repair Technician

DIAGNOSIS

1. Connect the HDS to the vehicle and check for DTCs P0420 or P0430.
NOTE: In addition to DTCs P0420 or P0430, you may also see DTCs P2243 or P2247 stored; the tip may have broken off the primary A/F sensor.
2. Remove the primary A/F sensor on top of the affected catalytic converter. For example: If DTC P0420 is stored remove the rear (bank one) primary A/F sensor.

3. Check for a missing cap from the primary A/F sensor.

GOOD

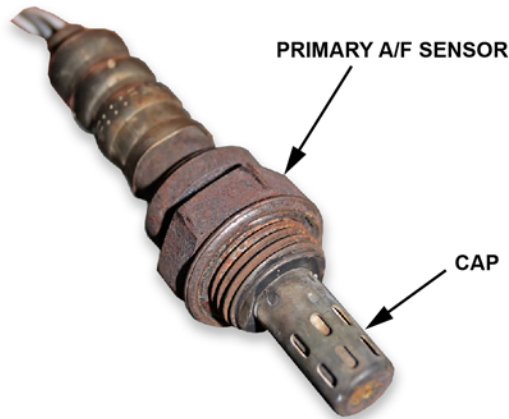

NO GOOD



- If DTC P0430 is stored and the cap is missing from the front (bank two) primary A/F sensor, go to REPAIR PROCEDURE A.
- If DTC P0420 is stored and the cap is missing from the rear (bank one) primary A/F sensor, go to REPAIR PROCEDURE B.
- If the cap is not missing, this bulletin does not apply. Continue with normal troubleshooting.

ELECTRONIC SERVICE MANUAL PROCEDURES

The following procedures have been used in full or in part within this service bulletin. For more detail on them, and torque specifications for some components, refer to the appropriate electronic service manual.

- Condenser Fan Removal/Installation
- Driveshaft Removal/Installation
- A Pipe Removal/Installation
- Warm Up TWC Removal/Installation
- Under Floor TWC Removal/Installation

REPAIR PROCEDURE A

1. Remove the engine cover.

Pilot shown:

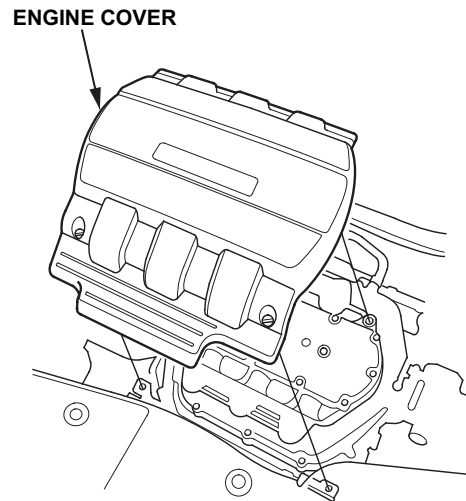

2. If not already disconnected, disconnect the 4P connector and remove the front primary A/F sensor.

Pilot shown:

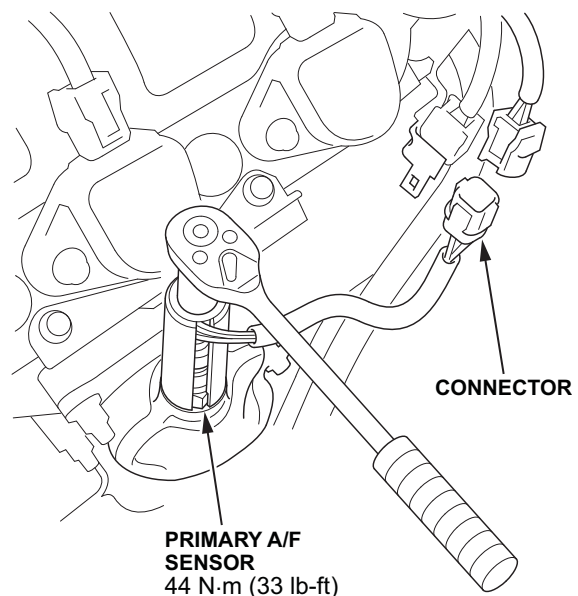

3. Disconnect the 4P connector and remove the harness clamps securing the front secondary A/F sensor harness.

Pilot shown:

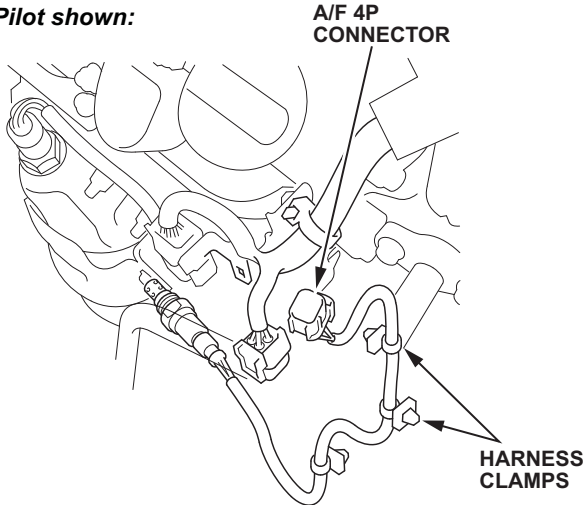

4. Remove the front secondary A/F sensor.

Pilot shown:

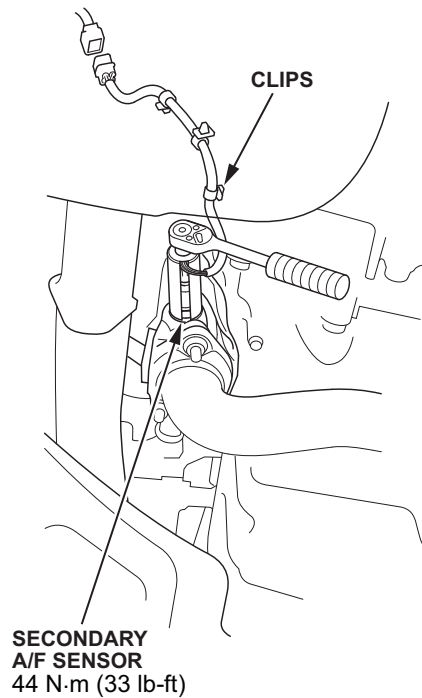

5. Remove the EGR pipe.

Pilot shown:

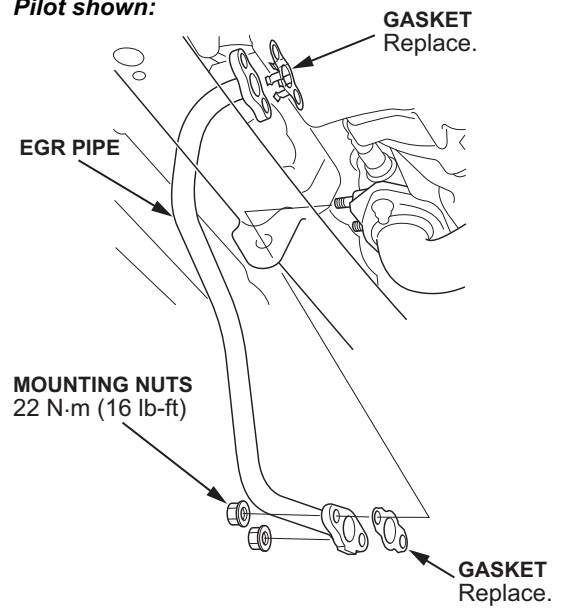

6. If necessary, remove the A/C condenser fan shroud assembly.

NOTE: Place an appropriate size piece of cardboard in front of the radiator. This protects the radiator from damage when removing the front catalytic converter.

Pilot shown:

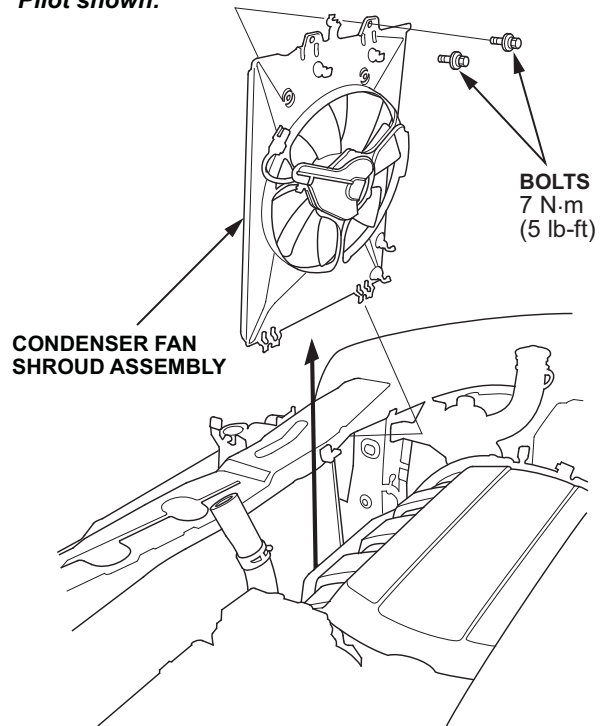

- Remove the No. 5 ignition coil and the ignition coil heat insulator.

Pilot shown:

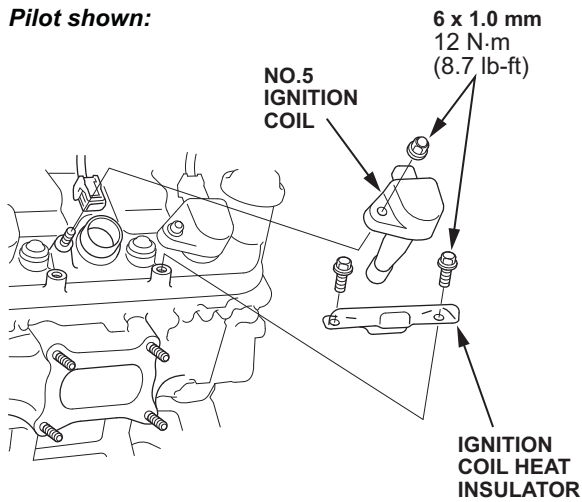

- Raise the vehicle.
- Remove the exhaust pipe hangers then remove the exhaust pipe A.

Pilot shown:

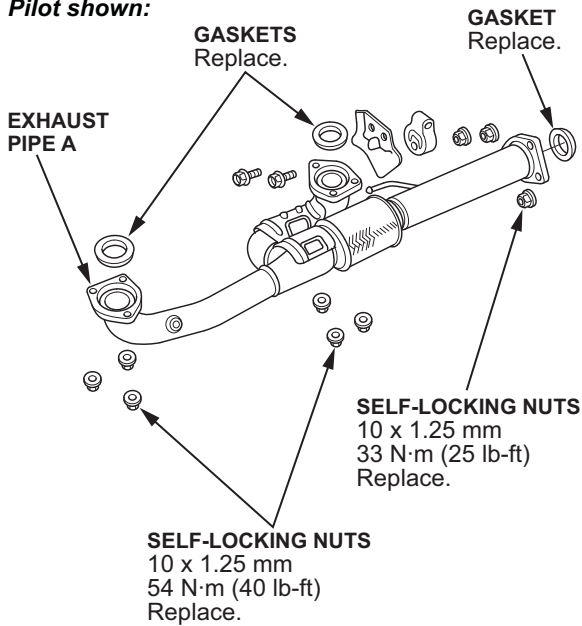

- Remove the front WU-TWC.

Pilot shown:

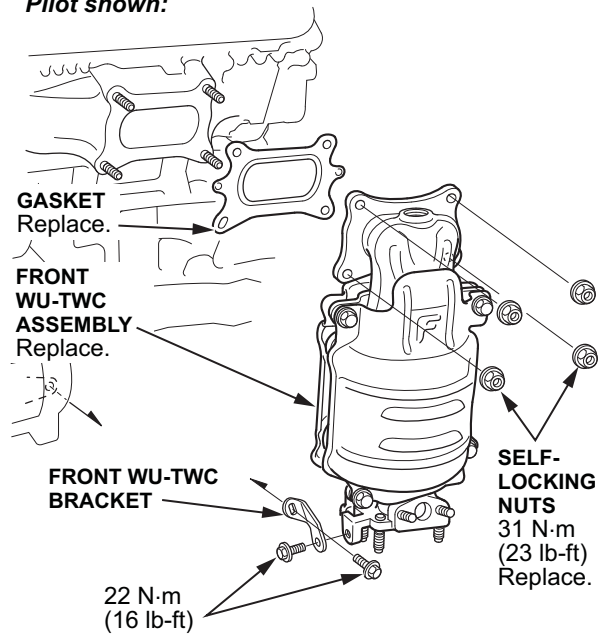

- Go to UNDER FLOOR TWC and check for the missing primary A/F sensor cap.

REPAIR PROCEDURE B

1. Remove the engine cover.

Pilot shown:

ENGINE COVER

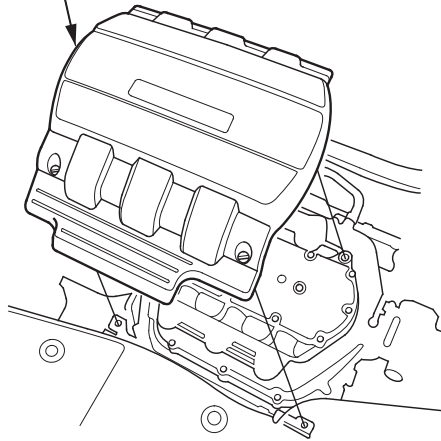

2. Disconnect the connector and remove the rear primary A/F sensor.

Pilot shown:

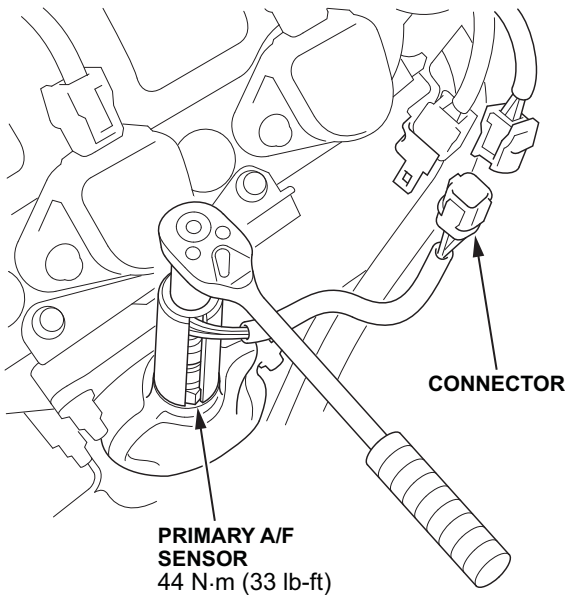

3. Raise the vehicle.

4. Remove the rear secondary A/F sensor.

Pilot shown:

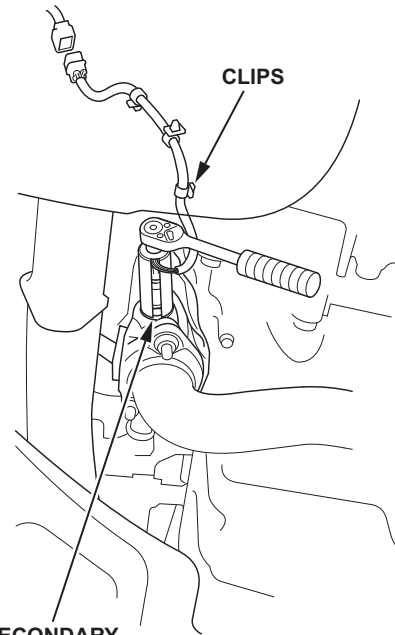

5. Remove the right front wheel.
6. *Odyssey, Pilot, and Ridgeline only:* Remove the brake hose mounting bolt from the right damper.

Pilot shown:

BRAKE HOSE
MOUNTING BOLT
22N·m (16 lb-ft)

BRAKE HOSE

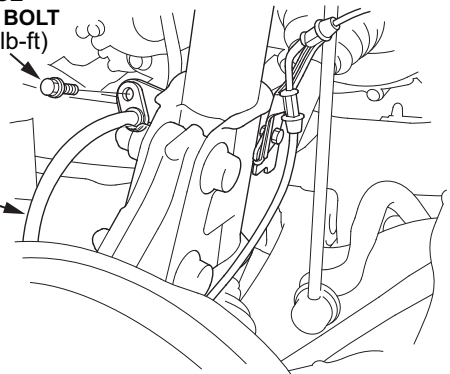

7. *Odyssey, Pilot and Ridgeline only:* Separate the right lower ball joint.

Pilot shown:

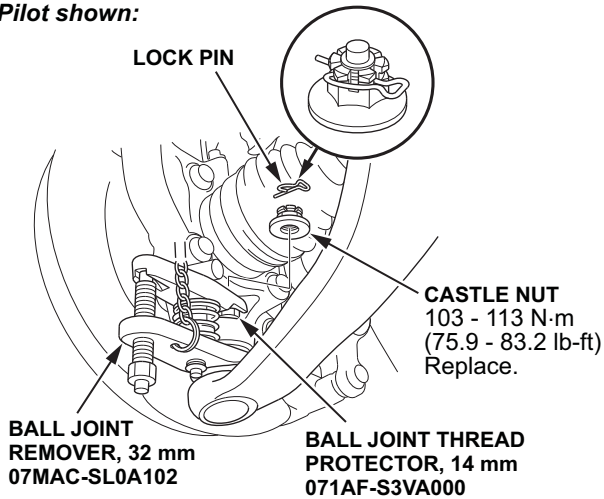

8. *Odyssey, Pilot and Ridgeline only:* Remove the spindle nut.
9. *Odyssey, Pilot and Ridgeline only:* Remove the right driveshaft.

NOTE: Drive the inboard joint off the intermediate shaft using a drift and hammer. **Do not** pull on the driveshaft or the inboard joint may come out.

Pilot shown:

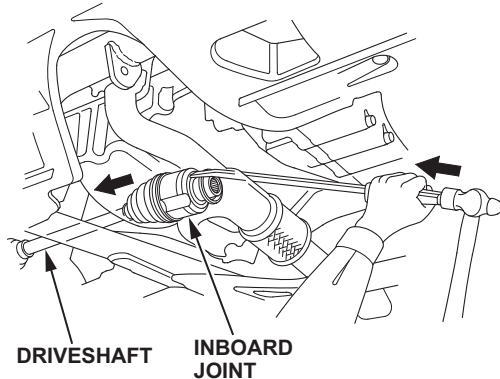

10. Remove the rear WU-TWC exhaust pipe bracket.

Pilot shown:

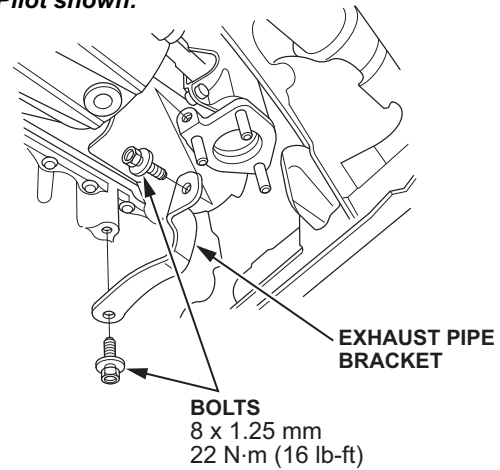

11. Remove the rear WU-TWC.

Pilot shown:

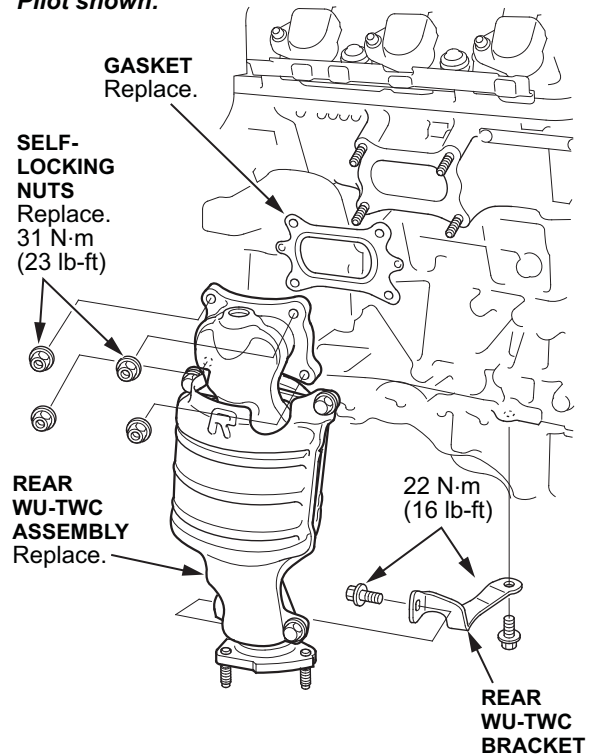

12. Go to UNDER FLOOR TWC, and check for the missing primary A/F sensor cap.

UNDER FLOOR TWC

1. Remove the under floor TWC.

Pilot shown:

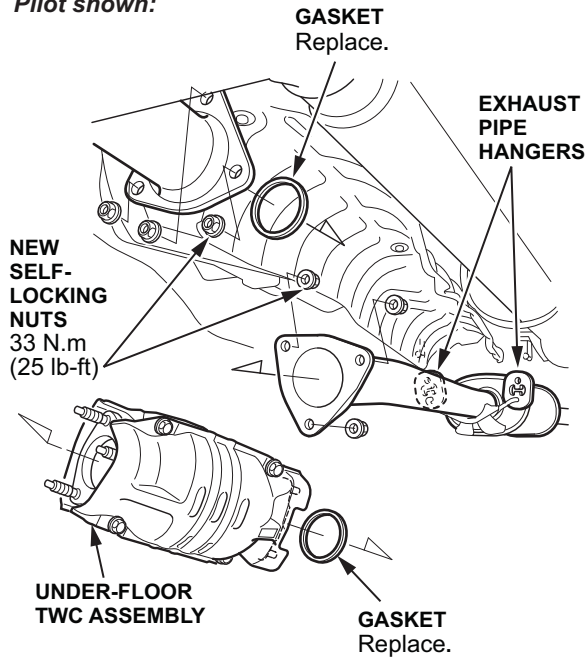

2. Search the under floor TWC for the missing primary A/F sensor cap and remove it.
3. Install all parts in the reverse order of removal.
4. Check wheel alignment and adjust if necessary.