

Antenna Installation During PDS

Service Category General

Section Pre-Delivery Service

Market USA

Toyota Supports
 ASE Certification 

Applicability

YEAR(S)	MODEL(S)	ADDITIONAL INFORMATION
2015	4Runner, Sienna, Tacoma, Tundra	

Introduction

The radio antenna pole on some models is designed with a hex-cut base and requires installation using an 8 mm wrench. When performing PDS or installing the antenna pole for any other reason, inspect the antenna base for a hex-cut to determine if the following procedure is required.

Warranty Information

OP CODE	DESCRIPTION	TIME	OFD	T1	T2
N/A	Not Applicable to Warranty	–	–	–	–

Installation Procedure

The radio antenna pole and wrench are loaded inside the vehicle at the assembly plant to avoid damage in transit. Install the antenna during PDS according to the instructions below and place the wrench in the glove box for the customer.

1. Remove the protective shipping plug from the antenna base of the fender.
2. Screw the antenna pole into the antenna base and tighten by hand until fully seated.

Antenna Installation During PDS

Installation Procedure (Continued)

- Using an 8 mm wrench, fully tighten the antenna pole by rotating the base 1/8 of a turn (20 to 45 degrees) clockwise.

Torque: 3.3 N*m (34 kgf*cm, 29 in*lb)

NOTICE

- Do NOT overtighten.
- Do NOT use pliers to tighten the antenna pole as damage can occur to the antenna pole surface.

NOTE

The antenna pole cannot be tightened by hand to the proper specification.

Figure 1.

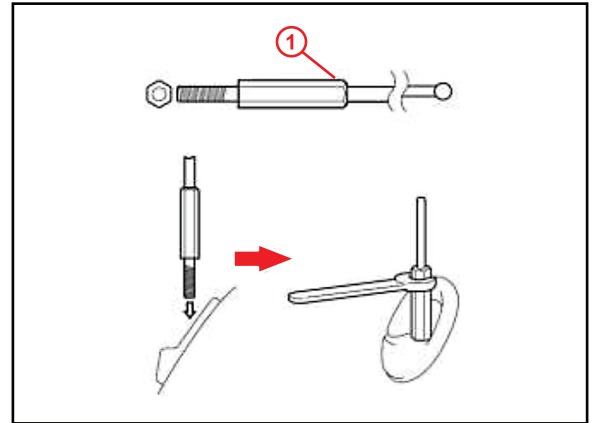

1	Hex-cut Type Antenna
----------	----------------------