

Premium HDD Navigation Gracenote[®] Database Update Process (AVN/AW-EMV)

Service Category Audio/Visual/Telematics

Section Navigation/Multi Info Display

Market USA

Toyota Supports
 ASE Certification 

Applicability

| YEAR(S) | MODEL(S) | ADDITIONAL INFORMATION |
|-------------|--|------------------------|
| 2013 | Avalon, Avalon HV, Land Cruiser, Venza | |
| 2012 – 2013 | Camry, Camry HV, Prius, Prius PHV, Prius V | |
| 2012 | RAV4 EV | |

Introduction

Toyota models equipped with the Premium HDD Navigation (AVN/AW-EMV) System will periodically require an update to the Gracenote[®] Database. Gracenote[®] includes detailed information for songs (i.e. Genre, Artist, Song Title, Album Name, etc.). The Gracenote[®] update will be included on the "USB Drive – Navigation Update" SST. A Gracenote[®] update must be performed before a Navigation Map Update. A Navigation Map Update is not required to complete the Gracenote[®] update. Use the process described in this bulletin to perform the update.

Required Tools & Equipment

| SPECIAL SERVICE TOOLS (SST) | PART NUMBER | QTY |
|-------------------------------|---------------|-----|
| USB Drive - Navigation Update | TOYD-HDD07-12 | 1 |

* Essential SST.

NOTE

Additional SSTs may be ordered by calling 1-800-933-8335.

Warranty Information

| OP CODE | DESCRIPTION | TIME | OFP | T1 | T2 |
|---------|----------------------------|------|-----|----|----|
| N/A | Not Applicable to Warranty | – | – | – | – |

Premium HDD Navigation Gracenote® Database Update Process (AVN/AW-EMV)

Repair Procedure

1. Turn Ignition ON (Ready OFF).
2. Insert the USB Drive — Navigation Update SST into the USB port of the vehicle (usually located under the navigation head unit, center console/armrest, or glove box).
3. Press the “Setup” button on the navigation head unit.

Figure 1.

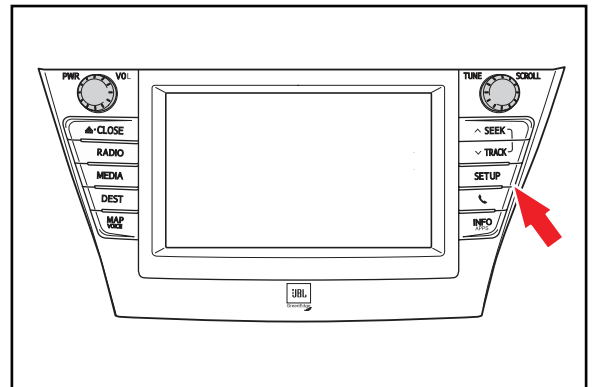

4. Select "General" on the navigation head unit.

Figure 2.



5. Press the down arrow and then select “Gracenote Database Update”.

Figure 3.

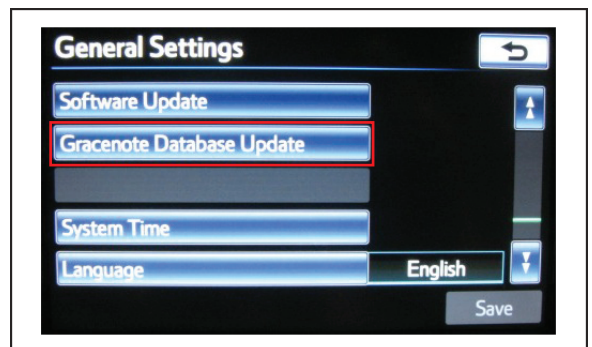

Premium HDD Navigation Gracenote® Database Update Process (AVN/AW-EMV)

Repair Procedure (Continued)

6. Select "Update" on the navigation head unit.

Figure 4.

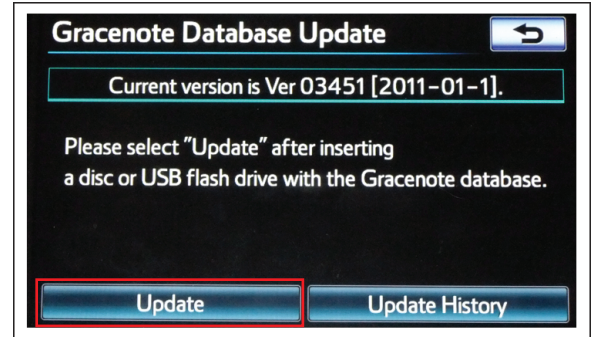

7. Select "Yes" on the navigation head unit.

Figure 5.

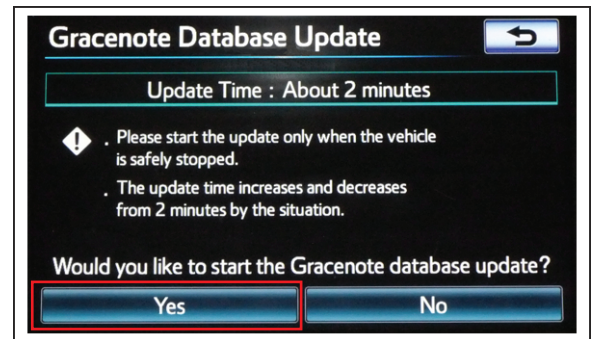

8. Gracenote Database Update will begin automatically.

Figure 6.

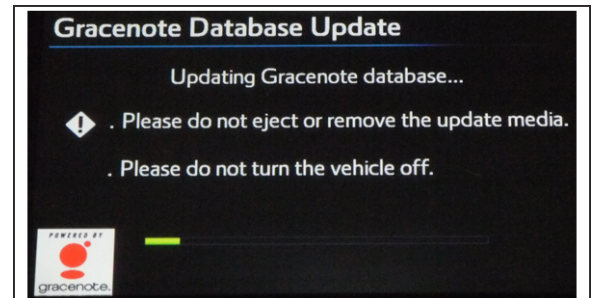

NOTE
This process will take about 2 minutes.

Premium HDD Navigation Gracenote® Database Update Process (AVN/AW-EMV)

Repair Procedure (Continued)

9. The head unit will display the new Gracenote version upon completion.

The head unit is now ready for a Navigation Map Update (if desired).

Figure 7.

