

# Drive Belt Squeal Noise on Cold Start

**Service Category** Engine/Hybrid System

**Section** Engine Mechanical

**Market** USA

Toyota Supports  
 ASE Certification 

## Applicability

YEAR(S)	MODEL(S)	ADDITIONAL INFORMATION
2006 – 2015	Yaris	

## Introduction

Some 2006 – 2015 model year Yaris vehicles may exhibit a squealing noise coming from the engine compartment during the engine start-up. The drive belt (v-belt) tension specification has been updated to address this condition.

## Production Change Information

This bulletin applies to vehicles produced **BEFORE** the Production Change Effective VINs shown below.

MODEL	PRODUCTION CHANGE EFFECTIVE VIN
Yaris	VNKKTUD3#FA028439

## Warranty Information

OP CODE	DESCRIPTION	TIME	OFF	T1	T2
EG1500	Inspect V-Belt and Adjust Tension	0.2	90916-02705	91	14
EG1501	R & R V-Belt and Adjust Tension	0.4	90916-02705		

### APPLICABLE WARRANTY

- This repair is covered under the Toyota Basic Warranty. This warranty is in effect for 36 months or 36,000 miles, whichever occurs first, from the vehicle's in-service date.
- Warranty application is limited to occurrence of the specified condition described in this bulletin.

## Drive Belt Squeal Noise on Cold Start

### Parts Information

PART NUMBER	PART NAME	QTY
90916-02705	Belt, V-Ribbed	1

### Required Tools & Equipment

REQUIRED TOOLS & EQUIPMENT	PART NUMBER	QTY
Denso BTG-20 (Belt Tension Gauge)	95506-00020	1

### Repair Procedure

1. Verify the condition as described in the Introduction.
2. Inspect the V-Belt physical condition and tension.

**NOTE**  
Visually check the belt for excessive wear, frayed cords etc.

What is the condition of the V-Belt?

- **V-Belt is physically OK and tension is within specifications (350 Nm – 400 Nm)** — This bulletin does NOT apply. Continue diagnosis using the applicable Repair Manual.
- **V-Belt shows signs of fraying, scoring, or glazing** — Continue to step 3.
- **V-Belt is physically OK but tension is below 350 Nm** — Continue to step 4.

Figure 1.

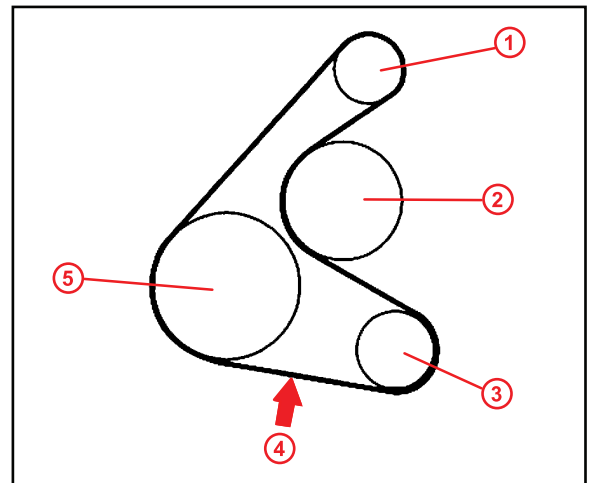

1	Alternator
2	Water Pump
3	Compressor
4	Measure Point for Belt Tension
5	Crankshaft Pulley

## Drive Belt Squeal Noise on Cold Start

### Repair Procedure (Continued)

3. Replace the V-Belt.

**NOTE**

See the **NEW V-Belt specifications on page 4 of this bulletin.**

Refer to the Technical Information System (TIS), applicable model and model year Repair Manual:

- Yaris H/B [2006](#) / [2007](#) / [2008](#) / [2009](#) / [2010](#) / [2011](#) / [2012](#) / [2013](#) / [2014](#) / [2015](#):  
*Engine/Hybrid System – Engine Mechanical– “1NZ-FE Engine Mechanical: Drive Belt: Removal”*
- Yaris Sedan [2012](#) / [2013](#) / [2014](#) / [2015](#):  
*Engine/Hybrid System – Engine Mechanical– “1NZ-FE Engine Mechanical: Drive Belt: Removal”*
- Yaris H/B [2006](#) / [2007](#) / [2008](#) / [2009](#) / [2010](#) / [2011](#) / [2012](#) / [2013](#) / [2014](#) / [2015](#):  
*Engine/Hybrid System – Engine Mechanical– “1NZ-FE Engine Mechanical: Drive Belt: Installation”*
- Yaris Sedan [2012](#) / [2013](#) / [2014](#) / [2015](#):  
*Engine/Hybrid System – Engine Mechanical– “1NZ-FE Engine Mechanical: Drive Belt: Installation”*

4. Increase the V-Belt tension up to 400 Nm.

A. Loosen bolt A.

**NOTE**

Do NOT loosen bolt B.

**Figure 2.**

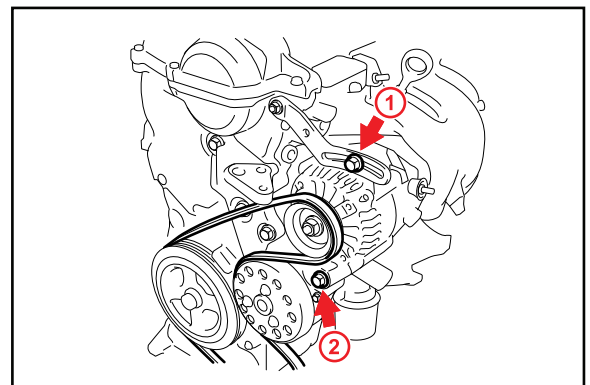

<b>1</b>	<b>Bolt A</b>
<b>2</b>	<b>Bolt B</b>

## Drive Belt Squeal Noise on Cold Start

### Repair Procedure (Continued)

B. Use a pry bar to increase V-Belt tension up to a maximum of 400Nm.

**Figure 3.**

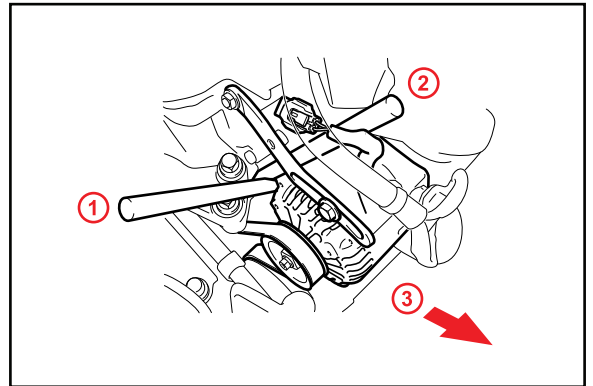

1	OK
2	Not Good
3	Front of the Vehicle

V-BELT	TENSION SPECIFICATION
Used	375 Nm – 400 Nm
New	750 Nm – 850 Nm

**Figure 4.**

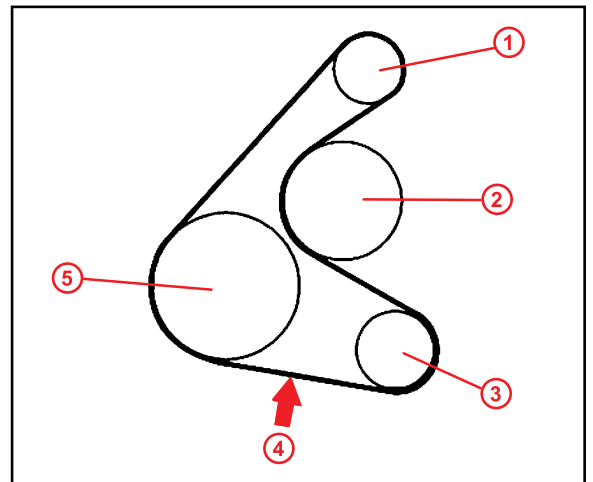

1	Alternator
2	Water Pump
3	Compressor
4	Measure Point for Belt Tension
5	Crankshaft Pulley

5. Verify the noise is no longer present.