



Technical Bulletin 188

03.2018

Contents

Item	Subject	Model Affected
188.1	Triumph Diagnostic Tool Compatibility with Windows Operating Systems	Not Applicable
188.2	Fog Lights Warning	Tiger XRX, Tiger XCX, Tiger XRT, Tiger XCA and Tiger XRX LRH
188.3	TFT Instruments - Calibration Update	Street Triple R, Street Triple R - LRH, Street Triple RS
188.4	Exhaust Header Nuts Tightening Sequence	Bonneville T100, Bonneville T100 Black, Street Scrambler, Street Cup, Street Twin, Bonneville T120, Bonneville T120 Black, Bonneville Bobber, Bonneville Bobber Black, Bonneville Speedmaster, Thruxton, Thruxton R
188.5	Hugger Fixing	Tiger Sport
188.6	Pinpoint Test - Brake Switches	Street Triple S, Street Triple S - LRH and Street Triple S 600cc A2 Restricted Licence Version
188.7	Pinpoint Test - Brake Switches	Street Triple R, Street Triple R - LRH and Street Triple RS
188.8	Alternator Cover Parts Kit	Tiger 800, Tiger 800 ABS, Tiger 800 XC, Tiger 800 XC ABS - from engine number 612714, except engine number 613308 to 613370
188.9	Alternator Cover Parts Kit	Tiger 800 XRX, Tiger 800 XRX LRH, Tiger 800 XR, Tiger 800 XCX, Tiger 800 XCX LRH, Tiger 800 XC - up to engine number 768815, all markets except Brazil
188.10	Alternator Cover Parts Kit	Tiger 800 XRX, Tiger 800 XRX LRH, Tiger 800 XR, Tiger 800 XCX, Tiger 800 XCX LRH, Tiger 800 XC - up to engine number 763462, Brazilian market only
188.11	Starter Motor Parts Kit	Tiger 800 - up to engine number 612713 and engine number 613308 to 613370
188.12	Starter Motor Parts Kit	Tiger 800 XRT - up to engine number 818365, all markets except Brazil and India
188.13	Starter Motor Parts Kit	Tiger 800 XCA - up to engine number 808365, all markets except Brazil and India
188.14	Starter Motor Parts Kit	Tiger 800 XRT and Tiger 800 XCA - up to engine number 817335, Brazilian market only



Technical Bulletin 188

03.2018

Contents

188.15	Starter Motor Parts Kit	Tiger 800 XRX, Tiger 800 XRX LRH, Tiger 800 XR, Tiger 800 XCX, Tiger 800 XCX LRH, Tiger 800 XC - up to engine number 818365, all markets except Brazil and India
188.16	Starter Motor Parts Kit	Tiger 800 XRX, Tiger 800 XRX LRH, Tiger 800 XR, Tiger 800 XCX, Tiger 800 XCX LRH, Tiger 800 XC - up to engine number 818252, Brazil and Indian markets only
188.17	Starter Motor Parts Kit	Tiger 800, Tiger 800 ABS, Tiger 800 XC, Tiger 800 XC ABS, Tiger 800 XC ABS Special Edition - from engine number 612714, except engine numbers 613308 to 613370

Item: 188.1

Description: Triumph Diagnostic Tool Compatibility with Windows Operating Systems

Model Affected: Not Applicable

From April 2018, the Triumph Diagnostic Tool will no longer operate on computers running Microsoft Windows XP® or Vista®.

Users still using these operating systems should upgrade their operating systems, and if necessary their hardware, before April 2018.

Further reminders and details of the software version incorporating this change will be provided in the coming months.

Details of the minimum equipment required to run the Triumph Diagnostic Tool are listed below:

- A desktop or laptop Personal Computer (PC) running 32 bit or 64 bit versions of Microsoft Windows 7®, Windows 8®, Windows 8.1® or Windows 10®.
- A 1 GHz processor or equivalent, 10 GB of free hard disk space and a minimum of 512 to 1024 MB of memory (RAM).
- The PC must have a free USB (Universal Serial Bus) port.
- The PC must be connected to the internet (Broadband is not essential but is preferred).
- 1024 x 768 standard XGA monitor or a 1200 x 800 widescreen monitor.
- Administrator level access is required for software installation and updates.

Item: 188.2
Description: Fog Lights Warning
Model Affected: Tiger XRX, Tiger XCX, Tiger XRT, Tiger XCA and Tiger XRX LRH

Warning

Before starting work, ensure the motorcycle is stabilised and adequately supported. This will help prevent it from falling and causing injury to the operator or damage to the motorcycle.

Fog Lights Warning Display

If the FOG LIGHTS FAULT warning is displayed in the information tray, use the Triumph Diagnostic Tool to check and, if necessary, install the latest software for the instruments.

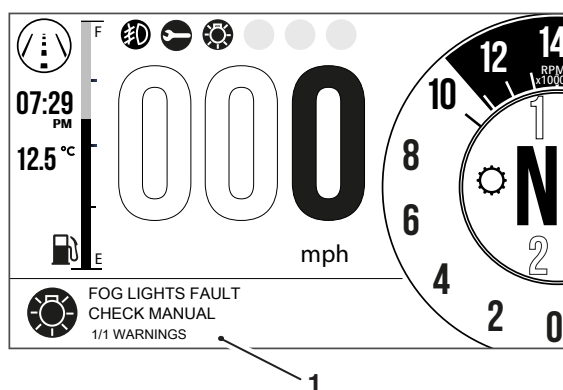

1. Information tray

Motorcycles without Fog Lights

If the FOG LIGHTS FAULT warning is still displayed in the information tray, follow the procedures described below.

1. Remove the rider's seat as described in the Owner's Handbook.
2. Check for fitment of the fog light relay.

Note:

- The fog light relay is located next to the fuse box under the rider's seat.

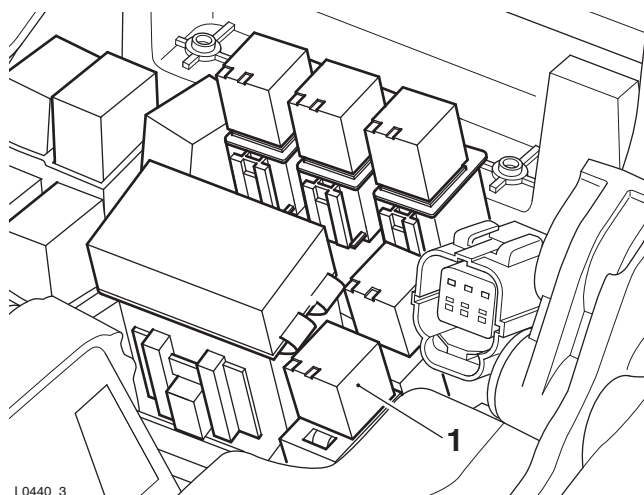

1. Fog light relay

3. If the fog light relay is not fitted, navigate to the MAIN MENU in the instruments and RESET TO DEFAULTS as described in the owner's handbook.
4. If the relay is fitted, remove the relay and then navigate to the MAIN MENU in the instruments and RESET TO DEFAULTS as described in the Owner's handbook.

Motorcycles with Fog Lights

If the FOG LIGHTS FAULT warning is still displayed in the information tray, follow the procedures described below.

1. Remove the rider's seat as described in the owner's Handbook.

Note:

- **The fog light relay is located next to the fuse box under the rider's seat.**
2. Check that the fog light relay is fitted as shown in the illustration below.

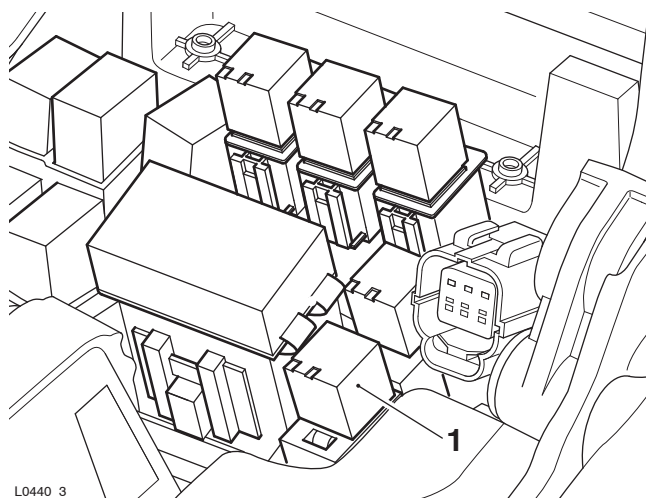

1. Fog light relay

3. If fog lights are fitted but the relay is not fitted, fit the relay. Refer to EPC for part number.
4. If the FOG LIGHTS FAULT warning is still illuminated, check the harness for open circuit between the instruments and the fog light relay connector (see Fog Light Fault - Pinpoint Test below).

Fog Light Fault - Pinpoint Test

Fault Code	Possible Cause	Action
Fog Lights Fault	Fog light relay is not fitted Open circuit between fog light relay and instruments	Fit the fog light relay Proceed to pinpoint test 1

Pinpoint Test

Test	Result	Action
1 Check cable and terminal integrity: - Instrument connector pin 8 and fog light relay pin 2 Ignition switch pin 4 and fog light relay pin 1	OK	Proceed to test 2
	Faulty	Rectify fault, proceed to test 4
2 Check cable continuity: - Instrument connector pin 8 and fog light relay pin 2	OK	Proceed to test 3
	Faulty	Locate and rectify fault, proceed to test 4

3	Check cable continuity: -Ignition switch pin 4 and fog light relay pin 1	OK	Proceed to test 4
		Faulty	Locate and rectify fault, proceed to test 4
4	Test the fog lights	OK	Action complete - quit test
		Faulty	Contact Triumph service

Circuit Diagram

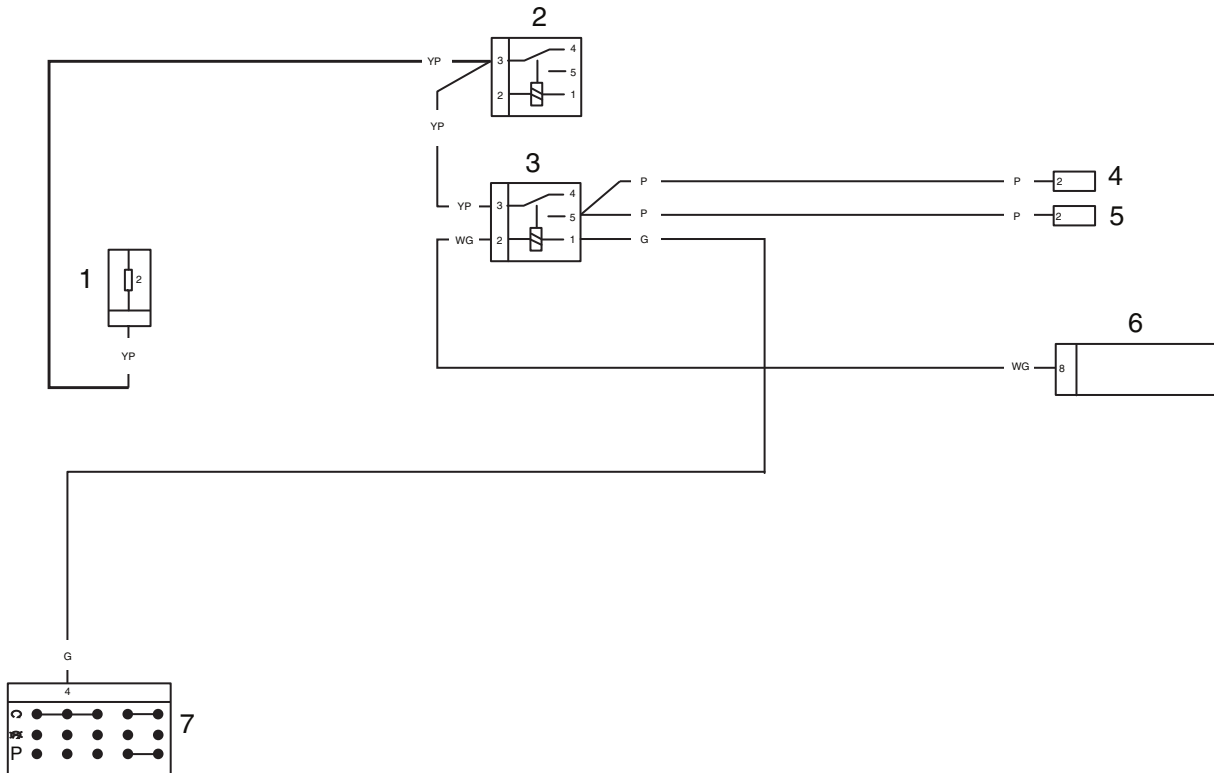

1. Fuse box
2. Horn relay
3. Fog light relay
4. Fog light (left hand)
5. Fog light (right hand)
6. Instruments
7. Ignition switch

Please mark your copy of the Service Manual with this information. For electronic service manuals, store this information in a readily accessible place and refer to it often. This information will be included in the next service manual update.

Item: 188.3

Description: TFT Instruments - Calibration Update

Model Affected: Street Triple R, Street Triple R - LRH, Street Triple RS

New TFT instrument calibrations have been released for the above models. The new calibrations improve heated grip functionality (if fitted) to allow three levels of heat to be selected.

Dealers are requested to update the TFT instrument calibrations on the above models at the next service/visit to dealership.

Heated Grip Operation (if fitted)

The heated grips will only heat when the engine is running.

When the heated grips are switched on, the heated grips symbol will appear in the display and the selected heat level will be shown.

There are three levels of heat: low, medium and high. This is indicated by the different colours of the symbols shown in the display.

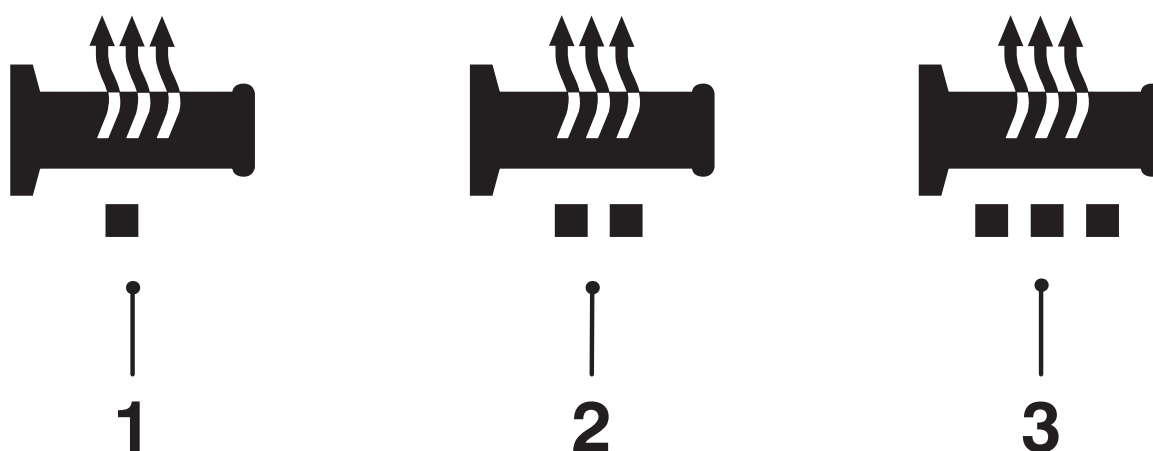

1. Low heat symbol (yellow)
2. Medium heat symbol (orange)
3. High heat symbol (red)

For maximum benefit in cold conditions, from the OFF position press the switch once for the high heat setting initially and then reduce the heat level by pressing the switch again for a low heat setting when the grips have warmed up.

To turn off the heated grips, press and release the switch until the heated grips symbol is no longer shown in the display.

Low Power Voltage Cut Off

If a low voltage is detected, the heated grips switch will power off. The heated grips will not function again until the voltage rises to a safe level.

The switch will not power back on automatically even if the voltage rises to the safe level. The user must manually press the switch again to activate the heated grips.

Item: 188.4

Description: Exhaust Header Nuts Tightening Sequence

Model Affected: Bonneville T100, Bonneville T100 Black, Street Scrambler, Street Cup, Street Twin, Bonneville T120, Bonneville T120 Black, Bonneville Bobber, Bonneville Bobber Black, Bonneville Speedmaster, Thruxton, Thruxton R

The exhaust header tightening sequence and torque figures have been updated for the above models. When refitting an exhaust header pipe to the above models, follow the new exhaust header tightening sequence as described in the procedure below:

Stage 1:

Tighten the exhaust header pipe to cylinder head nuts in the sequence shown below:

Right Hand Side

- Tighten the exhaust header pipe lower nut (1) to **10 Nm**
- Tighten the exhaust header pipe upper nut (2) to **10 Nm**
- Re-tighten the exhaust header pipe lower nut (1) to **10 Nm**

Left Hand Side

- Tighten the exhaust header pipe lower nut (3) to **10 Nm**
- Tighten the exhaust header pipe upper nut (4) to **10 Nm**
- Re-tighten the exhaust header pipe lower nut (3) to **10 Nm**.

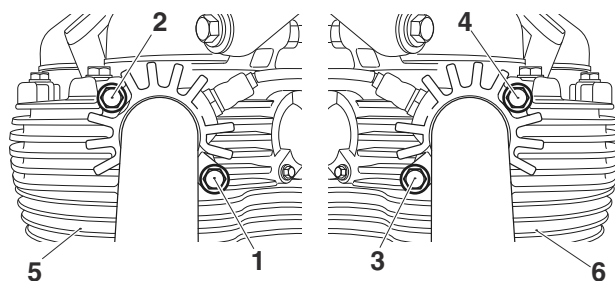

1. Right hand header pipe lower nut (1)
2. Right hand header pipe upper nut (2)
3. Left hand header pipe lower nut (3)
4. Left hand header pipe upper nut (4)
5. Cylinder head (right hand side) (5)
6. Cylinder head (left hand side) (6)

Stage 2:

Tighten the exhaust header pipe to cylinder head nuts in the sequence shown below:

Right Hand Side

- Tighten the exhaust header pipe lower nut (1) to **19 Nm**
- Tighten the exhaust header pipe upper nut (2) to **19 Nm**
- Re-tighten the exhaust header pipe lower nut (1) to **19 Nm**

Left Hand Side

- Tighten the exhaust header pipe lower nut (3) to **19 Nm**
- Tighten the exhaust header pipe upper nut (4) to **19 Nm**
- Re-tighten the exhaust header pipe lower nut (3) to **19 Nm**.

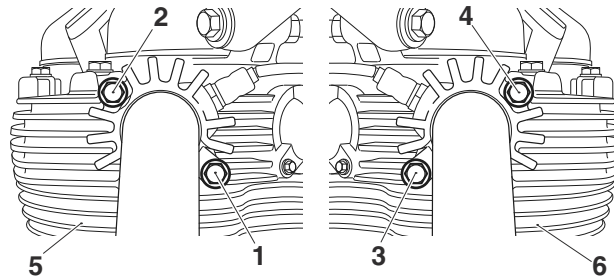

1. Right hand header pipe lower nut (1)
2. Right hand header pipe upper nut (2)
3. Left hand header pipe lower nut (3)
4. Left hand header pipe upper nut (4)
5. Cylinder head (right hand side) (5)
6. Cylinder head (left hand side) (6)

Item: 188.5
Description: Hugger Fixing
Model Affected: Tiger Sport

A M5 x 10 mm encapsulated fixing has replaced the original M5 x 14 mm fixing, therefore if loosened or removed for any reason the original fixing must be replaced and torqued to **4 Nm**.

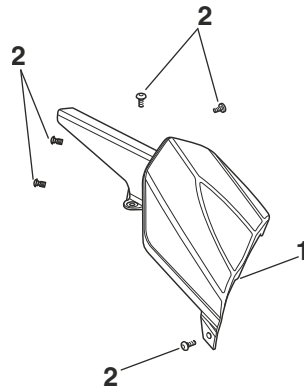

1. Hugger
2. Fixing

When ordering replacement parts, refer to the EPC.

Please mark your copy of the Service Manual with this information. For electronic service manuals, store this information in a readily accessible place and refer to it often. This information will be included in the next service manual update.

Item: 188.6
Description: Pinpoint Test - Brake Switches
Model Affected: Street Triple S, Street Triple S - LRH and Street Triple S 600cc A2 Restricted Licence Version

The pinpoint test for Brake Switches (P1567) has changed for the above models Service Manuals. The changes are in the Pinpoint Test - Fuel section within the Fuel System and Engine Management chapter. The revised pinpoint test is as described below.

Fault Code	Possible cause	Action
P0571	Brake 1 switch malfunction	View and note freeze frame data if available. Ensure brake switches connectors are secure.
P1576	Brake 1 switch correlation error with brake switch 2	
P1571	Brake 2 switch malfunction	Ensure battery voltage is greater than 10V. Disconnect engine ECM and proceed to pinpoint test 1:
P1577	Brake 2 switch correlation error with brake switch 1	

Pinpoint Tests

	Test	Result	Action
1	Turn ignition on, operate rear brake switch and check brake light operation.	OK	Proceed to test 2
		Faulty	Rectify fault, proceed to test 6
2	Check cable and terminal integrity: - ECM pin A06 - ECM pin A07 - Ignition switch pin 8	OK	Disconnect front and rear brake switch connectors, proceed to test 3
		Faulty	Rectify fault, proceed to test 6
3	With brakes released, check front and rear brake switch operation: The following should be short circuit: - Front brake switch pin 2 to pin 3 - Rear brake light switch pin 2 to pin 4 - Rear brake light switch pin 1 to pin 3 The following should be open circuit: - Front brake switch pin 1 to pin 3 With the front brake switch pressed the following should be short circuit: - Front brake switch pin 1 to pin 3 The following should be open circuit: - Front brake switch pin 2 to pin 3 With the rear brake switch pressed the following should be open circuit: - Rear brake light switch pin 2 to pin 4 - Rear brake light switch pin 1 to pin 3	OK	Proceed to test 4
		Faulty	Replace relevant brake switch, proceed to test 6

	Test	Result	Action
4	Re-Connect the brake switch connectors. Check cable continuity: - Engine ECM pin A07 to front brake switch pin 1 - Engine ECM pin A06 to rear brake switch pin 2 - Engine ECM pin A07 to brake switch relay pin 4 - Brake switch relay pin 2 to ground - Engine ECM pin A06 to front brake switch pin 2 - Engine ECM pin A06 to ignition switch pin 8	OK	Proceed to test 5
		Open Circuit	Locate and rectify wiring fault, proceed to test 6
5	Re-Connect the brake switch connectors. With the ignition switch on, measure the following Voltages: - Engine ECM pin A06 to ground - Rear brake switch pin 1 to ground - Rear brake switch pin 2 to ground - Rear brake switch pin 3 to ground - Rear brake switch pin 4 to ground - Brake switch relay pin 3 to ground - Brake switch relay pin 1 to ground - Front brake switch pin 3 to ground - Front brake switch pin 2 to ground	greater than 10V	Proceed to test 6
		Less than 10V	Locate and rectify wiring fault, proceed to test 6
6	Reconnect harness, clear fault code and run engine.	OK	Action complete - quit test
		Fault still present	Contact Triumph service

Circuit Diagram

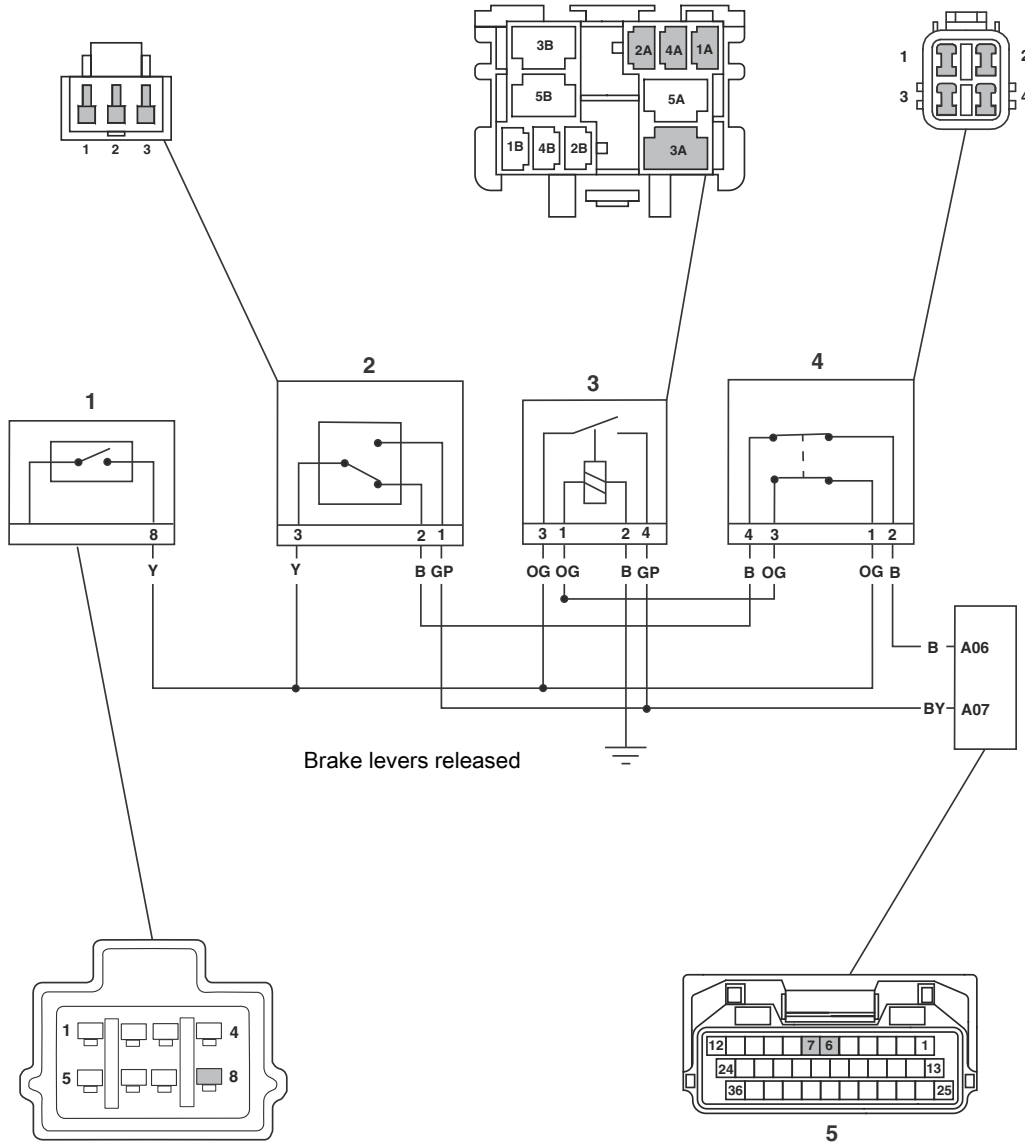

1. Ignition switch
2. Front brake switch
3. Brake switch relay
4. Rear brake switch
5. Engine electronic control module - connector A

Please mark your copy of the Service Manual with this information. For electronic service manuals, store this information in a readily accessible place and refer to it often. This information will be included in the next service manual update.

Item: 188.7

Description: Pinpoint Test - Brake Switches

Model Affected: Street Triple R, Street Triple R - LRH and Street Triple RS

The pinpoint test for Brake Switches (P1567) has changed for the above models Service Manuals. The changes are in the Pinpoint Test - Fuel section within the Fuel System and Engine Management chapter. The revised pinpoint test is as described below.

Fault Code	Possible cause	Action
P0571	Brake 1 switch malfunction	View and note freeze frame data if available. Ensure brake switches connectors are secure.
P1576	Brake 1 switch correlation error with brake switch 2	
P1571	Brake 2 switch malfunction	Ensure battery voltage is greater than 10V. Disconnect engine ECM and proceed to pinpoint test 1:
P1577	Brake 2 switch correlation error with brake switch 1	

Pinpoint Tests

	Test	Result	Action
1	Turn ignition on, operate rear brake switch and check brake light operation.	OK	Proceed to test 2
		Faulty	Rectify fault, proceed to test 6
2	Check cable and terminal integrity: - ECM pin A06 - ECM pin A07 - Ignition switch pin 8	OK	Disconnect front and rear brake switch connectors, proceed to test 3
		Faulty	Rectify fault, proceed to test 6
3	With brakes released, check front and rear brake switch operation: The following should be short circuit: - Front brake switch pin 2 to pin 3 - Rear brake light switch pin 2 to pin 4 - Rear brake light switch pin 1 to pin 3 The following should be open circuit: - Front brake switch pin 1 to pin 3 With the front brake switch pressed the following should be short circuit: - Front brake switch pin 1 to pin 3 The following should be open circuit: - Front brake switch pin 2 to pin 3 With the rear brake switch pressed the following should be open circuit: - Rear brake light switch pin 2 to pin 4 - Rear brake light switch pin 1 to pin 3	OK	Proceed to test 4
		Faulty	Replace relevant brake switch, proceed to test 6

	Test	Result	Action
4	Re-Connect the brake switch connectors. Check cable continuity: - Engine ECM pin A07 to front brake switch pin 1 - Engine ECM pin A06 to rear brake switch pin 2 - Engine ECM pin A07 to brake switch relay pin 4 - Brake switch relay pin 2 to ground - Engine ECM pin A06 to front brake switch pin 2 - Engine ECM pin A06 to ignition switch pin 8	OK	Proceed to test 5
		Open Circuit	Locate and rectify wiring fault, proceed to test 6
5	Re-Connect the brake switch connectors. With the ignition switch on, measure the following Voltages: - Engine ECM pin A06 to ground - Rear brake switch pin 1 to ground - Rear brake switch pin 2 to ground - Rear brake switch pin 3 to ground - Rear brake switch pin 4 to ground - Brake switch relay pin 3 to ground - Brake switch relay pin 1 to ground - Front brake switch pin 3 to ground - Front brake switch pin 2 to ground	greater than 10V	Proceed to test 6
		Less than 10V	Locate and rectify wiring fault, proceed to test 6
6	Reconnect harness, clear fault code and run engine.	OK	Action complete - quit test
		Fault still present	Contact Triumph service

Circuit Diagram

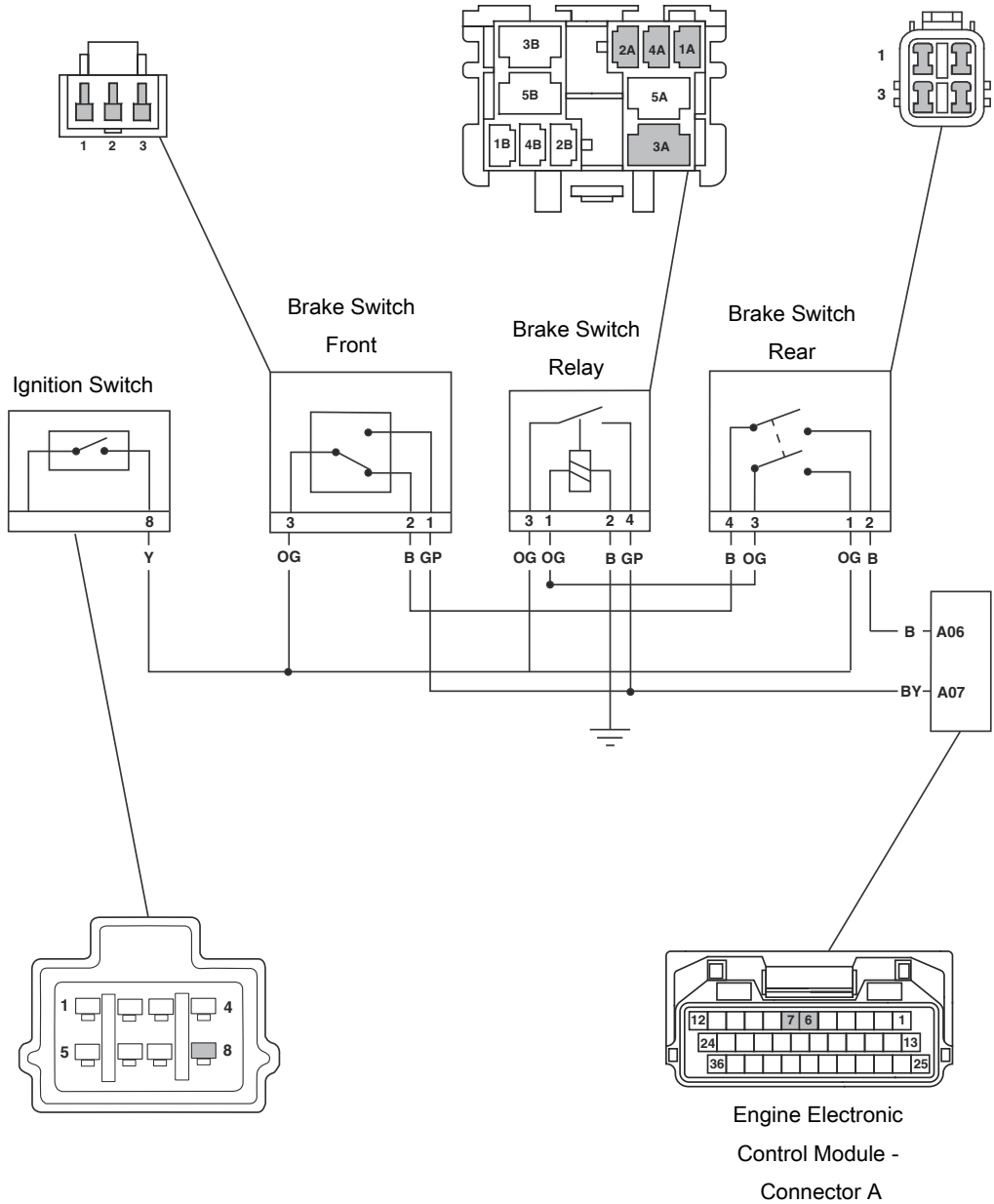

1. Ignition switch
2. Front brake switch
3. Brake switch relay
4. Rear brake switch
5. Engine electronic control module - connector A

Please mark your copy of the Service Manual with this information. For electronic service manuals, store this information in a readily accessible place and refer to it often. This information will be included in the next service manual update.

Item: 188.8
Description: Alternator Cover Parts Kit
Model Affected: Tiger 800, Tiger 800 ABS, Tiger 800 XC, Tiger 800 XC ABS - from engine number 612714, except engine number 613308 to 613370

A retrofittable alternator cover parts kit has been introduced on the above model. Parts will no longer support the old condition item and any replacement will be the new condition. Parts kit T1262277 has been released for use when starter motor part number T131333 has been installed:

Parts Kit T1262277 - Alternator Cover

Kit Contents	Quantity
T1260558 - Bracket, Alternator Cable Guide	1
T1261177 - Cover, Alternator	1
T3051055 - Screw, Cap/HD, M5 x 0.8 x 10, SLV, ENC	2
T3205082 - Bolt, HHF, M6 x 1.0 x 35, ENC	2
T3951013 - Badge flat type 1	1
T1260289 - Gasket, Alternator Cover	1

When ordering replacement parts, always refer to EPC.

Fitting the Parts Kit

Note:

- For the correct fitment of the new starter motor, all items in the kit must be fitted to the motorcycle.
- Refer to the Service Manual for the removal and installation procedure.

Item: 188.9

Description: Alternator Cover Parts Kit

Model Affected: Tiger 800 XRX, Tiger 800 XRX LRH, Tiger 800 XR, Tiger 800 XCX, Tiger 800 XCX LRH, Tiger 800 XC - up to engine number 768815, all markets except Brazil

A retrofittable alternator cover parts kit has been introduced on the above model.

Parts will no longer support the old condition item and any replacement will be the new condition.

Parts kit T1266677 has been released for use when starter motor part number T131333 has been installed:

Parts Kit T1266677 - Alternator Cover

Kit Contents	Quantity
T1260558 - Bracket, Alternator Cable Guide	1
T1261188 - Cover, Alternator	1
T3051055 - Screw, Cap/HD, M5 x 0.8 x 10, SLV, ENC	2
T3205082 - Bolt, HHF, M6 x 1.0 x 35, ENC	2
T3951013 - Badge flat type 1	1
T1260289 - Gasket, Alternator Cover	1

When ordering replacement parts, always refer to EPC.

Fitting the Parts Kit

Note:

- For the correct fitment of the new starter motor, all items in the kit must be fitted to the motorcycle.
- Refer to the Service Manual for the removal and installation procedure.

Item: 188.10

Description: Alternator Cover Parts Kit

Model Affected: Tiger 800 XRX, Tiger 800 XRX LRH, Tiger 800 XR, Tiger 800 XCX, Tiger 800 XCX LRH, Tiger 800 XC - up to engine number 763462, Brazilian market only

A retrofittable alternator cover parts kit has been introduced on the above model.

Parts will no longer support the old condition item and any replacement will be the new condition.

Parts kit T1266677 has been released for use when starter motor part number T131333 has been installed:

Parts Kit T1266677 - Alternator Cover

Kit Contents	Quantity
T1260558 - Bracket, Alternator Cable Guide	1
T1261188 - Cover, Alternator	1
T3051055 - Screw, Cap/HD, M5 x 0.8 x 10, SLV, ENC	2
T3205082 - Bolt, HHF, M6 x 1.0 x 35, ENC	2
T3951013 - Badge flat type 1	1
T1260289 - Gasket, Alternator Cover	1

When ordering replacement parts, always refer to EPC.

Fitting the Parts Kit

Note:

- For the correct fitment of the new starter motor, all items in the kit must be fitted to the motorcycle.
- Refer to the Service Manual for the removal and installation procedure.

Item: 188.11

Description: Starter Motor Parts Kit

Model Affected: Tiger 800 - up to engine number 612713 and engine number 613308 to 613370

A retrofittable Starter Drive parts kit has been introduced on the above model.

Parts will no longer support the old condition item and any replacement will be the new condition.

Parts kit T1316677 has been released for use when replacing the starter motor as follows:

Parts Kit T1316677 - Starter Motor

Kit Contents	Quantity
T1313333 - Starter Motor	1
T1226666 - Gear, Starter Idler	1
T1262222 - Bracket, Alternator cable guide	1
T3051055 - Screw, Cap/HD, M5 x 0.8 x 10, SLV, ENC	2
T3205082 - Bolt, HHF, M6 x 1.0 x 35, ENC	2
T1260289 - Gasket, Alternator Cover	1

When ordering replacement parts, always refer to EPC.

Fitting the Parts Kit

Note:

- For the correct fitment of the new starter motor, all items in the kit must be fitted to the motorcycle.
- Refer to the Service Manual for the removal and installation procedure.

Item: 188.12
Description: Starter Motor Parts Kit
Model Affected: Tiger 800 XRT - up to engine number 818365, all markets except Brazil and India

A retrofittable Starter Drive parts kit has been introduced on the above model.
Parts will no longer support the old condition item and any replacement will be the new condition.
Parts kit T1316677 has been released for use when replacing the starter motor as follows:

Parts Kit T1316677 - Starter Motor

Kit Contents	Quantity
T1313333 - Starter Motor	1
T1226666 - Gear, Starter Idler	1
T1262222 - Bracket, Alternator cable guide	1
T3051055 - Screw, Cap/HD, M5 x 0.8 x 10, SLV, ENC	2
T3205082 - Bolt, HHF, M6 x 1.0 x 35, ENC	2
T1260289 - Gasket, Alternator Cover	1

When ordering replacement parts, always refer to EPC.

Fitting the Parts Kit

Note:

- For the correct fitment of the new starter motor, all items in the kit must be fitted to the motorcycle.
- Refer to the Service Manual for the removal and installation procedure.

Item: 188.13

Description: Starter Motor Parts Kit

Model Affected: Tiger 800 XCA - up to engine number 808365, all markets except Brazil and India

A retrofittable Starter Drive parts kit has been introduced on the above model.

Parts will no longer support the old condition item and any replacement will be the new condition.

Parts kit T1316677 has been released for use when replacing the starter motor as follows:

Parts Kit T1316677 - Starter Motor

Kit Contents	Quantity
T1313333 - Starter Motor	1
T1226666 - Gear, Starter Idler	1
T1262222 - Bracket, Alternator cable guide	1
T3051055 - Screw, Cap/HD, M5 x 0.8 x 10, SLV, ENC	2
T3205082 - Bolt, HHF, M6 x 1.0 x 35, ENC	2
T1260289 - Gasket, Alternator Cover	1

When ordering replacement parts, always refer to EPC.

Fitting the Parts Kit

Note:

- For the correct fitment of the new starter motor, all items in the kit must be fitted to the motorcycle.
- Refer to the Service Manual for the removal and installation procedure.

Item: 188.14
Description: Starter Motor Parts Kit
Model Affected: Tiger 800 XRT and Tiger 800 XCA - up to engine number 817335, Brazilian market only

A retrofittable Starter Drive parts kit has been introduced on the above model. Parts will no longer support the old condition item and any replacement will be the new condition. Parts kit T1316677 has been released for use when replacing the starter motor as follows:

Parts Kit T1316677 - Starter Motor

Kit Contents	Quantity
T1313333 - Starter Motor	1
T1226666 - Gear, Starter Idler	1
T1262222 - Bracket, Alternator cable guide	1
T3051055 - Screw, Cap/HD, M5 x 0.8 x 10, SLV, ENC	2
T3205082 - Bolt, HHF, M6 x 1.0 x 35, ENC	2
T1260289 - Gasket, Alternator Cover	1

When ordering replacement parts, always refer to EPC.

Fitting the Parts Kit

Note:

- For the correct fitment of the new starter motor, all items in the kit must be fitted to the motorcycle.
- Refer to the Service Manual for the removal and installation procedure.

Item: 188.15
Description: Starter Motor Parts Kit
Model Affected: Tiger 800 XRX, Tiger 800 XRX LRH, Tiger 800 XR, Tiger 800 XCX, Tiger 800 XCX LRH, Tiger 800 XC - up to engine number 818365, all markets except Brazil and India

A retrofittable starter motor parts kit has been introduced on the above model. Parts will no longer support the old condition item and any replacement will be the new condition. Parts kit T1315566 has been released for use when replacing the starter motor as follows:

Parts Kit T1315566 - Starter Motor

Kit Contents	Quantity
T1313333 - Starter Motor	1
T1226666 - Gear, Starter Idler	1
T1261188 - Cover - Alternator	1
T3051055 - Screw, Cap/HD, M5 x 0.8 x 10, SLV, ENC	2
T3205082 - Bolt, HHF, M6 x 1.0 x 35, ENC	2
T3951013 - Badge flat type 1	1
T1260289 - Gasket, Alternator Cover	1

When ordering replacement parts, always refer to EPC.

Fitting the Parts Kit

Note:

- For the correct fitment of the new starter motor, all items in the kit must be fitted to the motorcycle.
- Refer to the Service Manual for the removal and installation procedure.

Item: 188.16

Description: Starter Motor Parts Kit

Model Affected: Tiger 800 XRX, Tiger 800 XRX LRH, Tiger 800 XR, Tiger 800 XCX, Tiger 800 XCX LRH, Tiger 800 XC - up to engine number 818252, Brazil and Indian markets only

A retrofittable starter motor parts kit has been introduced on the above model.

Parts will no longer support the old condition item and any replacement will be the new condition.

Parts kit T1315566 has been released for use when replacing the starter motor as follows:

Parts Kit T1315566 - Starter Motor

Kit Contents	Quantity
T1313333 - Starter Motor	1
T1226666 - Gear, Starter Idler	1
T1261188 - Cover - Alternator	1
T3051055 - Screw, Cap/HD, M5 x 0.8 x 10, SLV, ENC	2
T3205082 - Bolt, HHF, M6 x 1.0 x 35, ENC	2
T3951013 - Badge flat type 1	1
T1260289 - Gasket, Alternator Cover	1

When ordering replacement parts, always refer to EPC.

Fitting the Parts Kit

Note:

- For the correct fitment of the new starter motor, all items in the kit must be fitted to the motorcycle.
- Refer to the Service Manual for the removal and installation procedure.

Item: 188.17
Description: Starter Motor Parts Kit
Model Affected: Tiger 800, Tiger 800 ABS, Tiger 800 XC, Tiger 800 XC ABS, Tiger 800 XC ABS Special Edition - from engine number 612714, except engine numbers 613308 to 613370

A retrofittable starter motor parts kit has been introduced on the above model. Parts will no longer support the old condition item and any replacement will be the new condition. Parts kit T1314455 has been released for use when replacing the starter motor as follows:

Parts Kit T1314455 - Starter Motor

Kit Contents	Quantity
T1313333 - Starter Motor	1
T1226666 - Gear, Starter Idler	1
T1261177 - Cover - Alternator	1
T3051055 - Screw, Cap/HD, M5 x 0.8 x 10, SLV, ENC	2
T3205082 - Bolt, HHF, M6 x 1.0 x 35, ENC	2
T3951013 - Badge flat type 1	1
T1260289 - Gasket, Alternator Cover	1

When ordering replacement parts, always refer to EPC.

Fitting the Parts Kit

Note:

- For the correct fitment of the new starter motor, all items in the kit must be fitted to the motorcycle.
- Refer to the Service Manual for the removal and installation procedure.

Circulation

Initial and date when read and return to central file holder

Service Manager	Parts Manager	Sales Manager	Workshop Supervisor	Technician 1	Technician 2