

JTB00613NAS2

TECHNICAL BULLETIN

13 MAR 2018



© Jaguar Land Rover North America, LLC

NOTE: The information in Technical Bulletins is intended for use by trained, professional Technicians with the knowledge, tools, and equipment required to do the job properly and safely. It informs these Technicians of conditions that may occur on some vehicles, or provides information that could assist in proper vehicle service. The procedures should not be performed by 'do-it-yourselfers'. If you are not a Retailer, do not assume that a condition described affects your vehicle. Contact an authorized Jaguar service facility to determine whether this bulletin applies to a specific vehicle.

INFORMATION

This reissue replaces all previous versions. Please destroy all previous versions.

Changes are highlighted in blue

SECTION:

501-08: Exterior Trim and Ornamentation

SUBJECT/CONCERN:

Rocker Panel Moulding/Rear Fender Paint Delamination

AFFECTED VEHICLE RANGE:

MODEL:	MODEL YEAR:	VIN:	ASSEMBLY PLANT:
F-TYPE (X152)	2014 Onwards	K00001 Onwards	Castle Bromwich

MARKETS:

NORTH AMERICA

CONDITION SUMMARY:**SITUATION:**

Paint delamination may be evident between the rocker moulding panel and the rear fender.

CAUSE:

This may be caused by insufficient clearance between the rocker moulding panel and the rear fender.

ACTION:

Should a customer express this concern, follow the Workshop Procedure below.

PARTS: **NOTE:**

* - an allowance (\$3.75 USD or local equivalent) has been provided to cover the cost of the adhesive tape (3M™ Acrylic Plus Tape PT1100 [8mm width or similar]) and cable tie. Claim using Sundry Code 'ZZZ001'.

PART NUMBER	DESCRIPTION	QUANTITY
ZZZ001	Adhesive tape [8mm width]; cable tie	\$3.75

TOOLS:

Refer to Workshop Manual for any required special tools.

WARRANTY:

NOTE:

* - an allowance (\$3.75 USD or local equivalent) has been provided to cover the cost of the adhesive tape (3M™ Acrylic Plus Tape PT1100 [8mm width or similar]) and cable tie. Claim using Sundry Code 'ZZZ001'.

NOTES:

- Repair procedures are under constant review, and therefore times are subject to change; those quoted here must be taken as guidance only. Always refer to JLR claims submission system to obtain the latest repair time.
- The JLR Claims Submission System requires the use of causal part numbers. Labor only claims must show the causal part number with a quantity of zero.

DESCRIPTION	SRO	TIME (HOURS)	CONDITION CODE	CAUSAL PART
Rocker panel moulding - Modification - Single	76.96.66	0.3	70	T2R10395
Rocker panel moulding - Modification - Pair	76.96.67	0.6	70	T2R10395

NOTE:

Normal Warranty procedures apply.

WORKSHOP PROCEDURE:**NOTE:**

All illustrations: left-side shown; right-side similar.

- 1 Open the door on the side of the vehicle that has the concern.

2

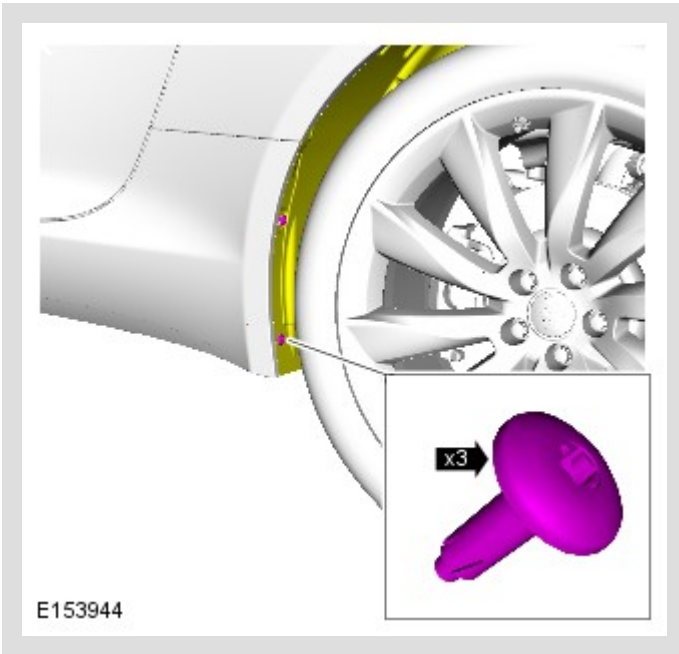

Remove the rear wheel arch liner fasteners.

3

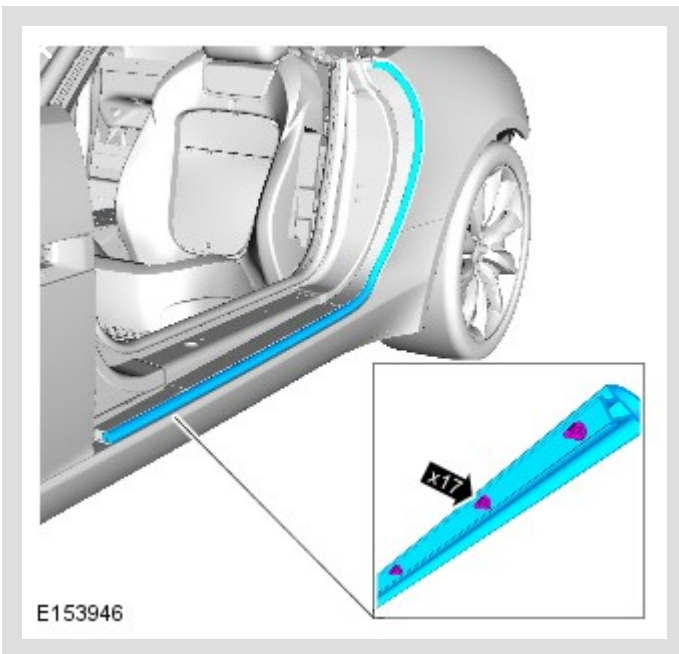

Remove the door seal.

4

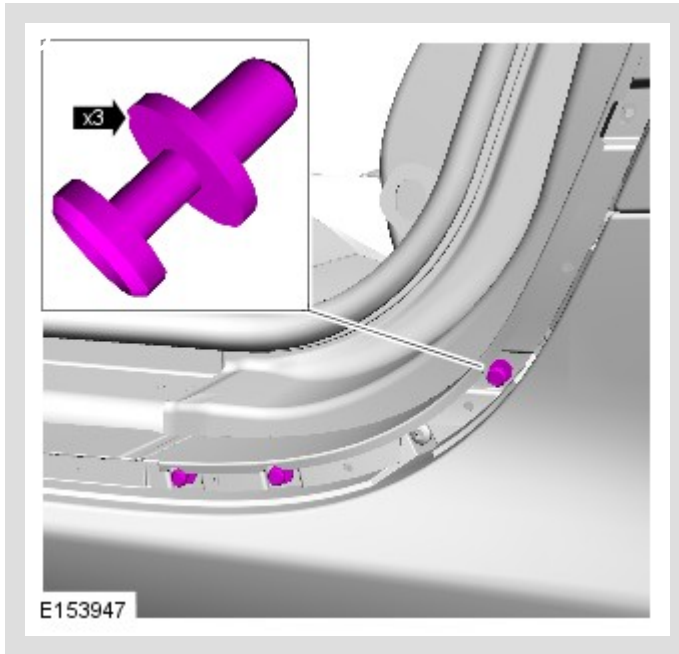

Remove the fasteners.

5

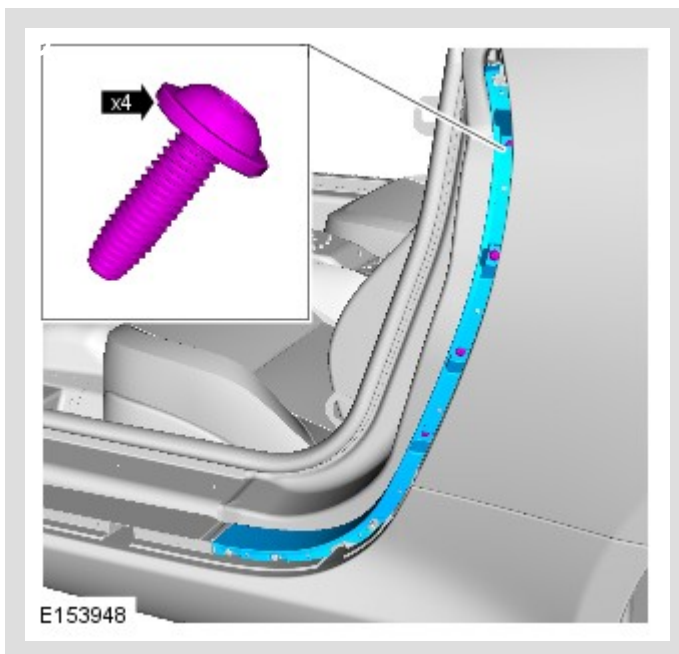

Remove the trim.

- Torque: **4 Nm**

6

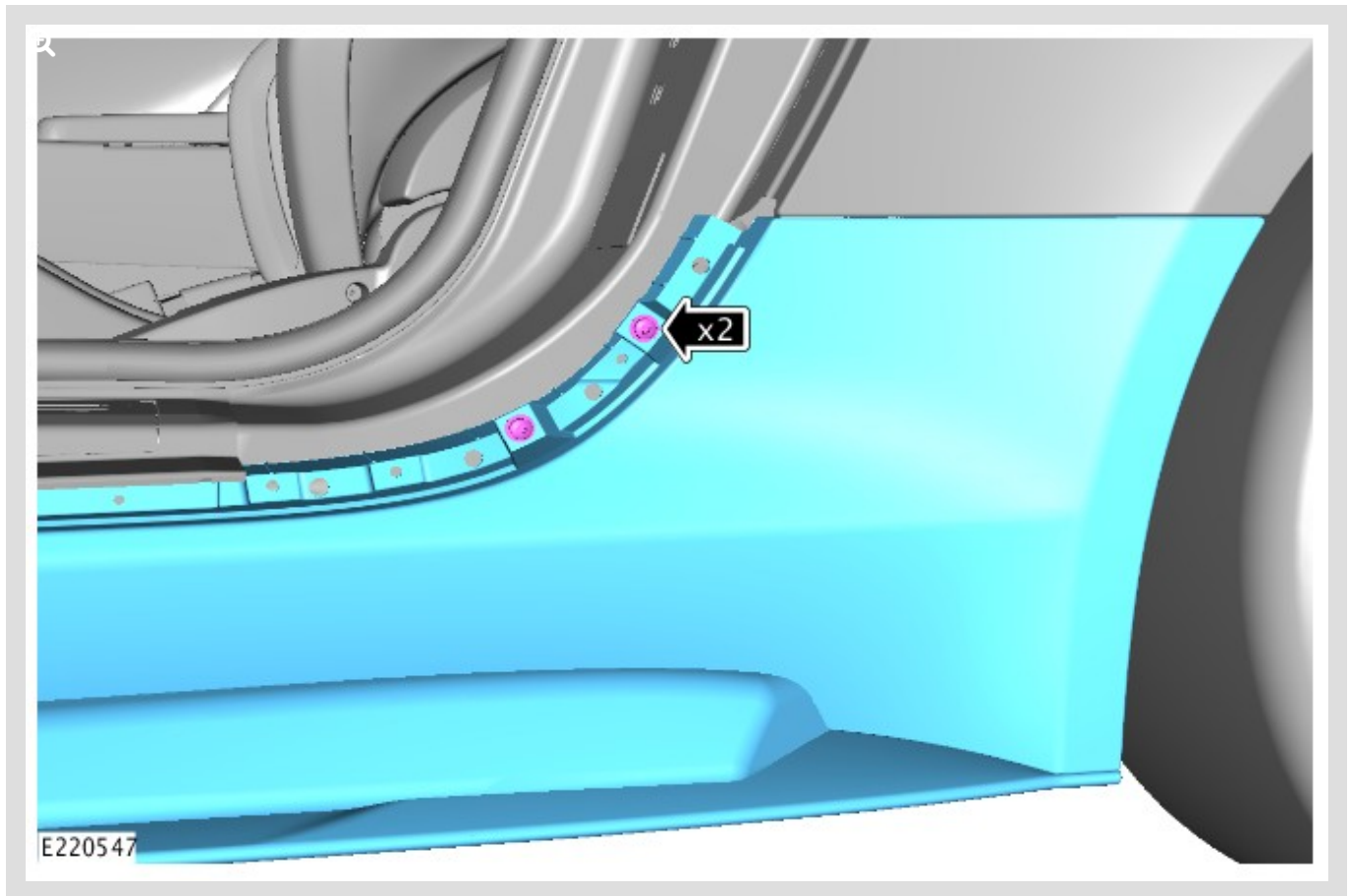

Remove the fasteners.

- Torque: **4 Nm**

7

ⓘ CAUTION:

Do not use excessive force to reposition the rocker panel moulding; the rocker panel moulding is still attached underneath the vehicle.

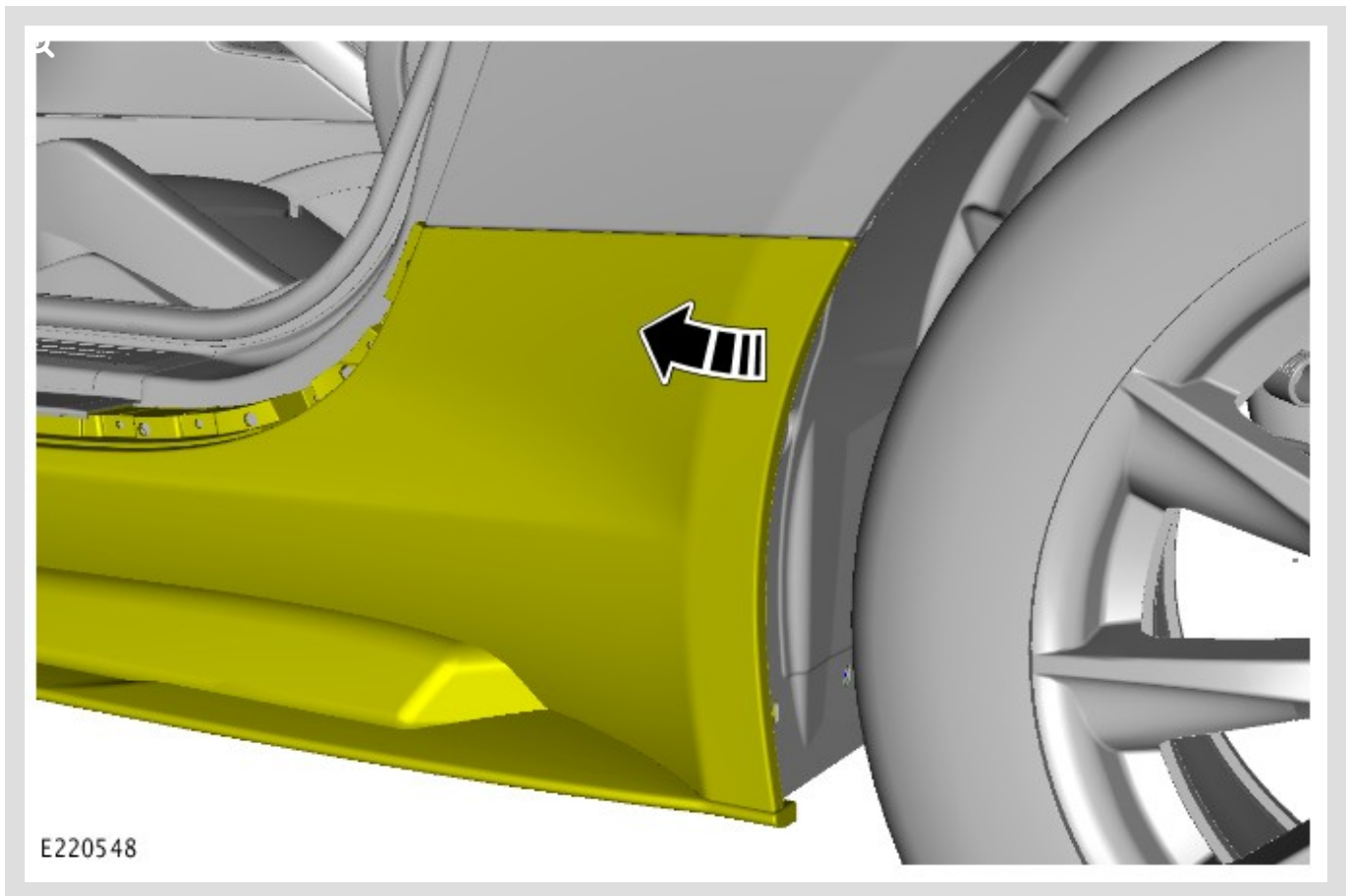

Position the rocker panel moulding to one side.

8

 **NOTE:**

A new cable tie must be used during installation.

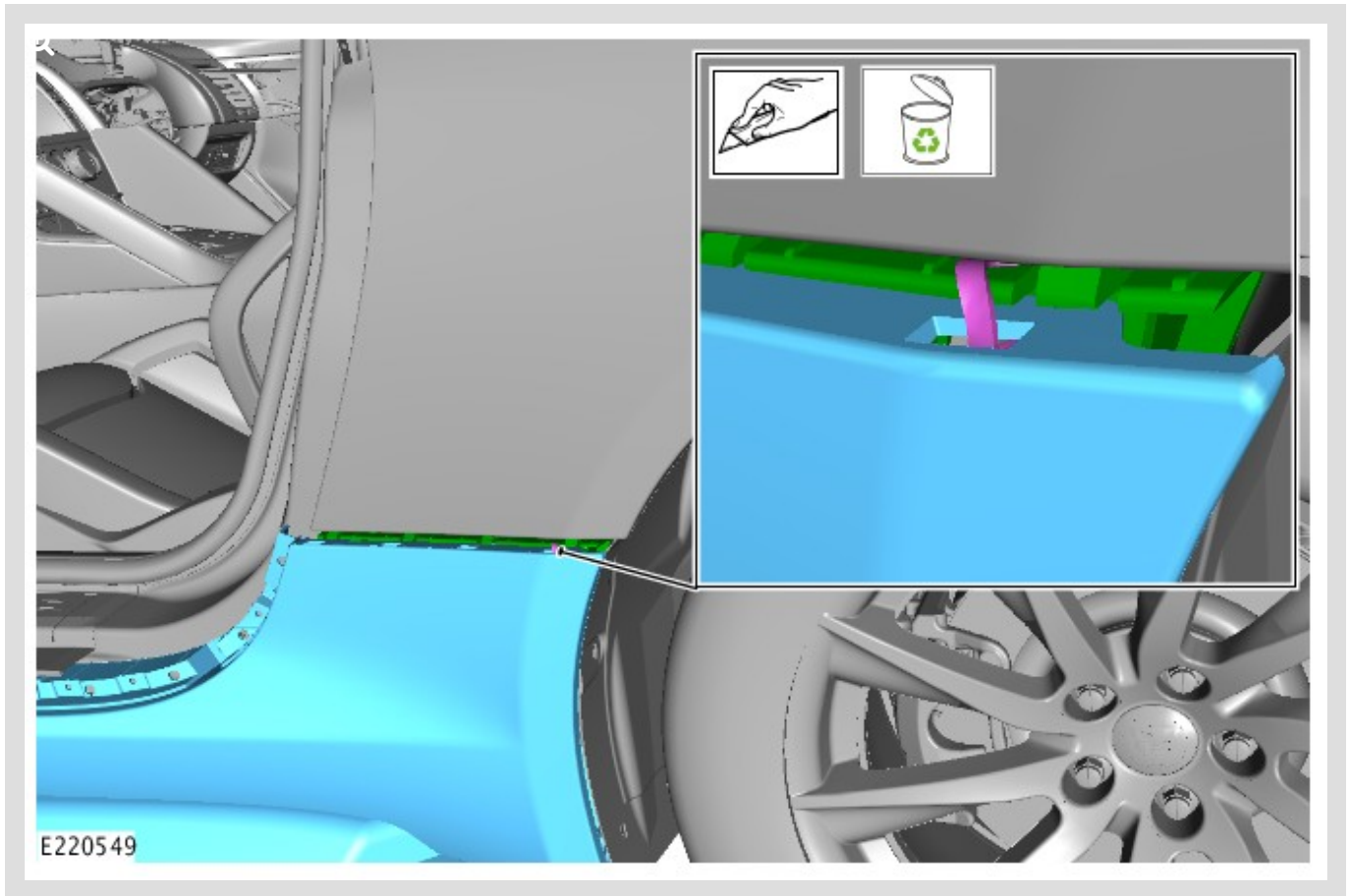

Cut and discard the cable tie.

9

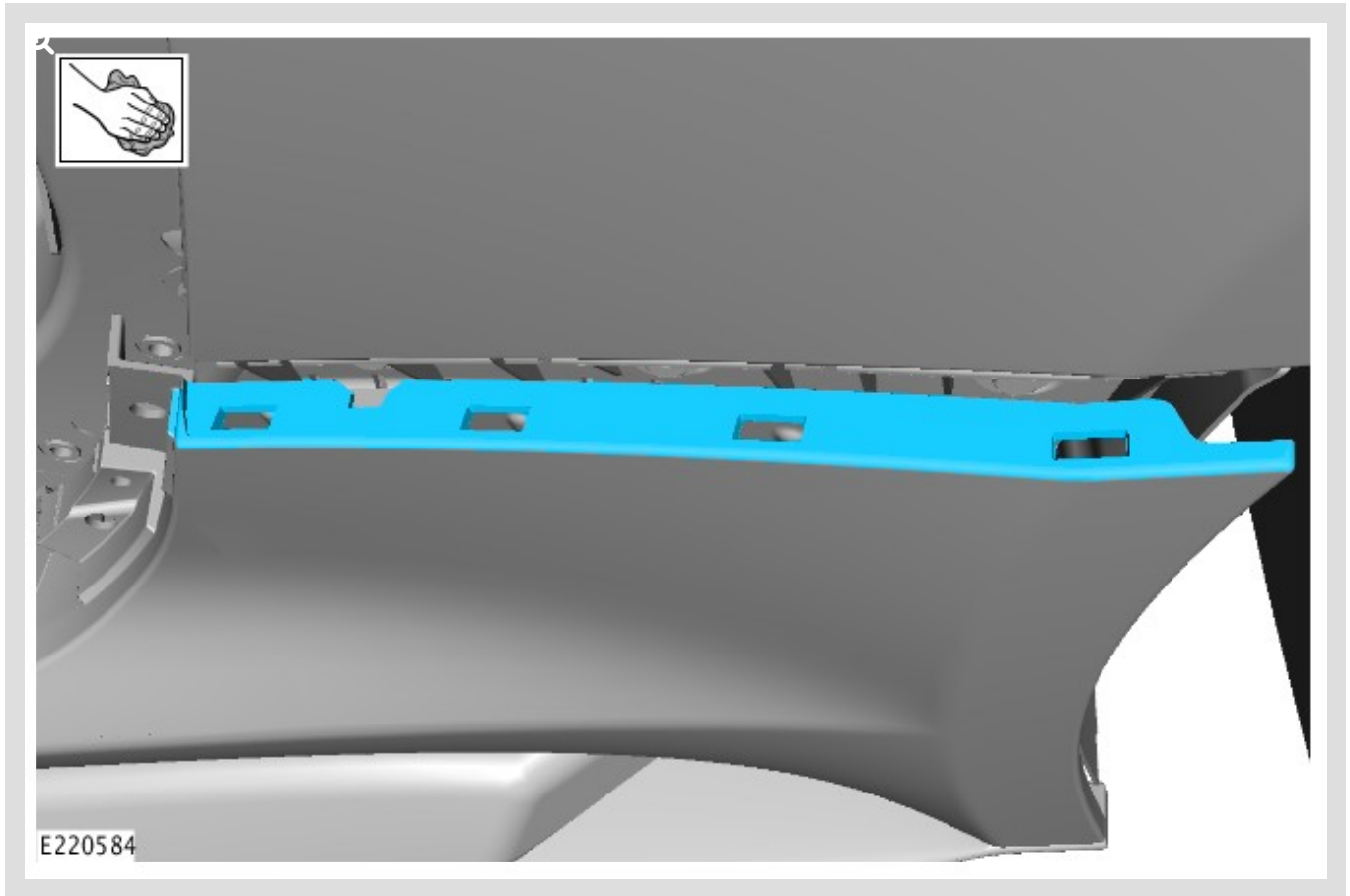

Clean the area shown.

10

 **NOTE:**

The numbers shown correspond to the installation position in Step 11.

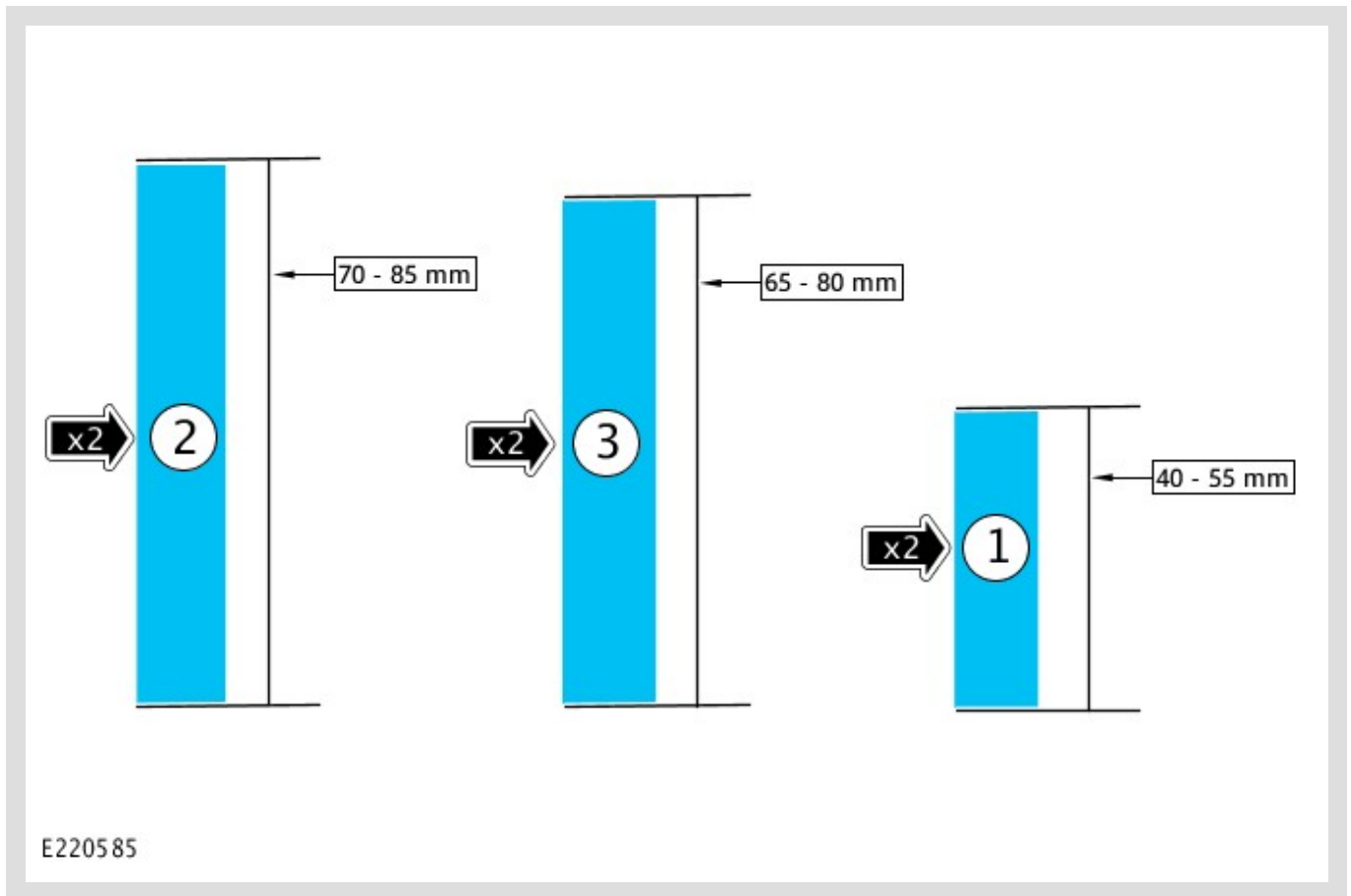

Cut the adhesive tape to the sizes and quantities shown.

11

NOTE:

The position of the adhesive tape will vary depending on the contact point but the measurement shown must always be correct.

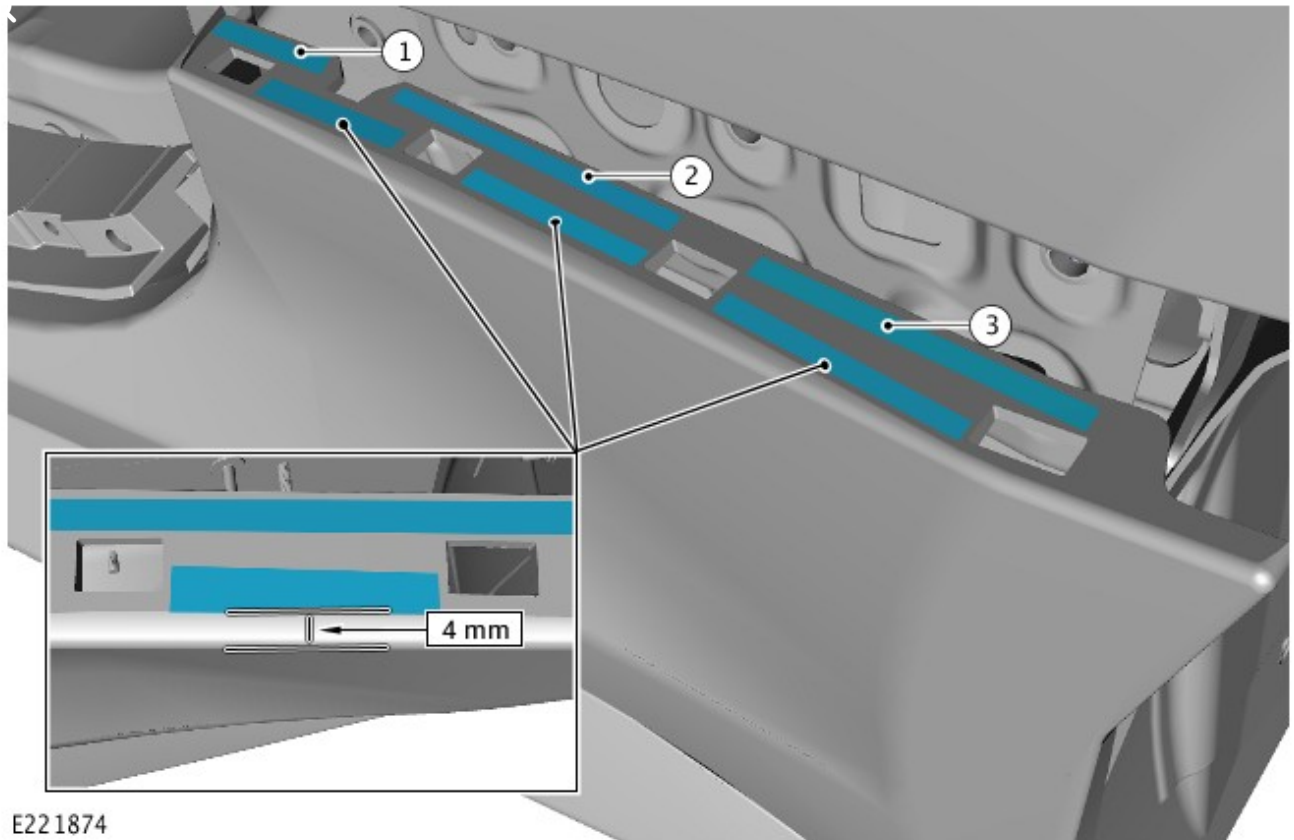

Install the adhesive tape to the areas of contact.

12

NOTES:

- Make sure that no adhesive tape can be seen after installation.
- The gap between the rocker panel moulding and the rear fender will be between 0.8-1.2 mm. This will reduce to 0.5 mm after 48 hours.

Reverse Steps 1-8.

13

NOTE:

Only if required.

Repeat steps 1-12 to the other side of the vehicle.