

Replacing Push-to-Connect Air Line Fittings with Brass Compression Fittings

20-59

FLA COE
FLB COE
> FLD Conventional
Business Class

FLC 112 Conventional
> Century Class Conventional
> Argosy COE
Cargo

> Columbia
> Coronado
> Business Class M2
> Cascadia

Freightliner Service Bulletin

General Information

The standard push-to-connect air line fitting for the engine fan control on some vehicles may develop a leak due to high temperatures and vibration beyond its design limit. If this is the case, replace it with a brass compression fitting on an as-needed basis. See [Fig. 1](#) and [Fig. 2](#).

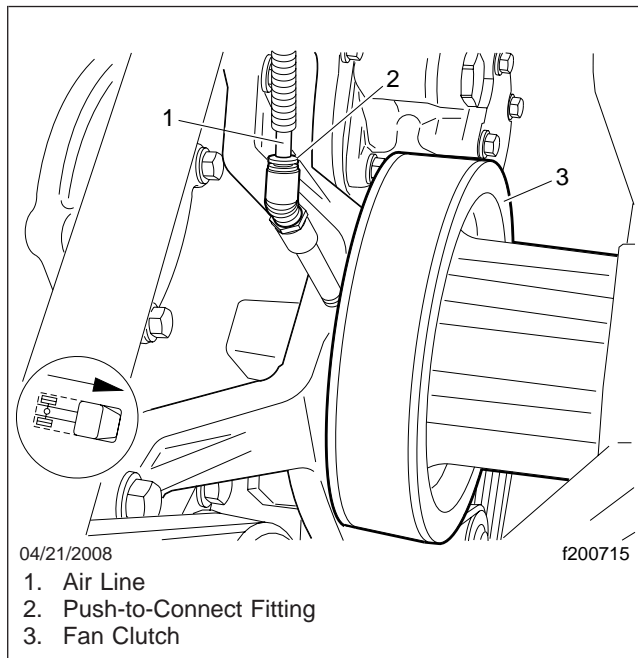

Fig. 1, Existing Fan Clutch Air-Line Fitting

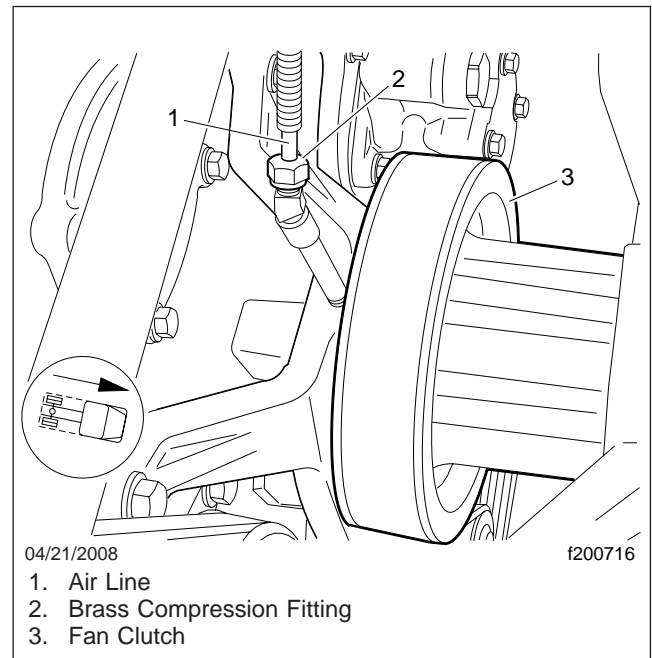

Fig. 2, New Fan Clutch Air-Line Fitting

Use the parts and the procedure in this bulletin.

Parts

Parts are available from the PDCs.

Parts Required		
Part Number	Description	Qty.
210501 000001	Connector, Female, 1/4-Inch	1

Table 1, Parts Required

Procedure

1. Shut down the engine, apply the parking brakes, and chock the tires.
2. Disconnect the batteries at the negative terminals.
3. As applicable, open the hood or tilt the cab. For complete information and warnings on cab tilting, see the *Argosy Driver's Manual*.
4. Drain the air system. The air line cannot be easily removed from the push-to-connect fitting if air pressure is in the system.

Freightliner Service Bulletin

FLA COE
FLB COE
> FLD Conventional
Business Class

FLC 112 Conventional
> Century Class Conventional
> Argosy COE
Cargo

> Columbia
> Coronado
> Business Class M2
> Cascadia

5. To remove the air line, push the air line into the fitting, push the release collar against the fitting body, then pull the air line out of the fitting.
6. Remove the brass fitting from the standpipe on top of the fan clutch.
7. Apply red Loctite®, or equivalent, to the threads of the new fitting, then install it on the standpipe on top of the fan clutch. Tighten the fitting firmly.
8. If needed, cut the end of the nylon tubing smooth and square.
9. Put the hexnut, then the sleeve from the new fitting over the air line.
10. Insert the squared end of the tubing in the new fitting until it bottoms in the body of the fitting.
11. Slide the sleeve down the air line so it is inside the fitting, then tighten the hexnut finger-tight.
12. Using two wrenches to prevent twisting of the air line, tighten the nut a minimum of two turns, or until one thread is showing on the body of the fitting.
13. Connect the batteries.
14. Start the engine, let the pressure build to 110 psi (758 kP), then check for leaks.

NOTE: If equipped with a fan override switch, use it to cycle the fan on to check for leaks; otherwise, let the engine idle until the fan cycles on.

15. Close the hood, or lower the cab, as applicable. For complete information and warnings on cab tilting, see the *Argosy Driver's Manual*.

Warranty

Normal warranty applies. See [Table 2](#) for damage code and labor allowance information, and refer to this bulletin by number in the story of the claim.

Damage Code and Labor Allowance					
VMRS CK18	VMRS CK33	Damage Code	SRT Code	Description	Time: hours
12	042-003-062	273-002902130	27F-5005A	Replace Push-to-Connect Air Line Fitting with Brass Compression Fitting	0.3

Table 2, Damage Code and Labor Allowance