

1 7 07-13



Service Information Bulletin

SUBJECT	DATE
Description and Operation of the HC Doser Fuel Supply Pressure Control Valve – Two-Filter System	July 2013

Additions, Revisions, or Updates

Publication Number / Title	Platform	Section Title	Change
DDC-SVC-MAN-0082	DD Platform	Description and Operation of the HC Doser Fuel Supply Pressure Control Valve – Two-Filter System	Updating pressures.



13400 Outer Drive, West, Detroit, Michigan 48239-4001
 Telephone: 313-592-5000
www.demanddetroit.com

2 Description and Operation of the HC Doser Fuel Supply Pressure Control Valve - Two-Filter System

NOTE: KM59 GEN1 fuel filter module return lines are secured to the module with banjo bolts.

NOTE: KM63 GEN2 fuel filter module return lines are secured to the module with a mounting plate attached to the PLV return line.

NOTE: KM63 GEN2 does not use a Hydrocarbon (HC) doser fuel supply pressure control valve.

The HC doser fuel supply pressure control valve (2) is part of the high pressure fuel flange (1). The HC doser fuel supply valve regulates fuel pressure to the HC doser block. The opening pressure of the HC doser fuel supply pressure control valve is 4.5 bar (65 psi).

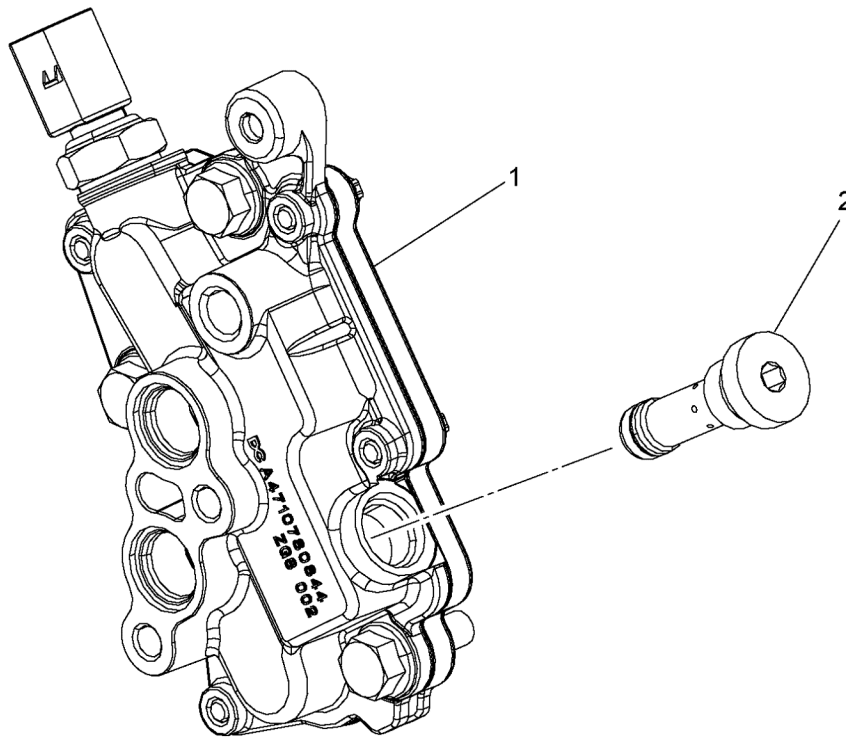

d470115b

1. High Pressure Fuel Flange

2. HC Doser Fuel Supply Pressure Control Valve

Figure 1. KM59 GEN1 HC Doser Fuel Supply Pressure Control Valve