



GROUP ENG	MODEL 2017-2018MY Forte (YDm) 2.0L MPI
NUMBER 170 (Rev 1, 08/08/2018)	DATE June 2017

TECHNICAL SERVICE BULLETIN

SUBJECT: ADAPTIVE VALUES RESET FOR DTC P0016

* NOTICE

This bulletin has been revised to include additional information. New/revised sections of this bulletin are indicated by a black bar in the margin area.

This bulletin provides the procedure to reset adaptive values on some 2017-2018MY Forte (YDm) 2.0L MPI vehicles, produced from May 15, 2016 through June 22, 2018, which may experience a malfunction indicator lamp illumination with DTC P0016 due to a stuck intake CVVT assembly. To correct this concern, reset the adaptive values of the engine ECU using the KDS as described in this bulletin.

DTC P0016: Crankshaft/Camshaft Position Correlation (Bank 1 Sensor A Intake)



Kia Diagnostic System (KDS)

* NOTICE

- A fully charged battery is necessary before this procedure can be performed. It is recommended that the Midtronics GR8-1299 system be used in ECU mode during charging. **DO NOT** connect any other battery charger to the vehicle during procedure.
- This procedure must be done with the ignition key in the 'ON' position.
- Be careful not to disconnect the VCI-II connected to the vehicle during this procedure.
- **DO NOT** start the engine during this procedure.
- **DO NOT** turn the ignition key 'OFF' or interrupt the power supply during this procedure.
- When this procedure is completed, turn the ignition 'OFF' and wait 10 seconds before starting the engine.
- Prior to performing this procedure, be sure to check that the KDS is fully charged.

File Under: <Engine>

Circulate To: General Manager Service Manager Parts Manager
 Service Advisors Technicians Body Shop Manager Fleet Repair

Service Procedure:

1. Connect the VCI-II to the OBD-II connector, located under the driver's side of the instrument panel.



2. With the ignition ON, turn ON the KDS tablet. Select **KDS** from the home screen.



3. Confirm communication with VCI (A) and then configure the vehicle (B) using the **AUTO VIN** (C) feature.

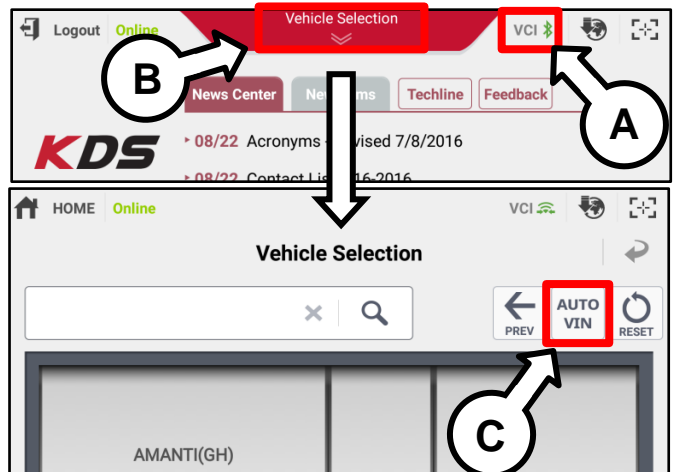

4. From the home page of the KDS app, select "Fault Code Searching".

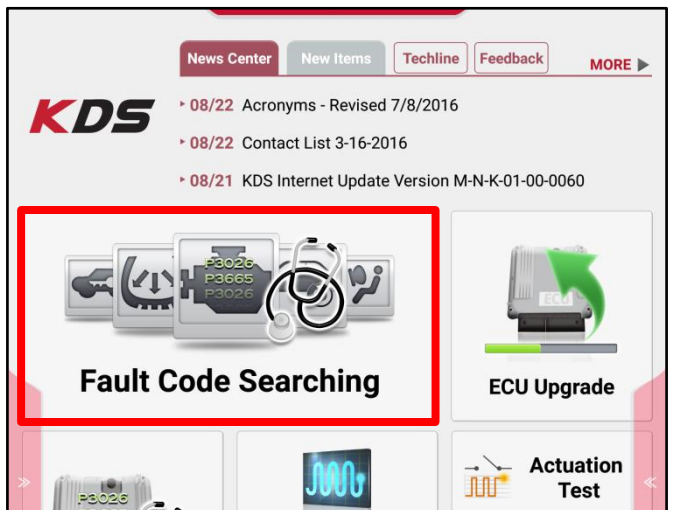

SUBJECT: ADAPTIVE VALUES RESET FOR DTC P0016

- Select “Engine” and select “OK” to perform the fault code search.

Record and then clear any **Engine** related fault codes.

* NOTICE

If there are codes not listed on this TSB (P0016), further diagnosis may be required. Refer to the applicable Shop Manual on KGIS for information regarding the non-listed DTC.

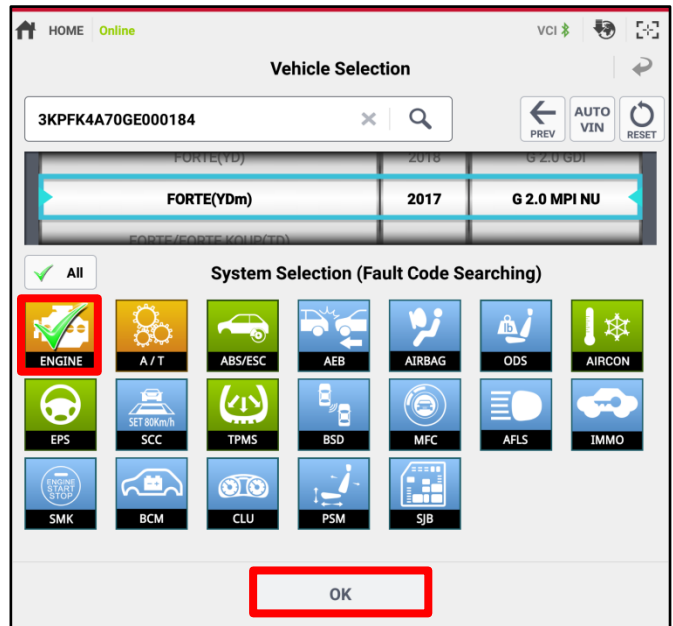

- Return to the KDS app home page and select “S/W Management”.

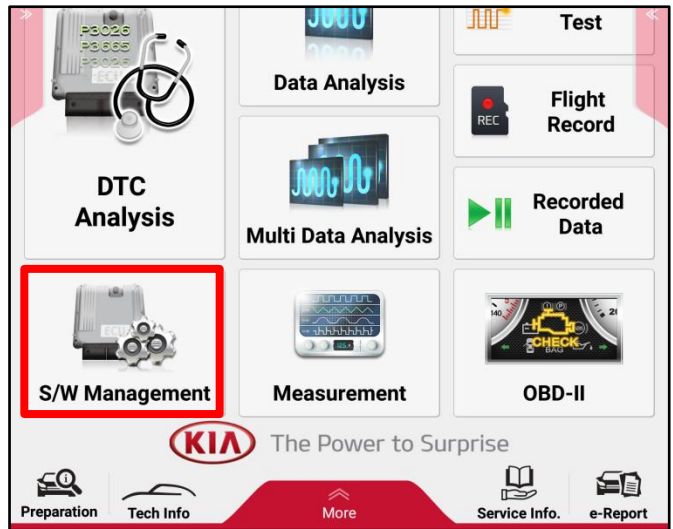

- Select “Engine Control” → “Resetting Adaptive Values” under the “Systems” tab.

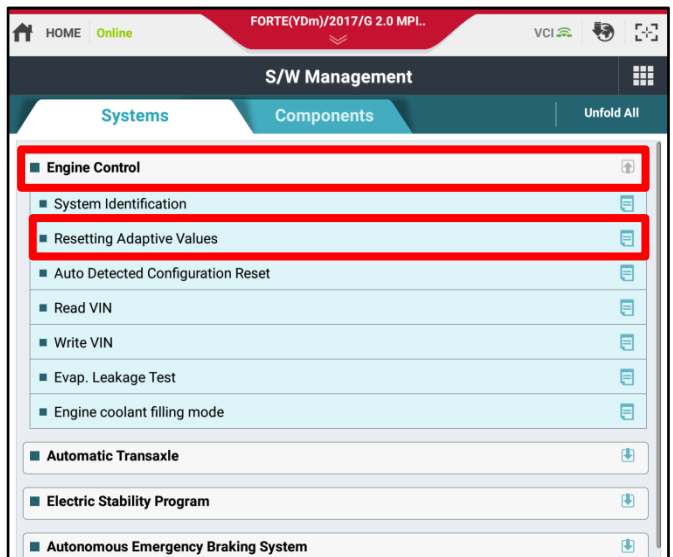

8. Select "OK" to continue.

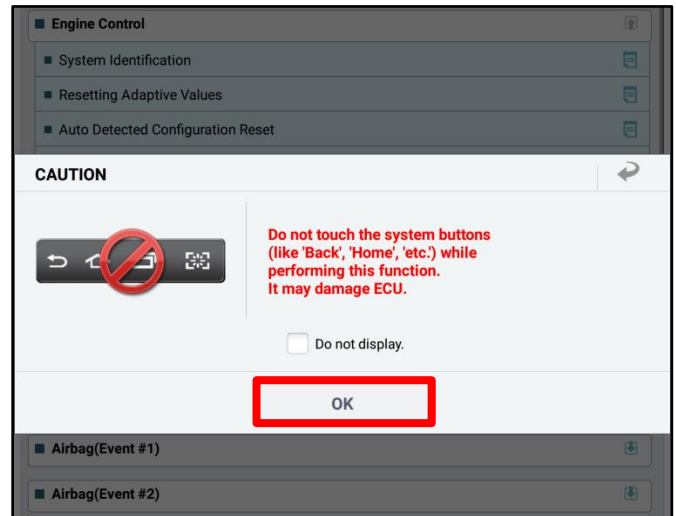

9. Ensure the Enable Conditions are met:

- Ignition ON
- Engine OFF

Select "OK" to continue.

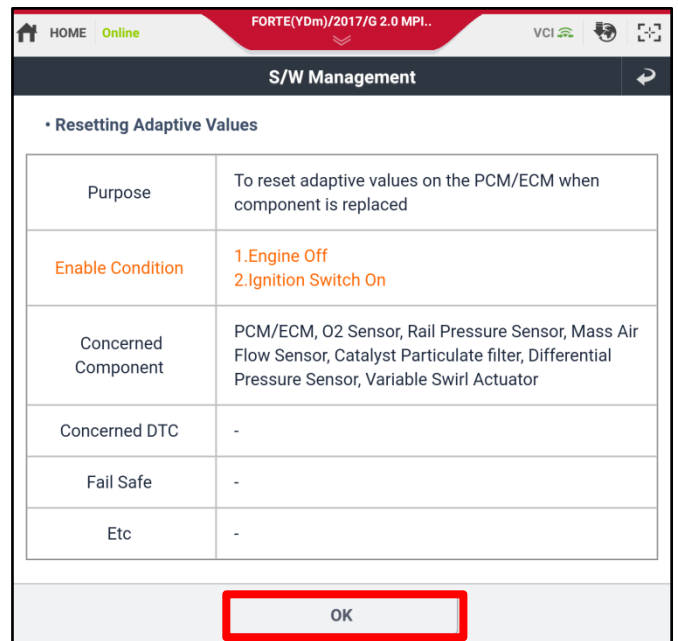

10. Select "Reset" to reset the adaptive values.

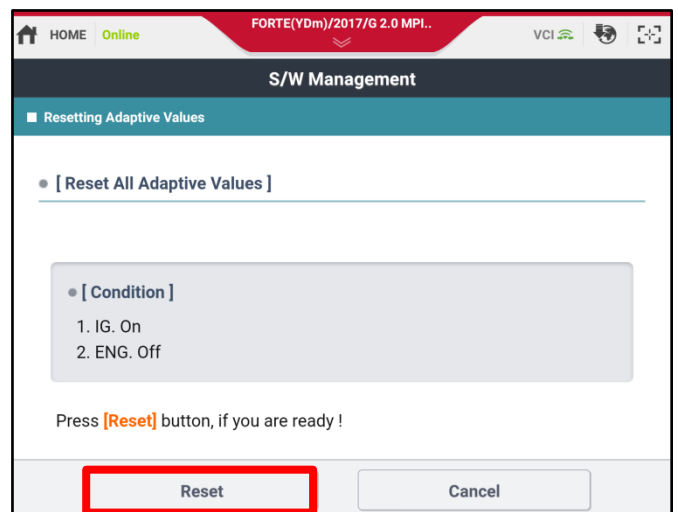

SUBJECT:

ADAPTIVE VALUES RESET FOR DTC P0016

11. Select "OK" when prompted to confirm ("Are you sure?").

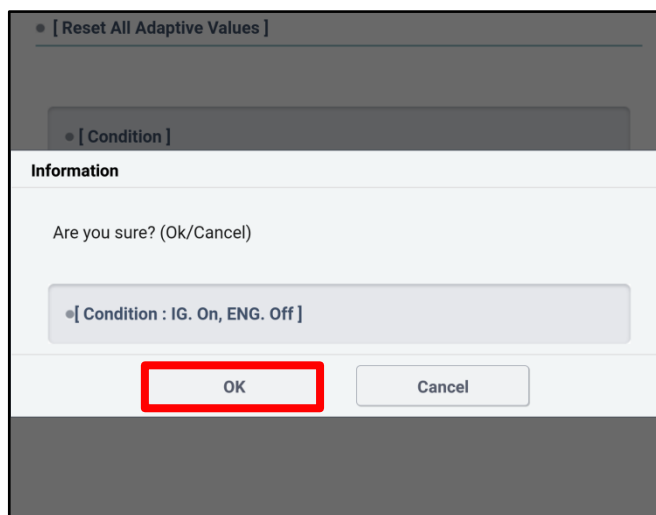

12. Select "OK" to complete the procedure.

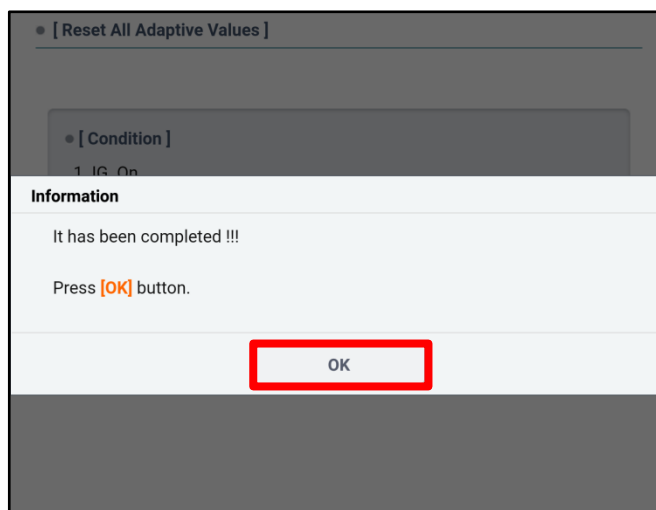

13. Start the engine and perform at least 2 drive cycles to confirm proper operation of the vehicle.

SUBJECT:

ADAPTIVE VALUES RESET FOR DTC P0016

AFFECTED VEHICLE RANGE:

Model	Production Date Range
Forte (YDm) 2.0L MPI	May 15, 2016 through June 22, 2018

WARRANTY INFORMATION:

N Code: I3A C Code: ZZ3

Claim Type	Causal P/N	Qty.	Repair Description	Labor Op Code	Op Time	Replacement P/N	Qty.
W	39131 2EYG0	0	Adaptive Values Reset for DTC P0016	39110RQ0	0.3 M/H	N/A	0