



# Technical Journal

TITLE:

**Gear shift lever inoperable**

<b>REF NO:</b> TJ 32469.2.0	<b>ISSUING DEPARTMENT:</b> Technical Service	<b>CAR MARKET:</b> United States and Canada	
<b>PARTNER:</b> 3 US 7510 Volvo Car USA		<b>ISSUE DATE:</b> 2017-11-17	<b>STATUS DATE:</b> 2017-11-22
<b>FUNC GROUP:</b> 4323	<b>FUNC DESC:</b> Gear lever, complete	Page 1 of 6	

“Right first time in Time”

## Attachment

File Name	File Size
TJI-503582-1_1_0_en-US.pdf	1.4846 MB

## Vehicle Type

Type	Eng	Eng Desc	Sales	Body	Gear	Steer	Model Year	Plant	Chassis range	Struc Week Range
234							2017-2017		-	201617-201709
235							2017-2018		-	201624-201816
236							2016-2018		-	201644-201816
238							2018-2018		-	201710-201816
246							2018-2018		-	201710-201816
256							2016-2018		-	201505-201816

## CSC Customer Symptom Codes

Code	Description
7G	Text window and warning symbol/Yellow symbol and text message
IV	Text window and warning symbol/Text message
MP	Automatic transmission/Possible to change gears, Shift lock does not work

## VST Operation Number

VST Operation Number	Description
98677-2	Inspection Selector Lever Assembly



## DTC Diagnostic Trouble Codes

Control Module	Code	Fault Type
ECM	U010387	Permanent
TCM	P086087	Permanent

Rows beginning with \* are modified

Note! If using a printed copy of this Technical Journal, first check for the latest online version.

### Text

#### DESCRIPTION:

\*Updated with additional variants in vehicle type, description and test under service.

\*If the gear shift lever is inoperable and DTC above are set by its own or in combination, then follow advise under "Service".

#### SERVICE:

\*Disconnect and reconnect the connector at the GSM, according to attached method. Reset the DTC's and test gear shift lever.

#### VEHICLE REPORT:

Yes, please submit a Vehicle Report if the service solution described in this TJ has no effect. Use concern area "Vehicle Report" and sub concern area "Support not needed", use function group 4323.

**To view TJ attachment continue to next page. This TJ has one attachment.**



# Volvo Car Customer Service

TJ Instruction VCC-503582-1

<b>Title</b>	Selector Lever Assembly	<b>Page</b>	1 ( 4 )
<b>Action</b>	Inspection	<b>Operation number:</b>	98677-2

<b>Issue</b>	<b>Date</b>	<b>Reason</b>
1	2017-04	First issue

## Orientation view

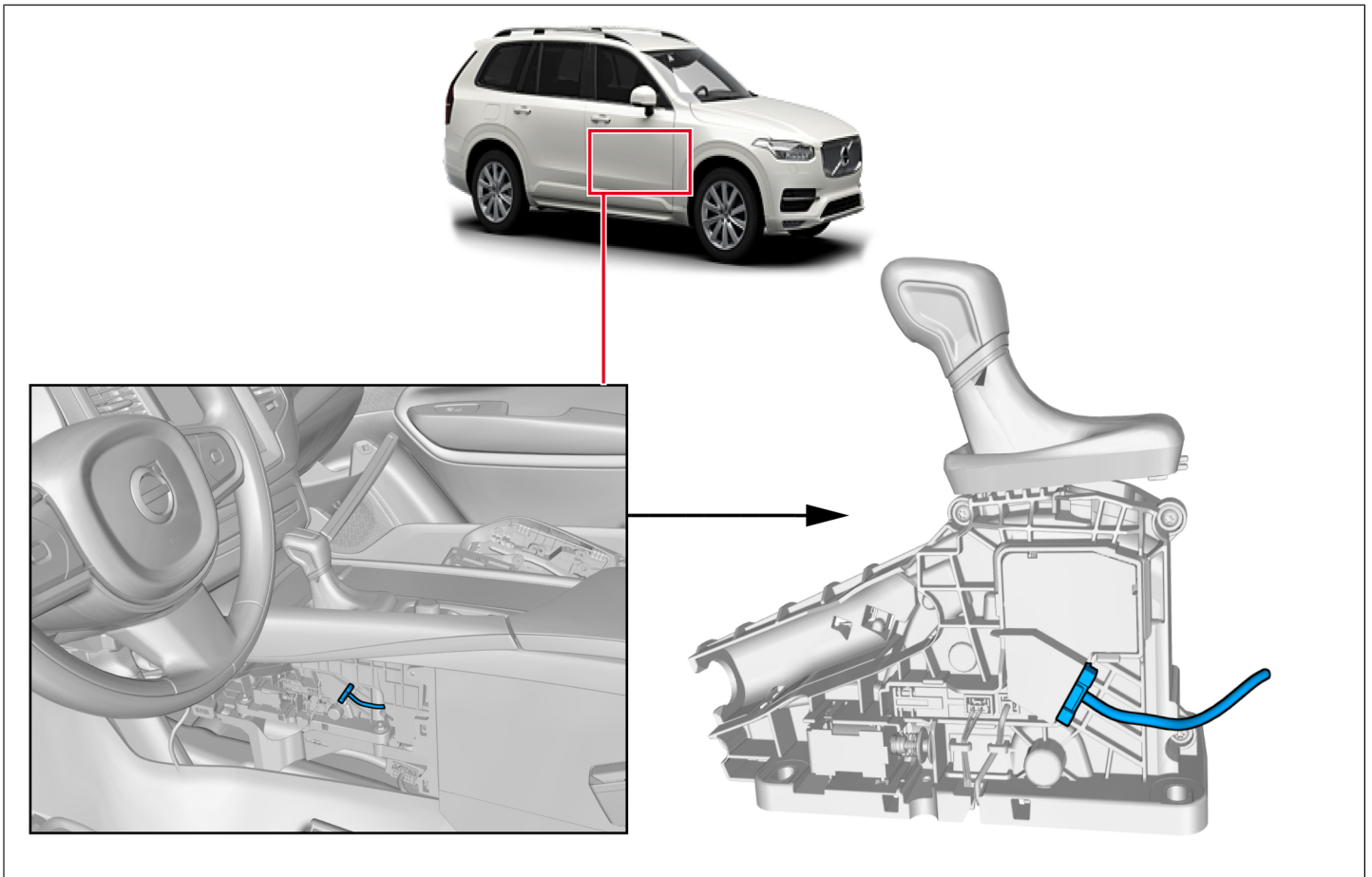

## Color symbols

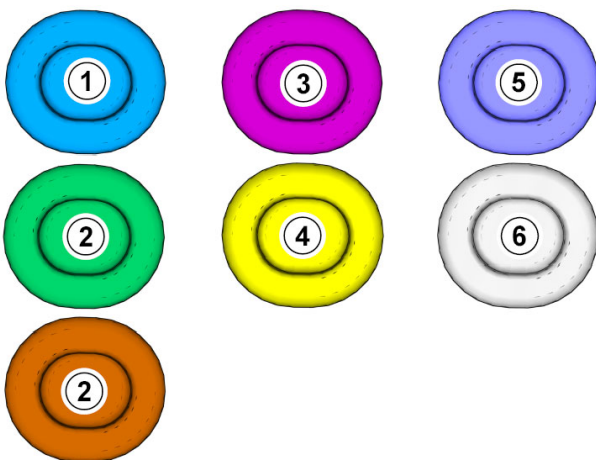

**Note! This colour chart displays (in colour print and electronic version) the importance of the different colours used in the images of the method steps.**

- 1 . Used for focused component, the component with which you will do something.
- 2 . Used as extra colors when you need to show or differentiate additional parts.
- 3 . Used for attachments that are to be removed/installed. May be screws, clips, connectors, etc.
- 4 . Used when the component is not fully removed from the vehicle but only hung to the side.
- 5 . Used for standard tools and special tools.
- 6 . Used as background color for vehicle components.

Removal

**Note! Orientation view**

The graphic shows the back of the component.

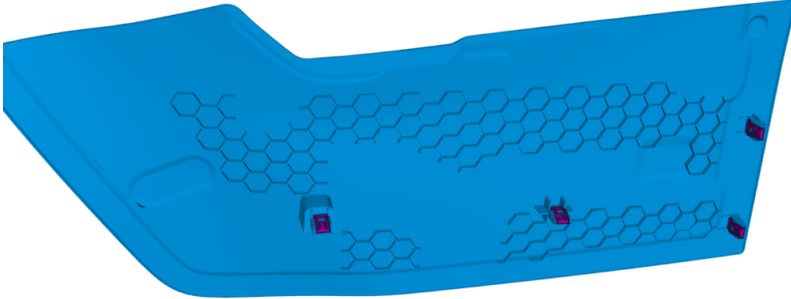

Remove the marked part.

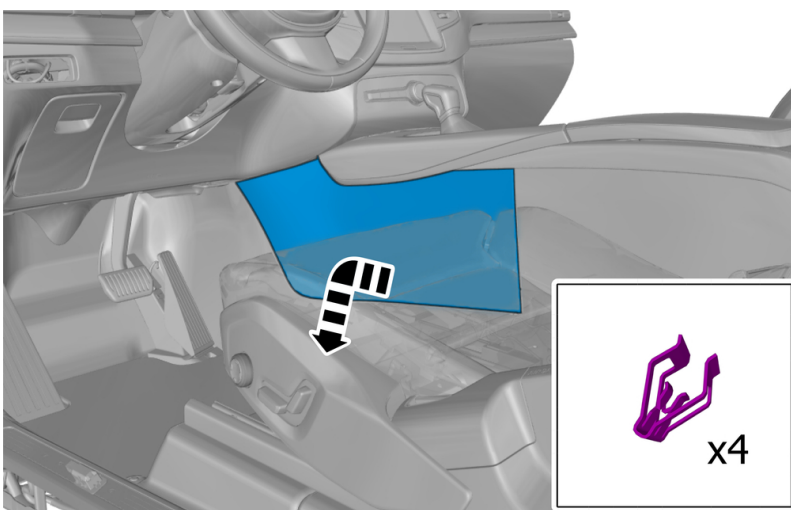

### Check

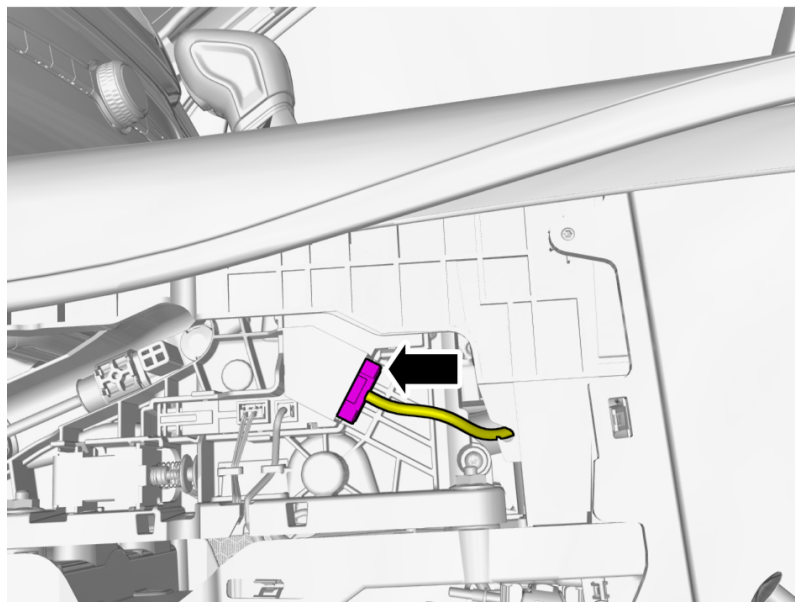

- 1 . Disconnect the connector.
- 2 . Connect the connector.
- 3 . **Caution! Check that the connector(s) is/ are properly connected.**

### Installation

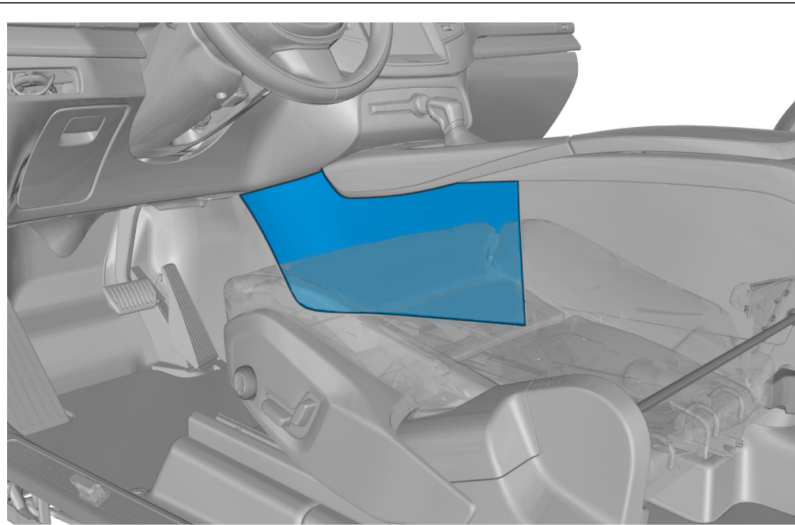

Install the marked component.