

Measure no.	Subject	
US 60577201-03	Fold up armrest	
Status date (mm/dd/yy)	Status	Organization
6/18/15	Accepted	US, MOT
Date created (mm/dd/yy)	Created by	PQM Problem reference
6/18/15	Christine Koehling	
Release date (mm/dd/yy)	Approved by	Dealer release
		Allow automatic release

Vehicles affected		
E series	Engine	Body
K48		
Production period (from/to)	Feedback (all cases relating to	
(mm/dd/yy)	Comment on production period	measure up to) (mm/dd/yy)
/		

Complaint

When riding faster than 100 mph the armrest folds up and blocks the view in the mirror.

Cause

A catch is missing which allows the armrest to fold up when the vehicle is in motion.

Measure

In the event of a complaint, install an optimization retrofit kit for the armrests.

Installing a new plastic washer in conjunction with a rubber bushing increases friction and thus increases the operating force of the folding function. The procedure is described in the attached item. Parts and reimbursement numbers are listed below.

Parts:

1 x 77 25 8 562 492, retrofit kit (includes 2 x plastic washer and 2 x O-ring)

2 x 77 25 8 549 881, protective cap

Reimbursement:

Main labor code 46 72 006 "Optimize comfort armrest" has 6 FRUs

As an Add-on plus code +46 72 506 "Optimize comfort armrest" 5 FRUs

Defect code is 46 62 11 41

Complaint

Fault location	Fault type	Fault place	Fault conditions
Folding centre armrest	Autonomous adjusting / switching over		8th speed: over 160 km/h / 100 mph

Cause

#	Fault location	Fault type	Fault place
1	71/60 Accessories for body		
	Repair Task	Special Clearance	Area
	Retrofit	No	Body and Trim

Fault code**Progman / DIS / ISTA / ISTA/P**

System	State	Version
---------------	--------------	----------------

0601- K 1600 GT / 0602 - K 1600 GTL

46 72 006 Optimising comfort armrest

1

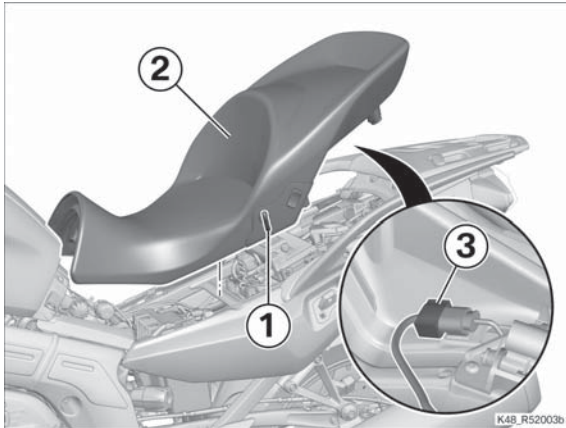

► Removing seat

- Open the seat lock with ignition key **(1)**.
- Slightly lift seat **(2)** and disconnect plug **(3)** for the seat heating.
- Remove seat **(2)**.

2

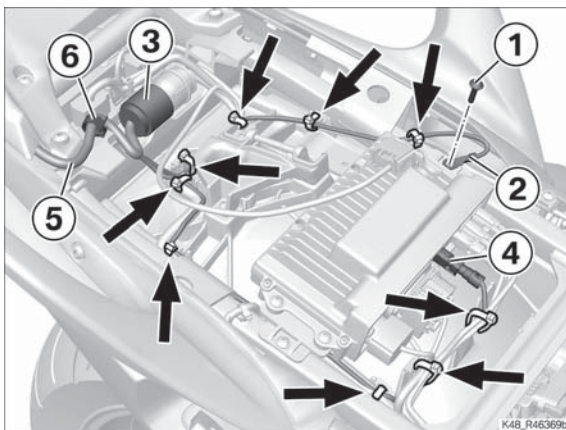

► Removing topcase

- Remove the cable ties **(arrows)**.
- Remove screw **(1)** and remove ground cable **(2)** for the aerial.
- Disconnect plug connection **(3)** for the topcase electrics.
- Disconnect connector **(4)** for the FM aerial.
- Disengage cable leg **(5)** from holder **(6)** and work it clear.

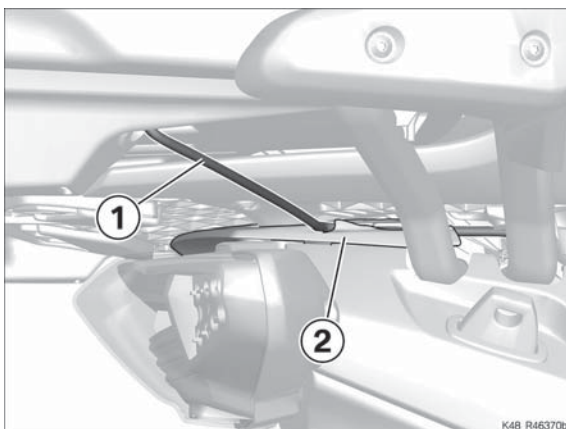

- Disengage cable leg **(1)** from cable guide **(2)** and work it clear.

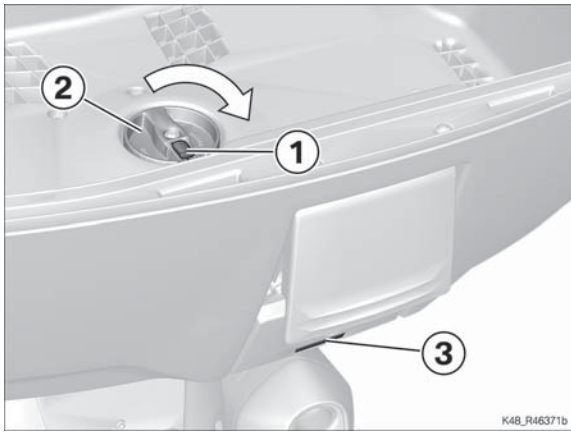

- Open the topcase and remove the carpet.
- Push slide latch **(1)** toward the outside and hold it in this position.
- Turn rotary latch **(2)** clockwise as far as it will go.
 - » Release warning **(3)** is visible.
- Close the topcase.

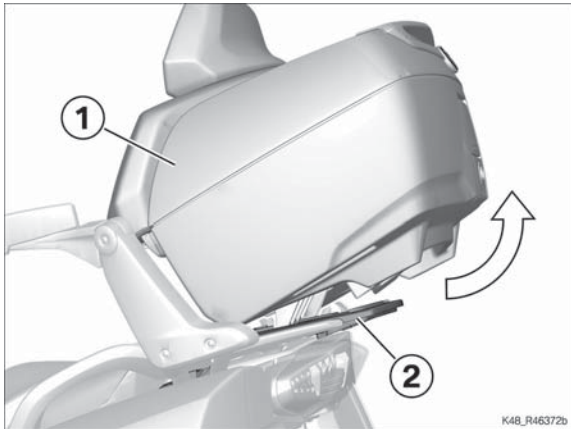

- Lift topcase **(1)** at the rear and remove it from luggage carrier **(2)**.

3

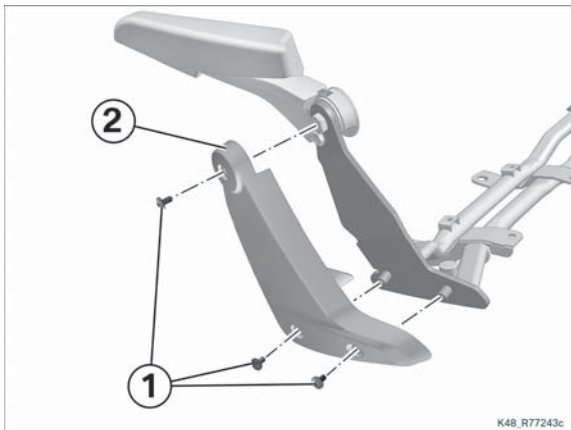

► Removing cover for comfort armrest, left

- Remove screws **(1)**.
- Remove left cover **(2)**.

4

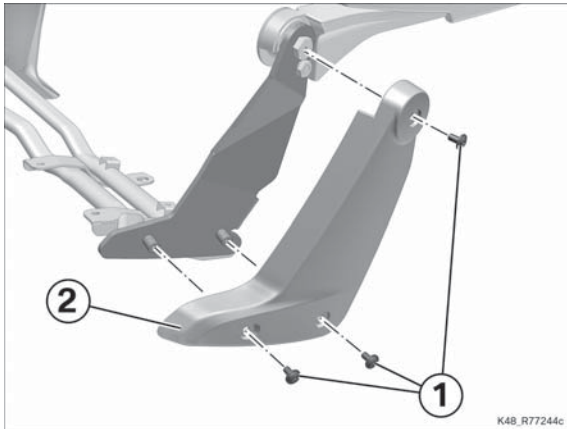

► Removing cover for comfort armrest, right

- Remove screws **(1)**.
- Remove right cover **(2)**.

5

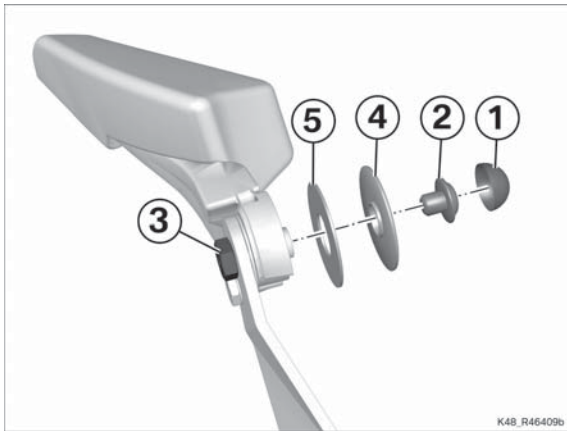

► Optimising comfort armrest

- Remove cap **(1)**.
- Remove screw **(2)** while counter-holding screw **(3)**.
- Remove washers **(4)** and **(5)** and clean.

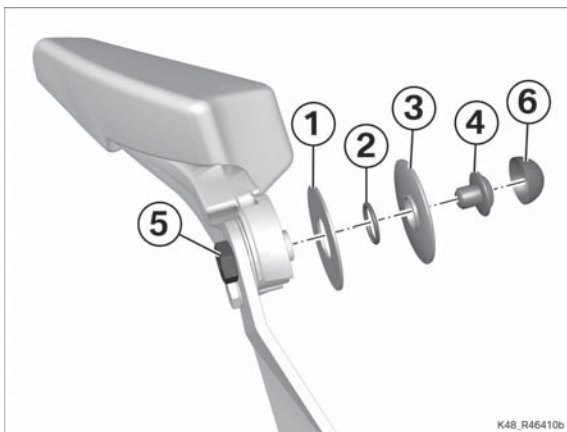

- Transfer lubricant from the old washer to new washer **(1)**.
- Install washer **(1)** and rubber ring **(2)**.
- Install washer **(3)**.
- Install screw **(4)** while counter-holding screw **(5)**.

Tightening torques		
Comfort armrest to support		
Stud, M10 x 10	12 Nm	
Thread-locking compound (Loctite 243, Medium strength)		

- Apply suitable silicone to screw head **(4)** and install protective cap **(6)**.
- Repeat this procedure with the other armrest.

6

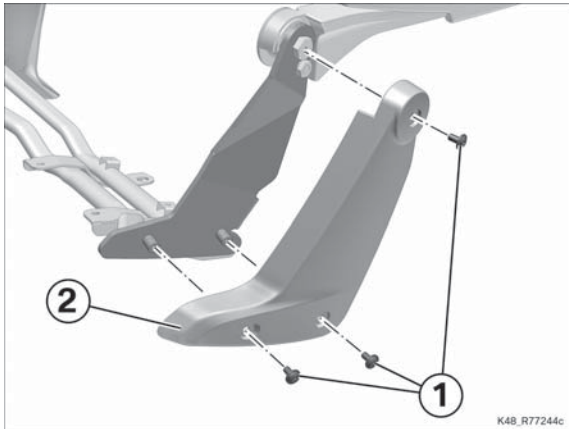

► Installing cover for comfort armrest, right

- Clean the threads.
- Hold right cover (2) in position.
- Install screws (1).

 Tightening torques		
Cover to carrier for comfort armrest		
M5 x 10 Thread-locking compound (Micro-encapsulated) or, Thread-locking compound (Loctite 243, Medium strength)	2.5 Nm	

7

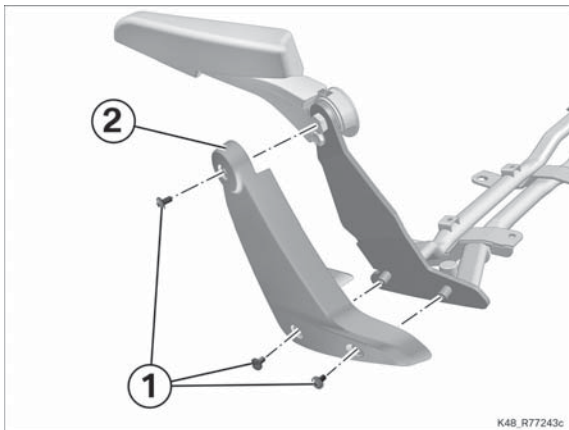

► Installing cover for comfort armrest, left

- Clean the threads.
- Hold left cover (2) in position.
- Install screws (1).

 Tightening torques		
Cover to carrier for comfort armrest		
M5 x 10 Thread-locking compound (Micro-encapsulated) or, Thread-locking compound (Loctite 243, Medium strength)	2.5 Nm	

8

► Installing topcase

ATTENTION

Hard or sharp-edged objects.

Component damage

- Take care not to scratch components; cover or mask as necessary.

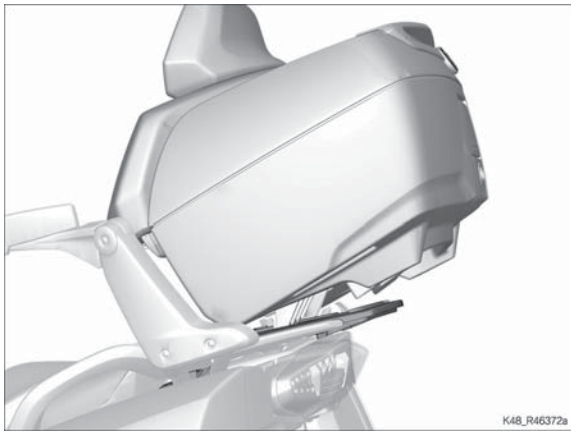

- Set the topcase on the luggage carrier, but do not engage it yet.

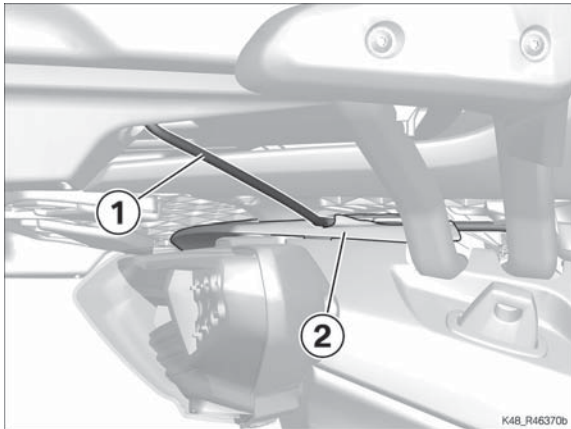

- Work cable leg **(1)** into position, route it forward and secure it in cable guide **(2)**.

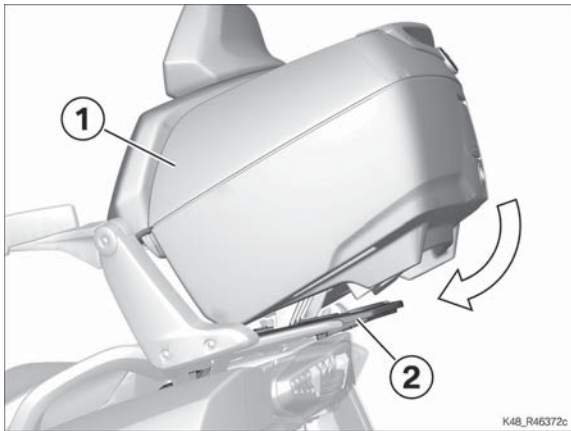

- Insert topcase **(1)** into luggage carrier **(2)**, making sure that topcase **(1)** is not scratched on the armrests.

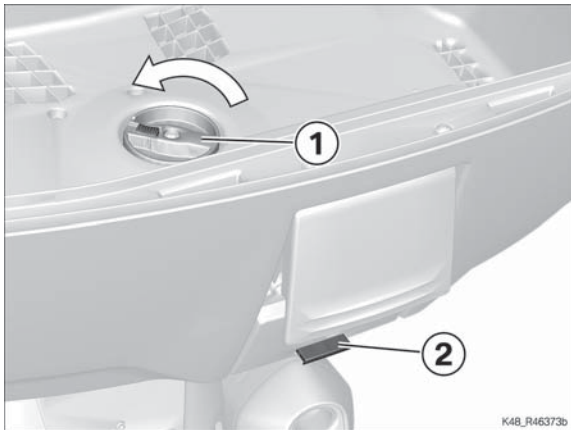

- Turn rotary latch **(1)** as far as it will go counter-clockwise while pressing down on the back edge of the topcase.
 - » Release warning **(2)** is no longer visible.

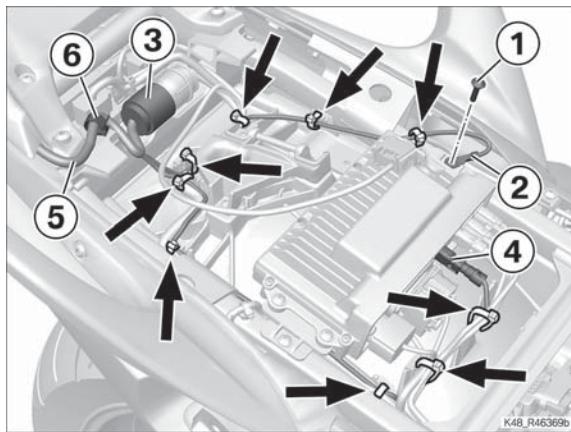

- Route cable leg **(5)** in the rear frame and secure in cable holder **(6)**.
- Connect connector **(4)** for the FM aerial.
- Connect plug connection **(3)** for the topcase electrics.
- Hold ground cable **(2)** for the aerial in position and install screw **(1)**.
- Close the cable ties **(arrows)**.

9

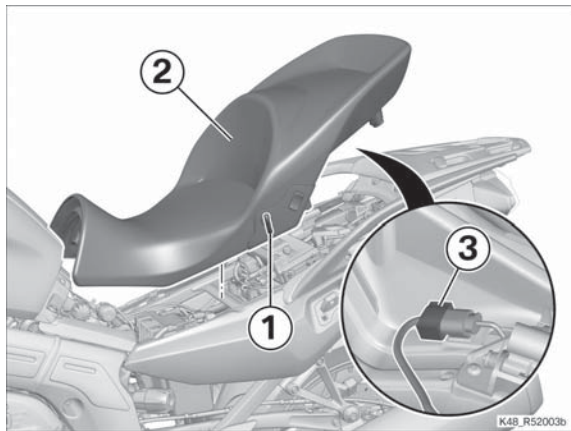

► Installing seat

- Place seat **(2)** in position.
- Connect plug **(3)** for the seat heating.
- Install seat **(2)** and make sure that seat lock **(1)** engages.

10

► Final check of work performed

- Check that
 - the work as performed achieved the intended purpose.
 - all reservoirs and containers have been filled and that all fluids and lubricants are at their correct levels.
 - all threaded fasteners released beforehand have been correctly retightened.
 - the fuel system is free of leaks.
 - the lights and signalling equipment are fully operational and that the motorcycle is roadworthy.
 - the brake pads of the front and rear brakes are bedded against the brake discs.

▷ Function test, engine start suppression

Check

- Move the kill switch to the operating position (ON).
- Select neutral.
- Switch on the ignition.
 - » Neutral telltale light "N" lights up.

- Select a gear.
 - » Neutral telltale light "N" goes out.
- Press the starter button.
 - » Starter does **not** operate.
- Extend the side stand.
- Pull the clutch lever.
- Press the starter button.
 - » Starter does **not** operate.
- Retract the side stand.
- Press the starter button without releasing the clutch lever.
 - » Starter operates.

Result

Not all test steps completed successfully.

Measure

- Check the appropriate parts with the BMW Motorrad diagnostic system.

