



NUMBER: 23-020-15

GROUP: Body

DATE: May 23, 2015

This bulletin is supplied as technical information only and is not an authorization for repair. No part of this publication may be reproduced, stored in a retrieval system, or transmitted, in any form or by any means, electronic, mechanical, photocopying, or otherwise, without written permission of FCA US LLC.

THIS SERVICE BULLETIN IS ALSO BEING RELEASED AS RAPID RESPONSE TRANSMITTAL (RRT) 15-058. ALL APPLICABLE SOLD AND UN-SOLD RRT VIN'S HAVE BEEN LOADED. TO VERIFY THAT THIS RRT SERVICE ACTION IS APPLICABLE TO THE VEHICLE, USE VIP OR PERFORM A VIN SEARCH IN TECHCONNECT. ALL REPAIRS ARE REIMBURSABLE WITHIN THE PROVISIONS OF WARRANTY.

SUBJECT:

Replace Missing Manual Release Cover For The Electric Fuel Door

OVERVIEW:

This bulletin involves installing a cover for the fuel door manual release cable.

MODELS:

2015

(BU)

Jeep Renegade (Latin America Vehicles Only)

NOTE: This bulletin applies to vehicles built on or before April 09, 2015 (MDH 0409XX).

SYMPTOM/CONDITION:

The customer may describe a loose cable hanging in the right rear of the cargo compartment area.

DIAGNOSIS:

If a customer's VIN is listed in VIP or your RRT VIN list, perform the repair. For all other customers that describe the symptom/condition listed above, perform the Repair Procedure.

PARTS REQUIRED:

Qty.	Part No.	Description
1	735623051	Cover

REPAIR PROCEDURE:

1. Open the rear hatch (Fig. 1).



Fig. 1 Rear Hatch

2. If cover is not present and cable (1) is hanging perform the repair (Fig. 2).

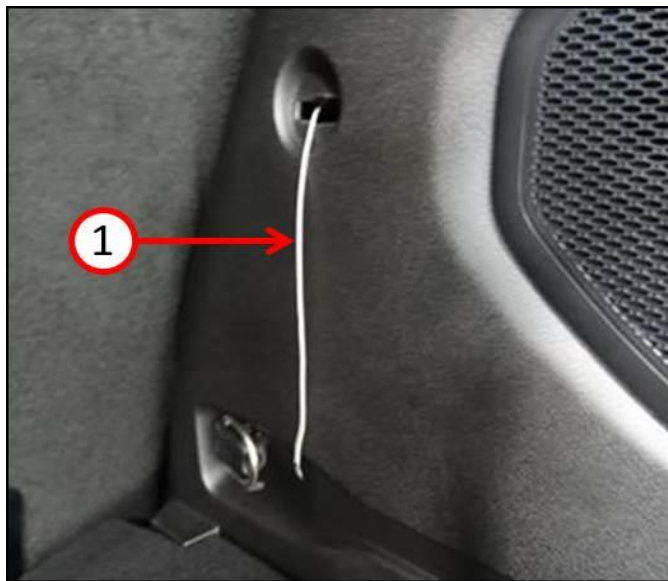

Fig. 2 Loose Cable

1 - Cable

3. Install the cable (2) onto the new cover (1) (Fig. 3).

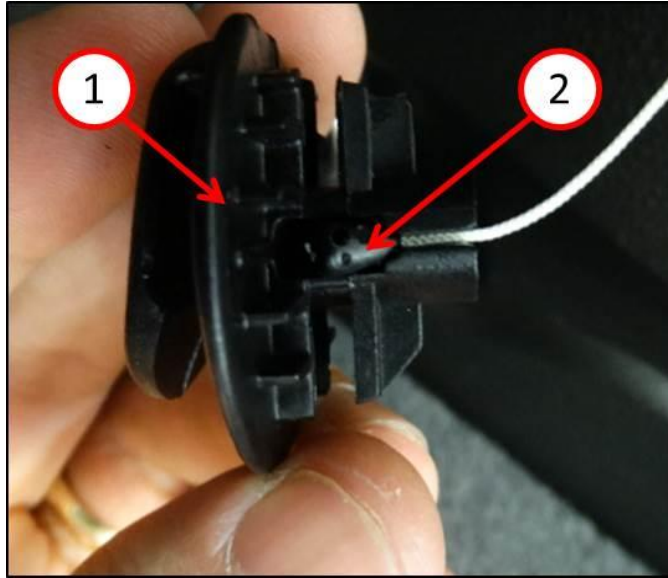

Fig. 3 Cable Insertion

- 1 - Cover
- 2 - Cable

-
4. Make sure the cable is fully inserted into the cover (1) as shown (Fig. 4).

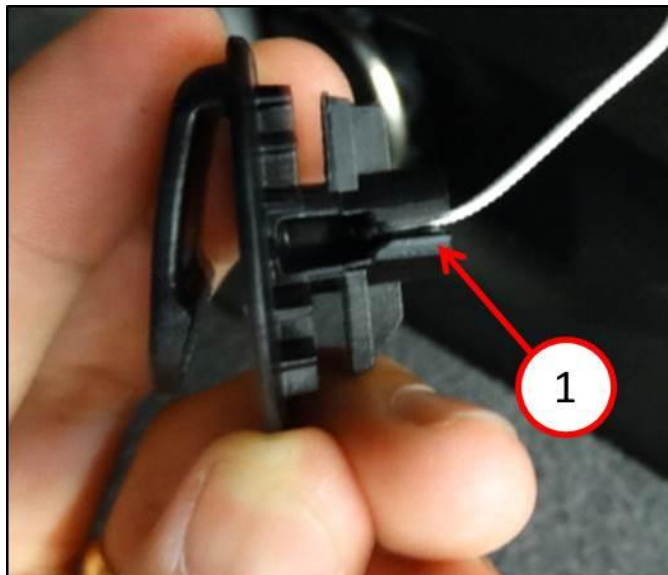

Fig. 4 Cable Fully Inserted Into Cover

- 1 - Cover
-

5. Install the cover and cable into trim cover as shown and turn the cover 90° counterclockwise until it's completely locked into place (Fig. 5).



Fig. 5 Installing Cover

6. Make sure the cover (1) is flush and installed properly (Fig. 6).



Fig. 6 Cover Installed

1 - Cover

POLICY:

Reimbursable within the provisions of the warranty.

TIME ALLOWANCE:

Labor Operation No:	Description	Skill Category	Amount
23-41-38-90	Install Release Cover for Manual Fuel Door (1 - Semi-Skilled)	6 - Electrical and Body Systems	0.2 Hrs.

FAILURE CODE:

ZZ	Service Action
----	----------------