



SI B41 01 18  
Body

December 2018  
Technical Service

## CRACKING NOISE FROM THE UPPER DOOR HINGE WHEN OPENING

### MODEL

G15 (8 Series Coupe)	G14 (8 Series Convertible)
----------------------	----------------------------

### SITUATION

There is a cracking noise from the area of the upper door hinge when opening the door to the end stop.

### CAUSE

Interference between the inner door hinge support and the door. The interference is only present from the upper hinge supports of either door.

### CORRECTION

Apply cavity protection between the door and door hinge support.

### PROCEDURE

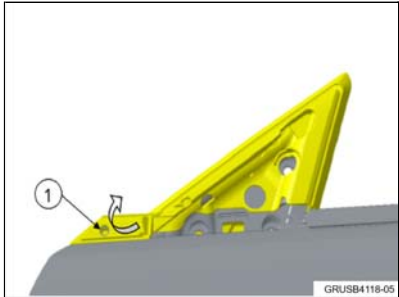
	1. For the affected door(s), remove the side view mirror, following repair instructions REP 51 16 001 " <b>Removing and installing the exterior mirror on left or right front door</b> ".
 <p>GRUSB4118-05</p>	2. Position seal (1) out of the way to allow for a visual inspection the door hinge support inside the door.
	3. With the seal repositioned, the door hinge support (inside the door cavity) can be accessed.

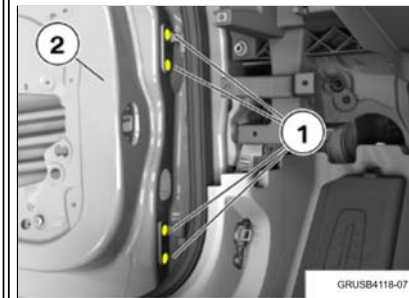
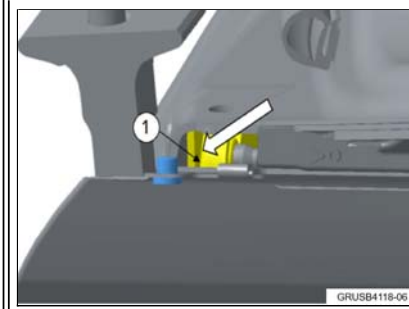

4. Loosen, but do not remove the top 2 door hinge screws (1) from the door (2).

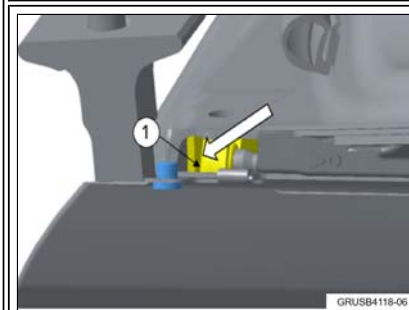

5. Using the access hole from step 2, spray cavity protection spray PN 83 42 2 457 337 between the inner door hinge support and the door.



Note: Slight downwards pressure can be applied to the

door to open the gap between the support and the door to allow for complete application of cavity protection.

6. Re-tighten the door hinge bolts to 19Nm.

7. Test to ensure the noise is no longer present. If no noise is present, completely re-assemble the vehicle.

## PARTS INFORMATION

Part Number	Description	Quantity
83 42 2 457 337	Cavity protection spray (400ml)	As needed

## WARRANTY INFORMATION

Covered under the terms of the BMW New Vehicle Limited Warranty for Passenger Cars and Light Trucks.

<b>Defect Code:</b>	<b>4151013900</b>	
---------------------	-------------------	--

Noise is present at one front door:

<b>Labor Operation:</b>	<b>Labor Allowance:</b>	<b>Description:</b>
51 16 001	Refer to AIR/KSD2	Removing and installing the outside rearview mirror on left or right front door (Main work)
Or:		
51 16 501	Refer to AIR/KSD2	Removing and installing the outside rearview mirror on left or right front door (Plus work)
And:		
41 00 009	3 FRU	Work time to apply cavity protection spray to door hinge.

If you are using a Main labor code for another repair, use the Plus code labor operation 51 16 501 instead of 51 16 001.

#### Noise is present at both front doors

<b>Labor Operation:</b>	<b>Labor Allowance:</b>	<b>Description:</b>
51 16 021	Refer to AIR/KSD2	Removing and installing both outside rearview mirrors on the front doors (Main work)
Or:		
51 16 521	Refer to AIR/KSD2	Removing and installing both outside rearview mirrors on the front doors (Plus work)
And:		
41 00 009	5 FRU	Work time to apply cavity protection spray to both door hinges.

If you are using a Main labor code for another repair, use the Plus code labor operation 51 16 521 instead of 51 16 021.

Refer to AIR/KSD2 for the corresponding flat rate unit (FRU) allowances.

Work time labor operation code 41 00 009 is not considered a Main labor operation. Also, since the "work time" FRU allowance to be claimed is specified, a separate punch time is not required. However, it still requires an explanation on the repair order and in the claim comments section.

And:

#### Sublet – Bulk Materials

<b>Sublet Code 4</b>	See the sublet reimbursement calculations below	Reimbursement for the repair-related bulk materials (Do not use part numbers for claim submission)
----------------------	---	--

Sublet reimbursement calculation for claiming the applicable repair-related bulk materials (BMW part numbers) is at the dealer net price for the "quantities used" plus your center's handling.

Enter this material cost in sublet and itemize the amount on the repair order and in claim comment section.

[ Copyright ©2018 BMW of North America, Inc. ]