



Condition

ATTENTION:

**THIS IS A TECH TIP, NOT A TECHNICAL BULLETIN.
TECH TIPS ARE NOT ASSOCIATED WITH WARRANTY CLAIMING.**

Applicable Vehicles

Model(s)	Year	Eng. Code	Trans. Code	VIN Range From	VIN Range To
Golf, GTI, eGolf, Sportwagen, Jetta, Passat, CC, Tiguan, Tiguan LWB, Atlas, Touareg	2015-2019	All	All	All	All

Revision Table

Instance Number	Published Date	Version Number	Reason For Update
2049470/2	6/14/19	91-17-06TT	Update to model year applicability.
2049470/1	11/17/ 7	91-17-06TT	Original publication.

Technical Background

Ensure proper electrical connection prior to antenna replacement.

Satellite radio or GPS navigation complaints may be accompanied by the following DTCs:

DTC	Description
B10F411	Antenna for satellite radio open circuit
B105F13	GPS antenna open circuit

Service

If during diagnosis of complaints related to malfunctions of the satellite radio or GPS navigation, the testing leads toward replacement of the antenna, first ensure there are no electrical connector issues at the antenna itself (see Figure 1).

If any connection issues exist at the antenna, repair the connection issue and retest before proceeding to antenna replacement. DO NOT replace the antenna before ruling out connection issues.

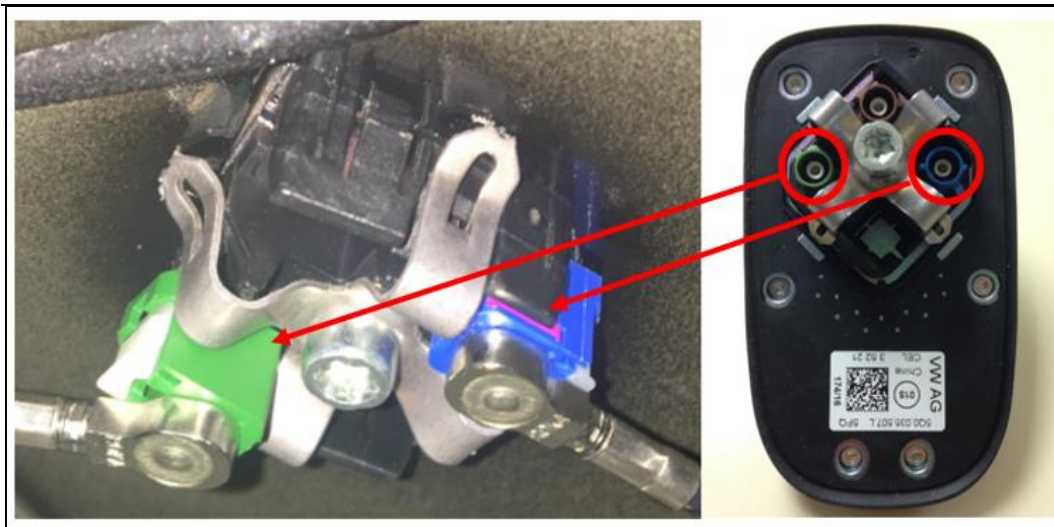

Figure 1.

Additional Information

© 2019 Volkswagen Group of America, Inc. All rights reserved. Information contained in this document is based on the latest information available at the time of printing and is subject to the copyright and other intellectual property rights of Volkswagen Group of America, Inc., its affiliated companies and its licensors. All rights are reserved to make changes at any time without notice. No part of this document may be reproduced, stored in a retrieval system, or transmitted in any form or by any means, electronic, mechanical, photocopying, recording, or otherwise, nor may these materials be modified or reposted to other sites, without the prior expressed written permission of the publisher.