

NEW SELECTOR MECHANISM SPARES KIT



Notice Information

Ref	11141
Posted Date:	
Posted To:	General Manager / Business Owner, Technician, Parts / Accessories Coordinator, Aftersales Manager, Service Leader / Advisor, Accounts / Admin
Subject:	Service/Technical

TOL NOTICE (US&CAN) – June 27, 2019

TOL Ref. # 11141-SVC

New Selector Mechanism Spares Kit

A revised gearchange shaft has been introduced to all liquid-cooled Triumph Modern Classics models. Spares kit **T1191968** has been released for use when replacing the gearchange shaft on all 900cc and 1200cc liquid-cooled twin models.

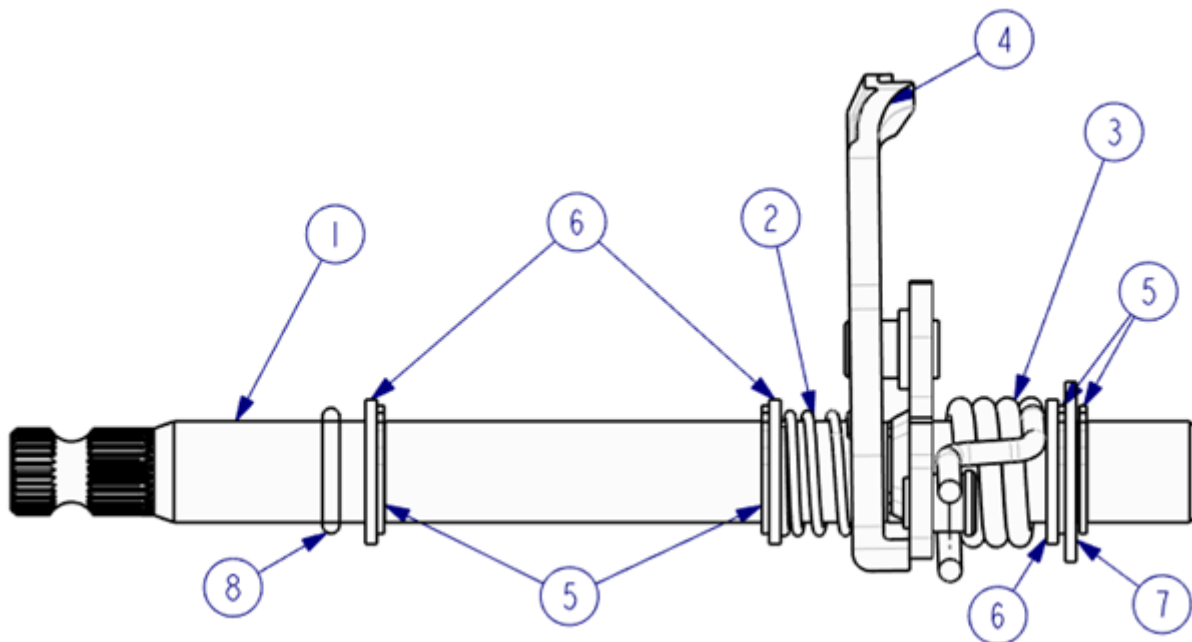

1. Selector mechanism
2. Pivot plate spring
3. Gearchange return spring
4. Pivot plate
5. Circlip
6. Washer, 14.0 x 20.0 x 1.6
7. Washer, 14.5 x 25 x 1.5
8. O-ring (to be discarded before fitting)

The O-ring (item 8) is fitted for shipping purposes only and must be discarded prior to fitting of the shaft. Installation of the new gearchange shaft is as described in the appropriate Service Manual. Please refer to the Triumph Online EPC dropdown when ordering replacement parts.

Please contact Triumph Customer Support at (888) 284-6288 if you have any questions regarding this new selector mechanism spares kit.