



August 5, 2019

Product Change Notice - New screws for screen door catches

Dear Valued Customer:

Please be advised we are changing the length of our screen door catch screws (Fig. 1A) from # 8 - 15 X 1/2 Square Pan Head to #8 X 1 Square Pan Head (Fig. 2).

The new screw has more threads for better thread engagement. The new, longer screw also makes adjusting the catch easier if needed.

There is no change in fit, form or function with the new screws. The current screw part number is 328275 and the new screw part number is 227619. The overall assembly number for the door does not change, nor does the part number for the screen door catch.

Fig.1

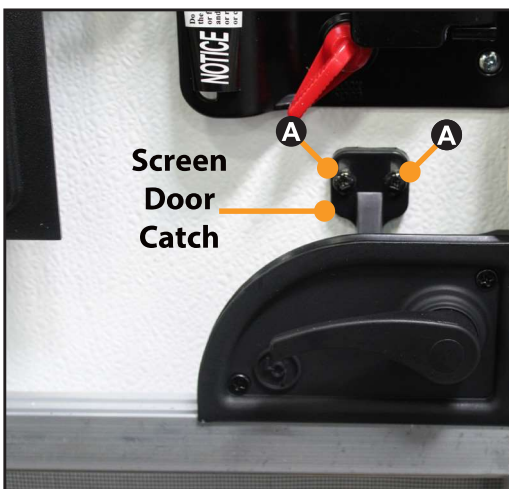
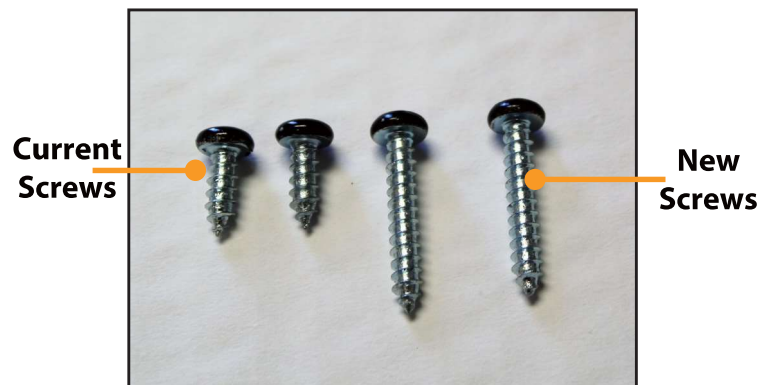

Fig.2



If you have any questions, please feel free to call me directly or your LCI representative. We value and appreciate your business and partnership.

Sincerely,

Scott McKinnon
Product Manager
c: 269.832.6800
smckinnon@lci1.com

Frequently Asked Questions:

- 1. Will a new part number be required?** Yes, the current screw part number is 328275 and the new screw part number is 227619
- 2. Does the price change for the item?** No, there is no price change.
- 3. Is the new part wholly interchangeable with the previous version of the part?** Yes, the screws are interchangeable.
- 4. Does the customer need to replace inventory?** No, the change will be made on a running basis, starting this week.