

Step well Panel Rework

Description:

This procedure outlines the steps to install mechanical fasteners on the step well of MY 2018 J4500 coaches.

WARNING

Read this entire procedure before beginning work.

Use Safe Shop Practices at All Times.

To avoid personal injury:

- a. Proper Personal Protective Equipment (PPE) must be worn. Safety glasses and protective gloves are required for working with DEF Fluid.*
- b. Turn the main battery disconnect switch to the OFF position.*
- c. Ensure that both the front and the rear wheels are chocked.*
- d. Positioning the ENGINE RUN and ENGINE START switches on the engine compartment remote control box to the OFF position.*
- e. Allow enough time for components to cool down prior to working in the engine compartment.*

1.0 Material requirements:

Service Kit **T03-3020** contains the following parts:

ITEM	PART NO.	QTY	U/M	DESCRIPTION
1	19-05-0253	2	EA	Receptacle- Captive Screw
2	18-13-271	4	EA	Rivet- 1/8 SST
3	03-01-3184	2	EA	Foam- Spacer, Dzus
4	19-05-0252	2	EA	Retainer- captive screw
5	19-05-0408	2	EA	Screw- Fast Lead, Cross Recess
6	19-05-0294	2	EA	Cover- Screw, Blk Hinged

3.0 Special Tools:

- Template- Stepwell Left, T03-3019
- Template- Stepwell Right, T03-3018
- Rivet gun
- 1/4" drill bit
- 1/8" drill bit

4.0 Drilling holes in the step well

Locate the step well on the right side of the entrance area and place LH template, 03-33-3676, on the left end, towards driver seat, of the step well such that the edges of the template and step well align and mark the hole location on the step well.

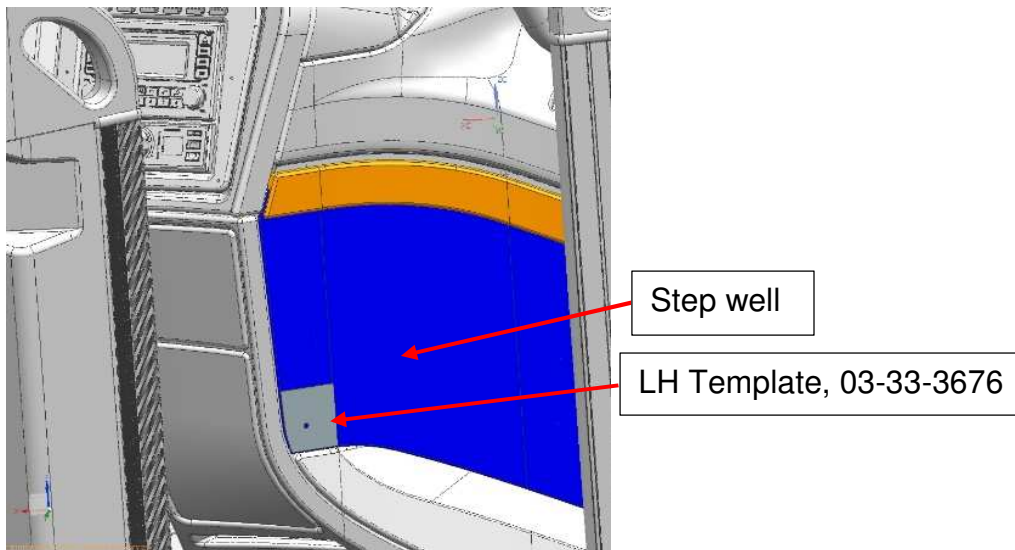

Repeat the process on the right corner, towards entrance door, of the step well with the RH template, 03-33-3677.

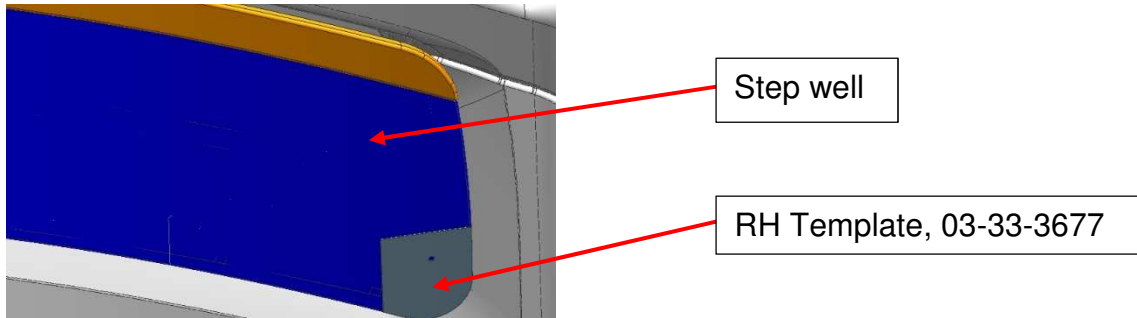

Pull the step well out to detach it from the coach and using a 1/4" drill bit, drill holes at the marked locations.

5.0 Installing hardware on the dash

Install the step well back on the coach and mark the location of holes on the dash behind the step well. Remove the step well again. Save the step well for later use.

Remove the dash by removing the below mentioned screws and save them for later use.

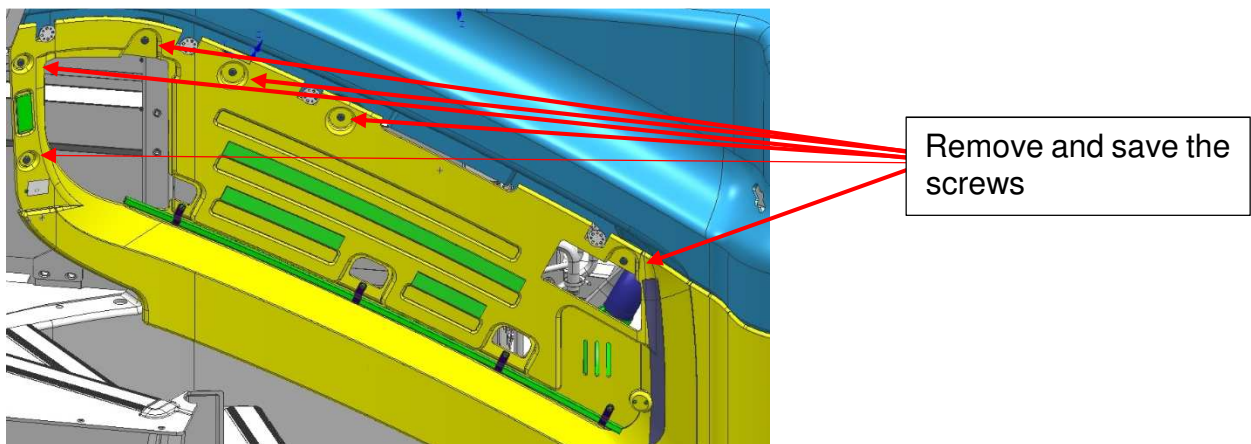

Once the dash is detached, drill holes at the marked location using a 1/4" drill bit.

Using the just drilled holes as reference place receptacles, 19-05-0253, on each hole from behind the dash such that the axis of middle hole in the receptacle aligns with the just drilled hole.

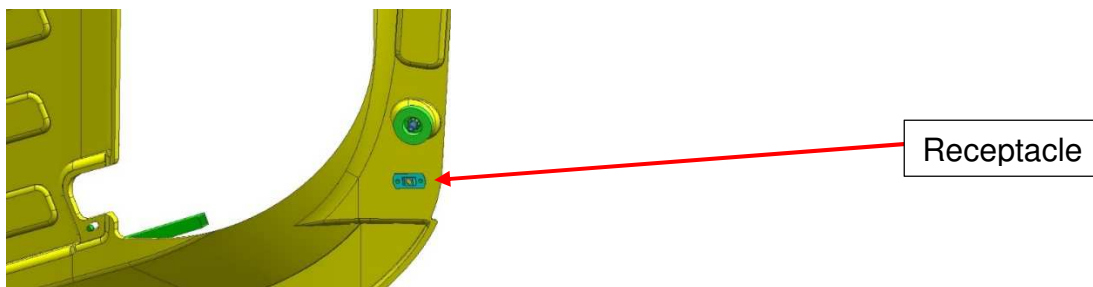

Mark the other two holes locations of the receptacle on the dash. Using a 1/8" drill bit, drill holes

Install receptacle to the dash by installing two rivets, 19-13-271, in the 1/8" diameter holes using rivet gun.

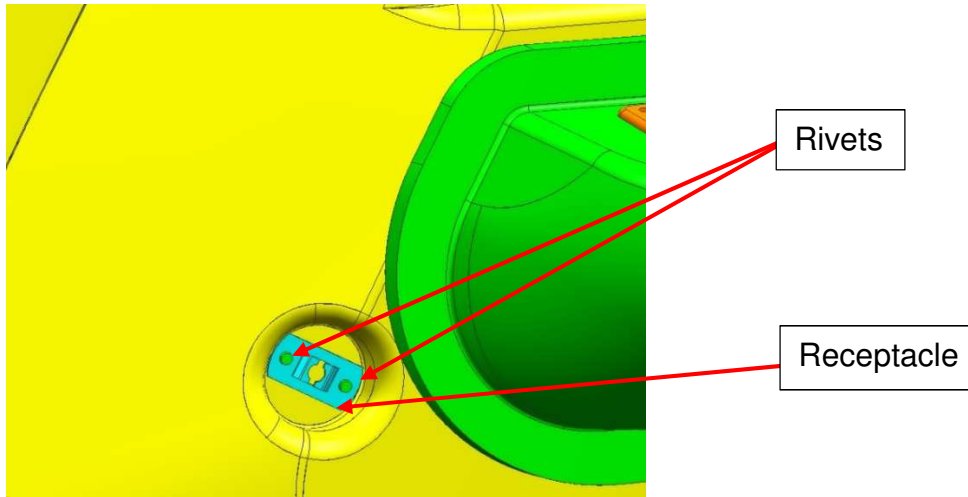

Install the dash back by installing the previously removed screws

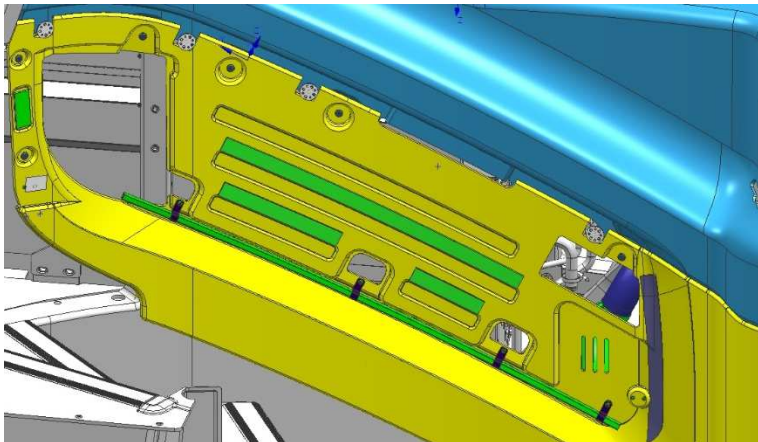

6.0 Install the step well

With the newly drilled holes as reference, from behind the step well, trim the fabric as shown below

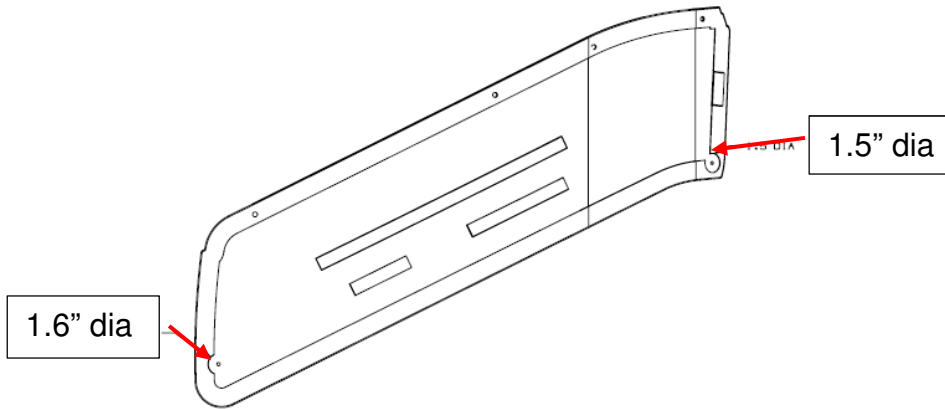

Place foam spacers, 03-01-3184, around the holes as shown below

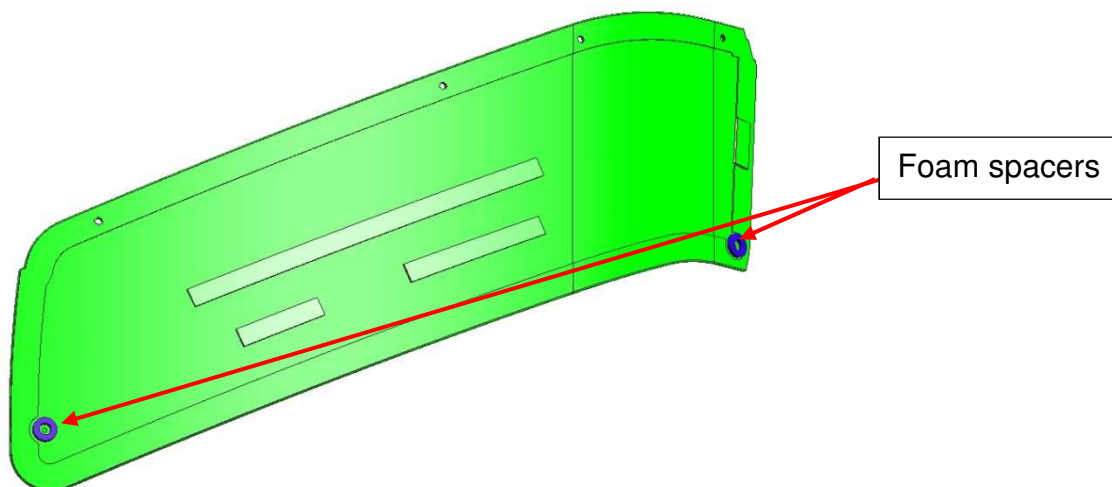

Install screws, 19-05-0408, in each hole from the front and use retainers, 19-05-0252, in the back to hold the screws.

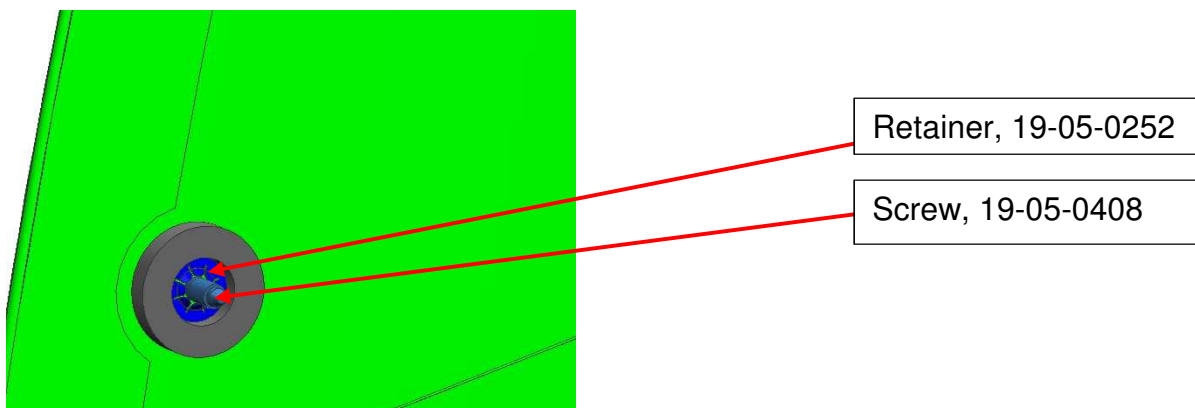

Install the step well to the coach and tighten the just installed screws.



Screw, 19-05-0408

Place screw covers, 19-05-0294, on the screw heads of just installed two screws.

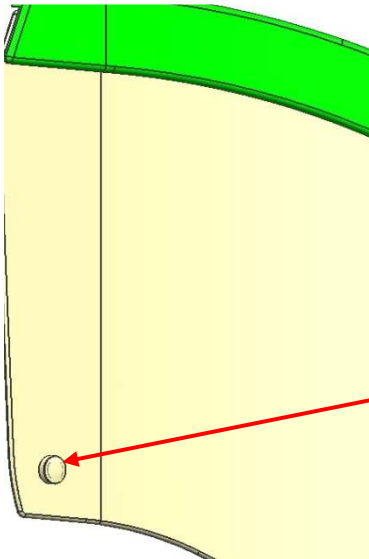

Screw cover, 19-05-0294

End of the procedure