

Audi Technical Update

Summer 2019

Agenda

01. Body

1.1 Examples of customer misuse

02. Chassis

2.1 Wheel change mode/jacking mode

03. Electrical

3.1 Alexa in the Audi e-tron quattro
3.2 myAudi map update for MIB2+

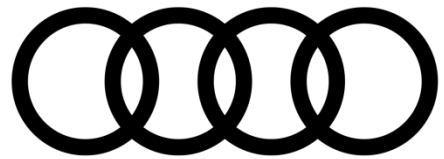

Electrical

3.1 Alexa in the Audi e-tron quattro

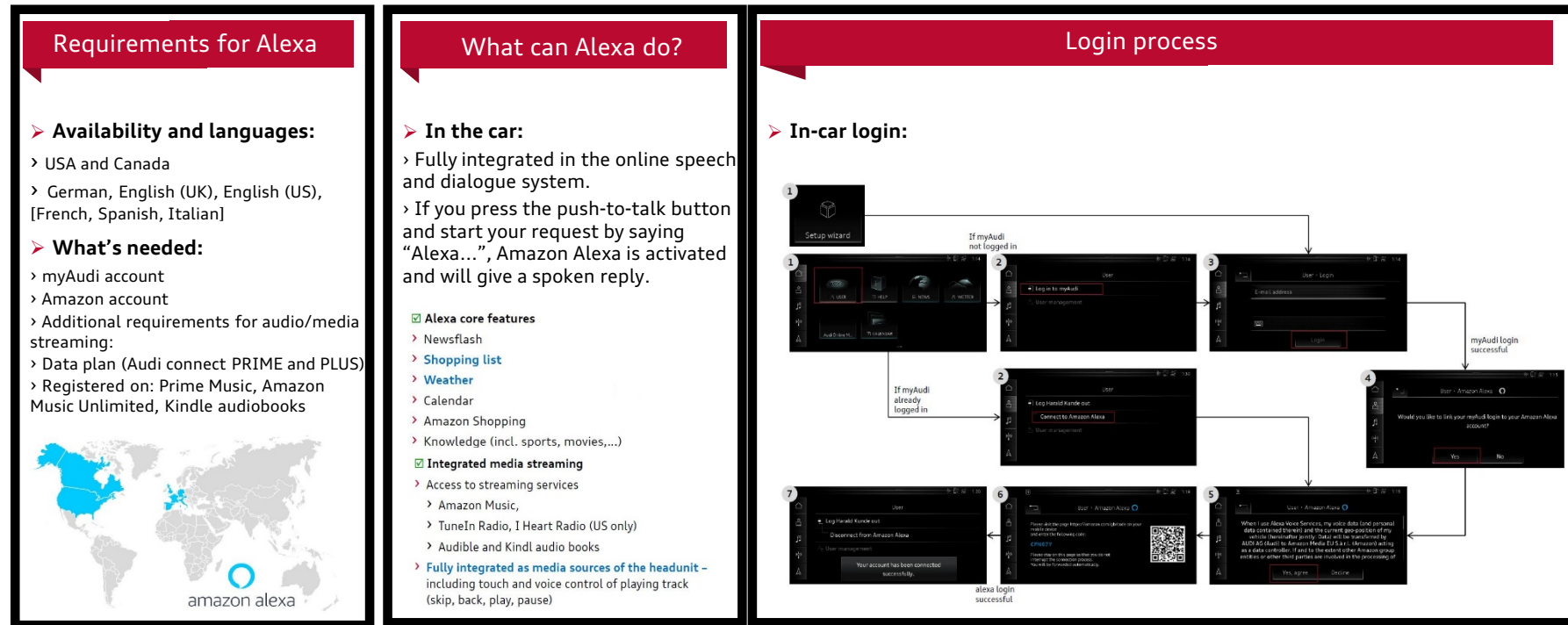

Data protection when using Alexa

- **Customer statements are only transmitted to Amazon if all of the following requirements are fulfilled:**
 - › The customer has activated Alexa integration by connecting his/her car to his/her Amazon account.
 - › The customer has pressed the push-to-talk button on the steering wheel.
 - › The Audi speech recognition feature has recognised the key word "Alexa" at the start of what the customer says.
 - › Alexa listens until the dialogue has finished or the time has elapsed.
- **What information is transmitted to Amazon, and who stores or analyses the dialogues?**
 - › The statement itself and the current geographical location so that Alexa can provide information that is relevant for the location – e.g. a weather forecast for the current location.
 - › Only Amazon has access to the statements which are directed to Alexa.

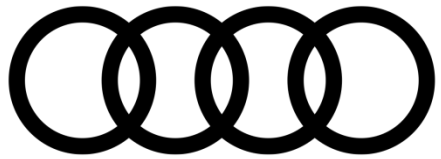

myAudi map update for MIB2+

3.2 myAudi map update for MIB2+

Product description in the configurator for new vehicles (<https://www.audiusa.com/myaudi>) (example shows the Audi Q8):

- > The map version delivered with the vehicle can be updated free of charge on a quarterly basis for up to a maximum of five years after the end of production of the infotainment equipment generation installed in the vehicle. The latest navigation data are made available for download on the myAudi platform at <https://www.audiusa.com/myaudi> and can be installed in the vehicle using an SD card. In conjunction with Audi connect, the maps can also be downloaded and updated directly in the vehicle. In addition, it also possible to have the new navigation data installed at an Audi Partner (additional charges are incurred for this service).

Content description of the map update function in myAudi (<https://www.audiusa.com/myaudi>):

- > “The Audi connect map update keeps the maps for your navigation system up-to-date at all times.”

myAudi

Overview Services

Twitter Map update Online news Destination entry via Google Maps™ Destination entry via myAudi City events Flight information

Service enabled

Map update ⓘ

Digital road map North America (Mexico, Canada, USA) Version 2019

Complete package You can download the complete package here

Individual country package Please select

Please note the following:

1. The latest map updates can be downloaded here free of charge and then installed in the vehicle via SD card. You can download and install the updates an unlimited number of times. The Map Update includes the first five updates to the version of the map installed at the factory. The updates are issued every six months.
2. Transferring the new map package overwrites the map package currently stored in the MMI. The currently installed version can be found in the MMI under -> Setup MMI -> Version information -> Navigation database country versions.
3. You can also have the new map data installed by an Audi dealer (there would be a charge for this service).

More information Prepare package

Privacy policy Contact Audi of America. All rights reserved. © Copyright 2018

3.2 myAudi map update for MIB2+

Important information on the online map update

- › The online map update is always one quarter ahead of the production line and myAudi.
 - › The next online update can be started directly after the vehicle is delivered or after an update from myAudi (<https://www.audiusa.com/myaudi>) is installed.
- › If the “Automatic” setting is selected, the online map update starts automatically; the customer does not need to take any action.
- › The possible options in the settings are “Automatic” and “With request”.
- › Up to five regions where the vehicle travels regularly are included.
- › At least 20 bus sleep cycles in a region are necessary with at least 1.25 miles of position change in the quarter. The five regions with the highest count receive an online update.
- › After an online update, the counter returns to zero.
- › Additional features planned starting with MIB3, e.g. in the case of starting a route for a holiday journey where the destination is far away.

3.2 myAudi map update for MIB2+

Important information on the myAudi map update

(<https://www.audiusa.com/myaudi>):

- › A **complete map update** is only available by downloading from myAudi.
- › Only two new map versions are made available in myAudi each year.
- › These two versions conform to the two implementations on the production line each year.
- › New versions in myAudi are from one quarter before the online update version.
- › Ready-to-use SD cards for each version are currently **not** yet available in ETKA.
- › Exception: SD cards with navigation data for TPIs or field campaigns.
- › Workshops can create an SD card if necessary using their own myAudi account and the chassis number of the customer's vehicle. It is not necessary to verify the account or register a key user to do so.

3.2 myAudi map update for MIB2+

Concerns in 2019 regarding the myAudi map update (<https://www.audiusa.com/myaudi>):

The map version offered in myAudi is too old, sometimes older than the version delivered with the vehicle.

- › The download from myAudi does not start. An error message appears.

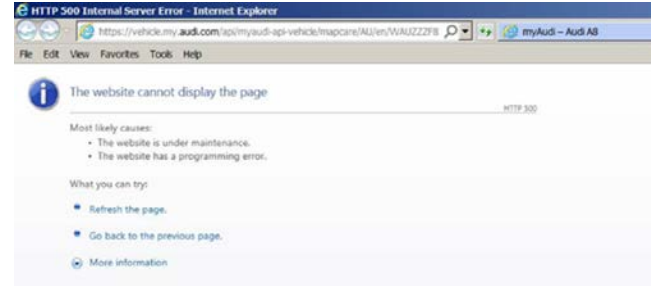

Result:

- › A complete map update is not possible. Measures that were implemented in the maps cannot be used.

Technical causes/measures:

- › It has been ensured that a new map version is available (worldwide) for myAudi → as of week 17/19.
- › North America (NAR) available as of 24/19.
- › Download function from myAudi not working → available again as of week 14/19.
- › Incorrect results from check to verify which map version has a valid licence → corrected as of week 46/18.

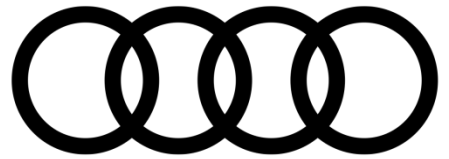

Thank you!