

Seat belt wet, SRS light on

Topic number	LI91.40-N-056663
Version	1
Design group	91.40 Seat belts, emergency tensioning retractors
Date	07-23-2013
Validity	Model 906 with CODE (T16) Right load compartment sliding door and/or with CODE (T19) Left load compartment sliding door
Reason for change	
Reason for block	

Complaint:

Seat belt is wet, SRS light is on.

Cause:

Water ingress at the B-pillar (sliding door side), which can cause contact problems in the connector of the emergency tensioning retractor.

Remedy:

Installing a cover on the opening in the B-pillar (inside) prevents water from entering the electrical connection of the emergency tensioning retractor.

The cover(s) are only to be installed on the side of the vehicle with the sliding door.

The following steps are to be performed:

1. Unclip B-pillar trim and place to one side (see: AR68.30-D-4700A).
2. Clean and dry electrical connection of emergency tensioning retractor (File 2, item 3).

NOTE: To do this, separate the connection (File 2, item 3) and use suitable tools.

3. Install cover (File 1, item 1 or 2) for emergency tensioning retractor (File 2, item 4).

NOTE: Clip the cover (File 3, item 1 or 2) into the opening (File 3, item 5) in the B-pillar.

4. The emergency tensioning retractor (File 2, item 4) should only be replaced (see: AR91.40-D-0630B) if the following conditions are met:

- Fault codes cannot be erased.
- Belt has an odor (moldy, musty).

Attachments	
File	Designation
1.jpg	New parts
2.jpg	Electrical connection of emergency tensioning retractor
3.jpg	Installation of covers

Symptoms
Body / Safety system / Airbag/Supplemental restraint system SRS / Indicator lamp / SRS indicator lamp / lit
Body / Body/Cab / Body sealing / Water entry
Body / Safety system / Seat belt / Seat belt indicator lamp / lit
Body / Safety system / Airbag/Supplemental restraint system SRS / Indicator lamp / Airbag / lit

Control unit/fault code		
Control unit	Fault code	Fault text
SRSSupplemental restraint system (ARCADE906)	9243	R12/1 (Driver ETR [GUS] squib)-Short circuit to ground
SRSSupplemental restraint system (ARIAN906)	9243	R12/1 (Driver ETR [GUS] squib)-Short circuit to ground
SRSSupplemental restraint system (ARIAN906)	9244	R12/1 (Driver ETR [GUS] squib)-Test plug connection R12/1 (Driver ETR [GUS] squib).
SRSSupplemental restraint system (ARIAN906)	9245	R12/1 (Driver ETR [GUS] squib)-Plausibility error
SRSSupplemental restraint system (ARIAN906)	9250	R12/2 (Front passenger ETR [GUS] squib)-Resistance too large
SRSSupplemental restraint system (ARIAN906)	9251	R12/2 (Front passenger ETR [GUS] squib)-Resistance too small
SRSSupplemental restraint system (ARIAN906)	9252	R12/2 (Front passenger ETR [GUS] squib)-Short circuit to positive
SRSSupplemental restraint system (ARIAN906)	9253	R12/2 (Front passenger ETR [GUS] squib)-Short circuit to ground
SRSSupplemental restraint system (ARIAN906)	9254	R12/2 (Front passenger ETR [GUS] squib)-Test plug connection R12/2 (Front passenger ETR [GUS] squib).
SRSSupplemental restraint system (ARIAN906)	9255	R12/2 (Front passenger ETR [GUS] squib)-Plausibility error
SRSSupplemental restraint system (ARCADE906)	9244	R12/1 (Driver ETR [GUS] squib)-Test plug connection R12/1 (Driver ETR [GUS] squib).
SRSSupplemental restraint system (ARCADE906)	9245	R12/1 (Driver ETR [GUS] squib)-Plausibility error
SRSSupplemental restraint system (ARCADE906)	9250	R12/2 (Front passenger ETR [GUS] squib)-Resistance too large
SRSSupplemental restraint system (ARCADE906)	9251	R12/2 (Front passenger ETR [GUS] squib)-Resistance too small
SRSSupplemental restraint system (ARCADE906)	9252	R12/2 (Front passenger ETR [GUS] squib)-Short circuit to positive
SRSSupplemental restraint system (ARCADE906)	9253	R12/2 (Front passenger ETR [GUS] squib)-Short circuit to ground
SRSSupplemental restraint system (ARCADE906)	9254	R12/2 (Front passenger ETR [GUS] squib)-Test plug connection R12/2 (Front passenger ETR [GUS] squib).
SRSSupplemental restraint system (ARCADE906)	9255	R12/2 (Front passenger ETR [GUS] squib)-Plausibility error

Parts							
Part number	ES1	ES2	Designation	Quantity	Note	EPC	Other make part
A 906 691 00 00			Cover	1	Cover (1) for left B-pillar. For vehicles with code (T19) Left load compartment sliding door.	X	
A 906 691 01 00			Cover	1	Cover (2) for right B-pillar. For vehicles with code (T16) Right load compartment sliding door.	X	

WIS-References			
Document number	Title	Note	Allocation
AR68.30-D-4700A	Remove/install trim on B-pillar		Remedy
AR91.40-D-0630B	Remove/install seat belt with emergency tensioning retractor	ONLY when the stated conditions (step 4) are met.	Remedy

Validity		
Vehicle	Engine	Transmission
Sprinter III	*	*

Attachments

1.jpg:

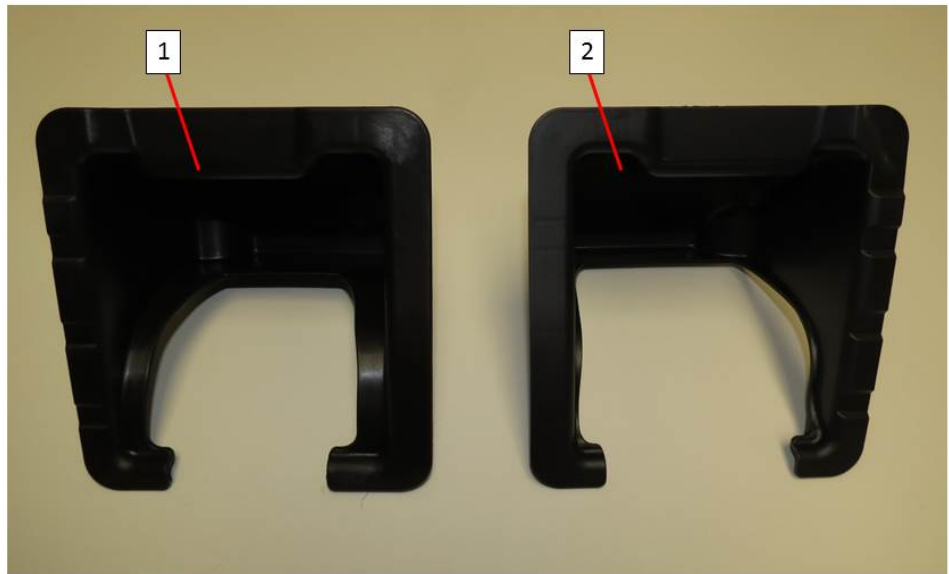

2.jpg:

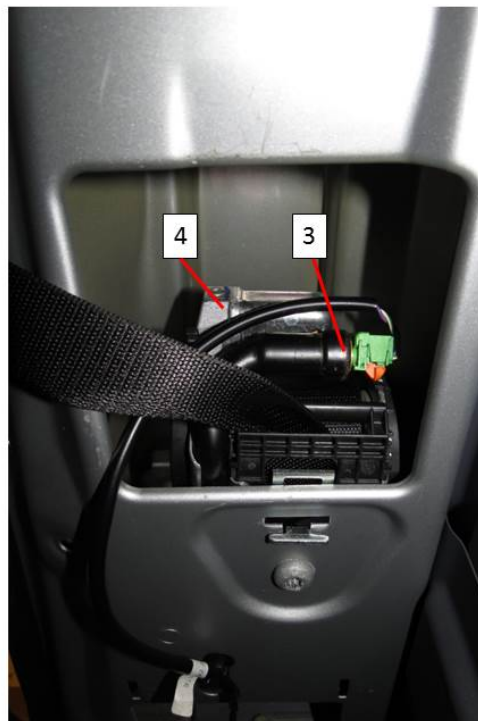

3.jpg:

