



TECH TALK

Volume 198, July, 2013

In This Issue

- Vehicle Technical Info..... page 1
- Techline Information.....page 2
- MEDIC Information.....page 2
- Tips from the Toolman..... page 2
- Training News.....page 3
- Bulletin Review..... page 4

Vehicle Technical Info

NOTE: The ✓ mark is used as a reminder, indicating an article that has been repeated from a previous issue of Tech Talk.



GROUP 00 – General

OWNER'S MANUAL LOCATION — 2014 Outlander. Some dealers are having difficulty locating the owner's manual during new vehicle inspection. The manual is placed in the upper glovebox section for vehicle shipping. Please advise those who check in new vehicles .



✓ 2014 OUTLANDER NEW MODEL QUALITY REPORTING — 2014 Outlander MMNA needs your help identifying product quality issues on the all new 2014 Outlander. Through the end of August, 2013, we request you report any quality or design issues that you identify. This includes items found during PDI,

warranty repair, customer comments made during test drives, parts questions, etc.

Please open a Techline case and/or submit a PQR to report your observations as soon as possible during this period. If you believe the issue is critical and/or safety related, open a case and contact Techline immediately.

NON-REUSABLE PARTS — All models. Parts indicated with an **N** in service manual illustrations are not reusable. They must be replaced with a new part. Typically, these parts are special fasteners, seals, gaskets and o-rings, but parts such as dowel pins, washers, shims and others also may not be reusable. Always refer to the repair procedure in the service manual to confirm if a part is reusable. The illustrations for Disassembly and Reassembly clearly identify non reusable parts. Not doing so may lead to a fluid leak or additional repairs.

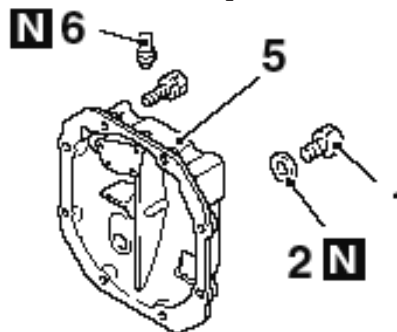

GROUP 11 – Engine

2014 OUTLANDER VALVE TRAIN NOISE — 2014 Outlander w/4J12 engine. The complex, new generation MIVEC valve train has many more moving parts, and it makes more noise as a result. Before attempting any repairs such as valve adjustment, compare the noise to similar vehicles. Adjusting the valves is an involved process and due to the the added moving parts, some additional noise is considered normal.



GROUP 15 – Exhaust

2014 OUTLANDER EXHAUST RESONANCE — 2014 Outlander w/4J12 engine. When

accelerating at light throttle, an exhaust resonance may be noticed as the engine passes through 1,400 RPM. Before beginning diagnosis, compare the noise to similar vehicles. Do not attempt diagnosis or repairs unless the noise is noticeably different than similar vehicles.



GROUP 42A – Body

2014 OUTLANDER ELECTRIC LIFTGATE DOES NOT FUNCTION — 2014 Outlander. The electric liftgate system can be turned off using the master switch located in the front of the console next to the key box. Unless this button is in the ACTIVE position (pressed in) the liftgate will not operate electrically. As recommended in TSB-13-00-014REV, place the master switch in the ACTIVE position during PDI.

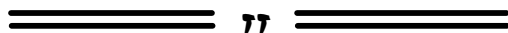
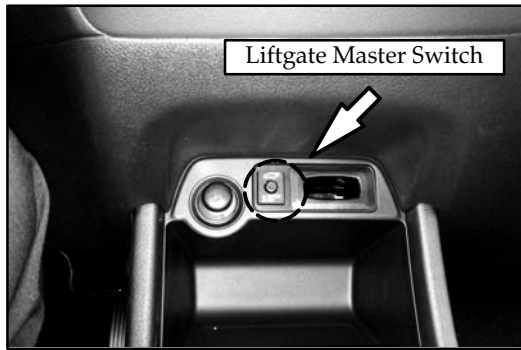

GROUP 54 – Chassis Electrical

2014 OUTLANDER REAR VIEW CAMERA DOES NOT FUNCTION — 2014 Outlander. The rear view camera will not operate (no picture) if connector(s) at the rear of the audio unit are not securely connected.

Confirm that all harness connections are securely fastened. Insert connectors with a firm push and listen for the “click.” Then gently pull on the connector to ensure it is locked in place.

Check the green connector (C-116) at the CAN module located under the audio unit and the gray connector (C-108) located at the rear of the audio unit.

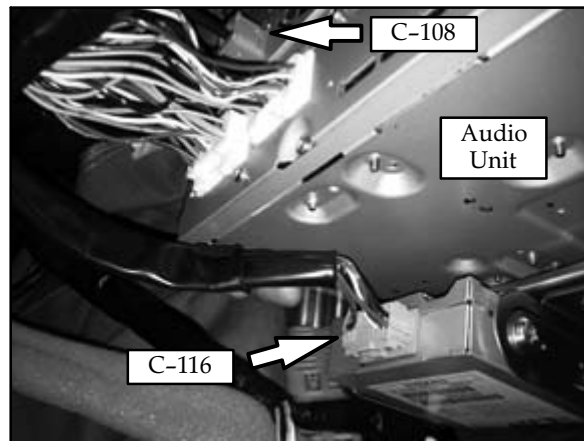

<p>Tips From the Toolman</p>	<p>NEW VALVE ADJUSTING TOOL FOR 2014 OUTLANDER MB991477</p>
-------------------------------------	--

MMNA is making available a new valve adjusting tool for the 4J1 4 cylinder engine. This tool allows you to loosen/tighten the tappet lock nut and then adjust the valve without removing the tool. A screwdriver is inserted through the tool to make the valve clearance adjustment. The tool is available from from Bosch Automotive Service Solutions (formerly SPX) 1-888-727-6672, or on the web at www.mitsubishidealersolutions.com.

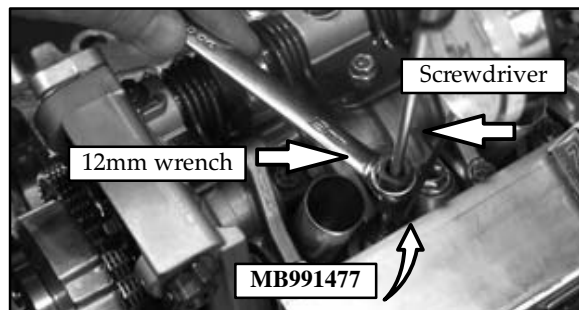
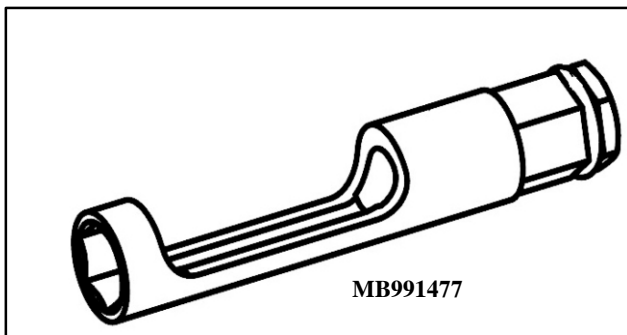

Training News

Technical Training Schedule July — August, 2013

Mobile Training does not appear on these calendars. Contact your District Parts & Service Manager for information about mobile training in your area.

East Zone - N.J. Tech Training Center

East Zone - Atlanta Tech Training Center

July				
M	T	W	Th	F
1	2	3	4	5
	141	ASCF	H	
8	9	10	11	12
	141	ASCF		
15	16	17	18	19
		MED2	MEVTT	
22	23	24	25	26
	141	ASCF	TC-SST	
29	30	31	1	2
	ES3			

August				
M	T	W	Th	F
29	30	31	1	2
	ES3			
5	6	7	8	9
	AED			
12	13	14	15	16
	MTT		TC-SST	
19	20	21	22	23
26	27	28	29	30
	141	ASCF	141	ASCF

July				
M	T	W	Th	F
1	2	3	4	5
	141	ASCF	H	
8	9	10	11	12
	141	ASCF		
15	16	17	18	19
		MED2	MEVTT	
22	23	24	25	26
	141	ASCF	TC-SST	
29	30	31	1	2
	ES3			

August				
M	T	W	Th	F
29	30	31	1	2
	ES3			
5	6	7	8	9
	AED			
12	13	14	15	16
	MTT		TC-SST	
19	20	21	22	23
26	27	28	29	30
	141	ASCF	141	ASCF

West Zone-Dallas Tech Training Center

California Technical Training Center

July				
M	T	W	Th	F
1	2	3	4	5
			H	
8	9	10	11	12
	141	ASCF	ES3	
	MTT		TC-SST	
15	16	17	18	19
	TC-SST		141	ASCF
22	23	24	25	26
	141	ASCF	141	ASCF
	TC-SST		TC-SST	
29	30	31	1	2
	MFIT2			

August				
M	T	W	Th	F
29	30	31	1	2
	MFIT2			
5	6	7	8	9
	MTT		MED2	STV3
12	13	14	15	16
	ES2		AACT1	
	CVTT		MEVTT	
19	20	21	22	23
	141	ASCF	TC-SST	
26	27	28	29	30
	141	ASCF	TC-SST	

July				
M	T	W	Th	F
1	2	3	4	5
	MEVTT		H	
8	9	10	11	12
15	16	17	18	19
	141	ASCF	TC-SST	
22	23	24	25	26
29	30	31	1	2
	141	ASCF	TC-SST	

August				
M	T	W	Th	F
29	30	31	1	2
	141	ASCF	TC-SST	
5	6	7	8	9
12	13	14	15	16
19	20	21	22	23
	141	ASCF	TC-SST	
26	27	28	29	30

Days	Code	Prerequisites	Days	Code	Prerequisites
Automatic Transaxles			Manual Transaxles		
40/50 Series Diagnosis & Repair	3	AT2T ATFT1 or ATFWE or ATFB	Manual Transaxles & Transfer Cases	3	MTT No Prerequisites
50 Series 5-speed Diagnosis & Repair	1	AT3 AT2T	Twin Clutch Sportronic Shift Transmission	2	TC-SST AESP, ES1, ES2, STV3, MED2, MED3, ATFWE, MTT
CVT Diagnosis & Repair	2	CVTT ATFT1 or ATFWE or ATFB			
Brakes			Vehicle Specific		
Antilock Brakes	2	ABS2 ES1	Eclipse Spyder Convertible Top (Top Stack)	1	SP3 No Prerequisites
Electrical Systems			2014 Outlander Technology	1	141 ES1, MED2, MED3, STV3
Electrical Systems 2	3	ES2 ES1	Mitsubishi Electric Vehicle Technician Training	2	MEVTT AESP, ES1, ES2, STV3, MED2, MED3, 120
Electrical Systems 3	2	ES3 ES1			
Engine Performance			Vehicle Diagnostics		
Advanced Emission Diagnosis	3	AED ES1, STV3, MFIT2	Advanced Electronic Service Procedures	-	AESP No Prerequisites
Engine Technology & Diagnosis	3	EN1 No Prerequisites	Advanced Safety Features	1	ASF ES1, MED2, MED3, STV3
Multipoint Fuel Injection	4	MFIT2 ES1, STV3	MEDIC II	1	MED2 No Prerequisites
Heating & A/C Systems			Scan Tool Viewer (MUT-III)	1	STV3 No Prerequisites
Manual A/C Systems	2	MACT No Prerequisites			
Automatic A/C Systems	1	AACT1 ES1			

NEWS:

- The new 2014 Outlander New Model course (course code 141) is available for enrollment on mitsubishiacademy.com. This 1-day, instructor-led course familiarizes technicians with the all new Outlander and its available technologies. It is very important that technicians attend class to understand the operational characteristics of these all new technologies and how to service and repair them. New features include the new 4J12 S4 MIVEC 2.4L engine, changes to CVT shift mapping, and other body and chassis changes.
- The 1-day Advanced Safety and Convenience Features (course code ASCF) details the new Power Liftgate, ECO Driver Support, Dual Zone Climate Control, and three advanced safety features; Forward Collision Mitigation (FCM), Lane Departure Warning (LDW), Adaptive Cruise Control (ACC). These systems feature the use of an on-board radar a camera, and a MID-based driver notification system. Enroll today as this course will fill up quickly.

Bulletin Review

The following information was recently released:

Number	Title	Vehicles	Subject
TSB-13-00-006	DRL Updates for ETACS-ECU Coding Data List-SMR	2011-13 Lancer, Lancer Sportback, Lancer Evolution, Outlander	Revises the Coding Data List Tables for Daytime Running Lights.
TSB-13-00-007	General PDI Procedures for 2014 Models (except i-MiEV)	All 2014 models	Updates previous year bulletin with new information and procedures including 2014 Outlander.
TSB-13-00-008	Technical Specifications	2014 Lancer Evolution	Provides new model tech specs.
TSB-13-00-009	Technical Specifications	2014 Lancer	Provides new model tech specs.
TSB-13-00-010	Technical Specifications	2014 Lancer Sportback	Provides new model tech specs.
TSB-13-00-011	New Model Service Information and Features - 2014 Lancer, & Lancer Sportback	2014 Lancer, & Lancer Sportback	Provides service information, features and equipment changes for 2014 models
TSB-13-00-012	New Model Service Information and Features - 2014 Lancer Evolution	2014 Lancer Evolution	Provides service information, features and equipment changes for 2014 models
TSB-13-00-013	Technical Specifications	2014 Lancer Outlander	Provides new model tech specs.
TSB-13-00-014REV	New Model Service Information and Features - 2014 Outlander	2014 Outlander	Provides service information, and features for the all new 2014 Outlander.
TSB-13-11-005	Piston Oil Ring Installation-SMR	2006 Lancer Evolution	Revises piston oil ring installation steps.
TSB-13-11-006	Timing Belt Removal and Installation-SMR	2007-14 Outlander V6	Revises Service Points of Removal/Installation of timing belt.
TSB-13-13-001REVII	ECM Reprogramming for MIL Illumination - Mis-detection of DTC P0300 -Second Revision	2011-13 Outlander, Lancer, Lancer Sportback, Outlander Sport	Revises TSB-13-13-001REV with additional affected vehicles and updates MUT-III Standalone software information.
TSB-13-13-002REVII	ECM Reprogramming for MIL Illumination - Mis-detection of DTC P0145 -Second Revision	2010 Outlander, 2011 Lancer, Lancer Sportback, Outlander Sport	Revises TSB-13-13-002REV with additional affected vehicles and updates MUT-III Standalone software information.
TSB-13-13-005REV	ECM Reprogramming for False MIL (DTC P2100) or Hard to Start with Engine Cold	2012-12 Outlander	Revises TSB-13-13-005 with to update MUT-III Standalone software information.
TSB-13-33-001	Front Stabilizer Bar Removal and Installation - SMR	2007-13 Outlander, 2008-13 Lancer, 2009-13 Lancer Sportback, 2011-13 Outlander Sport	Revises front stabilizer bar removal and installation procedure.
TSB-13-52A-003	DTC B1558: OCM (Occupant Classification-ECU) DTC Present-SMR	2011-13 Outlander Sport	Revises diagnostic procedure for DTC B1558



© Copyright 2013 Mitsubishi Motors North America, Inc.

The information contained in this bulletin is subject to change. For the latest version of this document, go to the Mitsubishi Dealer Link, MEDIC, or the Mitsubishi Service Information website (www.mitsubishitechinfo.com).