



# Technical Service Bulletin

SUBJECT: <b>SECURING THE OVERHEAD CONSOLE</b>		No: <b>TSB-12-52A-004</b>
		DATE: <b>December, 2012</b>
		MODEL: <b>2013 Outlander Sport/RVR</b>
CIRCULATE TO:	<input type="checkbox"/> GENERAL MANAGER	<input checked="" type="checkbox"/> PARTS MANAGER
<input checked="" type="checkbox"/> SERVICE ADVISOR	<input checked="" type="checkbox"/> SERVICE MANAGER	<input checked="" type="checkbox"/> TECHNICIAN
	<input checked="" type="checkbox"/> WARRANTY PROCESSOR	<input type="checkbox"/> SALES MANAGER

## PURPOSE

The overhead console assembly with sunshade illumination dimmer switch on certain vehicles equipped with a panoramic roof may not fit securely to the headliner bracket. This TSB provides a procedure to repair this condition.

## AFFECTED VEHICLES

2013 Outlander Sport/RVR built prior to 10/8/2012 and VIN DE006573

## PROCEDURE

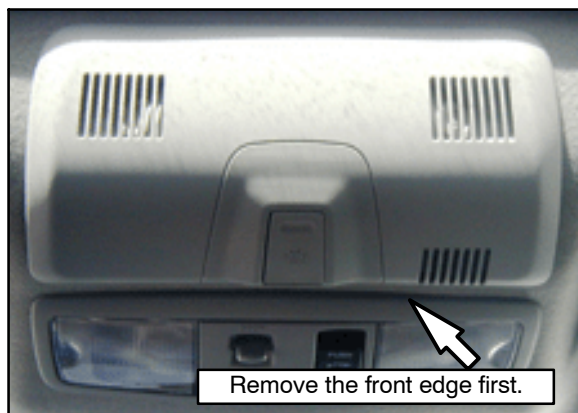

1. Grab the front edge of the overhead console with your fingers and pull rearward and down to remove it. It should come out easily.

### **!! IMPORTANT!!**

Remove the front of the assembly, then the rear.

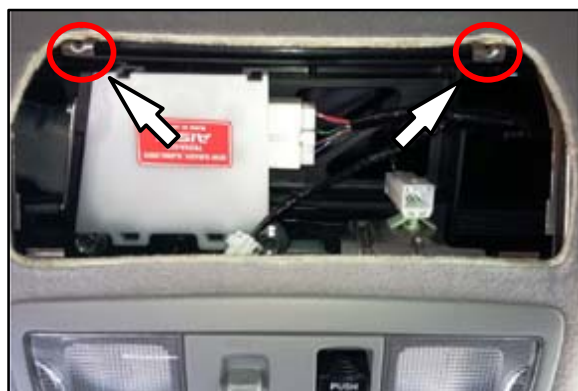

2. Check if the two tabs (circled) on the bracket are fitted with felt pads (see illustration for location).

If felt pads are present, skip to step 4.

Continued

Copyright 2012, Mitsubishi Motors North America, Inc.

(3935)

The information contained in this bulletin is subject to change. For the latest version of this document, go to the Mitsubishi Dealer Link, MEDIC, or the Mitsubishi Service Information website ([www.mitsubishitechinfo.com](http://www.mitsubishitechinfo.com)).

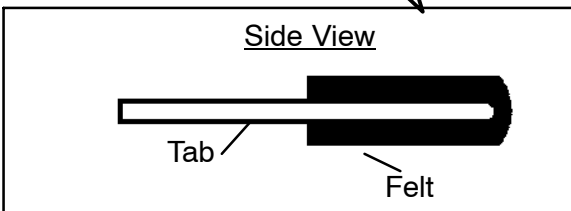
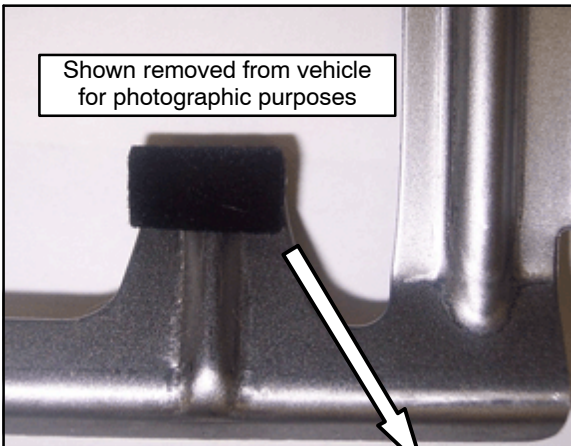

3. If felt pads are not present, cut two squares (10mm x 10 mm ) of 2mm thick self adhesive felt from BSR kit MB991752. Apply one piece of felt to each bracket tab.

Wrap the felt over the end of the tab as illustrated.

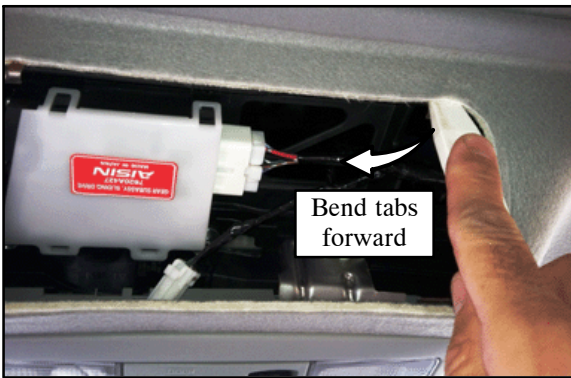

4. Using a plastic trim stick (or other tool that will not damage the headliner) carefully bend both bracket tabs slightly forward.

Take care the felt pads do not become dislodged during this adjustment

5. Reinstall the overhead console assembly to confirm a secure fit.

Secure the rear edge of the panel first, then the front.

6. Check for secure installation.
7. If the overhead console assembly is still not properly secured, remove the panel and repeat steps #4 through # 6 until the assembly fits securely.

**NOTE:** This procedure may not restore the console to a perfect fit on some vehicles. An uneven gap may remain.

## PARTS INFORMATION

Use only the Genuine Mitsubishi Parts listed below.



MB991752: Service Kit – Noise Suppression

**One kit will be automatically shipped to each dealer with stock orders beginning November 13, 2012.**

Cut one 10mm x 10mm square of 2mm thick non-woven felt per vehicle.

## WARRANTY INFORMATION

This bulletin is supplied as technical information only and is not an authorization to repair. If an affected vehicle is reported with the described condition, diagnose the condition, repair as described in this bulletin and submit a normal warranty claim using the following information.

### 2013 Outlander Sport – Secure Overhead Console

*Nature Code:* 86D

*Cause Code:* 430

*Labor Operation No.:* 523410 90

*Time Allowance:* 0.3 hr.

<i>Parts:</i>	<u>Part No.</u>	<u>Qty.</u>	<u>Cost Allowance</u>
	FELTKIT	1	\$3.60

*Warranty Coverage:* Basic Coverage. Refer to the *Superscreen* for basic coverage terms applicable to each vehicle.