

SportDesign Front Apron (2D4)

Information: **Retrofitting**

Model Year: **As of 2018**

Additional step: **Can be installed only for vehicles from week 14/18**

Note:



Figure 1

The SportDesign front apron comprises an independent SportDesign front and rear apron painted in exterior color as well as sculpted wheel arch extensions and side skirts.

The Porsche logo and part numbers are only visible when parts are removed.



Information

The scope of parts can vary in the different complete packages and can therefore differ from the lists of parts shown here. Dispose of parts that are not needed.



Information

Some of the repair illustrations show only one side of the vehicle. Naturally, some steps also have to be performed on the opposite side of the vehicle as well. These must be carried out as a mirror image of the steps shown.



Information

The number of electric plug connections and clips will vary depending on equipment.

Parts list:

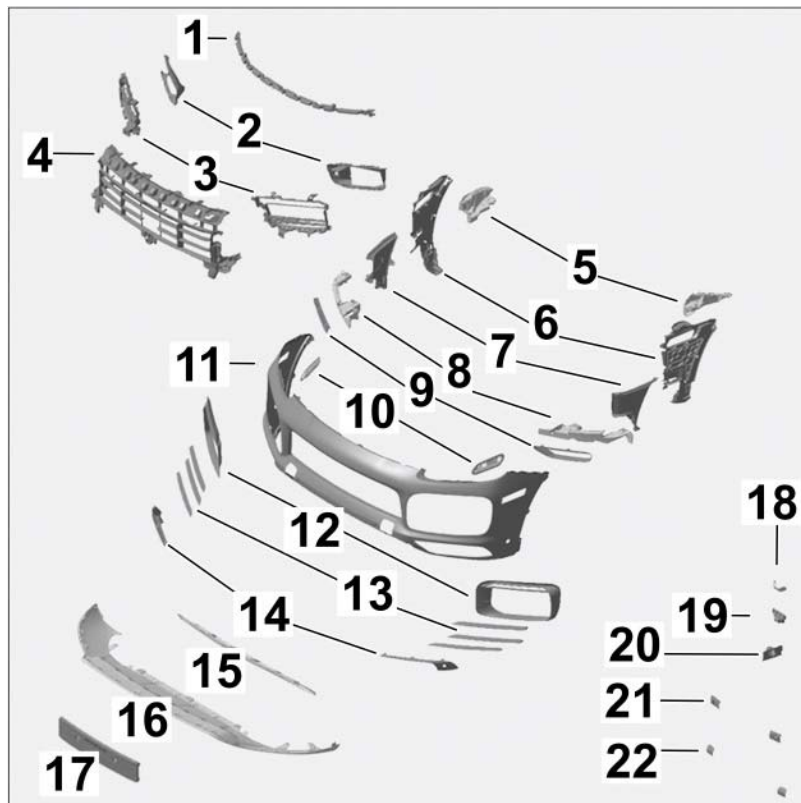

Figure 2

Package Order No.		Vehicle version
9Y0.044.850	1 x	SportDesign front apron, RoW
9Y0.044.860	1 x	SportDesign front apron, RoW + PLA Porsche Steering Assist (7X5)
9Y0.044.861	1 x	SportDesign front apron, USA
9Y0.044.862	1 x	SportDesign front apron, USA + PLA Porsche Steering Assist (7X5)

Important: The following parts **must** also be ordered, depending on **country** and **vehicle variant**.

Night vision system holder

		Vehicle version
9Y0.980.562	1 x	With Night vision system

Supplementary set

		Vehicle version
9Y0.044.858.B	1 x	With ACC
9Y0.044.858.A	1 x	Without ACC

Number plate holder ⇒

Figure 2-17-

		Country version
9Y0.807.287.K	1 x	Number plate holder, ECE
9Y0.807.287.L	1 x	Number plate holder, NAR
9Y0.807.287.M	1 x	Number plate holder, China
9Y0.807.287.N	1 x	Number plate holder, Japan
9Y0.807.287.P	1 x	Number plate holder, RoW
9Y0.807.287.S	1 x	Number plate holder, China - PHEV

Scope of air guides ⇒ Figure 5-1 and 2-

			Engine variant
9Y0.117.335.D	1 x	Front left air guide for charge-air cooler	V6 petrol engine LK3 TV8
9Y0.117.336.D	1 x	Front right air guide for charge-air cooler	
9Y0.117.335.E	1 x	Front left air guide for charge-air cooler	V8 petrol engine T1M
9Y0.117.336.E	1 x	Front right air guide for charge-air cooler	
9Y0.117.335.F	1 x	Front left air guide for charge-air cooler	R4 petrol engine TW6, V6 petrol engine LK2 T9I
9Y0.117.336.F	1 x	Front right air guide for charge-air cooler	

Scope of sound absorber for bumper ⇒ Figure 5-3-

			Country version
9Y0.807.550.B	1 x	Sound absorber for bumper	For RoW
9Y0.807.550.E	1 x	Sound absorber for bumper	For NAR
9Y0.807.550.K	1 x	Sound absorber for bumper	For Korea

Important: The following parts are **included** in the package and do **not** have to be ordered. **The following parts lists are provided for overview purposes only! Part numbers can vary depending on country and package.**

Scope of front apron		
9Y0.807.665.D	1 x	Foam part, SDP ⇒ <i>Figure 2-1-</i>
9Y0.807.161.D/162.D	2 x	Side air guides, left and right, basic ⇒ <i>Figure 2-2-</i>
9Y0.807.161.E	1 x	Side air guides, left, basic Nivi ⇒ <i>Figure 2-2-</i>
9Y0.807.681.C/682.C	2 x	Side grille, left and right, SDP, basic ⇒ <i>Figure 2-3-</i>
9Y0.807.683.M	1 x	Center grille, SDP (included in air guide package) ⇒ <i>Figure 2-4-</i>
9Y0.807.683.N	1 x	Center grille, SDP, ACC (included in air guide package) ⇒ <i>Figure 2-4-</i>
9Y0.807.049.B/050.B	2 x	Side guide section, left and right, carry-over part ⇒ <i>Figure 2-5-</i>
9Y0.807.177.B/178.B	2 x	Side guides, left and right ⇒ <i>Figure 2-6-</i>
9Y0.807.957.B/958.B	2 x	Side cooling-air guide, left and right ⇒ <i>Figure 2-7-</i>
9Y0.807.571.B/572.B	2 x	Lower guide element, left and right, carry-over part ⇒ <i>Figure 2-8-</i>
9Y0.807.675.B/676.B	2 x	Side grille, lower left and right, SDP ⇒ <i>Figure 2-9-</i>
9Y0.807.677.A/678.A	2 x	Position light holder, USA ⇒ <i>Figure 2-10-</i>
9Y0.807.221.B	1 x	Front apron, ready-primed ⇒ <i>Figure 2-11-</i>
9Y0.807.795.B/796.B	2 x	Side cover, left and right ⇒ <i>Figure 2-12-</i>
9Y0.807.685.C/686.C	2 x	Upper vane, left and right ⇒ <i>Figure 2-13-</i>
9Y0.807.877.C/878.C	2 x	Center vane, left and right, SDP ⇒ <i>Figure 2-13-</i>
9Y0.807.973.C/974.C	2 x	Lower vane, left and right, SDP ⇒ <i>Figure 2-13-</i>
9Y0.807.823/824	2 x	Airblade trim, left and right ⇒ <i>Figure 2-14-</i>
9Y0.807.684	1 x	Center grille, lower, carry-over part ⇒ <i>Figure 2-15-</i>
9Y0.807.061.B	1 x	Front spoiler for bumper, lower ⇒ <i>Figure 2-16-</i>
9Y0.807.644.A	1 x	RTV cover ⇒ <i>Figure 2-18-</i>
9Y0.807.997.B	1 x	RTV holder ⇒ <i>Figure 2-19-</i>
9Y0.807.115.B/116.B	2 x	Outer PLA holder, left and right (already installed and bonded) ⇒ <i>Figure 2-20-</i>
9Y0.807.131.B/132.B	2 x	PDC holder, center (already installed and bonded) ⇒ <i>Figure 2-21-</i>
9Y0.807.129.B/130.B	2 x	PDC holder, left and right, outer (already installed and bonded) ⇒ <i>Figure 2-21-</i>
9Y0.807.155.B/156.B	2 x	Towing lug cover, ready-primed ⇒ <i>Figure 2-22-</i>

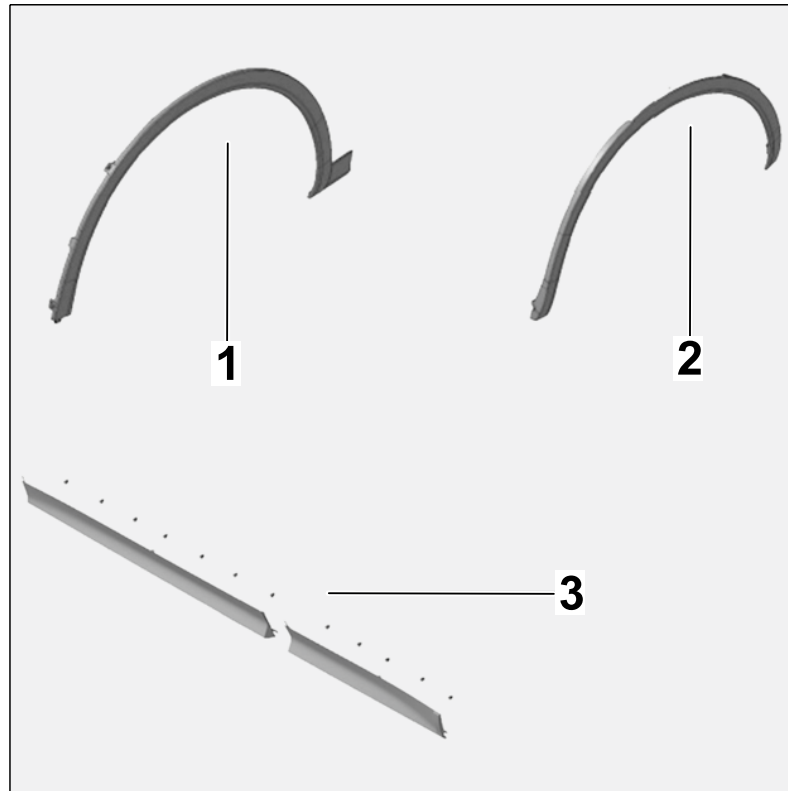

Figure 3

Scope of wheel arch trims/door trim panels

9Y0 853 717 L G2X	1 x	Wheel cover, front left ⇒ <i>Figure 3-1-</i>
9Y0 853 718 L G2X	1 x	Wheel cover, front right ⇒ <i>Figure 3-1-</i>
9Y0 853 731 K G2X	1 x	Wheel cover, rear left ⇒ <i>Figure 3-2-</i>
9Y0 853 732 K G2X	1 x	Wheel cover, rear right ⇒ <i>Figure 3-2-</i>
9Y0 837 341 AY G2X	1 x	Set of door trim panels, left ⇒ <i>Figure 3-3-</i>
9Y0 837 342 AY G2X	1 x	Set of door trim panels, right ⇒ <i>Figure 3-3-</i>

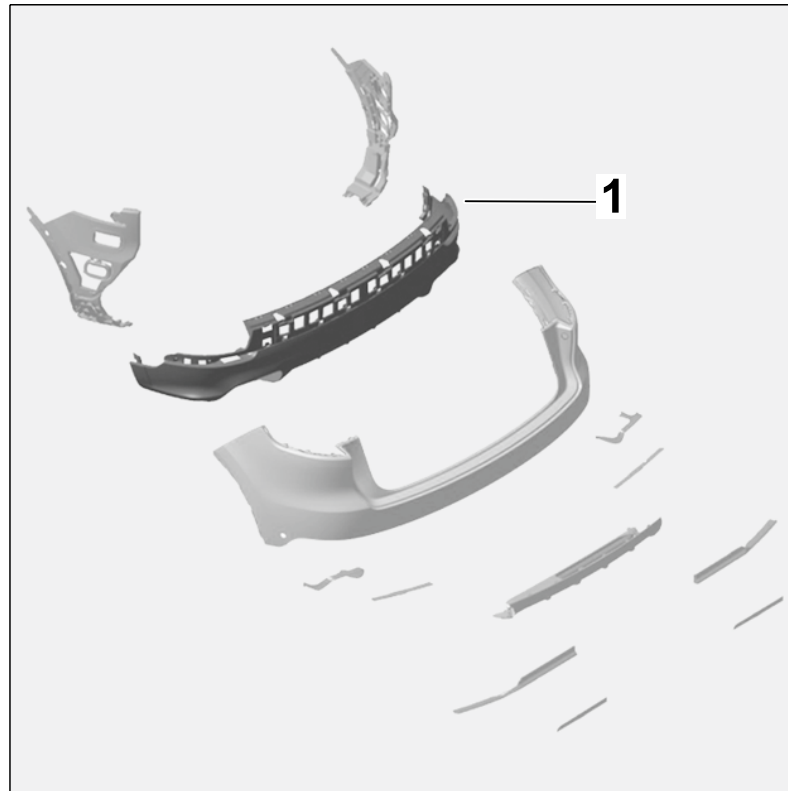

Figure 4

Scope of rear apron

9Y0.807.110.A

1 x

Spoiler for rear apron ⇒ Figure 4-1-

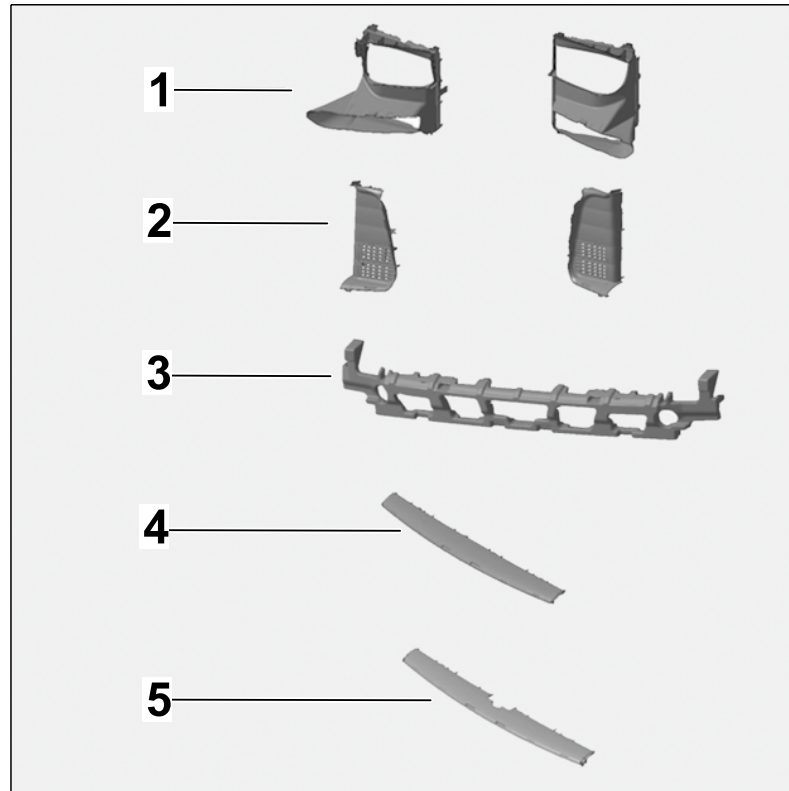

Figure 5

Scope of air guides ⇒ Figure 5-1 and 2-

			Engine variant
9Y0.117.335.D	1 x	Front left air guide for charge-air cooler	V6 petrol engine LK3 TV8
9Y0.117.336.D	1 x	Front right air guide for charge-air cooler	
9Y0.117.335.E	1 x	Front left air guide for charge-air cooler	V8 petrol engine T1M
9Y0.117.336.E	1 x	Front right air guide for charge-air cooler	
9Y0.117.335.F	1 x	Front left air guide for charge-air cooler	R4 petrol engine TW6, V6 petrol engine LK2 T9I
9Y0.117.336.F	1 x	Front right air guide for charge-air cooler	

Scope of sound absorber for bumper ⇒ Figure 5-3-

			Country version
9Y0.807.550.B	1 x	Sound absorber on bumper	For RoW
9Y0.807.550.E	1 x	Sound absorber on bumper	For NAR

9Y0.807.550.K	1 x	Sound absorber on bumper	For Korea
---------------	-----	--------------------------	-----------

Scope of center air guides**Equipment variant**

9Y0.121.710.B	1 x	Center air guide ⇒ <i>Figure 5-4-</i>	Without ACC
9Y0.121.710.E	1 x	Center air guide ⇒ <i>Figure 5-5-</i>	With ACC
9Y0.807.683.M	1 x	Center grille, SDP ⇒ <i>Figure 2-4-</i>	Without ACC
9Y0.807.683.N	1 x	Center grille, SDP, ACC ⇒ <i>Figure 2-4-</i>	With ACC

Work
procedure:

**Painting components**

- Risk of warping of components
 - Risk of damage to components
- ⇒ Observe the guidelines and instructions for painting components in the "Paint" Workshop Manual.
- ⇒ Always place parts without tension on the painting devices provided during painting and drying processes.

- 1 Raise the vehicle. ⇒ *Workshop Manual 'Lifting the vehicle'*
- 2 Connect battery charger. ⇒ *Workshop Manual 'Charging vehicle electrical system battery'*

3 Paint work/Installing front apron

Paint all ready-primed parts to match the vehicle's color code in accordance with instructions in the Paint Workshop Manual. Paint the following parts in vehicle color:

Front apron, front spoiler on bumper, outer PLA holder (if Porsche Steering Assist (PLA) is installed)

- 3.1 Disassemble and assemble front apron ⇒ *Figure 2*.
 - 3.1.1 Replace side guides ⇒ *Figure 2-6-*. Carry out this step in conjunction with Step 3.1.2.
 - 3.1.2 Replace front apron ⇒ *Workshop Manual 'Replacing front apron (basic)'*. After removing the standard front apron, replace air guides for radiator and charge-air cooler (see 3.1.2 and 3.1.3).
 - 3.1.3 Replace air guide for radiator with the supplied radiator guides ⇒ *Workshop Manual 'Removing and installing front air guide'*. Also replace sound absorber on bumper with the supplied new sound absorber ⇒ *Figure 5-3-* and side air guides ⇒ *Figure 5-2-*.

- 3.1.4 Replace air guides for charge-air cooler with the supplied air guides ⇒ *Workshop Manual 'Removing and installing front air guide at the side (ahead of charge-air cooler)'*.

4 Paint work/Installing wheel covers

Paint all ready-primed parts to match the vehicle's color code in accordance with instructions in the Paint Workshop Manual. Paint the following parts in vehicle color:

Wheel covers, door trim panels

- 4.1 Remove and install door trim panels and wheel arch trims ⇒ *Figure 3*.
- 4.1.1 Replace door trim panels at the front ⇒ *Workshop Manual 'Removing and installing trim for front door'* and rear ⇒ *Workshop Manual 'Removing and installing trim for rear door'*.
- 4.1.2 Replace wheel covers at the front ⇒ *Workshop Manual 'Removing and installing front wheel cover'* and rear ⇒ *Workshop Manual 'Removing and installing rear wheel cover'*.

5 Paint work/Installing rear skirt

Paint all ready-primed parts to match the vehicle's color code in accordance with instructions in the Paint Workshop Manual. Paint the following parts in vehicle color:

PDC spoiler/rear skirt

- 5.1 Remove and install PDC spoiler/rear skirt ⇒ *Figure 4-1-*.
- 5.1.1 Remove and install rear apron ⇒ *Workshop Manual 'Removing and installing rear apron'*.
- 5.1.2 Remove and install PDC spoiler/rear skirt ⇒ *Workshop Manual 'Removing and installing rear skirt'*.
- 5.1.3 For vehicles with Lane Change Assist (I-no. 7Y1, 7Y2, 7Y3, 7Y4), continue with Step 6.1.4.
- 5.1.4 Calibrate Lane Change Assist ⇒ *Workshop Manual 'Calibrating Lane Change Assist'*.

NOTICE

Voltage drop

- Risk of irreparable damage to control unit
- Risk of damage to control unit
- Fault entries in the control unit
- Coding in the control unit is aborted
- Malfunctions in control unit, even during programming

- ⇒ Before disconnecting the control unit, switch off ignition and remove ignition key.
- ⇒ Make sure that the power supply is not interrupted during programming.
- ⇒ Connect battery charger/power supply - Suitable for AGM Type batteries, recommended current rating of 90A fixed voltage 13.5V to 14.5V.

6 Code SportDesign package.

- 6.1 **9900 - PIWIS Tester 3** must be connected and ignition switched on.
- 6.2 Select "Diagnostics". **9900 - PIWIS Tester 3** detects the model line.
Press Next. PIWIS Tester III Diagnostics starts.
- 6.3 Update vehicle data.
 - 6.3.1 **Additional menu** must be selected by pressing **•F7"** . Press **•F11"** to confirm the question "Create vehicle analysis log (VAL)?".
 - 6.3.2 Select the **Maintenance of vehicle data** function. Press **•F12"** until PR numbers appears in the Value group column.
 - 6.3.3 Select **Trim CD value** in the Family column. When you touch the cell behind Trim CD value, the drop-down menu opens.

Select the value **2D4 - Sport Design package (AEROKIT) Basic.**
Press **•F12"** to change values.
 - 6.3.4 The selected values appear. Press **•F8"** to write values. Wait until the following message appears: **Generation of vehicle data is complete. Press**

Press **•F11"** to switch to the control unit overview.
- 6.4 Adapt coding.
 - 6.4.1 Select all control units by pressing **•Ctrl A"** . Press **•F12"** to continue.
 - 6.4.2 Switch to the **Coding/programming** menu. Press **•F12"** to continue.

Select **Automatic coding** mode. Press **•F12"** to continue.
 - 6.4.3 Wait until the following message appears: **Coding was completed successfully.**
Press **•F12"** to continue.

Press **•F12"** to return to the **Overview** menu.
- 6.5 Switch off ignition and disconnect **9900 - PIWIS Tester 3.**
- 6.6 Disconnect battery charger.

- 66992310: Installing SportDesign package, complete Labor time: **613 TU**
Includes: Replacing front apron, replacing rear skirt.
Replacing door trim panels, replacing wheel arch trims.
Replacing air guides, replacing sound absorber on bumper.
Without: Calibrating Lane Change Assist.
- 66996172: Painting new parts in SportDesign package, complete Labor time: **411 TU**
Includes: Painting new parts, Step 1:
Front apron, towing lug cover, front spoiler on bumper, PLA holder, towing lug, PDC spoiler, PLA holder, wheel covers, wheel arch trims, door trim panels
Preparing body for painting

Important Notice: Technical Bulletins issued by Porsche Cars North America, Inc. are intended only for use by professional automotive technicians who have attended Porsche service training courses. They are written to inform those technicians of conditions that may occur on some Porsche vehicles, or to provide information that could assist in the proper servicing of a vehicle. Porsche special tools may be necessary in order to perform certain operations identified in these bulletins. Use of tools and procedures other than those Porsche recommends in these bulletins may be detrimental to the safe operation of your vehicle, and may endanger the people working on it. Properly trained Porsche technicians have the equipment, tools, safety instructions, and know-how to do the job properly and safely. Part numbers listed in these bulletins are for reference only. The work procedures updated electronically in the Porsche PIWIS diagnostic and testing device take precedence and, in the event of a discrepancy, the work procedures in the PIWIS Tester are the ones that must be followed.

© 2020 Porsche Cars North America, Inc.