



# Technical Service Bulletin

SUBJECT:			No: <b>TSB-13-11-004</b>
<b>TIMING CHAIN UPPER GUIDE ELIMINATED – SERVICE MANUAL REVISION</b>			DATE: <b>April, 2013</b>
			MODEL: <b>See Below</b>
CIRCULATE TO:	<input type="checkbox"/> GENERAL MANAGER	<input checked="" type="checkbox"/> PARTS MANAGER	<input checked="" type="checkbox"/> TECHNICIAN
<input checked="" type="checkbox"/> SERVICE ADVISOR	<input checked="" type="checkbox"/> SERVICE MANAGER	<input type="checkbox"/> WARRANTY PROCESSOR	<input type="checkbox"/> SALES MANAGER

## PURPOSE

The timing chain upper guide was eliminated from certain vehicles beginning October 1, 2009 with 4B11 (Non-turbo or Turbo-charged) and 4B12 engines. This TSB provides updated service manual information.

**NOTE:** This change affects service parts for 4B1 series engines (2008–10 model years). Replacement engine blocks will not have attachment holes for these parts.

## AFFECTED VEHICLES

2010 Lancer built from October, 2009  
 2010 Lancer Sportback built from October, 2009  
 2010 Lancer Evolution built from October, 2009  
 2010 Outlander with 2.4L engine built from October, 2009

## AFFECTED SERVICE MANUALS

2010 Lancer Service Manual – Engine:

Group 11A Engine Mechanical [2.0L Engine Non-turbo] > Timing Chain > Removal and Installation

Group 11C Engine Mechanical [2.0L Engine Turbo] > Timing Chain > Removal and Installation

Group 11E Engine Mechanical [2.4L Engine] > Timing Chain > Removal and Installation

2010 Lancer Sportback Service Manual – Engine:

Group 11A Engine Mechanical [2.0L Engine] > Timing Chain > Removal and Installation

Group 11C Engine Mechanical [2.4L Engine] > Timing Chain > Removal and Installation

2010 Lancer Evolution Service Manual – Engine:

Group 11A Engine Mechanical > Timing Chain > Removal and Installation

2010 Outlander Service Manual – Engine:

Group 11A Engine Mechanical [2.4L Engine] > Timing Chain > Removal and Installation

Continued

Copyright 2013, Mitsubishi Motors North America, Inc.

(3990)

The information contained in this bulletin is subject to change. For the latest version of this document, go to the Mitsubishi Dealer Link, MEDIC, or the Mitsubishi Service Information website ([www.mitsubishitechinfo.com](http://www.mitsubishitechinfo.com)).

Replace the timing chain Removal and Installation procedure with the following information:

## REMOVAL AND INSTALLATION

Apply engine oil to all moving parts before installation.

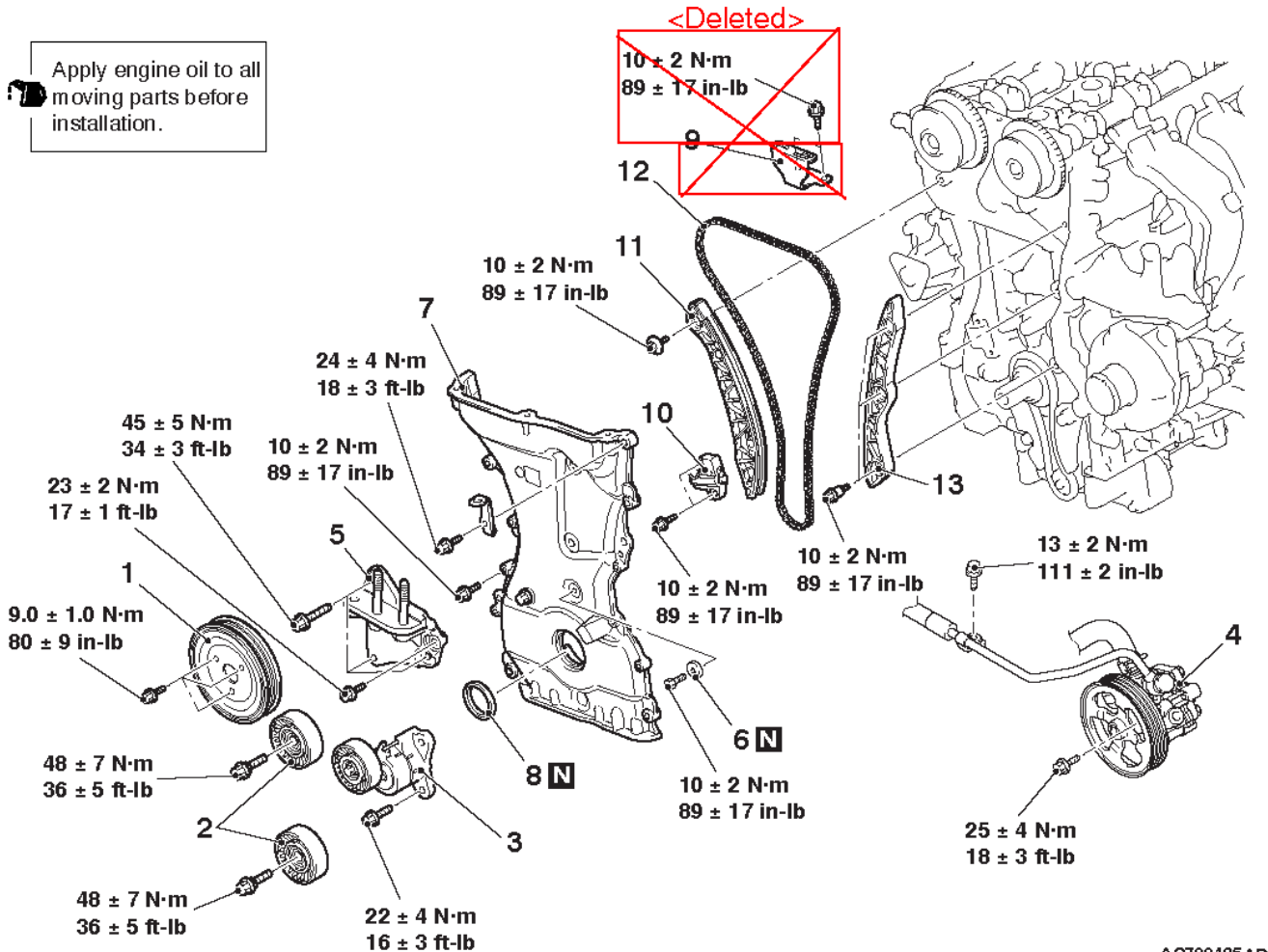

AC700425AD

- <<A>>
- Removal steps
  - Crankshaft pulley (Refer to
- >>E<<
1. Water pump pulley
  2. Idler pulley
  3. Auto-tensioner
- <<B>>
4. Power steering oil pump assembly
- <<C>>
- Engine and transaxle assembly holding
  - Engine mounting insulator (Refer to GROUP 32, Engine Mounting)

- <<D>>
5. Cylinder block engine front mounting bracket
  6. Gasket
  7. Timing chain case assembly
  8. Crankshaft front oil seal
- <<E>>
- <Deleted>
9. Timing chain upper guide
  10. Timing chain tensioner
  11. Timing chain tension side guide
  12. Timing chain
  13. Timing chain loose side guide