



**Bulletin Type.....:** C

**Bulletin No.....:** TS-C105

**Bulletin Name.....:** Relocating Transmission Oil Dipstick

**Bulletin Ref.No.....:** 700002595

**NHTSA.....:**

**Release Date.....:** 15.08.2016

**Expiry Date.....:** 15.08.2017

**Vehicle Model.....:** TS 35

**Flat Rate Code.....:**TSC105

**Flat Rate Time.....:**30 min.

**Summary:** Relocating Transmission Oil Dipstick

**Subject:** For ease of access to oil dipstick, the rod has been re-routed.

**Bulletin Responsible.....:**Teoman PEHLİVAN

**Published by & Approved by...:** Hakan GÜNERDEM

## Welding on the Chassis

- Always disconnect the batteries (starting with the negative lead).
- Disconnect the connectors of electrical and electronic equipment (electronic control units, sensors and actuators) if they are less than 20 inches away from the chassis part to be welded or the earth terminal of the welding equipment.
- The earth terminal should never be attached to vehicle components such as engine, axles and springs. Arcing on these parts is not permitted, because of the risk of damage to bearings, springs, etc.
- The earth terminal must make good contact and be placed as close as possible to the part to be welded.
- Plastic pipes, rubber parts and parabolic springs should be well protected against welding spatter and temperatures higher than 70°.
- The contact switch must not be in the accessory or contact position. The contact key should be removed.
- Reconnect in reversed order of disconnecting. Ensure that a good earth connection is made between chassis, engine and cab.



# SERVICE BULLETIN

Service bulletin expiry dates differ according to service bulletin type.

## Definitions

**Release Date:** As of this date the bulletin is released and available on E-Doc. Modification parts can be ordered. The time period between the release date and the effective date may vary according to the procurement lead time.

**Effective Date:** As of this date specified amount of the total modification parts will be available on Spare Parts Stock. Modification parts can be ordered and the application can be performed. ( except non-compliance and safety related campaigns, i.e. S-Type Bulletin)

**Part Order Deadline:** Last order date for modification parts. The part orders which will be placed after this date should be approved by Regional Coordinator.

**Expiry Date:** Expiration date for the application.

## Bulletin Types

- **S-Type:** Application period of this bulletin is 18 months after the date of issue. S type bulletin is used for Recall Campaigns.

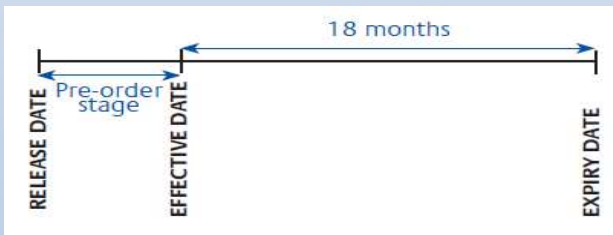

- **U-Type:** Application period of this bulletin is 12 months after the date of issue. U type bulletin is used for updates that need to be performed upon customer complaints.

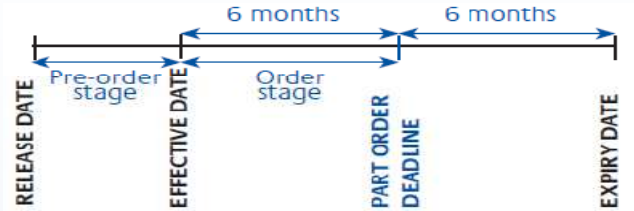

- **C-Type:** Application period of this bulletin is 12 months after the date of issue. C type bulletin is generally used for supplying technical instructions or other type of information to service network.

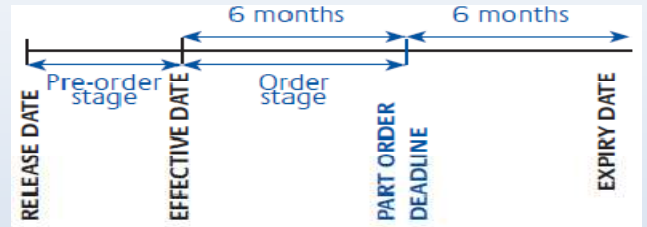

- **M-Type:** Application period of this bulletin is 12 months after the date of issue. M type bulletin is used for updates that should be implemented without waiting for customer complaints.

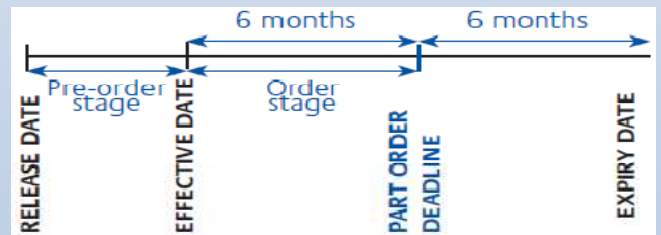

## PART LIST

### Insatalled Part List

No	Part No	Part Name	Qty
1	RP196120Y	TRANSMISSION OIL FILL PIPE	1
2	RP171154Y	DIPSTICK AND OIL FILLER CAP	1
3	TF104969Y	BOLT (M16x2x25-8.8)	1
4	MF450409Y	WASHER, (B 16)	1
5	MF100025Y	BOLT (M6x12)	2
6	RP109140Y	L- BRACKET for PIPE HOLDER	1
7	RP109139Y	BRACKET	1
8	MF434103Y	NUT (M6)	2
9	MH020816Y	CLAMP (25)	2

### Excluded Part List

No	Part No	Part Name	Qty
1		TRANSMISSION FILLING ROD	

# SERVICE BULLETIN

## 1. Mechanical Requested Dress Code



## 2. Before Start of Work

Always wear protective clothing. Do not wear any damaged or loose-fitting clothing and remove jewelry before starting the work. In case of long hair use hairnet. The illustration below shows some of the correct or incorrect clothing that should be worn during work.

Sharp edges should be avoided e.g. belts, watches, necklaces to prevent scratching the vehicle.



## 3. Protect Seats When Mechanics Start Working



1. Seats, trimming, upholstery stuff and carpeting should be protected with appropriate coverings.

# SERVICE BULLETIN

## TECHNICAL INSTRUCTIONS

1.The oil level rod on the gearbox must be removed by loosening it from its clamp.

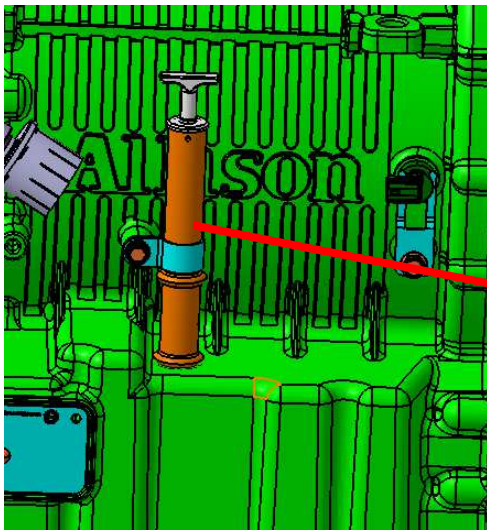
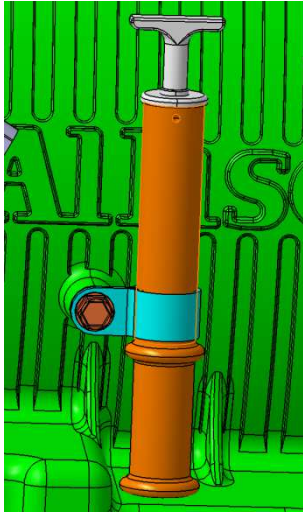

The oil level rod on the gearbox must be removed by loosening it from its clamp.

# SERVICE BULLETIN

2. First , in the place of the removed level rod, level rod pipe must be mounted. (RP196120Y)

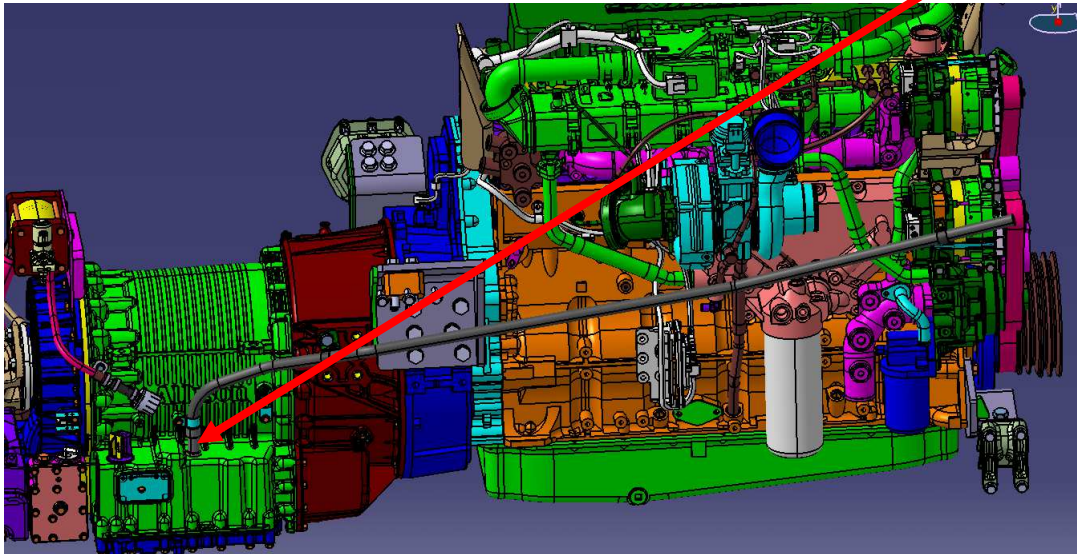

3. Then, the clamps must be fixed to the connection points on the engine and the clamp should be installed on the alternator by the RP109140 and RP109139 bracket.

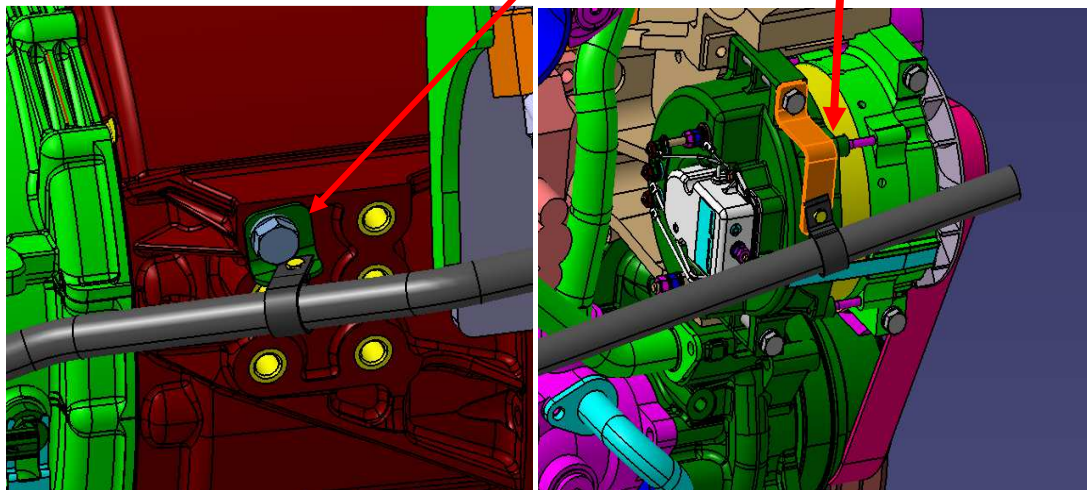



# SERVICE BULLETIN

4. The level rod is placed inside the pipe.

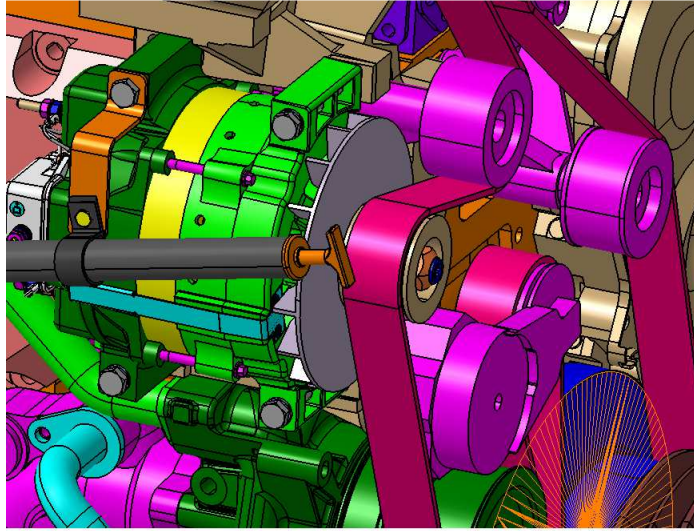

## RATE BREAK DOWN

Application	Time
Removing the oil level rod	5min
Mounting the oil level rod pipe	25min
<b>Total</b>	<b>30min</b>