



Technical Journal

TITLE:
ECM-P04F000, Evap System, High Pressure Purge Line

| | | | |
|--|---|--|-----------------------------------|
| REF NO: TJ 34857.6.0 | ISSUING DEPARTMENT: Technical Service | CAR MARKET: United States and Canada | |
| PARTNER: 3 US 7510 Volvo Car USA | | ISSUE DATE: 2021-01-28 | STATUS DATE: 2021-01-28 |
| FUNC GROUP: 2340 | FUNC DESC: Fuel tank, fuel lines, evaporator system | Page 1 of 6 | |
| | | | |

“Right first time in Time”

Attachment

| File Name | File Size |
|--------------------------------------|-----------|
| TJ 34857 Canister filter (1) (1).png | 0.1022 MB |
| TJ 34857 Evap purge line (1) (1).png | 0.3313 MB |
| TJ 34857 Visuel inspection (1).jpg | 0.0280 MB |

Rows beginning with * are modified

Note! If using a printed copy of this Technical Journal, first check for the latest online version.

DESCRIPTION:

* This TJ is rewritten in its entirety

If check engine light is on and ECM-P04F000 is set, please follow advise under “service”.

CSC Customer Symptom Codes

| Code | Description |
|------|---|
| DL | Warning lights and chimes/Malfunction Indicator Light ("Check engine" light) indication/no indication |

DTC Diagnostic Trouble Codes

| Control Module | Code | Fault Type |
|----------------|---------|--------------|
| ECM | P04F000 | Intermittent |



Vehicle Type

| Type | Eng | Eng Desc | Sales | Body | Gear | Steer | Model Year | Plant | Chassis range | Struc Week Range |
|------|-----|-----------|-------|------|------|-------|------------|-------|-----------------|------------------|
| 224 | 10 | B4204T23 | | | | | 2019-2020 | 70 | 0000448-0050171 | 201835-201948 |
| 224 | A2 | B4204T27 | | | | | 2019-2020 | 70 | 0000448-0050171 | 201835-201948 |
| 224 | BR | B1FPHEV | | | | | 2019-2020 | 70 | 0000448-0050171 | 201850-201948 |
| 225 | 10 | B4204T23 | | | | | 2019-2020 | 21 | 0000315-0370409 | 201817-201948 |
| 225 | 10 | B4204T23 | | | | | 2019-2020 | 22 | 0013852-0371761 | 201838-201948 |
| 225 | A2 | B4204T27 | | | | | 2019-2020 | 21 | 0000315-0370409 | 201817-201948 |
| 225 | A2 | B4204T27 | | | | | 2019-2020 | 22 | 0013852-0371761 | 201838-201948 |
| 225 | BM | B1EPHEV | | | | | 2019-2020 | 21 | 0000315-0370409 | 201850-201948 |
| 225 | BM | B1EPHEV | | | | | 2019-2020 | 22 | 0013852-0371761 | 201850-201948 |
| 225 | BR | B1FPHEV | | | | | 2019-2020 | 21 | 0000315-0370409 | 201850-201948 |
| 225 | BR | B1FPHEV | | | | | 2019-2020 | 22 | 0013852-0371761 | 201850-201948 |
| 227 | 10 | B4204T23 | | | | | 2019-2020 | 21 | 0000079-0040906 | 201846-201948 |
| 235 | 10 | B4204T23 | | | | | 2018-2020 | 21 | 0035046-0134375 | 201717-201948 |
| 235 | A2 | B4204T27 | | | | | 2018-2020 | 21 | 0035046-0134375 | 201717-201948 |
| 235 | BM | B1EPHEV | | | | | 2019-2020 | 21 | 0084075-0134375 | 201817-201948 |
| 235 | BR | B1FPHEV | | | | | 2019-2020 | 21 | 0035046-0134375 | 201817-201948 |
| 236 | 08 | B4204T20 | | | | | 2018-2020 | 21 | 0035046-0109482 | 201717-201948 |
| 236 | 10 | B4204T23 | | | | | 2018-2020 | 21 | 0013020-0109482 | 201717-201948 |
| 236 | A2 | B4204T27 | | | | | 2018-2020 | 21 | 0013020-0109482 | 201717-201948 |
| 238 | 10 | B4204T23 | | | | | 2018-2020 | 35 | 0000161-0164440 | 201717-201948 |
| 238 | 98 | B4204T23X | | | | | 2018-2018 | 35 | 0000161-0078016 | 201717-201948 |
| 238 | 99 | B4204T27X | | | | | 2018-2018 | 35 | 0000161-0078016 | 201717-201948 |
| 238 | A2 | B4204T27 | | | | | 2018-2020 | 35 | 0000161-0164440 | 201746-201948 |
| 238 | BC | B1BPHEV | | | | | 2018-2018 | 35 | 0000161-0078016 | 201726-201948 |
| 238 | BM | B1EPHEV | | | | | 2019-2020 | 35 | 0078017-0164440 | 201846-201948 |
| 238 | BR | B1FPHEV | | | | | 2018-2020 | 35 | 0000161-0164440 | 201746-201948 |
| 246 | 08 | B4204T20 | | | | | 2018-2020 | 21 | 0000389-0520438 | 201717-201948 |
| 246 | 08 | B4204T20 | | | | | 2019-2020 | 36 | 0176078-0523129 | 201817-201948 |
| 246 | 10 | B4204T23 | | | | | 2018-2020 | 21 | 0000389-0520438 | 201717-201948 |
| 246 | 10 | B4204T23 | | | | | 2019-2020 | 36 | 0176078-0523129 | 201817-201948 |
| 246 | A2 | B4204T27 | | | | | 2018-2020 | 21 | 0000389-0520438 | 201717-201948 |
| 246 | A2 | B4204T27 | | | | | 2019-2020 | 36 | 0176078-0523129 | 201817-201948 |
| 246 | BM | B1EPHEV | | | | | 2019-2020 | 21 | 0176061-0520438 | 201817-201948 |
| 246 | BM | B1EPHEV | | | | | 2019-2020 | 36 | 0176078-0523129 | 201817-201948 |
| 246 | BR | B1FPHEV | | | | | 2018-2020 | 21 | 0000389-0520438 | 201717-201948 |
| 246 | BR | B1FPHEV | | | | | 2019-2020 | 36 | 0176078-0523129 | 201817-201948 |
| 256 | 08 | B4204T20 | | | | | 2018-2020 | 21 | 0190072-0583304 | 201717-201948 |
| 256 | 10 | B4204T23 | | | | | 2018-2020 | 21 | 0190072-0583304 | 201717-201948 |
| 256 | A2 | B4204T27 | | | | | 2018-2020 | 21 | 0190072-0583304 | 201717-201948 |
| 256 | A3 | B4204T29 | | | | | 2018-2020 | 21 | 0344889-0583304 | 201746-201948 |



| Type | Eng | Eng Desc | Sales | Body | Gear | Steer | Model Year | Plant | Chassis range | Struc Week Range |
|------|-----|----------|-------|------|------|-------|------------|-------|-----------------|------------------|
| 256 | BM | B1EPHEV | | | | | 2019-2020 | 21 | 0415651-0583304 | 201817-201948 |
| 256 | BR | B1FPHEV | | | | | 2018-2020 | 21 | 0190072-0583304 | 201717-201948 |

SERVICE:

When you have the fault code ECM-P04F000 and the vehicle is in the vehicle type list follow these steps:

Perform a visual inspection of the EVAP system. (see attached picture).

1. Perform a visual inspection of all hoses so they are not damaged.
2. Perform a visual inspection of all connection to all components, that they are correctly assembled.
3. Make sure that you have the latest version(Part number) of the evap pipe on the vehicle according to VIDA.
4. Check that you have a canister filter and that the filter is properly mounted.
5. Perform a leak detection according to Information / Cleaning, Inspection and Adjustment / 230 general / Evaporation system emissions, leak detection.

Test run criteria

To make sure the DTC is triggered, drive the vehicle with varied driving and parts with heavy load for 10 minutes.

Note! Do NOT use the diagnostic sequence “Quicktest EVAP purge valve” to verify this DTC. To verify this DTC, drive the vehicle on the road and do a full throttle acceleration several times to trigger the DTC again.

Warranty claim info:

To get warranty claim accepted for a job described in this TJ, please use following data:
VST OP Number:98731-2 & 36001-2.

VST Operation Number

| VST Operation Number | Description |
|----------------------|--|
| 36001-2 | Diagnostic trouble codes read / reset / known Diagnostic trouble codes with VIDA |
| 98731-2 | Evap valve replace acc, to TJ34857 |

VEHICLE REPORT:

Yes, please submit a Vehicle Report if the service solution described in this TJ has no effect. Use concern area “Vehicle Report” and sub concern area “Support needed”, use function group 2340.

To view TJ attachments continue to next page. This TJ has three attachments.

TJ 34857

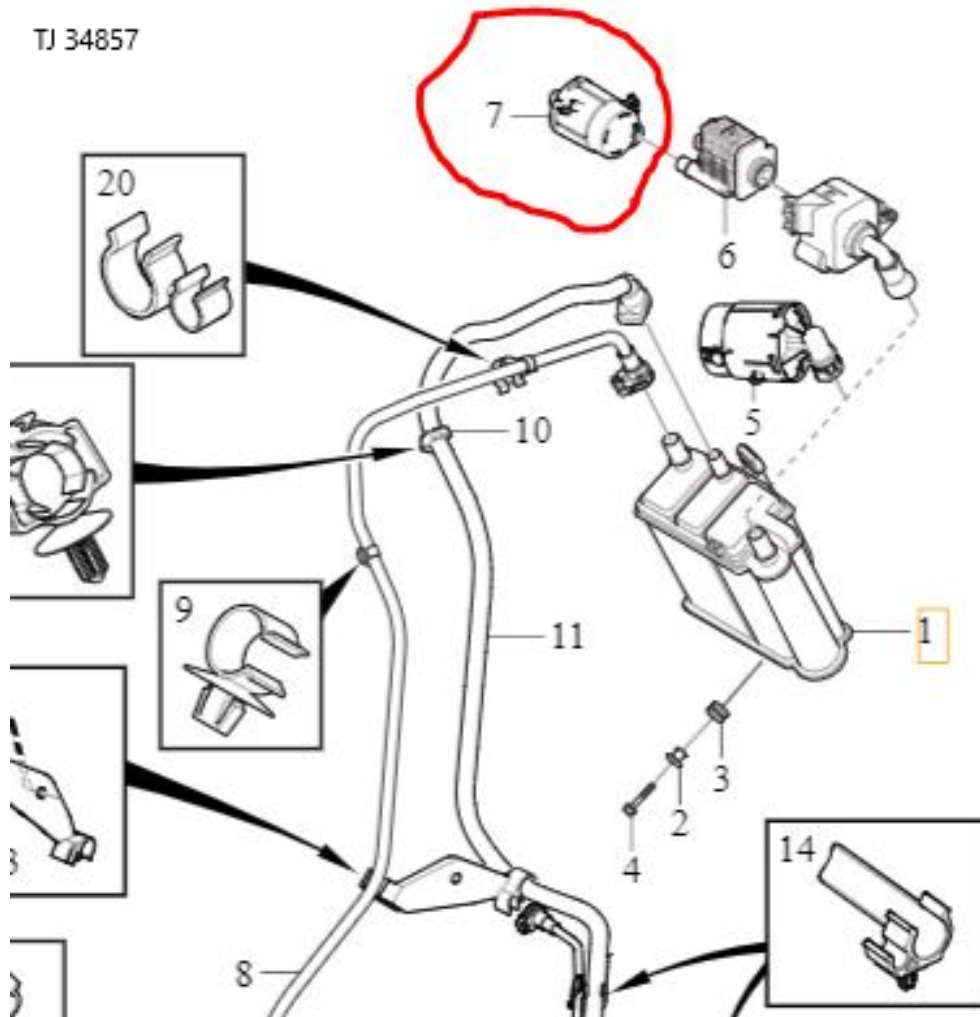



TJ 34857

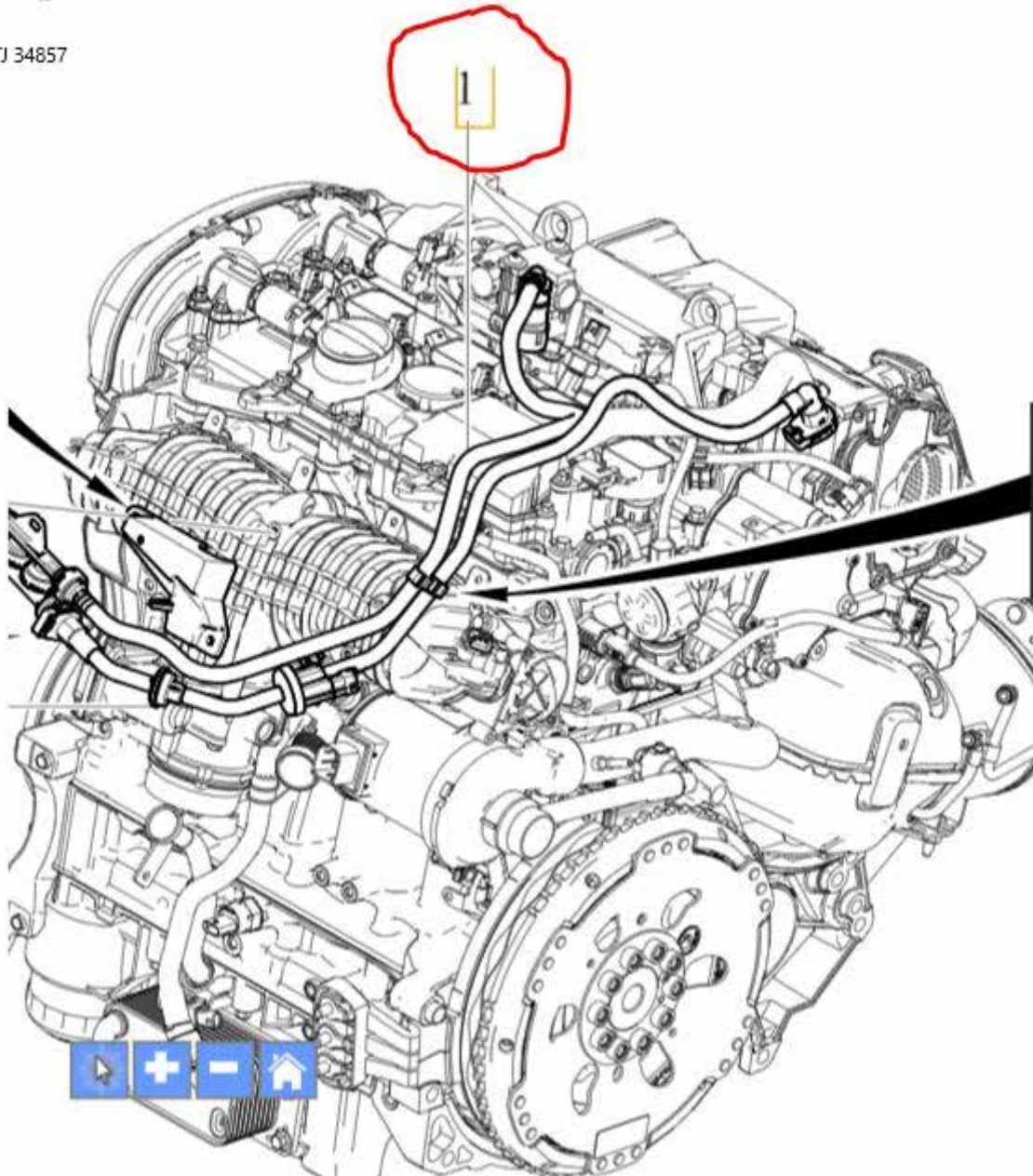

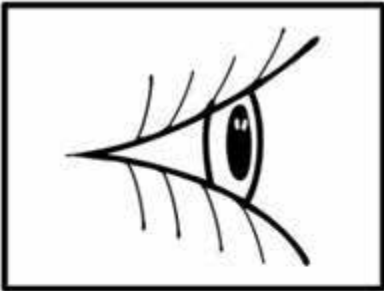

TJ 34857

