

JLRTB02068NAS1
TECHNICAL BULLETIN
 19 APR 2021



© Jaguar Land Rover North America, LLC

NOTE: The information in Technical Bulletins is intended for use by trained, professional Technicians with the knowledge, tools, and equipment required to do the job properly and safely. It informs these Technicians of conditions that may occur on some vehicles, or provides information that could assist in proper vehicle service. The procedures should not be performed by 'do-it-yourselfers'. If you are not a Retailer, do not assume that a condition described affects your vehicle. Contact an authorized Land Rover service facility to determine whether this bulletin applies to a specific vehicle.

INFORMATION

SECTION:

303-13

SUBJECT/CONCERN:

Malfunction Indicator Lamp (MIL) Illuminated on the Instrument Panel Cluster (IPC)

AFFECTED VEHICLE RANGE:

MODEL:	MODEL YEAR:	VIN:	ASSEMBLY PLANT:	APPLICABILITY:
Range Rover (LG)	2013-2018	100000-399999	Solihull	INGENIUM I4 2.0L Petrol - PHEV/V6 S/C 3.0L Petrol /V8 N/A 5.0L Petrol/V8 S/C 5.0L Petrol
Range Rover (LG)	2018-2020	500000-599999	Solihull	INGENIUM I4 2.0L Petrol - PHEV/INGENIUM I6 3.0L Petrol/V8 S/C 5.0L Petrol
Range Rover (LG)	2020	499999-414799	Solihull	INGENIUM I4 2.0L Petrol - PHEV/INGENIUM I6 3.0L Petrol/V8 S/C 5.0L Petrol

MODEL:	MODEL YEAR:	VIN:	ASSEMBLY PLANT:	APPLICABILITY:
Range Rover Sport (LW)	2014-2019	300000-699999	Solihull	INGENIUM I4 2.0L Petrol - High Power/INGENIUM I4 2.0L Petrol - PHEV/INGENIUM I6 3.0L Petrol/V6 S/C 3.0L Petrol /V8 S/C 5.0L Petrol
Range Rover Sport (LW)	2016-2018	100000-199999	Solihull	INGENIUM I4 2.0L Petrol - High Power/INGENIUM I4 2.0L Petrol - PHEV/INGENIUM I6 3.0L Petrol/V6 S/C 3.0L Petrol /V8 S/C 5.0L Petrol
Range Rover Sport (LW)	2018-2020	800000-899999	Solihull	INGENIUM I4 2.0L Petrol - High Power/INGENIUM I4 2.0L Petrol - PHEV/INGENIUM I6 3.0L Petrol/V6 S/C 3.0L Petrol /V8 S/C 5.0L Petrol
Range Rover Sport (LW)	2020	700000-748505	Solihull	INGENIUM I4 2.0L Petrol - High Power/INGENIUM I4 2.0L Petrol - PHEV/INGENIUM I6 3.0L Petrol/V8 S/C 5.0L Petrol
Discovery (LR)	2017-2019	000532-096625	Solihull	INGENIUM I4 2.0L Petrol - High Power/V6 S/C 3.0L Petrol
Discovery (LR)	2019-2020	400085-443228	Nitra (Slovakia)	INGENIUM I4 2.0L Petrol - High Power/V6 S/C 3.0L Petrol

MARKETS:**NORTH AMERICA****CONDITION SUMMARY:****SITUATION:**

The Malfunction Indicator Lamp (MIL) is illuminated on the Instrument Panel Cluster (IPC), with the following Diagnostic Trouble Code(s) (DTC)s may be stored in the Powertrain Control Module (PCM):

- P2402-00
- P2404-00
- P2405-00

- P2406-00

- P2407-00

CAUSE:

Contaminant ingress through the dust filter.

ACTION:

Follow the instructions below.

PARTS:

PART NUMBER	DESCRIPTION	QUANTITY
WTR500030	Diagnostic Module Tank Leakage (DMTL) pump	1
LR155089	DMTL pump dust filter cover	1

WARRANTY:**NOTES:**

- Repair procedures are under constant review, and therefore times are subject to change; those quoted here must be taken as guidance only. Use TOPIx to obtain the latest repair time.
- The JLR claims submission system requires the use of causal part numbers. Labor only claims must show the causal part number with a quantity of zero.

DESCRIPTION	SRO	TIME (HOURS)	CONDITION CODE	CAUSAL PART
Range Rover and Discovery - Renew DMTL pump and install cover	99.01.40	0.5	AK	WTR500030
Range Rover Sport - Renew DMTL pump and install cover	99.01.40	0.8	AK	WTR500030

NOTE:

Normal Warranty procedures apply.

SERVICE INSTRUCTION:

1.

NOTE:

The rear wheel arch liner may also be known as the rear fender splash shield in TOPIx.

Remove the rear wheel arch liner (see TOPIx Workshop Manual section 501-08: Exterior Trim and Ornamentation - Removal and Installation - Rear Wheel Arch Liner

2.

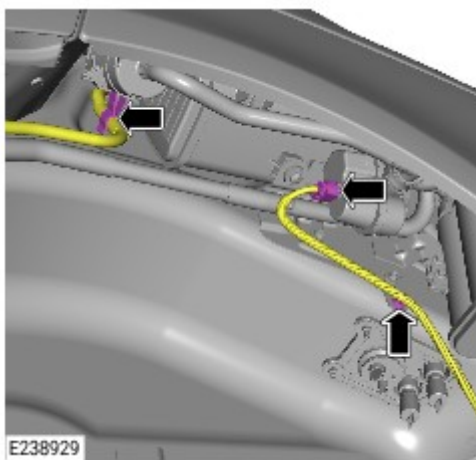

Disconnect the electrical connector and release the wiring harness.

- Release the vacuum hose from the Diagnostic Module Tank Leakage (DMTL) filter.

3.

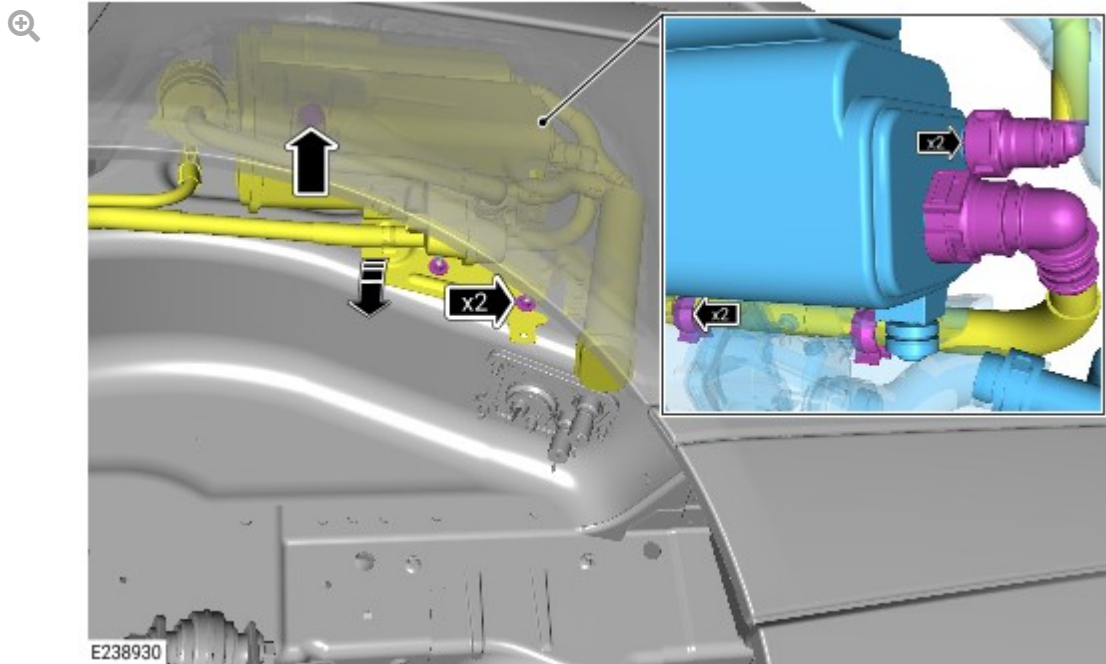

Remove the evaporative emissions canister assembly.

- Remove the bolt.
 - Torque: **9 Nm**
- Remove the 2 nuts.
 - Torque: **9 Nm**
- Release the evaporative emission canister.
- Disconnect and release the vacuum hoses.

4.

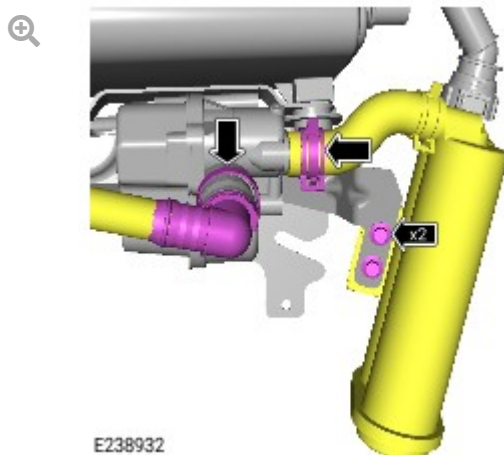

Release the vacuum 2 hoses from the DMTL pump.

- If installed, remove the 2 bolts.

5.

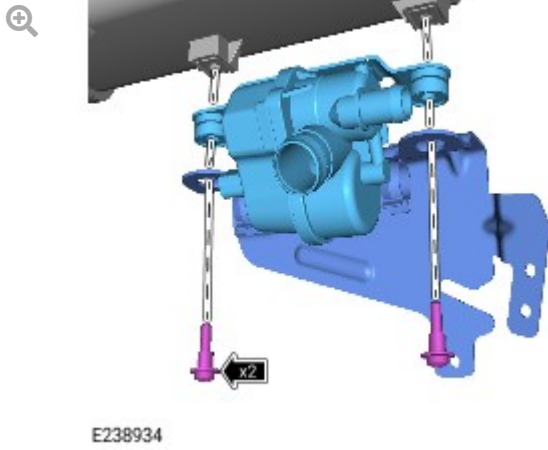

Remove the DMTL pump and evaporative emission canister bracket.

- Remove the 2 bolts.

6.



Remove and discard the DMTL pump.

- Remove the 3 screws.

7.

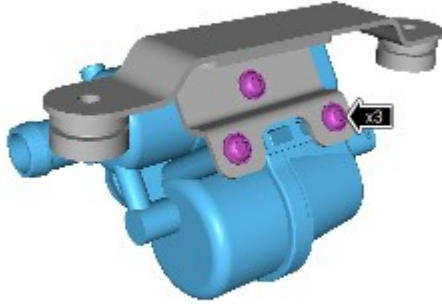

E238935

Install the new DMTL pump to the bracket.

- Install the 3 screws.
 - Torque: **1.8 Nm**

8.

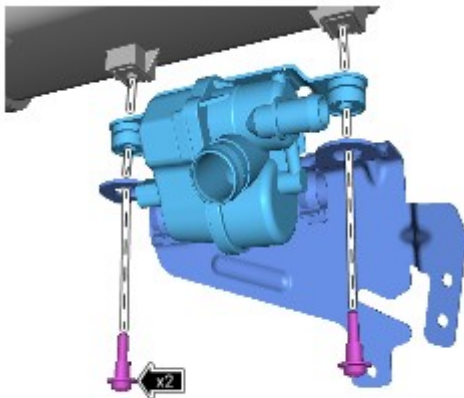

E238934

Install the DMTL pump and evaporative emission canister bracket to the evaporative emission canister assembly.

- Install the 2 bolts.
 - Torque: **4.5 Nm**

9.

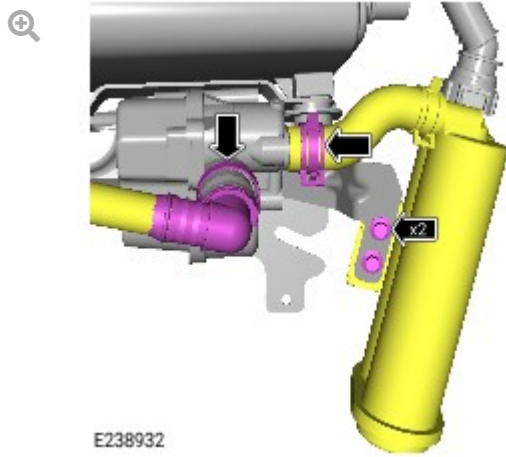

Install the vacuum 2 hoses to the DMTL pump.

- If installed, install the 2 bolts.
- Torque: **4.5 Nm**

10.

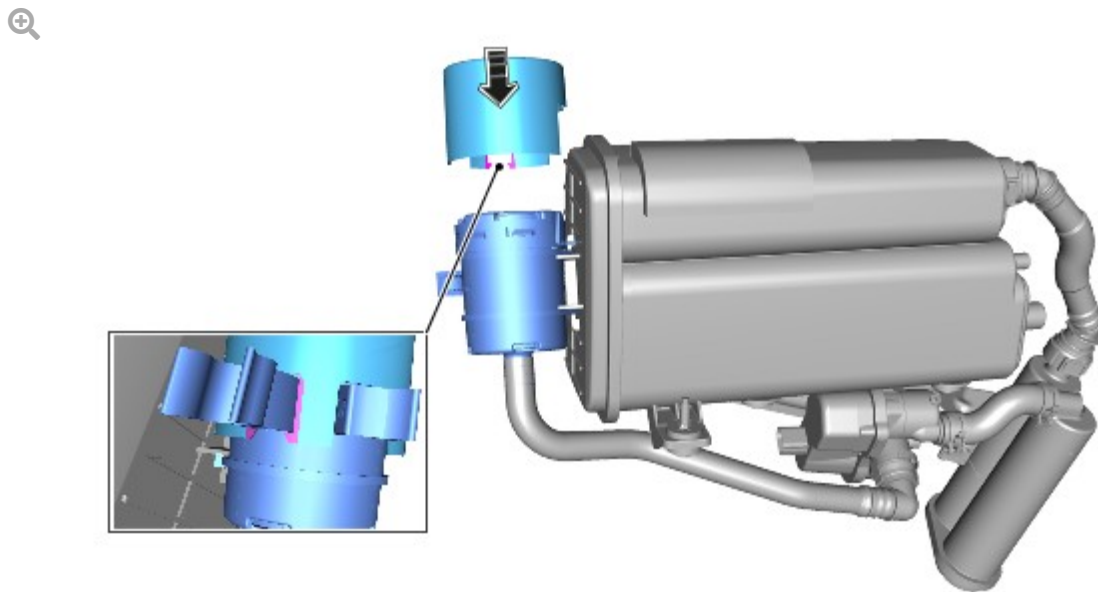

Install the DMTL pump dust filter cover.

- Make sure the DMTL dust filter cover clip is secured, as shown in the illustration.

11. To install the evaporative emission canister assembly, reverse steps 1 to 3.