

Classification:

Reference:

 COPYRIGHT © NISSAN NORTH AMERICA, INC.  
 Date:

EM14-007

ITB14-041

August 20, 2014

## 2014 QX80; OIL LEAKING FROM VVEL LADDER ASSEMBLY

**APPLIED VEHICLE:** 2014 QX80 (Z62)

### IF YOU CONFIRM:

Oil is leaking from bank 1 and/or bank 2 at any point between the VVEL ladder assembly and the related cylinder head at sealing surface shown in Figure 1.

**NOTE:** Figure 1 does not show the entire sealing surface that can be affected and is only an example of where a leak may be found.

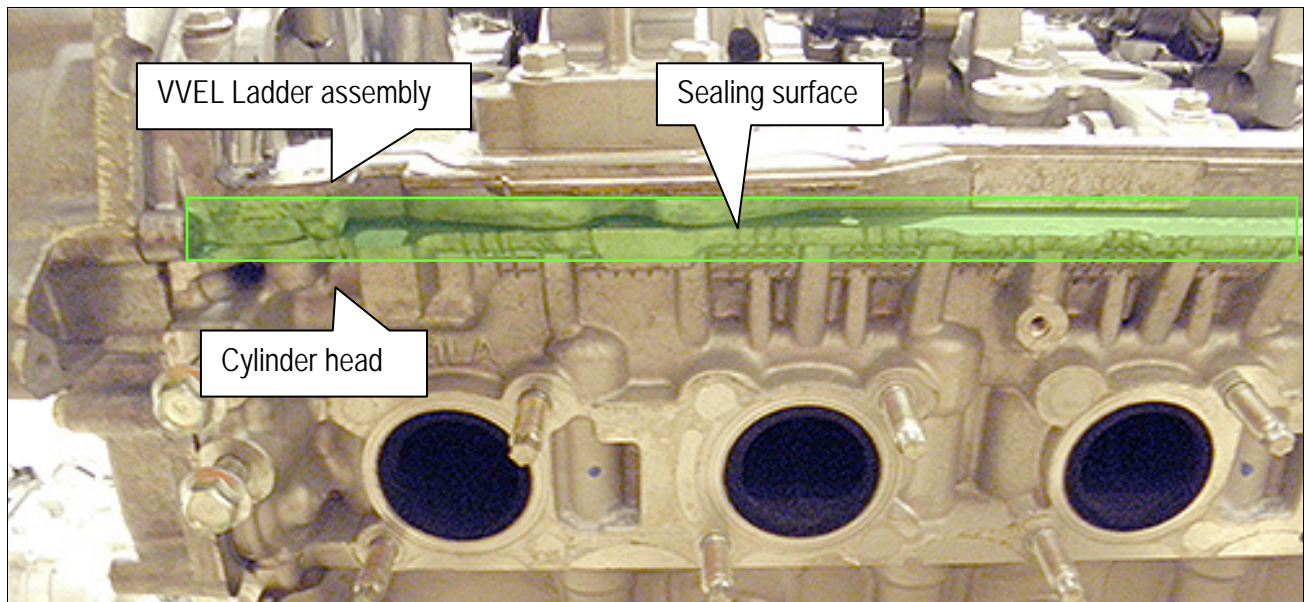

Figure 1

### ACTION:

Remove the affected VVEL ladder assembly and reseal it.

**IMPORTANT:** See Cautions on page 2 before starting to reseal VVEL ladder assemblies.

**NOTE:** Refer to the Electronic Service Manual (ESM) section, **EM – Engine Mechanical / CAMSHAFT / Removal and Installation** for the procedure to remove the VVEL ladder assembly and reseal it.

Infiniti Bulletins are intended for use by qualified technicians, not 'do-it-yourselfers'. Qualified technicians are properly trained individuals who have the equipment, tools, safety instruction, and know-how to do a job properly and safely. **NOTE:** If you believe that a described condition may apply to a particular vehicle, **DO NOT** assume that it does. See your Infiniti dealer to determine if this applies to your vehicle.

**CAUTION:**

- Never loosen the adjusting bolts (A), mounting bolts (black color) (B) of VVEL ladder assembly, or the mounting bolts (C) of the VVEL control shaft position sensor. If loosened, the stroke of the cam lift will be out of adjustment. In such a case, the replacement of the VVEL ladder assembly and the cylinder head assembly is required.
- Never loosen the mounting bolts (C) of the VVEL control shaft position sensor. VVEL control shaft position sensor mounting bolts are required to be loosened for adjustment only when using a new VVEL ladder assembly.

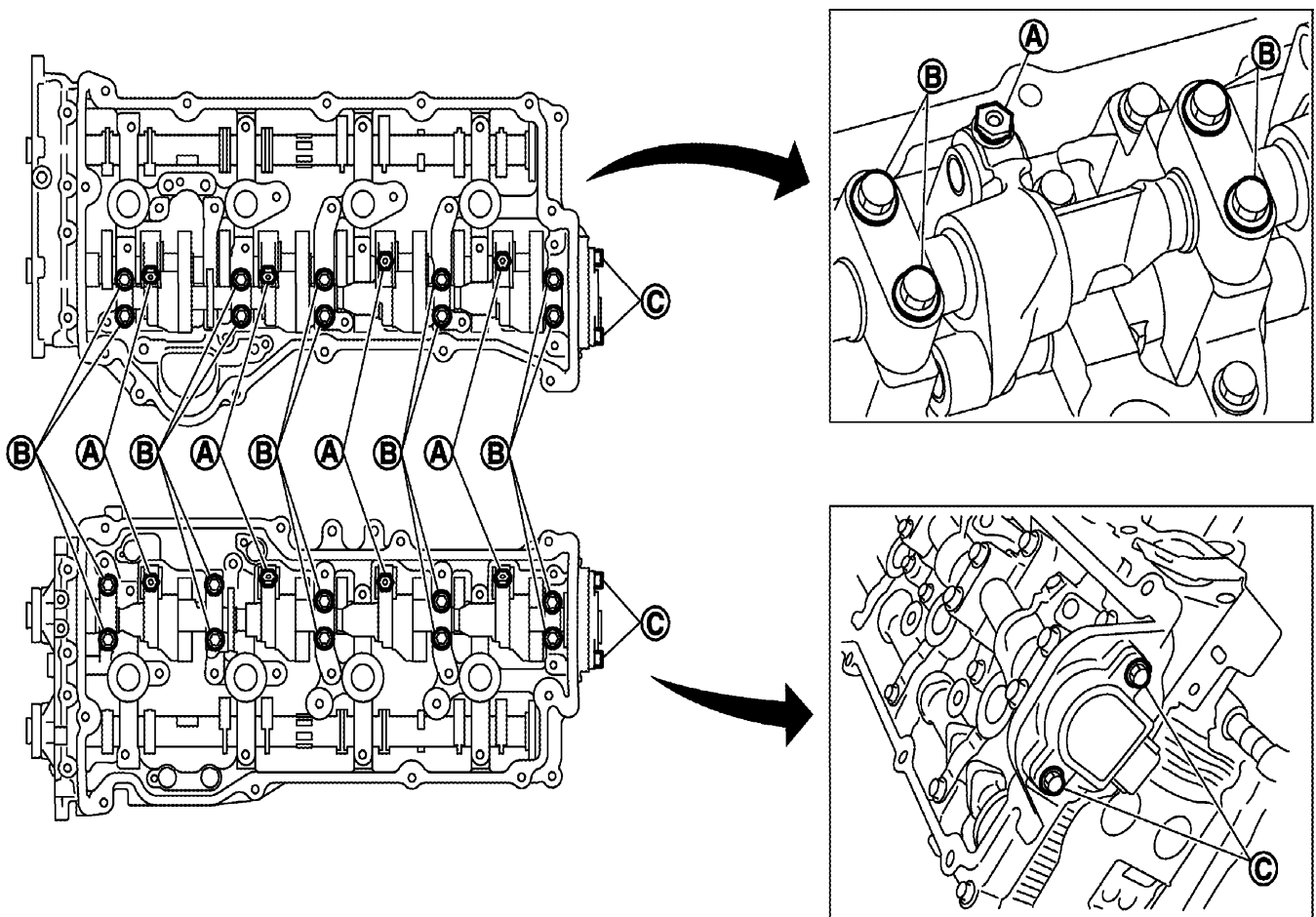

Figure 2

- Never loosen the adjusting bolts (A), mounting bolts (black color) (B) of VVEL ladder assembly, or the mounting bolts (C) of the VVEL control shaft position sensor.

**PARTS INFORMATION**

DESCRIPTION	PART #	QUANTITY
Gasket (VVEL Actuator)	23755-1LA0B	2
Washer (VVEL Ladder)	13056-31U0A	4
Rocker Cover Gasket (bank 1)	13270-1LA1A	1
Rocker Cover Gasket (bank 2)	13270-1LA0A	1
O-ring (Oil level gauge guide)	15066-7S020	1
copper seal (Fuel feed hose)	46237-1LA0A	2
Lifter	13231-1MC5E	1
Front oil seal	13510-1LA0A	1
Seal - camshaft	13042-3HD0A	6
O-Ring	15066-AR010	1
O-Ring	15066-6N204	2
O-Ring	15066-ZL80A	1
O-Ring	15066-AR020	2
O-Ring	15066-1LA0A	1
O-Ring	15066-7S010	1
O-Ring (Cam Sensor)	22131-EN205	2
Tube Assy-Fuel	17520-1LA0B	1
Tube Assy-Fuel	17520-1LA0C	1
O-Ring (Fuel Pump)	16618-1LA0D	1

**CLAIMS INFORMATION**

Submit a Primary Part (PP) type line claim using the following claims coding:

	OPERATION	OP CODE	PFP	SYM	DIAG	FRT
2WD	VVEL LADDER ASSY FOR 2WD - REPAIR (LH SIDE)	AX42AA	(1)	ZR	32	12.0
	VVEL LADDER ASSY FOR 2WD - REPAIR (RH SIDE)	AX43AA				12.1
	VVEL LADDER ASSY FOR 2WD - REPAIR (BOTH SIDES)	AX44AA				14.1
4WD	VVEL LADDER ASSY FOR 4WD - REPAIR (LH SIDE)	AX42AA	(1)	ZR	32	14.3
	VVEL LADDER ASSY FOR 4WD - REPAIR (RH SIDE)	AX43AA				14.4
	VVEL LADDER ASSY FOR 4WD - REPAIR (BOTH SIDES)	AX44AA				16.4

(1) Refer to the electronic parts catalog (FAST) and use the Cylinder Head Assembly part number (11041 - \*\*\*\*\*) as the Primary Failed Part (PFP).

**Expense code:**

EXPENSE CODE	DESCRIPTION	MAX AMOUNT
008	Sealant*	\$7.48

\*Use Genuine RTV silicone sealant or equivalent. 999MP-AM003P (Ultra Grey)