



SERVICE BULLETIN

Classification: AT15-019	Reference: NTB15-104	Date: November 18, 2015
-----------------------------	-------------------------	----------------------------

2014-2015 TAXI; KEY CANNOT BE REMOVED FROM IGNITION OR SHIFTER WILL NOT MOVE OUT OF PARK

APPLIED VEHICLE: 2014-2015 Taxi

IF YOU CONFIRM

- The key cannot be removed from the ignition.

And/or

- The Shifter will not move out of park.

ACTION

- a. Adjust the key interlock cable.
- b. Adjust the stop lamp switch.

NOTE: Nissan vehicle warranty does not cover incidents due to lack of vehicle maintenance and/or physical damage. Refer to the Nissan Assurance Products Resource Manual (APRM) for complete guidelines on warranty coverage.

Nissan Bulletins are intended for use by qualified technicians, not 'do-it-yourselfers'. Qualified technicians are properly trained individuals who have the equipment, tools, safety instruction, and know-how to do a job properly and safely. **NOTE:** If you believe that a described condition may apply to a particular vehicle, DO NOT assume that it does. See your Nissan dealer to determine if this applies to your vehicle.

**Instrument panel
(for reference only)
No need to remove**

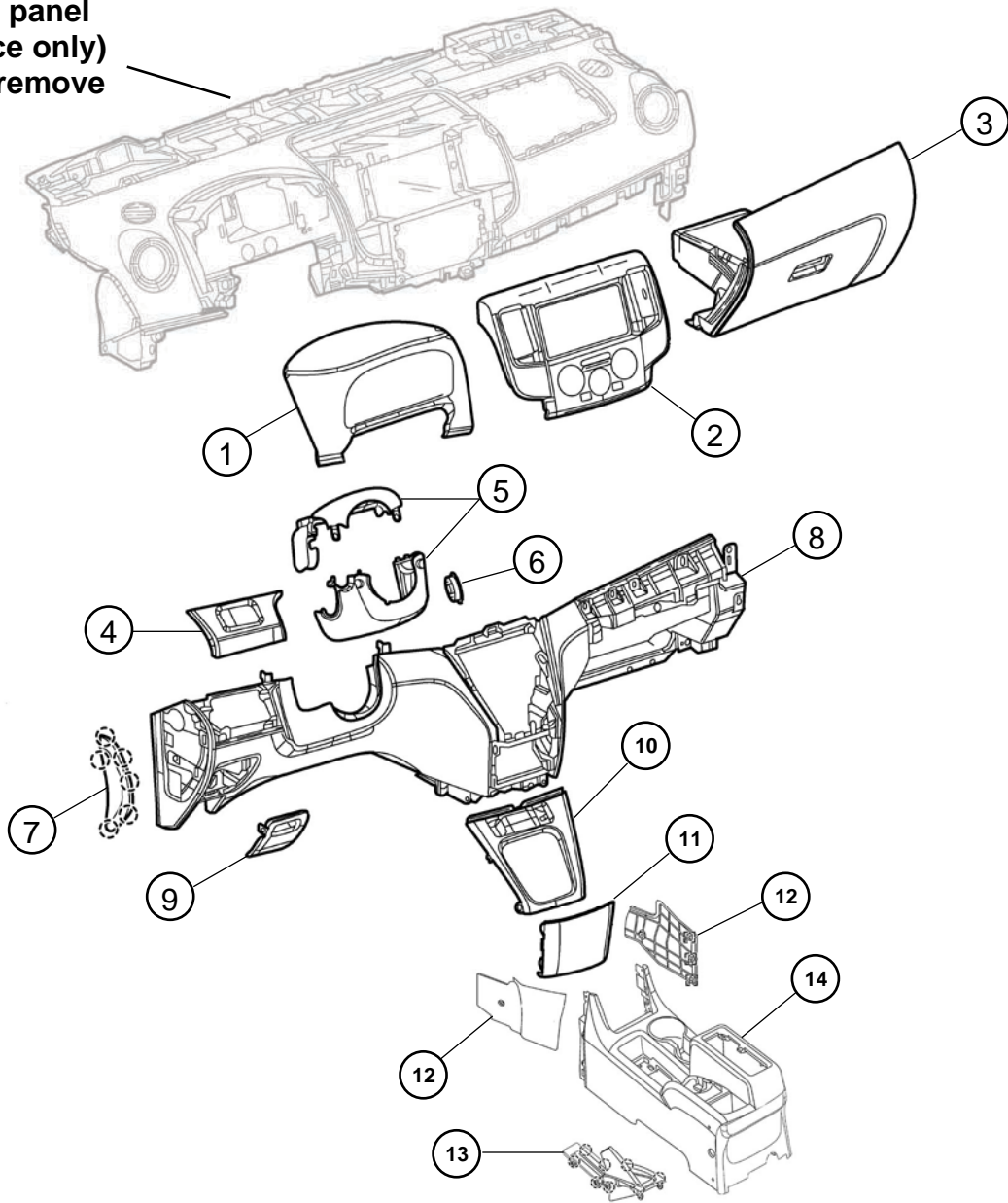

TP150319c

- | | |
|---|-----------------------------------|
| 1. Cluster lid A | 8. Instrument lower panel |
| 2. Cluster lid C | 9. Fuse block cover |
| 3. Glove box assembly | 10. Shift selector finisher |
| 4. Instrument finisher B | 11. Cluster lid C lower |
| 5. Upper and lower steering column covers | 12. Center console side finishers |
| 6. Steering lock escutcheon | 13. Parking brake finisher |
| 7. Instrument side finisher | 14. Center console assembly |

The parts above numbered 1-13 are to be removed and # 14 moved back to access the shift interlock cable. The instrument panel is shown for reference only and its removal is not necessary.

SERVICE PROCEDURE

IMPORTANT: Follow all cautions, warnings, and notes in the Electronic Service Manual (ESM) when working on or near a Supplemental Restraint System (SRS), such as an air bag.

CAUTION: Handle interior trim carefully to avoid damage. Work with clean hands and clean tools to avoid dirt and stains. Use protective covers as needed.

1. Unfasten and slide back the center console assembly as follows:
 - a. Remove the center console side finishers (see Figure 1).
 - Each center console side finisher is fastened with one T20 screw and three (3) snap type clips.

NOTE: Clip locations are shown with red and white circles in all applicable pictures.

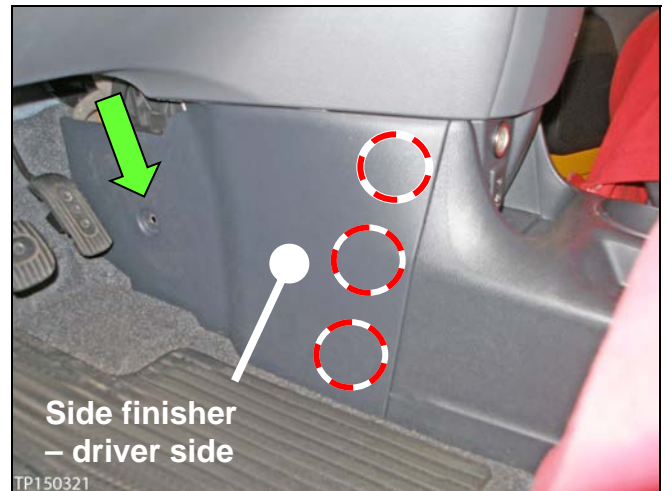

Figure 1

- b. Remove the T20 screw (located at the bottom of the front cup holder).



Figure 2

c. Remove the parking brake finisher with a suitable interior pry tool.

- The parking brake finisher is secured by eight (8) clips.



Figure 3

d. Remove the T20 screw underneath the parking brake finisher.



Figure 4

e. Position both front seats and seatbacks in their full forward positions.

f. Remove the center T20 screw at the rear of the center console assembly on each side.

g. Carefully slide the center console assembly as far back as possible.



Figure 5

2. Remove cluster lid A.

- Cluster lid A is secured by seven (7) clips.



Figure 6

3. Remove the upper and lower steering column covers:

- a. Remove the two (2) screws, one on each side of the steering column cover.
 - Turn the steering wheel almost 90° in each direction to access the two screws.



Figure 7

- b. After removing the screws, unsnap, and then remove, both upper and lower steering column covers.
 - Carefully adjust the steering column up or down as needed to unsnap and remove the upper and lower steering column covers.



Figure 8

4. Remove the front air control button, and then remove cluster lid C.
 - Use a suitable interior pry tool.
 - Cluster lid C is secured by nine (9) clips.

NOTE: During installation, the air control button can only be installed one way. If it does not snap in place with less than moderate pressure, rotate 180°, and then snap in place.

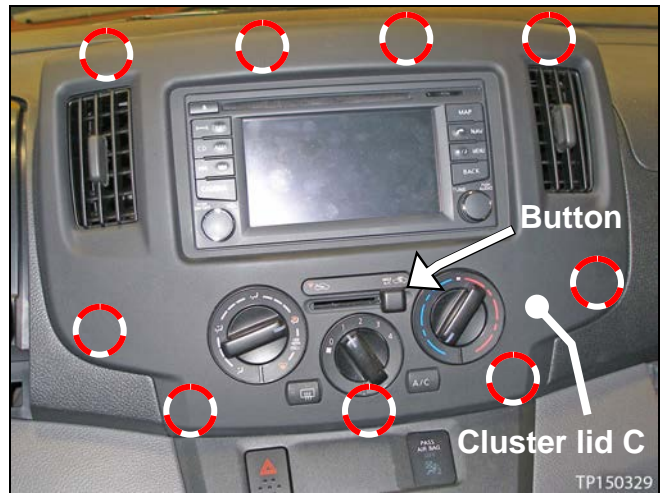

Figure 9

5. Remove cluster lid C lower.
 - Cluster lid C lower is secured by four (4) clips.

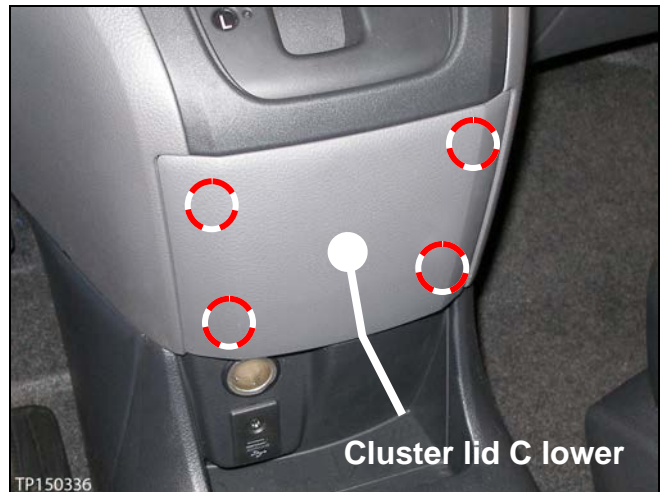

Figure 10

6. Remove the shifter finisher.
 - The shifter finisher is secured by four (4) clips.



Figure 11

7. Remove the instrument side finisher with a suitable interior pry tool.

- The instrument side finisher is secured by six (6) clips.



Figure 12

8. Remove the screw behind the instrument side finisher.



Figure 13

9. Remove instrument finisher B with a suitable interior pry tool.

- Instrument finisher B is secured by four (4) clips.



Figure 14

10. Remove the two (2) 10 mm bolts, and then unclip the hood lock/fuel filler door release handle.

- Let the hood lock/fuel filler door release handle hang where it is.

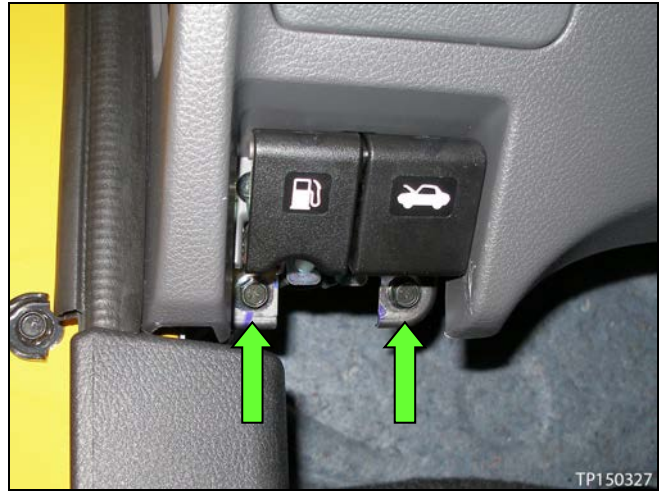

Figure 15

11. Remove the screw behind the hood lock/fuel filler door release handle.



Figure 16

12. Remove the fuse block cover, and then unfasten the data link (On Board Diagnostic or OBD) connector.

- Pinch in on both clips, and then push in the OBD connector.

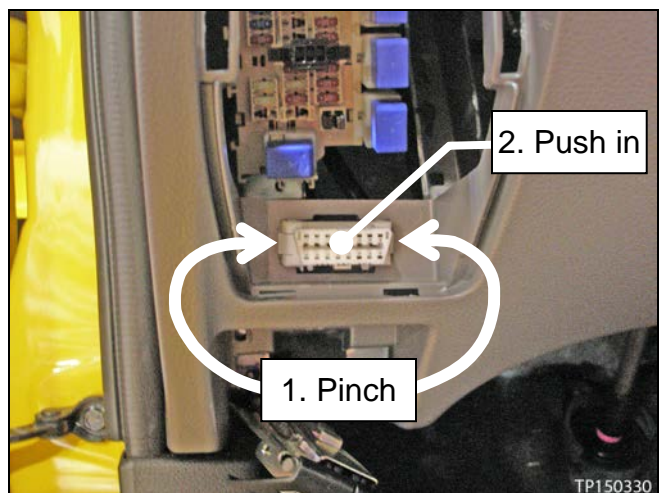

Figure 17

13. Remove the two (2) screws shown in Figure 18.



Figure 18

14. Remove the glove box assembly by removing the T20 and Phillips screws shown in Figure 19-21.

15. With all screws removed, unsnap the glove box assembly secured by six (6) clips.

16. Carefully remove the instrument lower panel.

NOTE: The instrument lower panel extends from one end of the instrument panel to the other.

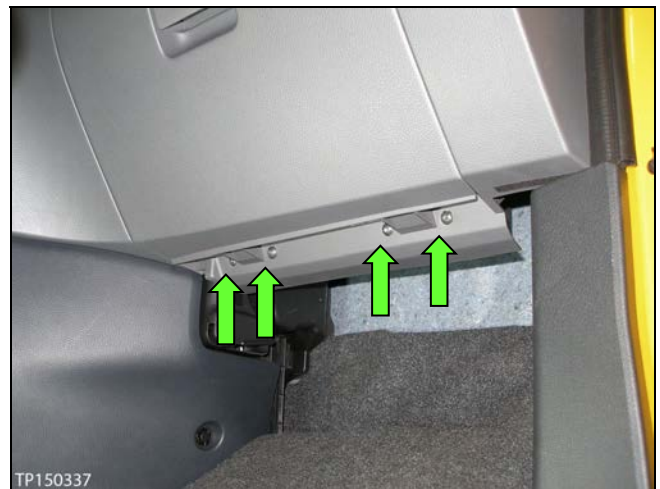

Figure 19

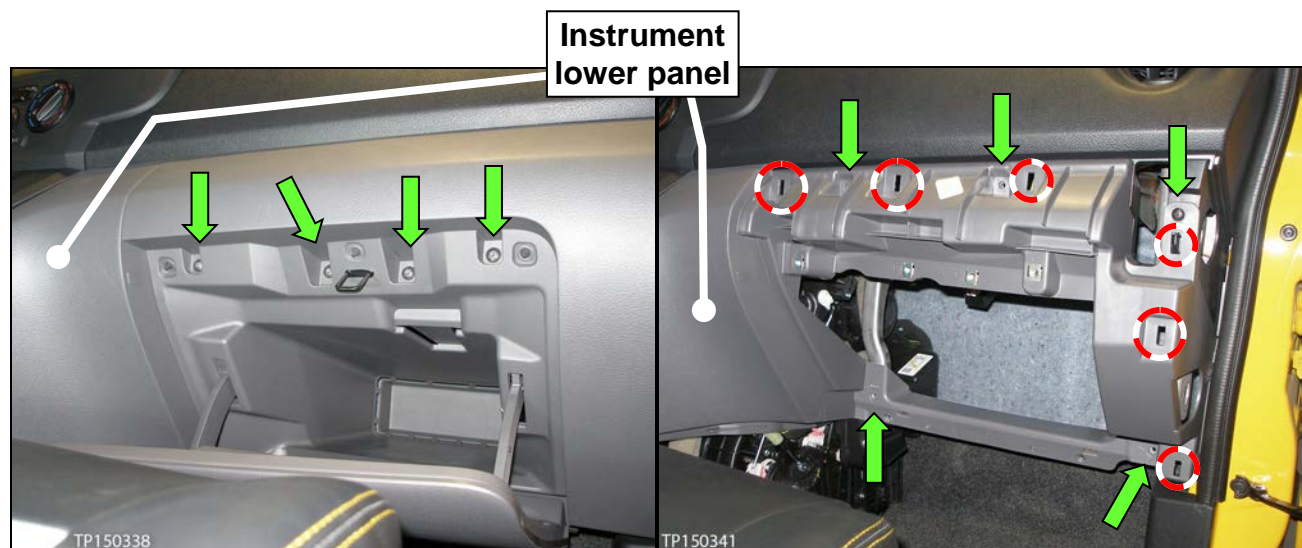

Figure 20

Figure 21

17. Temporarily reconnect the passenger air bag indicator lamp (see Figure 22 and 23).

- The passenger air bag indicator lamp is located on the upper right corner of the shift selector finisher.

IMPORTANT: If the ignition is ON or turned ON when the passenger air bag indicator lamp is disconnected, supplemental restraint system (SRS) related DTCs may trip and be permanently stored in the air bag diagnosis sensor unit.

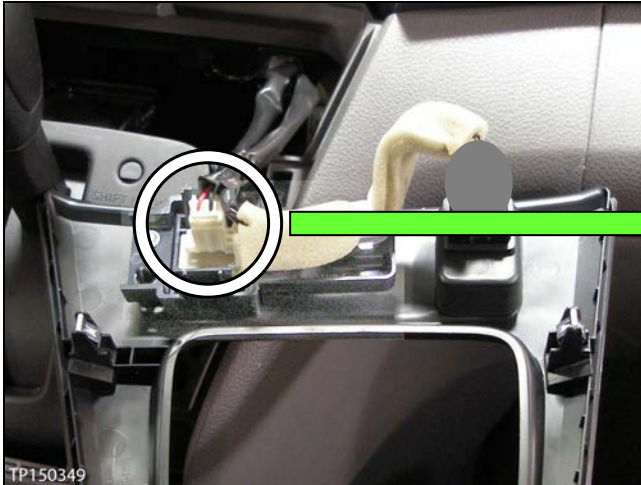

Figure 22



Figure 23

Key Interlock Cable Adjustment Procedure

18. Verify the holder of “key interlock cable” (end of key interlock cable) is secure to the column lock unit with the locking plate (clip) in place. See Figure 24.

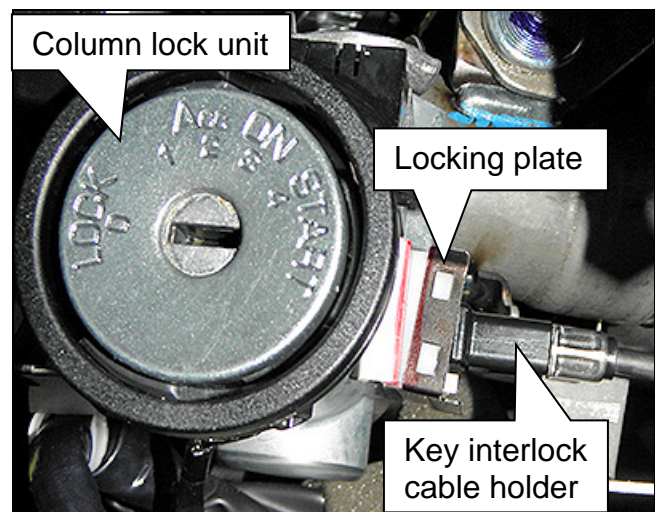

Figure 24

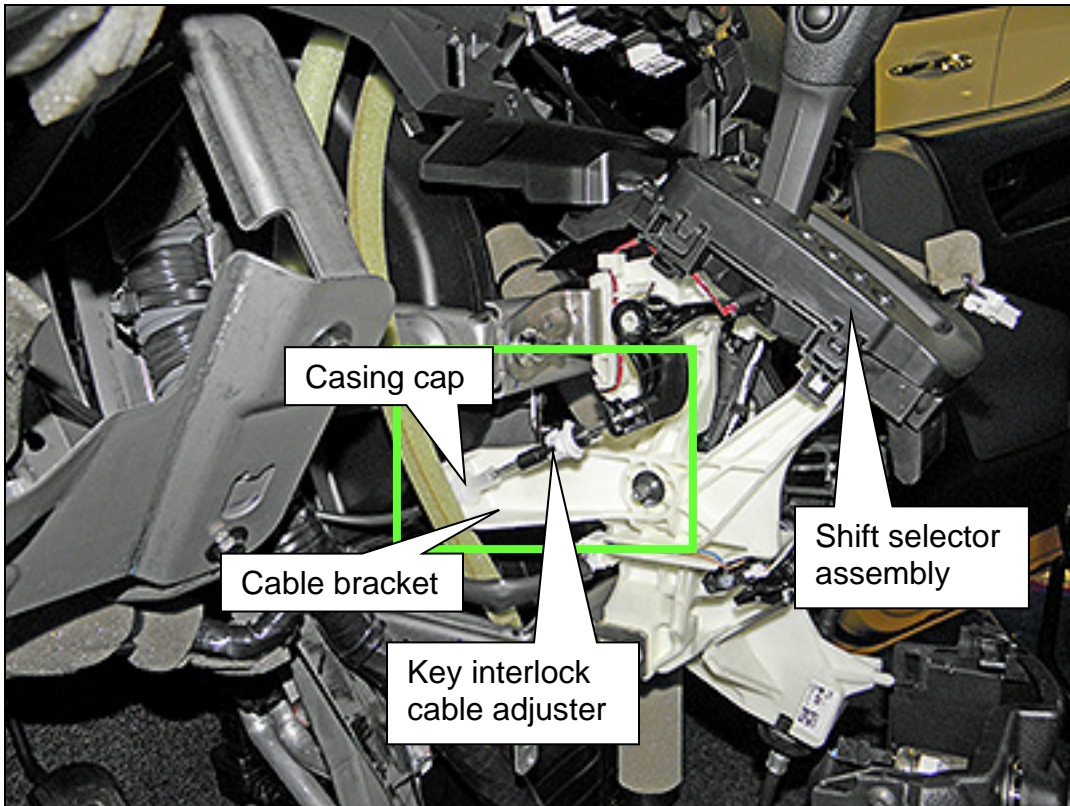

Figure 25

19. Unlock key interlock cable adjuster (Figure 25 and Figure 26):

- a. Press the pawls (B) of the key interlock cable slider (A),
- b. while sliding it in the direction of the casing cap (C),
- c. and then separate the adjust holder (D) and slider.

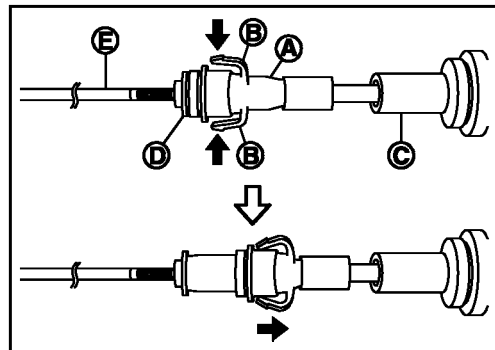

Figure 26

20. Adjust key interlock cable (Figure 27):

- a. Shift to "P" position (if not already).
- b. Turn the ignition switch to LOCK position.

NOTE:

- Do not bend or twist the cable forcefully.
- Confirm that the casing cap is fastened to the cable bracket (Figure 25).

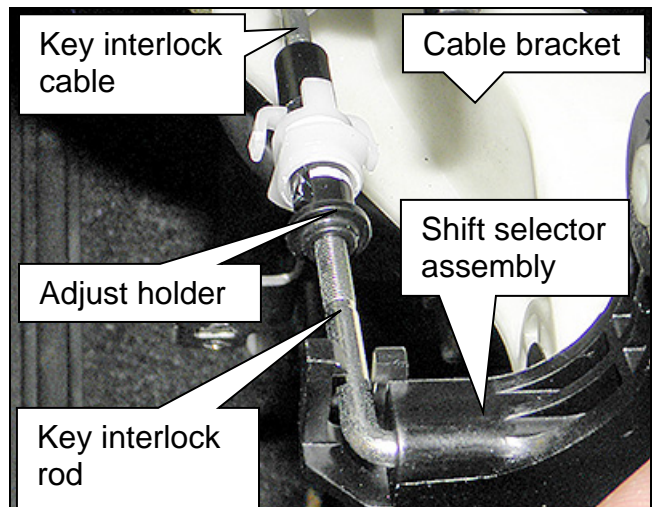

Figure 27

- c. Pull the adjust holder onto the key interlock rod until movement stops and adjust holder cannot be pulled any further; all free-play has been removed.

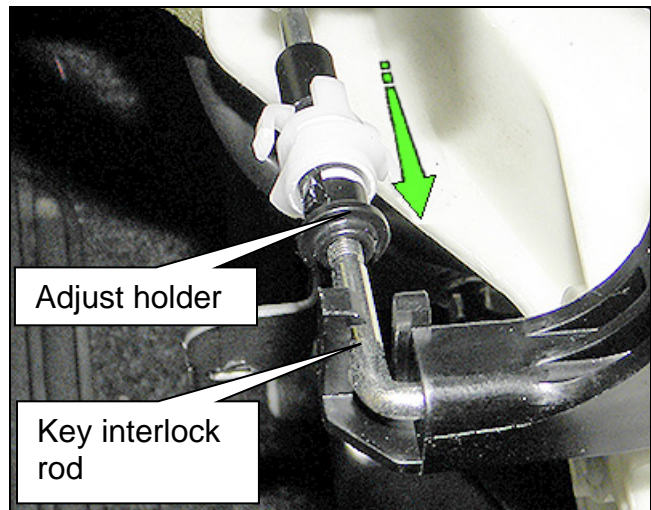

Figure 28

- d. While holding the adjust holder in position from step "c", Move the key interlock cable slider towards the key interlock rod side and lock it (over the adjust holder).

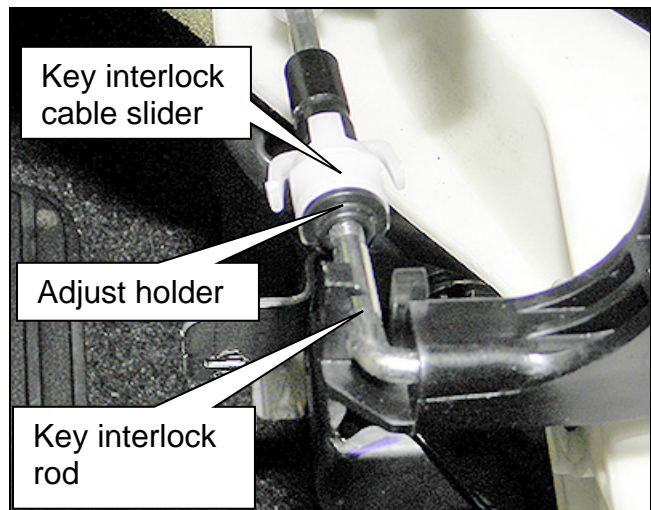

Figure 29

Stop Lamp Switch Adjustment Procedure

NOTE: The following steps are performed without the brake pedal depressed.

21. Adjust the stop lamp switch:

- a. Turn the stop lamp switch (black switch, Figure 30) 45° counterclockwise to unlock.

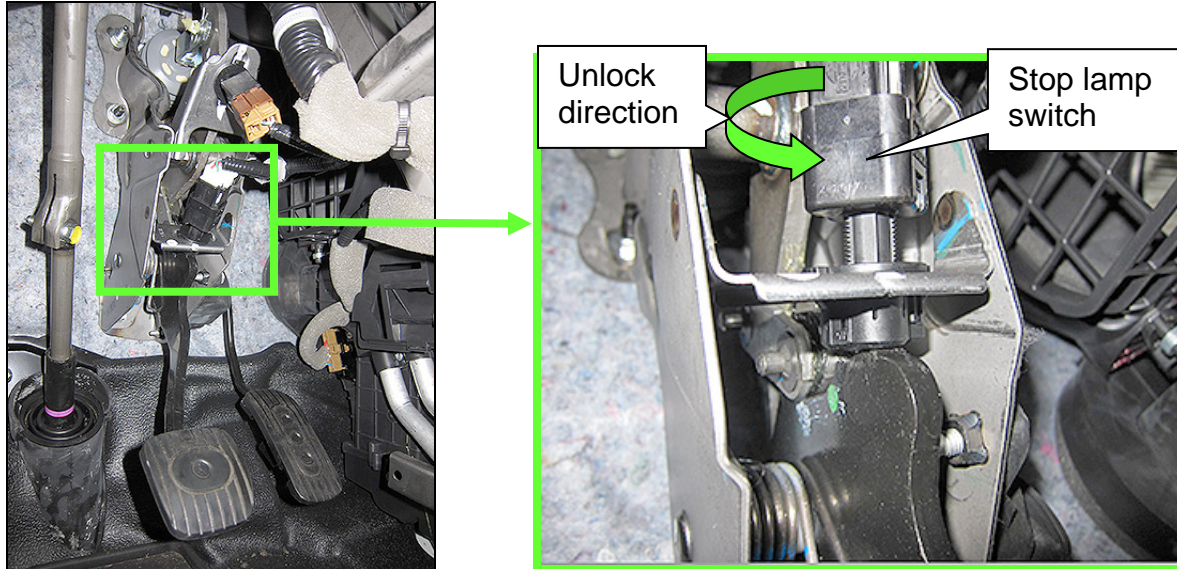

Figure 30

- b. While unlocked, gently push the stop lamp switch until its black plastic body contacts the brake pedal arm (Figure 31).
- c. While holding the stop lamp switch against the brake pedal arm turn the switch 45° clockwise to lock in place.

NOTE: The “brake pedal arm” in the above steps is listed as the “brake pedal bracket” in the ESM.

- d. Confirm the clearance between brake pedal arm and black plastic body of the stop lamp switch (Figure 31); readjust as necessary.

- Clearance:
0.74-1.96 mm (**0.0291-0.0772 in**)

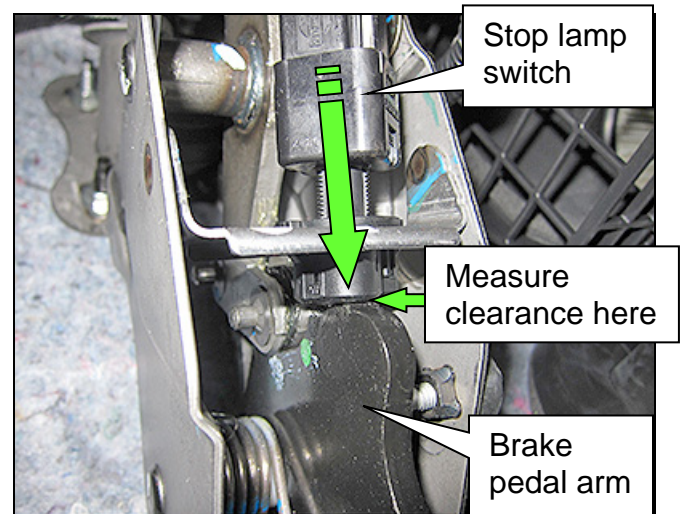

Figure 31

IMPORTANT: After adjusting the stop lamp switch, confirm that the stop lamps come on while the brake pedal is depressed, and then go out when released.

- If the stop lamps do not come on or go out after adjusting switch, recheck stop lamp switch adjustment.

22. After performing key interlock cable and stop lamp switch adjustments, confirm the following items:

a) "Control Device"

- i) To operate the "control lever" from "P" position to other ranges under ignition ON state, the lever is not operable unless the brake pedal is stepped on.
- ii) In other ranges, it is operable regardless of the brake pedal. At "P" position, the "control lever" is not operable under any state other than ignition ON.

b) "Steering Lock"

- i) The key can be removed only when the "control lever" is in the "P" position.

23. Turn the ignition OFF, and then disconnect the passenger air bag indicator lamp.

IMPORTANT: If step 23 is not performed in the order as stated, supplemental restraint system (SRS) related DTCs may trip and be permanently stored in the air bag diagnosis sensor unit.

24. Reassemble the vehicle in reverse order of disassembly.

25. After turning the ignition ON or starting the engine, make sure the supplemental air bag and front passenger air bag indicator lights turn OFF after approximately seven (7) seconds.

- The front passenger seat should be empty before performing step 24.

26. Use CONSULT-III plus to erase any DTCs caused by this repair.

CLAIMS INFORMATION

Submit a Primary Operation (PO) type line claim using the following claims coding:

DESCRIPTION	OP CODE	SYM	DIA	FRT
Adjust Key Interlock Cable and Brake Switch	JX41AA	ZE	32	1.0