

FLA COE  
FLB COE  
FLD Conventional  
Business Class  
FLC 112 Conventional

Century Class Conventional  
Argosy COE  
Cargo  
Columbia

122SD and Coronado  
> Business Class M2  
Cascadia  
> 108SD/114SD

Freightliner  
Service Bulletin

## General Information

Vehicles built in model year 2016 use a bulkhead module (BHM) with a 500k auto baud rate. If a BHM needs replacement, it must be replaced with the new BHM (A66-03086-000) with a 500k auto baud rate.

**IMPORTANT:** It is normally not necessary to replace the BHM. Replacing the BHM should be a last resort to solving electrical problems, unless the unit needs replacing due to physical damage.

## Replacement

1. Open the hood.
2. Disconnect the negative leads from the batteries.

**NOTE:** The bulkhead module is located on the frontwall slightly below and outboard of the steering column. See [Fig. 1](#).

3. Disconnect bulkhead harnesses B1 through B4 from the engine side of the frontwall. See [Fig. 2](#).
4. Disconnect bulkhead harnesses B5 through B7 from the bulkhead module on the cab side of the frontwall. See [Fig. 3](#).
5. Remove the tread plate from the driver door entry.
6. Remove the kick panel from the left side of the driver footwell.
7. Remove the five Torx® capscrews that secure the BHM to the cab side of the frontwall, then remove the BHM by pulling it through the opening into the cab.
8. Place the new BHM through the frontwall opening from the cab side, then secure it with five Torx capscrews and torque them 48 lbf-in (540 N-cm).
9. Install the kickpanel in the left side of the driver footwell and secure it with Torx capscrews.
10. Install the tread plate at the driver door entry.
11. Connect the bulkhead harnesses B5 through B7 to the BHM on the cab side of the frontwall.
12. Connect the bulkhead harnesses B1 through B4 to the BHM on the engine side of the frontwall.

**IMPORTANT:** The ignition and the battery switch must be in the ON position *before* the batteries are connected for the 500k auto baud rate BHM to operate properly.

13. Turn the ignition switch to the ON position.
14. Turn the battery cutoff switch (if equipped) to the ON position.
15. Connect the batteries.
16. Close the hood.
17. Flash the new BHM. Refer to **Section 54.12, Subject 110** for the *Business Class M2 Workshop Manual*, or **Section 54.07, Subject 110** for the *108SD/114SD Workshop Manual*.

## Warranty

This is an informational bulletin only. Warranty does not apply.

FLA COE  
FLB COE  
FLD Conventional  
Business Class  
FLC 112 Conventional

Century Class Conventional  
Argosy COE  
Cargo  
Columbia

122SD and Coronado  
> Business Class M2  
Cascadia  
> 108SD/114SD

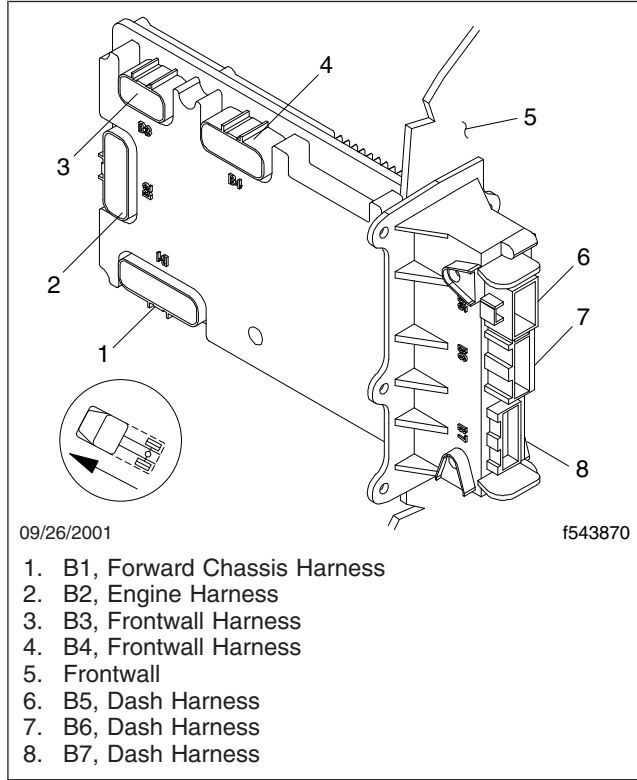

**Fig. 1, Bulkhead Module Harness Connections**

# Replacing a Bulkhead Module with a 500k Auto Baud Rate BHM

# 54-295

FLA COE  
FLB COE  
FLD Conventional  
Business Class  
FLC 112 Conventional

Century Class Conventional  
Argosy COE  
Cargo  
Columbia

122SD and Coronado  
> Business Class M2  
Cascadia  
> 108SD/114SD

**Freightliner  
Service Bulletin**

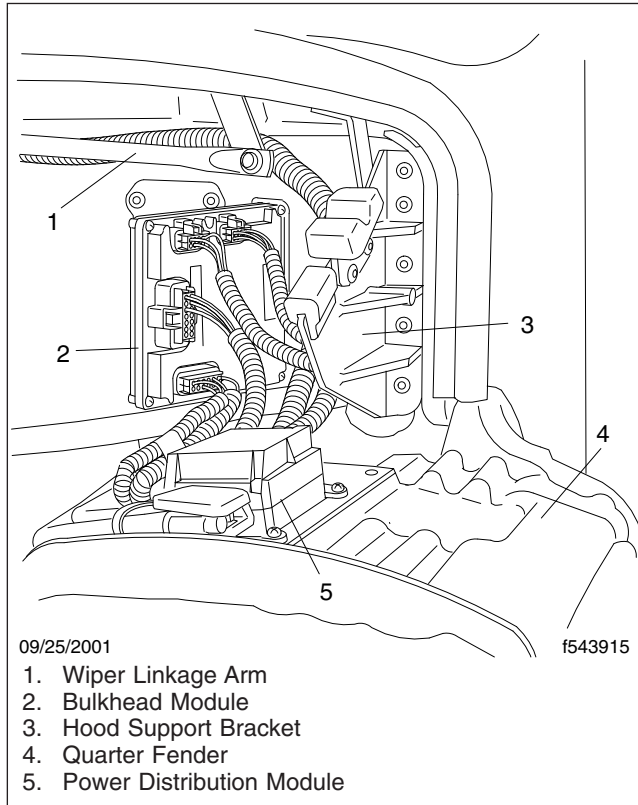

**Fig. 2, Bulkhead Module from the Engine Side**

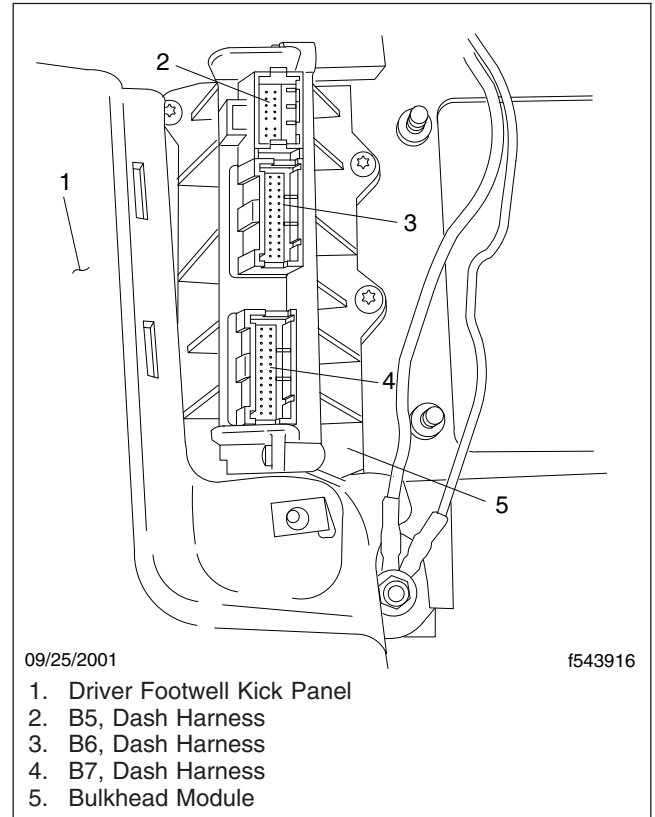

**Fig. 3, Bulkhead Module from the Cab Side**