

Technical product information

Topic	Rear window blinds do not operate
Market area	Russische Föderation (5RU),Australia E04 Bentley rest Asia and Australia (6E04),China 796 VW Import Comp. Ltd (Vico), Beijing (6796),Germany E02 Bentley rest Europe (6E02),Japan E03 Bentley Japan (6E03),Korea, (South) E08 Bentley South Korea (6E08),United Arab Emirates E06 Bentley Middle East and Africa (6E06),United Kingdom E01 Bentley UK (6E01),United States E05 Bentley USA and rest America (6E05)
Brand	Bentley
Transaction No.	2064460/1
Level	EH
Status	Approval
Release date	

New customer code

Object of complaint	Complaint type	Position
body fixtures and fittings -> sunblind operation -> electrically lower side window blind	functionality -> without function / defect	
body fixtures and fittings -> sunblind operation -> mechanically raise side window blind	functionality -> without function / defect	

Vehicle data

Bentayga

Sales types

Type	MY	Brand	Designation	Engine code	Gearbox code	Final drive code
4V1*	2021	E		*	*	*

Documents

Document name
master.xml

Customer statement / workshop findings

Rear side window blind/s do not operate from the individual switches and/or from the driver's door master switches

Technical background

▪

The following most common failure modes should be considered before proceeding with the instructions within the Measure section

- Rear blind/s do not operate following a CAN bus sleep
- Rear blind/s do not operate if the switch operation is a prolonged hold instead of a 'Press and release' operation
- Rear blind/s do not operate following the loss of control module basic settings
- Rear blind/s will also not operate if the 'Child Lock' is on
- Rear blind/s will cease to operate if there are repeated operations of the blind sufficient to trigger a failsafe mode (usually between 10 to 15 operations in a very short period)
- As instructed within the owner's handbook, the rear blind/s will not operate if window is in the lowered position
- The blind will also not operate in extreme cold temperature for example -10 degrees Celsius or 14 degrees, Fahrenheit.

▪

VERY IMPORTANT: In the event that all the previous recommendations have been checked/confirmed and the issue is still evident, the operative should conduct a software parameter update to all four door control modules 0042, 0052, 00BB, 00BC to restore the functionality of the rear blinds

Production change

-

Measure

▪

Where applicable - Please ensure all guidelines within the repair manual are strictly followed before and whilst conducting any work on vehicles with a High voltage system

Software update to all four door control modules

▪

Before conducting the software updates, Have the rear side blind motors been previously disconnected? Yes -

Reconnect the rear blind motors and continue with the software update

No - Continue with the software update

General information for the reprogramming:

- The closed-circuit voltage of the vehicle must be at least 12.5 V during the update. Connect a suitable battery charger to the vehicle. For further information refer to the Repair manual
- During the update switch off all unnecessary consumers (ventilation, seat heater, interior illumination etc)
- Because of the highest transmission stability you **MUST** use the diagnosis interface VAS 6154 (WiFi diagnostic tool) **ONLY** in USB operation or the cable-connected VAS 5055 for the reprogramming (updating) of control units. If these units are not available, the diagnosis interface VAS 5054 (A) can also be used in USB mode
- Do Not under any circumstances use a Bluetooth connection to conduct the reprogramming (updating) of control units

1) Select and run Guided fault finding

- Within the Special functions tab select -SVM- Problem related hardware/software
- Select -Perform test

2) Referring to Figure 1 (Point A) enter the SVM code 4V0LBBT01

- Select Adopt (Point B)

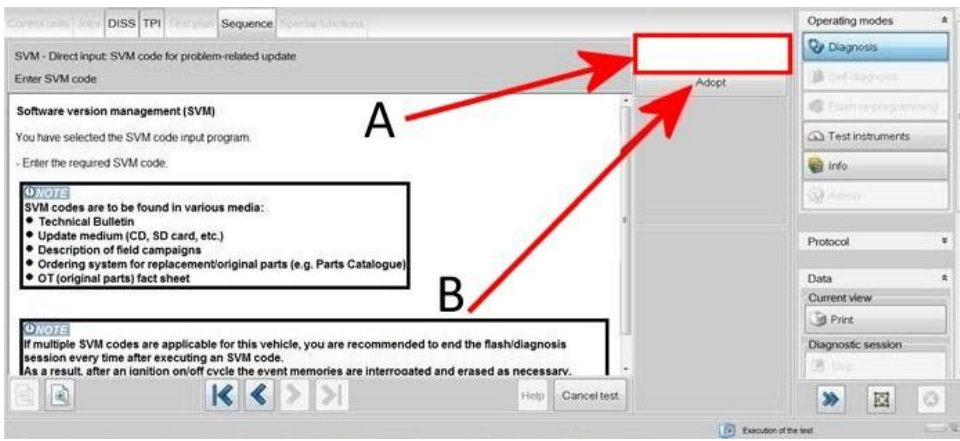

Figure 1

3) Follow all remaining on screen prompts to update all four door control modules - 0042, 0052, 00BB, 00BC

NOTE: All door control modules will automatically/simultaneously update

- Once complete a message will be displayed confirming that all actions have been completed successfully
- Follow on screen prompts until program end

4) After the update programming is complete, perform a CAN sleep, carry out the following steps in the order stated below:

- Switch off the ignition
- Remove the diagnostic interface from the OBD port
- Switch off and remove the battery charger from the vehicle
- Close the bonnet and all doors then lock the vehicle
- Wait 5 minutes so that the vehicle goes into bus silence
- When 5 minutes has elapsed, unlock the vehicle and open the driver's door
- Switch on the ignition
- Confirm gear selection is possible

5) Confirm the rear window side blinds now operate

Warranty accounting instructions

Warranty type 110 or 910

Damage service number 68 96

Damage code 00 40

Labour

Labour operation code 01510000

Time As per ODIS log (Must not exceed 50 TU)

Remove and refit x2 rear door trim panels (If required for reconnection of the blind motors)

Labour

Labour operation code 70732000

Time 40 TU