



SIB 65 04 21 RETROFITTING AUDIO SYSTEM

2021-09-24

Model	Model Description	Production Date
K52 11	R 1250 RT	Starting March 1, 2021. With optional equipment 269A.

SITUATION

R 1250 RT Motorcycles built on or after March 1, 2021 and equipped with option: "269A - Preparation Audio System" can be retrofitted with the audio module.

PROCEDURE

Retrofit Instructions:

Follow attached instructions to install the audio module.
Using ISTA Version 4.28.3X or higher, run the retrofit procedure.

PARTS INFORMATION

Obtain and confirm the part numbers for your specific vehicle by entering the chassis number in ETK which takes into account specific equipment and/or options.

Additional parts like gaskets, hardware and chemicals may be required for the complete repair.

Part Number

65 12 7 105 111	Audio Control Unit
65 12 1 540 373	Left ACU Bracket
65 12 1 540 372	Right ACU Bracket
07 12 9 904 381	Hex Nut (Qty:4)
07 12 9 904 997	Hex Nut (Qty:4)
52 53 7 696 126	Rubber Mounting (Qty:4)

As of October 1, 2021, prices for these parts have been adjusted to be similar in cost to the original factory Audio System option.

WARRANTY INFORMATION

This audio system could not be ordered from the factory and was not included in the cost of the motorcycle.

- The customer is responsible for the cost of all required parts.
- BMW will cover the cost of labor.

Defect code

65 12 90 00 00	Retrofitting audio system
----------------	---------------------------

Labor Operation

77 52 000	Installing audio system (vehicle with preparation kit)	6 FRU
+77 52 500	Installing audio system (vehicle with preparation kit)	5 FRU

FRUs includes all repair procedures to complete the task with allowance for necessary ancillary tasks (e.g., visual inspection, lubrication, cleaning parts etc.) and administrative tasks.

Labor operation code 77 52 000 is a Main labor operation. If you are using a Main labor code for another repair, use the Plus code labor operation instead.

QUESTIONS REGARDING THIS BULLETIN

Technical inquiries	Contact the BMW Technical Support Group via TSARA
Warranty inquiries	Submit an IDS ticket to the Warranty Department
Parts inquiries	Submit an IDS ticket to the Motorrad Parts Department

Supporting Materials

[picture_as_pdf RM_7752000_EN.pdf](#)

[picture_as_pdf 65 04 21 RETROFITTING AUDIO SYSTEM.pdf](#)

OL01 - R 1250 RT

77 52 000 Installing audio system (vehicle with preparation kit)

– with audio system^{OE} (0268)

NOTICE

There are different construction statuses.
Select the appropriate procedural steps.◇

1

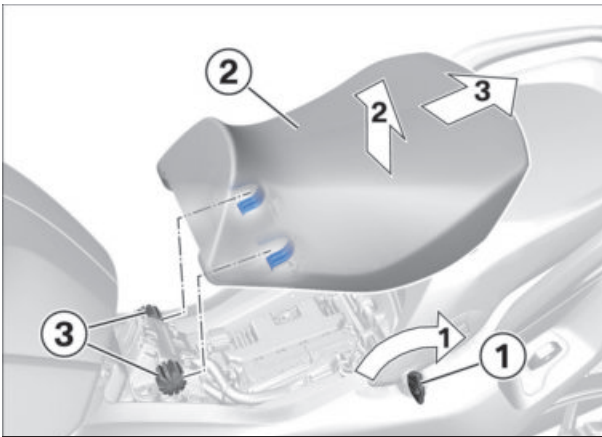

► Removing front seat

- Turn ignition key **(1)** clockwise.
- Lift front seat **(2)** at rear.
- Ease front seat **(2)** to the rear off buffers **(3)**.

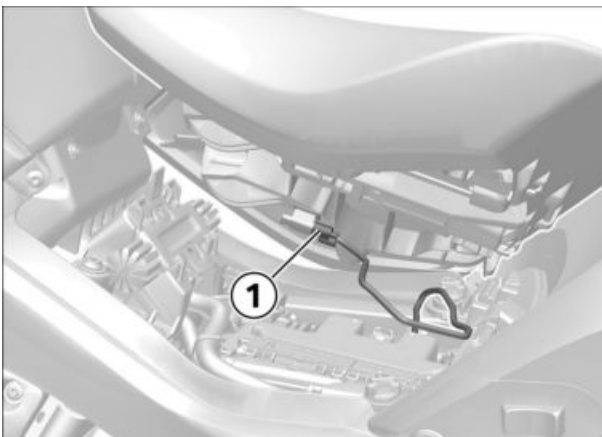

– with seat heating^{OE} (0518)

- Disconnect plug **(1)** for the seat heating.◇



2

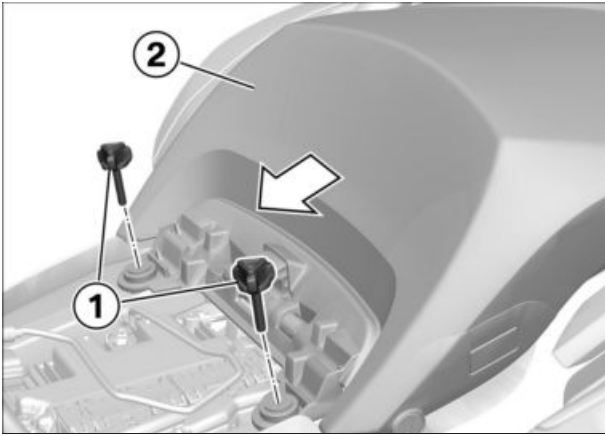

► **Removing passenger seat**

- Remove screws **(1)**.
- Remove passenger seat **(2)**.

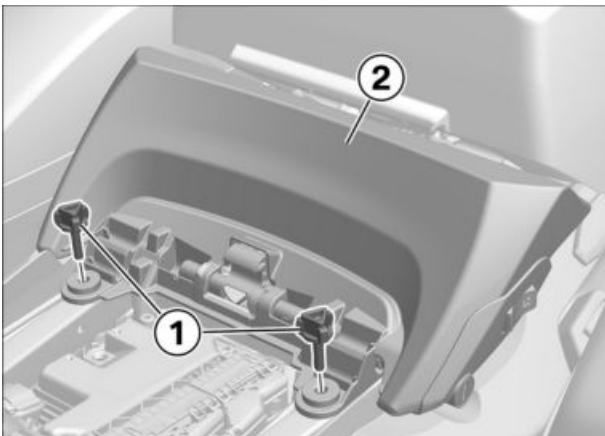

– with deviation from standard for authority vehicles^{BU}

▷ **Removing the seat wedge**

- Remove screws **(1)**.
- Remove seat wedge **(2)**.

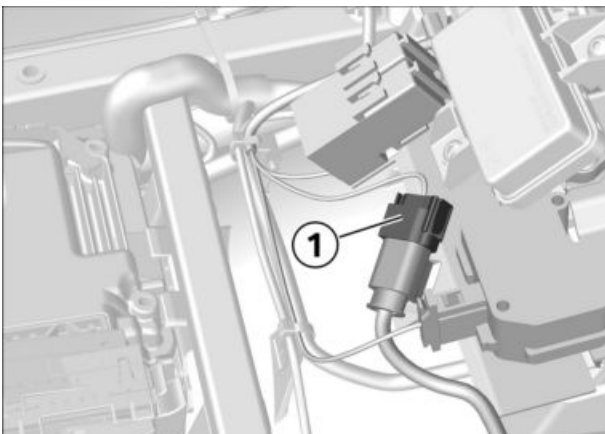

- Unclip and disconnect connector for radio transceiver box unlocking **(1)**.◊



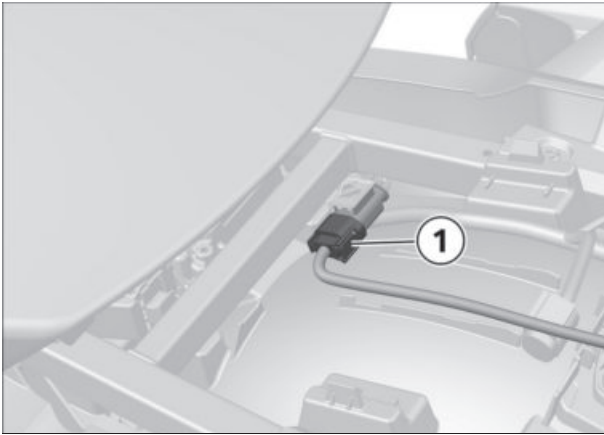

- with seat heating^{OE} (0518)
- Disconnect plug **(1)** for seat heating.◇



3

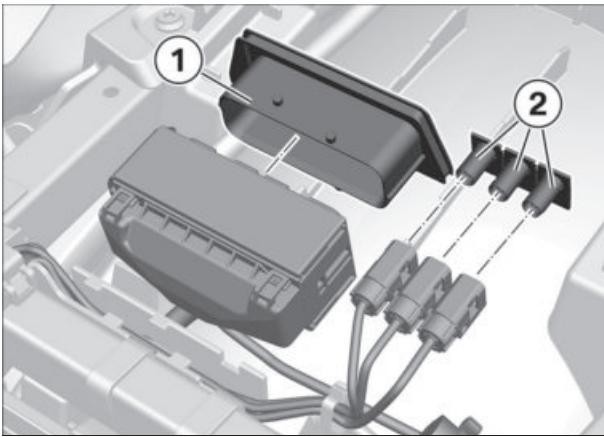

► **Removing individual blind caps**

- Remove blind caps **(1)** and **(2)**.



4

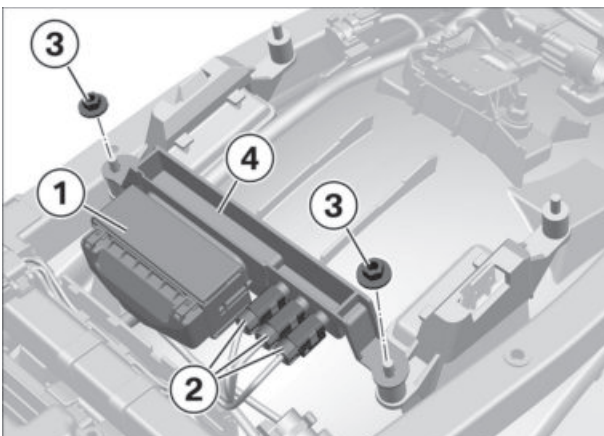

► **Removing blind cap bar**

- Disconnect connector **(1)** and **(2)**.
- Remove nuts **(3)**.
- Remove blind cap bar **(4)**.



5

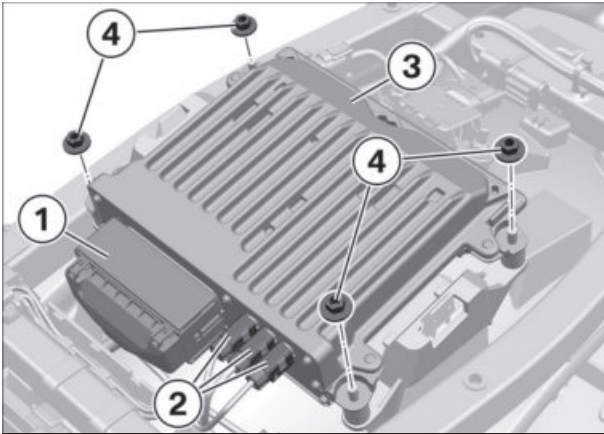

► **Installing audio control unit**

- Connect connectors (1) and (2).
- Connectors (2) are encoded differently.
- Install audio control unit (3).
- Install nuts (4).

Tightening torques		
Audio control unit to bracket		
M5	2.5 Nm	
Thread-locking compound (mechanical)		

6

► **Removing right engine spoiler**

ATTENTION

Use of hard or sharp-edged objects in proximity to component

Component damage

- Take care not to scratch components; cover or mask as necessary.

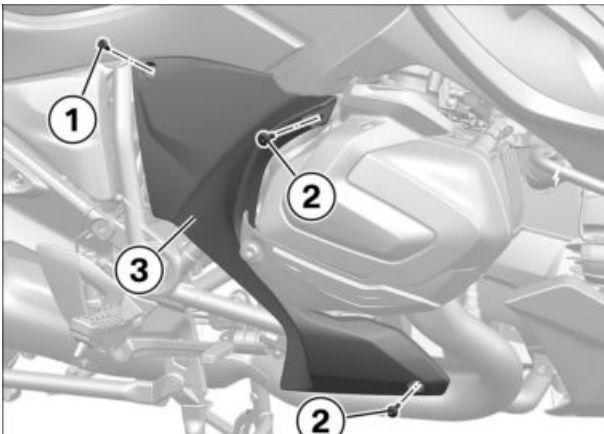

- Remove screws (1) and (2).
- Remove engine spoiler (3).

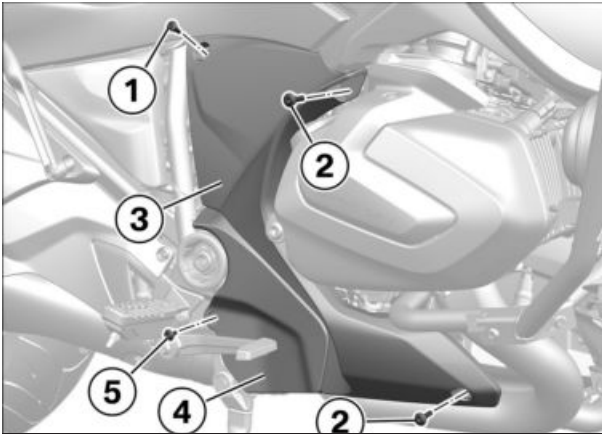

- with deviation from standard for authority vehicles^{BU}
- Remove screws **(1)**, **(2)** and **(5)**.
- Remove engine spoiler **(3)** with trim **(4)**.◇

7

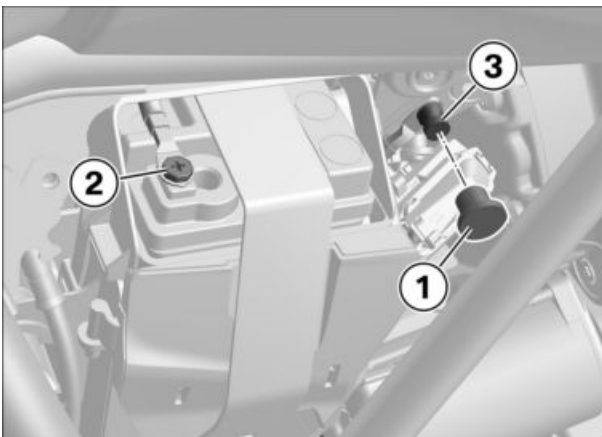

► **Connecting BMW Motorrad diagnostic system to vehicle**

- Remove cap **(1)**.
- Connect the BMW Motorrad battery charger to negative terminal **(2)** and remote positive terminal **(3)**.

NOTICE

When carrying out diagnosis and programming, use a battery charger with 30 A approved by BMW Motorrad that ensures an **on-board system voltage of 13 V**.

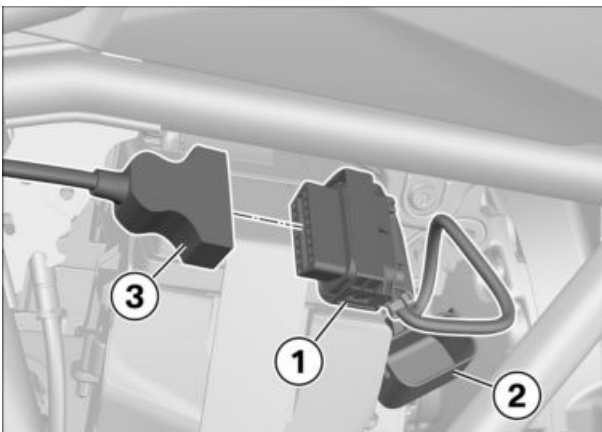

- Loosen diagnostic connector **(1)** from holder **(2)**.
- Connect diagnostic connector **(1)** with connecting cable **(3)** for diagnosis system.
- Follow the instructions issued by the BMW Motorrad diagnostic system.

8

► **Performing software update with the BMW Motorrad diagnosis system**

Requirement

Engine is off.

Battery is fully charged and battery charger is connected.

NOTICE

Do not attempt to perform work of any other kind on the motorcycle while programming/coding is in progress.

- Switch off all electrical consumers.
- Start the diagnosis system.
- Identify the vehicle.
- Select the retrofit.
- Create a measures plan and perform the retrofit.

9

► Disconnecting BMW Motorrad diagnostic system from vehicle

- Terminate the diagnosis session correctly and switch off the ignition.
- Disconnect diagnostic connector **(1)** of connecting cable **(3)** for diagnosis system.
- Secure diagnostic connector **(1)** in holder **(2)**.

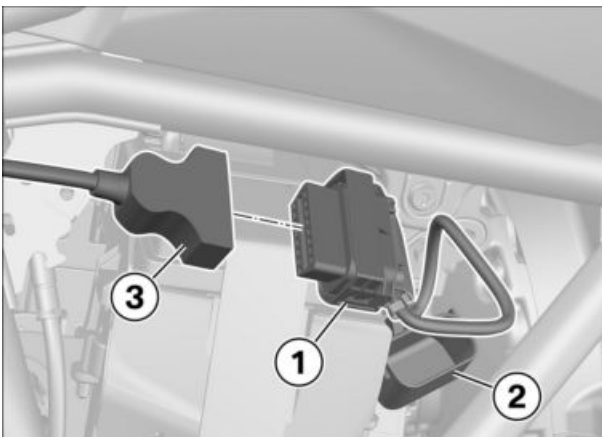

- Disconnect BMW Motorrad battery charger from remote positive terminal **(3)** and negative terminal **(2)**.
- Install cap **(1)**.

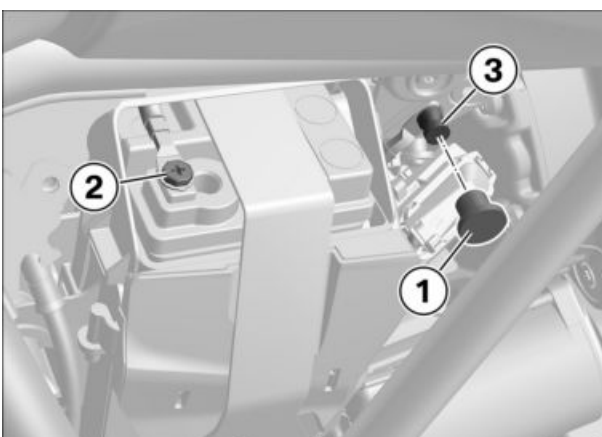

10

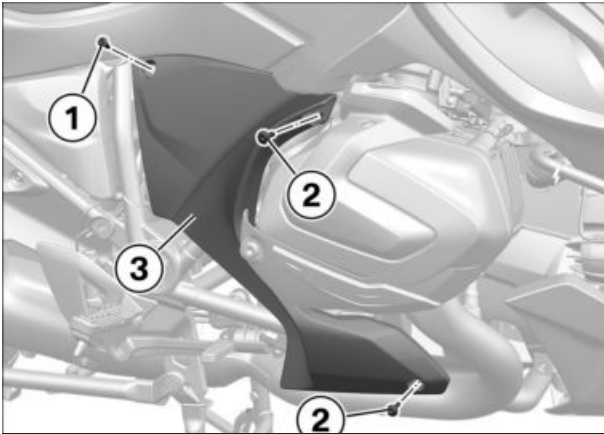

► Installing right engine spoiler

- Position engine spoiler **(3)**.
- Install screws (shorter collar) **(2)**.
- Install screw **(1)** (long collar).

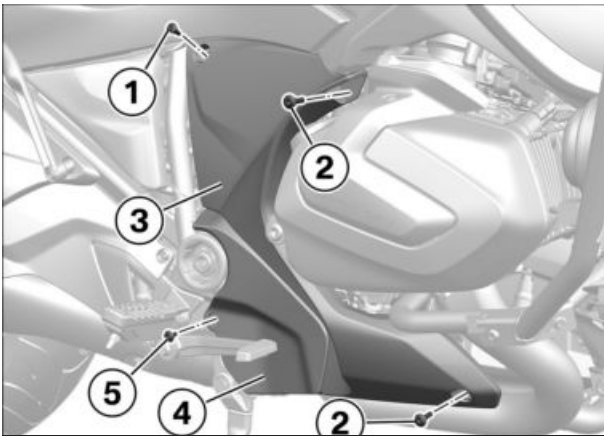

– with deviation from standard for authority vehicles^{BU}

- Position engine spoiler **(3)** with trim **(4)**.
- Install screws (shorter collar) **(2)**.
- Install screws (longer collar) **(1)** and **(5)**.◇



11

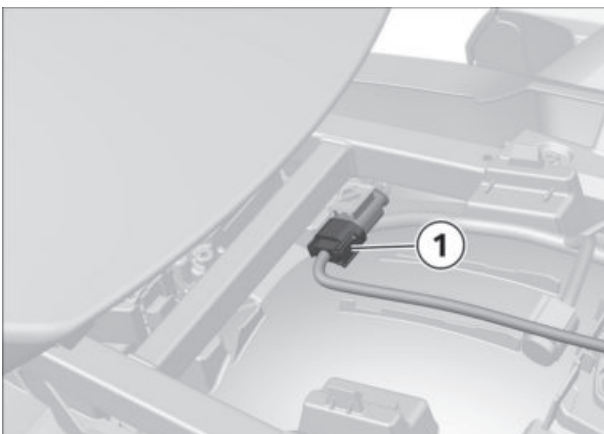

► Installing passenger seat

- with seat heating^{OE} (0518)
- Connect the connector **(1)** for seat heating.◇

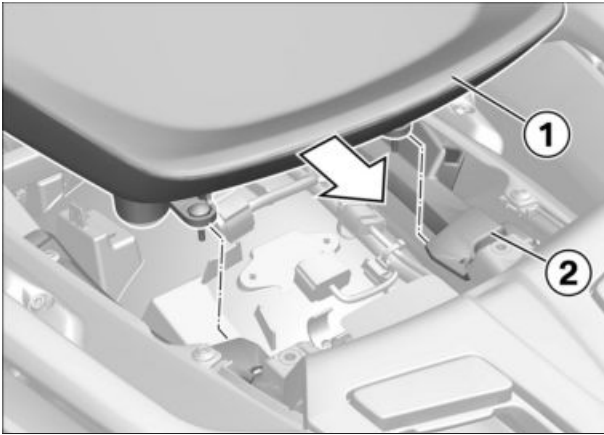

- without deviation from standard for authority vehicles^{BU}
- Place passenger seat **(1)** in position from the front, while engaging passenger seat **(1)** underneath case holder **(2)**.◇

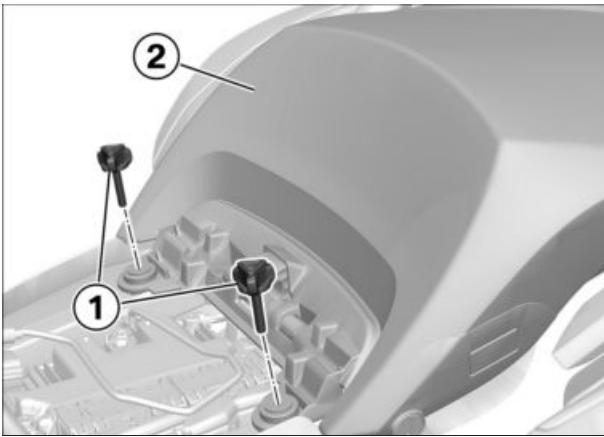

- Position passenger seat **(2)**.
- Install screws **(1)**.

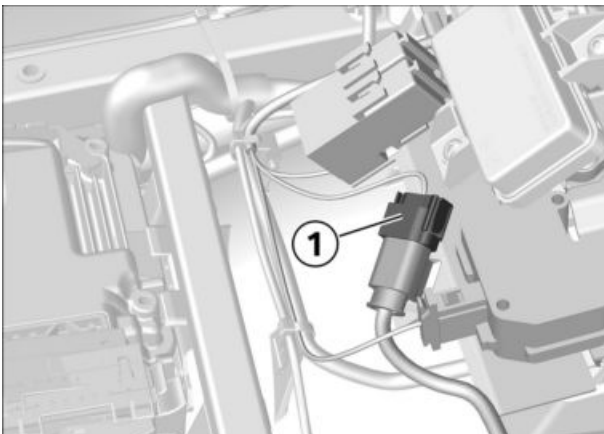

- with deviation from standard for authority vehicles^{BU}

▷ **Installing the seat wedge**

- Connect connector for the radio transceiver box unlocking **(1)** and clip it into position.

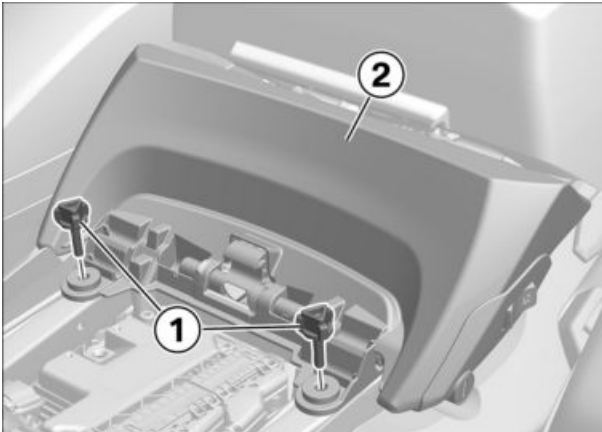

- Position seat wedge **(2)**.
- Install screws **(1)**.◇



12

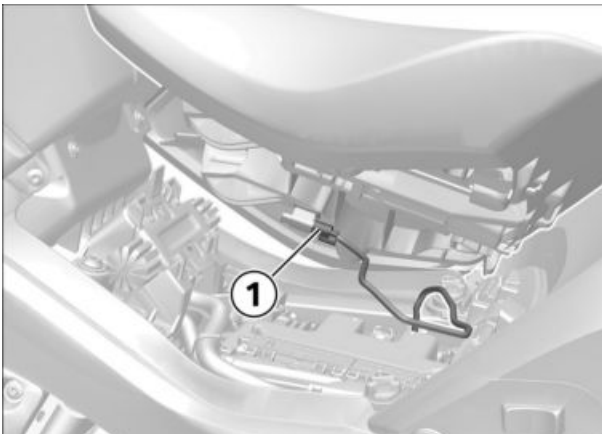

► Installing front seat

- with seat heating^{OE} (0518)
- Connect plug **(1)** for the seat heating.◇

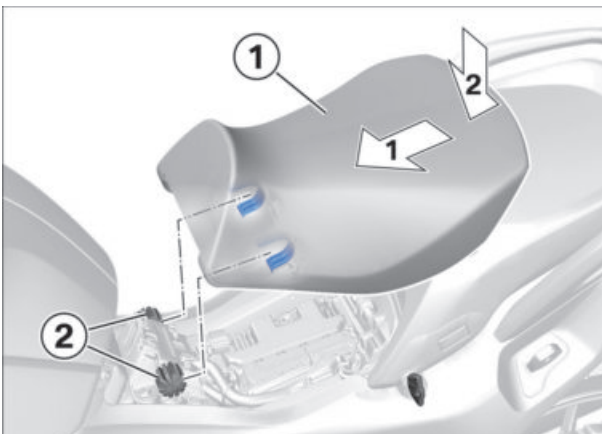

- Push front seat **(1)** on to buffers **(2)**.
- Press down on front seat **(1)** at the rear.
- » Front seat **(1)** engages with an audible click.



13

► Final check of work performed

- Check the following:
 - The work as performed achieved the intended purpose.
 - All reservoirs and containers have been filled and all fluids and lubricants are at their correct levels.

- All threaded fasteners released beforehand have been correctly retightened.
- The fuel system is free of leaks.
- The lights and signalling equipment are fully operational and the vehicle is roadworthy.
- The brake pads of the front and rear brakes are bedded against the brake discs.

▷ **Function test, engine start suppression**

Check

- Set kill switch to centred position.
- Select neutral.
 - » Neutral telltale light "N" lights up.
- Select a gear.
 - » Neutral indicator light "N" goes out.
- Press the starter button.
 - » Starter does **not** operate.
- Extend the side stand.
- Pull the clutch lever.
- Press the starter button.
 - » Starter does **not** operate.
- Retract the side stand.
- Press the starter button without releasing the clutch lever.
 - » Starter operates.

Result

Not all test steps completed successfully.

Measure

- Check the appropriate parts with the BMW Motorrad diagnostic system.◇



Service Information Bulletin

Audio, Navigation, Information Systems

September 24, 2021

65 04 21

RETROFITTING AUDIO SYSTEM



MODEL

Model	Model Description	Production Date
K52 11	R 1250 RT	Starting March 1, 2021. With optional equipment 269A.

SITUATION

R 1250 RT Motorcycles built on or after March 1, 2021 and equipped with option: "269A - Preparation Audio System" can be retrofitted with the audio module.

PROCEDURE

Retrofit Instructions:

Follow attached instructions to install the audio module.

Using ISTA Version 4.28.3X or higher, run the retrofit procedure.

PARTS INFORMATION

Obtain and confirm the part numbers for your specific vehicle by entering the chassis number in ETK which takes into account specific equipment and/or options.

Additional parts like gaskets, hardware and chemicals may be required for the complete repair.

Part Number

65 12 7 105 111	Audio Control Unit
65 12 1 540 373	Left ACU Bracket
65 12 1 540 372	Right ACU Bracket
07 12 9 904 381	Hex Nut (Qty:4)
07 12 9 904 997	Hex Nut (Qty:4)
52 53 7 696 126	Rubber Mounting (Qty:4)

As of October 1, 2021, prices for these parts have been adjusted to be similar in cost to the original factory Audio System option.

WARRANTY INFORMATION

This audio system could not be ordered from the factory and was not included in the cost of the motorcycle.

- The customer is responsible for the cost of all required parts.
- BMW will cover the cost of labor.

Defect code

65 12 90 00 00	Retrofitting audio system
----------------	---------------------------

Labor Operation

77 52 000	Installing audio system (vehicle with preparation kit)	6 FRU
+77 52 500	Installing audio system (vehicle with preparation kit)	5 FRU

FRUs includes all repair procedures to complete the task with allowance for necessary ancillary tasks (e.g., visual inspection, lubrication, cleaning parts etc.) and administrative tasks.

Labor operation code 77 52 000 is a Main labor operation. If you are using a Main labor code for another repair, use the Plus code labor operation instead.

QUESTIONS REGARDING THIS BULLETIN

Technical inquiries	Contact the BMW Technical Support Group via TSARA
Warranty inquiries	Submit an IDS ticket to the Warranty Department
Parts inquiries	Submit an IDS ticket to the Motorrad Parts Department