

Classification:

FA21-010

Reference:

ITB21-023

Date:

October 25, 2021

TRANSFER ASSEMBLY SEAL REPLACEMENT FOR AWD FRONT DRIVE SHAFT REMOVAL

APPLIED VEHICLES: 2019-2021 QX50 (J55)
2014-2020 QX60 (L50)
2014 QX60 Hybrid (L50H)

APPLIED DRIVELINE: AWD only

SERVICE INFORMATION

When removing the front passenger (RH) side drive shaft on an applied vehicle for any reason, transfer assembly drive shaft oil seal and dust cover seal replacement is required. Refer to the **SERVICE PROCEDURE** in this bulletin.

Infiniti Bulletins are intended for use by qualified technicians, not 'do-it-yourselfers'. Qualified technicians are properly trained individuals who have the equipment, tools, safety instruction, and know-how to do a job properly and safely. **NOTE:** If you believe that a described condition may apply to a particular vehicle, DO NOT assume that it does. See your Infiniti retailer to determine if this applies to your vehicle.

SERVICE PROCEDURE

NOTICE

To avoid damage to the transfer assembly, use care when removing the dust cover seal and the drive shaft oil seal.

1. Using a suitable tool, remove the dust cover seal (not shown).
 - Do not reuse the dust cover seal.
2. Using a suitable tool, remove the drive shaft oil seal (Figure 1).
 - Do not reuse the drive shaft oil seal.

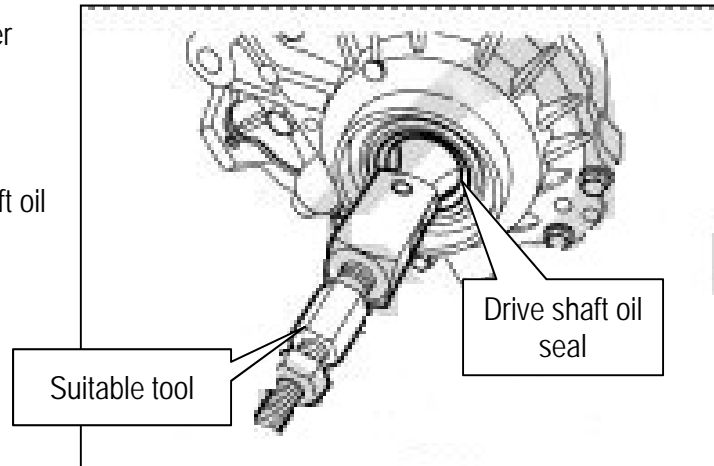

Figure 1

NOTICE

To avoid damage to the new dust cover seal and the new drive shaft oil seal, lubricate the seal lips before installation.

3. Install the new drive shaft oil seal.
 - a. Install the new drive shaft oil seal onto Seal Installer J-52390 (Figure 2).

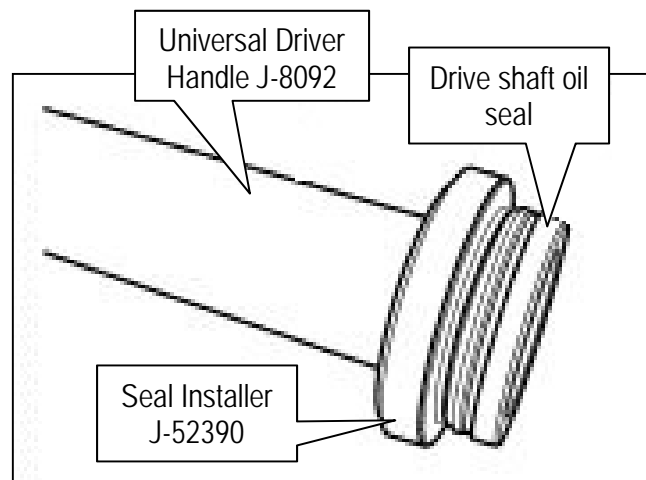

Figure 2

- b. With the help of an assistant, install the new drive shaft oil seal into the transfer assembly to the specified depth of 2.0-2.6 mm (0.079-0.102 in.) using Universal Driver Handle J-8092 and Seal Installer J-52390 (Figure 3).

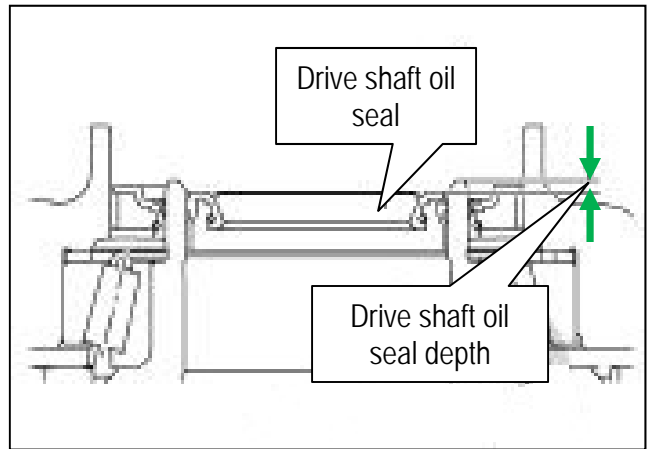

Figure 3

4. Install the new dust cover seal.

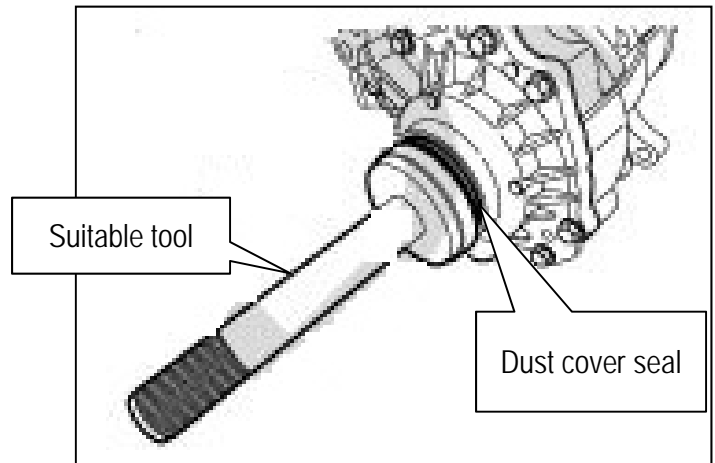

Figure 4

- a. With the help of an assistant, install the new dust cover seal to the specified depth of 0.0-0.6 mm (0.000-0.024 in.) using a suitable tool (Figure 4 and Figure 5).

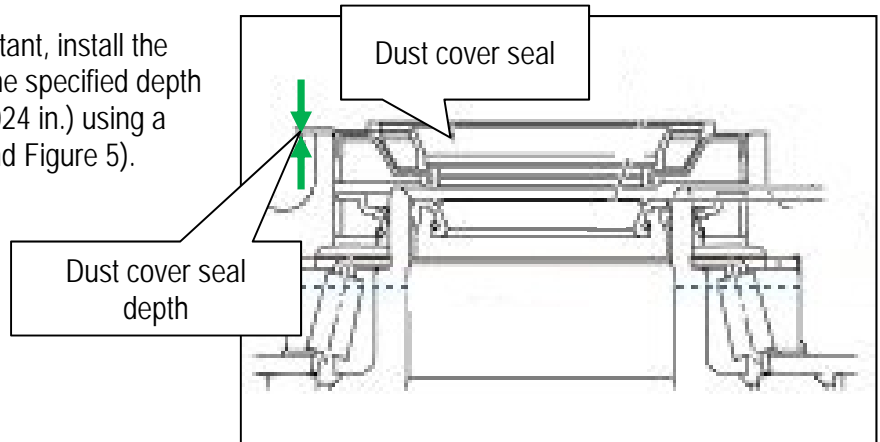

Figure 5

PARTS INFORMATION

DESCRIPTION	MODEL	PART NUMBER	QUANTITY
NUT-HEX (Axle Nut)	QX50	40262-4GA0C	1
	QX60, QX60 Hybrid	40262-2Y00A	1
SEAL-OIL, DRIVE PINION (Axle Seal)	QX50, QX60, QX60 Hybrid	33114-4BA0A	1
PIN-COTTER (Cotter Pin)	QX60, QX60 Hybrid	40073-0L700	1
SEAL-OIL (Dust Cover Seal)	QX50, QX60, QX60 Hybrid	33142-4BA0B	1
GASKET-FILLER PLUG (Gasket)	QX50, QX60, QX60 Hybrid	11026-1CA0A	1
Genuine Nissan Super Hypoid GL-5 80W-90 (Transfer Oil)	QX50, QX60, QX60 Hybrid	999MP-1XGPP0P (1)	as needed

(1) Order this item through the Infiniti Maintenance Advantage program: Phone: 877-INF-IMA1 (877-463-4621). Website order via link on dealer portal www.NNAnet.com and click on the "Maintenance Advantage" link.

CLAIMS INFORMATION

Reference the current Infiniti Warranty Flat Rate Manual and use the indicated Flat Rate Time (FRT) for the repair performed.

AMENDMENT HISTORY

PUBLISHED DATE	REFERENCE	DESCRIPTION
October 25, 2021	ITB21-023	Original bulletin published