



GROUP	MODEL
BOD	2015-2018MY Sedona (YP)
NUMBER	DATE
304	March 2022

## TECHNICAL SERVICE BULLETIN

SUBJECT:

### 3<sup>RD</sup> ROW CENTER SEAT BELT RETRACTOR WEBBING GUIDE REPLACEMENT

This bulletin provides information regarding the replacement of the 3rd row center seat belt retractor webbing guide associated with the 'Warranty Extension Program' (WTY024) on 2015-2018MY Sedona (YP) vehicles produced from July 21, 2014 through December 6, 2017. The 3rd row center seat belt in the affected vehicles may not fully retract into the headliner when being stowed, resulting in the seat belt dangling from the roof. When the 3rd row seat belt exhibits this condition, follow the procedure outlined in this publication to replace the 3rd row center seat belt webbing guide.



New 3<sup>rd</sup> Row Center Seat Belt Webbing Guide

**Replacement Procedure:**

- 1. Remove the cover (A) of the 3<sup>rd</sup> row center seat belt webbing guide by pulling it down with your hand as shown.



- 2. Insert a flat head screwdriver (or similar tool) into the ends of the webbing guide (B) as shown to release it. Then pull the webbing guide down.

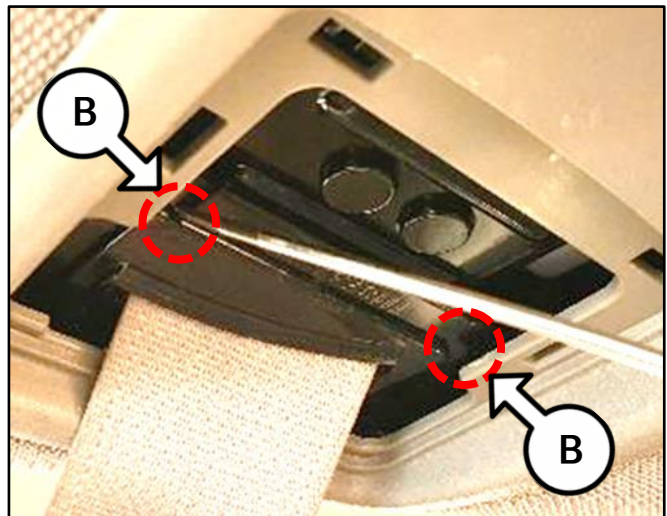

- 3a. Cut the webbing guide (C) as shown, then remove the guide from the belt.

**CAUTION**  
Be careful to NOT cut or damage the seat belt.

- 3b. Discard the old webbing guide.



**SUBJECT: 3<sup>RD</sup> ROW CENTER SEAT BELT RETRACTOR WEBBING GUIDE REPLACEMENT**

4. Insert the seat belt into the slit part (D) of the new webbing guide.

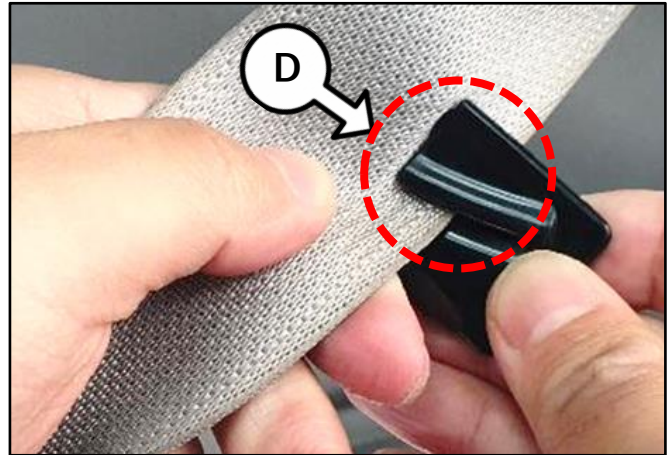
**! CAUTION**

Always install the new guide in the correct position, with the inside facing up, when reassembling it to the vehicle.

Outside (facing down when installed)



Inside (facing up when installed)



5. Reassemble all removed parts in reverse order of disassembly.
6. Verify proper seat belt function, including retraction and extension, making sure the seat belt moves smoothly in and out of the webbing guide.

**SUBJECT: 3<sup>RD</sup> ROW CENTER SEAT BELT RETRACTOR WEBBING GUIDE REPLACEMENT****AFFECTED VEHICLE RANGE:**

Model	Production Date Range
Sedona (YP)	July 21, 2014 to December 6, 2017

**REQUIRED PART:**

Part Name	Part Number	Figure	Qty.
3 <sup>rd</sup> Row Center Seat Belt Webbing Guide	89899 A9000FFF		1

**WARRANTY INFORMATION:****N Code: I92 C Code: ZZ4**

Claim Type	Causal P/N	Qty.	Repair Description	Labor Op Code	Op Time	Replacement P/N	Qty.
W	89899 A9000	0	Webbing Guide Replacement	212175RO	0.3 M/H	89899 A9000FFF	1