

Technical Service Bulletin

Mazda North American Operations
Irvine, CA 92618-2922



Subject: FRONT DOOR INTERFERES REAR DOOR GARNISH	Bulletin No.: 09-014/22
	Last Issued : 04/12/2022

BULLETIN NOTES

This bulletin supersedes the previously issued bulletin(s) listed below: The changes are noted in Red.

Previous TSBs	Date(s) Issued
09-007/21	04/15/21 and 02/25/21

APPLICABLE MODEL(S)/VINS

2019-2020 Mazda3 5-door HB (Japan built) with VINS lower than JM1BP*****158118 (produced before November 29, 2019)

DESCRIPTION

Some vehicles may exhibit that the glass run channel of the front door interferes with the rear door garnish.

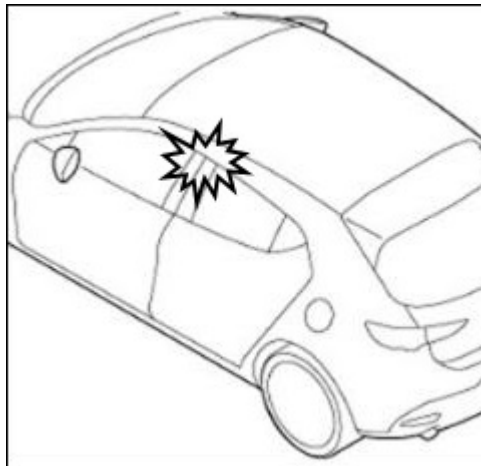

Since the front door glass run channel is not fixed to the door strongly enough for the following situations, cycles of door operation may result in interference and lead to damage on the seal rubber at the rear door.



- When the front door glass is closed, the glass run channel may be forced to move to the B pillar side.
- In very hot climates, the glass run channel may expand to the B pillar side.

To eliminate this concern, the following 2 phases have been started as a running change:

Page 1 of 7

CONSUMER NOTICE: The information and instructions in this bulletin are intended for use by skilled technicians. Mazda technicians utilize the proper tools/ equipment and take training to correctly and safely maintain Mazda vehicles. These instructions should not be performed by "do-it-yourselfers." Customers should not assume this bulletin applies to their vehicle or that their vehicle will develop the described concern. To determine if the information applies, customers should contact their nearest authorized Mazda dealership. Mazda North American Operations reserves the right to alter the specifications and contents of this bulletin without obligation or advance notice. All rights reserved. No part of this bulletin may be reproduced in any form or by any means, electronic or mechanical--including photocopying and recording and the use of any kind of information storage and retrieval system ---without permission in writing.

- Phase 1
 - Adhesive has been added between the front door glass run channel and the door panel.
- Phase 2
 - The shape of the front door glass run channel has been changed so as not to make contact with the rear garnish.
 - The shape of the clip at the rear side of the front door glass run channel has been changed for stronger fixing and the hole at the door panel has been changed accordingly.

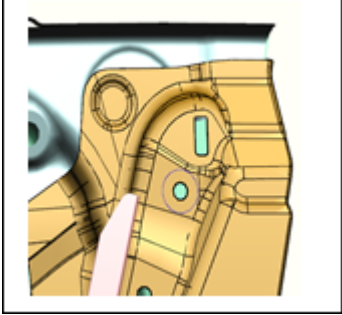
	Old	New
Clip		
Hole at the door panel		

Customers having this concern should have their vehicle repaired using the following repair procedure.

REPAIR PROCEDURE

1. Verify customer concern.
2. Replace the front door glass run channels with modified ones, regardless if the other side is damaged or not.

NOTE: Since the clip of the modified front door glass run channel is bigger than the hole at the door panel, cut the clip off and use a blind rivet instead.

- If the vehicle is NOT equipped with accessory side window deflectors, select Job Type A or B depending on the damage on the seal rubber at the rear door.
- If the vehicle is equipped with accessory side window deflectors, select Job Type C.

CONSUMER NOTICE: The information and instructions in this bulletin are intended for use by skilled technicians. Mazda technicians utilize the proper tools/ equipment and take training to correctly and safely maintain Mazda vehicles. These instructions should not be performed by "do-it-yourselfers." Customers should not assume this bulletin applies to their vehicle or that their vehicle will develop the described concern. To determine if the information applies, customers should contact their nearest authorized Mazda dealership. Mazda North American Operations reserves the right to alter the specifications and contents of this bulletin without obligation or advance notice. All rights reserved. No part of this bulletin may be reproduced in any form or by any means, electronic or mechanical--including photocopying and recording and the use of any kind of information storage and retrieval system ---without permission in writing.

Job Type	A	B	C
Vehicle status	Damage on one side of rear door	Damage on both sides of rear door	Equipped with side window deflectors
Front door glass run channel	X	X	X
Rear door glass run channel	X (damaged side)	X	X
Front door garnish	X	X	X
Rear door garnish	X (damaged side)	X	X
Clip for sail garnish	X	X	X
Clip for rear belt line mold	X	X	X
Service hole cover No.1	X	X	X
Grommet	X	X	X
Side window deflectors	-	-	X

X: Replace parts with new ones.

NOTE: If the rear door garnish needs to be replaced, the rear door glass run channel should be also be replaced due to the design change causing a gap between them.

a. Remove the front door glass run-channel according to the instructions on MGSS (FRONT DOOR GLASS RUN-CHANNEL REMOVAL/INSTALLATION).

NOTE: The beltline molding does not need to be removed/replaced for this repair even though the procedure on MGSS instructs to do so.

b. Remove the clip plate from a modified front door glass run-channel.



c. Cut the clip off which does not fit with the hole at the door panel.



CONSUMER NOTICE: The information and instructions in this bulletin are intended for use by skilled technicians. Mazda technicians utilize the proper tools/ equipment and take training to correctly and safely maintain Mazda vehicles. These instructions should not be performed by "do-it-yourselfers." Customers should not assume this bulletin applies to their vehicle or that their vehicle will develop the described concern. To determine if the information applies, customers should contact their nearest authorized Mazda dealership. Mazda North American Operations reserves the right to alter the specifications and contents of this bulletin without obligation or advance notice. All rights reserved. No part of this bulletin may be reproduced in any form or by any means, electronic or mechanical--including photocopying and recording and the use of any kind of information storage and retrieval system ---without permission in writing.

- d. Reassemble the clip plate and install the modified front door glass run-channel to the door panel aligning the holes to be riveted.
e. Install the rivet.

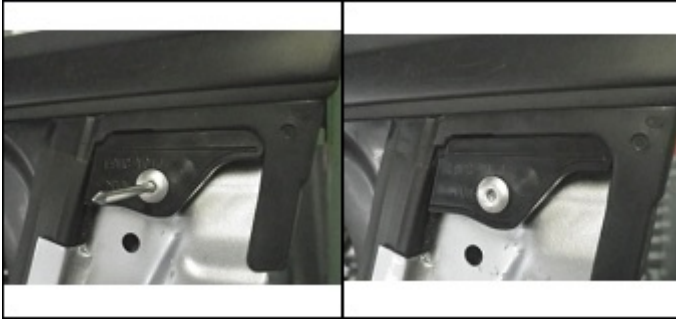

- f. Select the unwoven fabric sheet (0.25mm x 100mm x 150mm) from the "Noise Repair Kit" (TA01-76-100) and cut the sheet into a piece of 15mm x 15mm square.

NOTE: If a "Noise Repair Kit" is not available, obtain an appropriate fabric sheet locally.

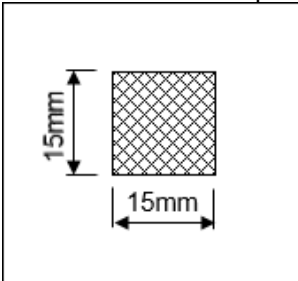

- g. Apply the piece of unwoven fabric seat on the rivet head to avoid a noise that may occur between the rivet and the garnish.



CONSUMER NOTICE: The information and instructions in this bulletin are intended for use by skilled technicians. Mazda technicians utilize the proper tools/ equipment and take training to correctly and safely maintain Mazda vehicles. These instructions should not be performed by "do-it-yourselfers." Customers should not assume this bulletin applies to their vehicle or that their vehicle will develop the described concern. To determine if the information applies, customers should contact their nearest authorized Mazda dealership. Mazda North American Operations reserves the right to alter the specifications and contents of this bulletin without obligation or advance notice. All rights reserved. No part of this bulletin may be reproduced in any form or by any means, electronic or mechanical---including photocopying and recording and the use of any kind of information storage and retrieval system ---without permission in writing.

h. Install the removed parts in the reverse order of removal.

ATTENTION: There are two types of front door glass run channel.

- If the front door glass run channel obtained is BDMT-58/59-60ZJ or later level, remove and discard the sail garnish (1), which is originally installed on the vehicle according to the instructions on MGSS (SAIL GARNISH REMOVAL/INSTALLATION), before installing the front door glass run channel.

BDMT-58/59-60ZH



BDMT-58/59-60ZJ or later

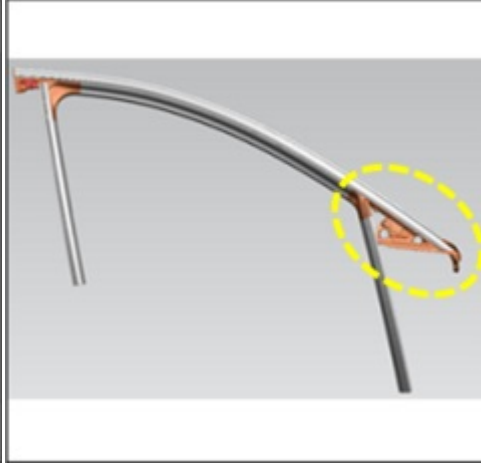

Discard
(1) Sail garnish
(BCJH-58-621)

Front door glass run channel and sail garnish are integrally formed

i. Perform the power window system initialization procedure (with auto open/auto close function) according to the instructions on MGS (POWER WINDOW SYSTEM INITIALIZATION PROCEDURE).

3. Verify repair.

CONSUMER NOTICE: The information and instructions in this bulletin are intended for use by skilled technicians. Mazda technicians utilize the proper tools/ equipment and take training to correctly and safely maintain Mazda vehicles. These instructions should not be performed by "do-it-yourselfers." Customers should not assume this bulletin applies to their vehicle or that their vehicle will develop the described concern. To determine if the information applies, customers should contact their nearest authorized Mazda dealership. Mazda North American Operations reserves the right to alter the specifications and contents of this bulletin without obligation or advance notice. All rights reserved. No part of this bulletin may be reproduced in any form or by any means, electronic or mechanical---including photocopying and recording and the use of any kind of information storage and retrieval system ---without permission in writing.

PARTS INFORMATION

Parts Number	Description	Qty.	Notes
BDMT-58-60ZH	Channel (R), Glass	1	For front door
BDMT-59-60ZH	Channel (L), Glass	1	For front door
BCKC-50-M10C	Garnish (R), Front Door	1	[R] Black
BEMD-50-M10C	Garnish (R), Front Door	1	[R] Piano black
BCKC-50-M20C	Garnish (L), Front Door	1	[R] Black
BEMD-50-M20C	Garnish (L), Front Door	1	[R] Piano black
GHP9-50-M38	Clip, Garnish	3	[R] For sail garnish
BCJH-58-975B	Grommet, Screw	4	[R] For hole cover No.1
BCJH-58-972F	Cover (R)	1	[R]
BCJH-59-972F	Cover (L)	1	[R]
BDMT-72-60ZG	Run Channel (R), Glass	1	For rear door
BDMT-73-60ZG	Run Channel (L), Glass	1	For rear door
BCKC-50-M30D	Garnish (R), Rear Door	1	[R] Black
BEMD-50-M30E	Garnish (R), Rear Door	1	[R] Piano Black
BCKC-50-M40D	Garnish (L), Rear Door	1	[R] Black
BEMD-50-M40E	Garnish (L), Rear Door	1	[R] Piano Black
BCKA-72-604	Clip	2	[R] For rear beltline molding
90257-4810	Rivet	2	
TA01-76-100	Noise Part Kit	1	One kit will repair 60 vehicles
BEMF-V3-700	Accessory side window deflectors	1	If already installed to the vehicle before repair

[R]: Replace parts

CONSUMER NOTICE: The information and instructions in this bulletin are intended for use by skilled technicians. Mazda technicians utilize the proper tools/ equipment and take training to correctly and safely maintain Mazda vehicles. These instructions should not be performed by "do-it-yourselfers." Customers should not assume this bulletin applies to their vehicle or that their vehicle will develop the described concern. To determine if the information applies, customers should contact their nearest authorized Mazda dealership. Mazda North American Operations reserves the right to alter the specifications and contents of this bulletin without obligation or advance notice. All rights reserved. No part of this bulletin may be reproduced in any form or by any means, electronic or mechanical--including photocopying and recording and the use of any kind of information storage and retrieval system ---without permission in writing.

Sample size of rivet (90257-4810)

d	L	H	D	P	W
4.8 mm	9.9 mm	1.8 mm	9.6 mm	27 mm	2.9 mm

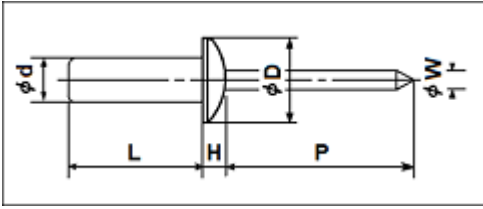

WARRANTY INFORMATION

NOTE:

- This warranty information applies only to verified customer complaints on vehicles eligible for warranty repair.
- This repair will be covered under Mazda's New Vehicle Limited Warranty term.
- Additional diagnostic time cannot be claimed for this repair.

Warranty Type	A
Symptom Code	90
Damage Code	9B
Part Number Main Cause	BDMT-58-60ZH or BDMT-59-60ZFH
Quantity	1
Operation Number / Labor Hours:	XXS7ZARX / 2.0 Hrs. (Job A: Front doors and one rear door) XXS7ZBRX / 2.6 Hrs. (Job B: All doors) XXS7ZCRX / 3.4 Hrs. (Job C: All doors with side deflectors)

NOTE: Claim the Noise Repair Kit as a Related Parts for the first time repair.

CONSUMER NOTICE: The information and instructions in this bulletin are intended for use by skilled technicians. Mazda technicians utilize the proper tools/ equipment and take training to correctly and safely maintain Mazda vehicles. These instructions should not be performed by "do-it-yourselfers." Customers should not assume this bulletin applies to their vehicle or that their vehicle will develop the described concern. To determine if the information applies, customers should contact their nearest authorized Mazda dealership. Mazda North American Operations reserves the right to alter the specifications and contents of this bulletin without obligation or advance notice. All rights reserved. No part of this bulletin may be reproduced in any form or by any means, electronic or mechanical---including photocopying and recording and the use of any kind of information storage and retrieval system ---without permission in writing.