

**Oil Leak Around the Oil-Filter Housing: Observe Work Procedure (173/22)**

Model Line: **Cayenne (9YA) / Cayenne Coupé (9YB)**  
**Macan (95B)**  
**Panamera (971)**

Model Year: **As of 2017 up to 2021**

Equipment: **V6 or V8 fuel engine**

Concerns: **Oil leaks around the oil-filter housing – improved seal for the oil-filter housing available**

Cause: **We have discovered that the leak point is not clearly identified in some cases when the complaint “Oil leak at the oil-filter housing” is received. As a result, the oil-filter housing ⇒ *Oil-filter housing (shown as an example) -1-* is often replaced unnecessarily although, in most cases, it is sufficient to replace the seal ⇒ *Oil-filter housing (shown as an example) -5-*.**

Action required: In the event of a complaint, clean the oil-filter housing or the affected area thoroughly and first spray leak-locating spray or powder on it. For this purpose, it may be necessary to remove and then re-install individual peripheral components in order to gain better access.

Then perform a test drive and find the leak.

If a leak is found in the oil-filter housing area, replace the seal with the improved type and check the oil-filter housing for damage.

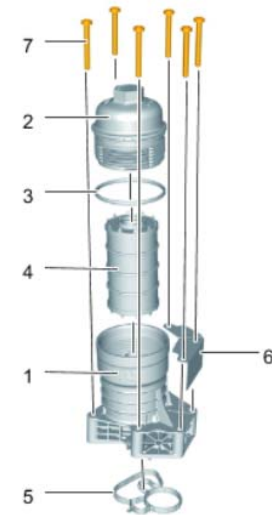

*Oil-filter housing (shown as an example)*

- 1** – Oil filter housing
- 2** – Oil filter cover
- 3** – O-ring
- 4** – Oil filter
- 5** – **Seal**
- 6** – Heat shield
- 7** – Screws

Date of Introduction: The improved seal has been available since April 22, 2021.

Parts Info:	Part No.	Designation – Point of use	Quantity
	PAB115441	⇒ Seal – Oil filter housing	1 pc(s)

Determine any other parts required for the respective vehicle based on the vehicle identification number in the Porsche Spare Parts Catalogue (PET2).

Work Procedure:



### Information

- Oil leaks must be clearly identifiable and reproducible.
- Engine oil and coolant must have reached operating temperature during a test drive.

- 1 Create photo documentation of the complaint for PCSS and attach it to the job.
- 2 Clean the affected area around the oil-filter housing thoroughly.
- 3 Cover a large area around the suspected leakage points with a leak-locating spray or powder ("spot check").
- 4 Perform a test drive.
- 5 Check the area around the oil-filter housing for leaks and find the leak.
- 6 Create photo documentation of the leakage point found using leak-locating spray and attach it to the PCSS process.
- 7 Replace the oil-filter housing seal if necessary and check the oil-filter housing for signs of damage.  
 For work procedure, see:  
 ⇒ *Workshop Manual '172919 Removing and installing oil filter housing (V8 Biturbo)'*  
**or**  
 ⇒ *Workshop Manual '172919 Removing and installing oil filter housing (V6 Biturbo)'*  
 If the oil-filter housing is damaged, also replace it and attach a corresponding photo documentation to the job that clearly shows the damaged oil-filter housing.

End of remedial action.

**Invoicing**



**Information**

If this repair was carried out as part of an oil service, the oil filter must not be invoiced using the warranty claim.

For documentation and invoicing **in the event of a warranty**, state the work items required depending on the vehicle at hand, from the scope of work required and the specified PCSS encryption in the warranty claim:

APOS	Labor operation	I No.
17291980	Removing and installing oil filter housing	

PCSS encryption:

Location (FES5)	17290	Oil-filter housing
Damage type (SA4)	5041	Oil/grease leak

References: ⇒ *Workshop Manual '172919 Removing and installing oil filter housing (V8 Biturbo)'*  
 ⇒ *Workshop Manual '172919 Removing and installing oil filter housing (V6 Biturbo)'*

**Important Notice:** Technical Bulletins issued by Porsche Cars North America, Inc. are intended only for use by professional automotive technicians who have attended Porsche service training courses. They are written to inform those technicians of conditions that may occur on some Porsche vehicles, or to provide information that could assist in the proper servicing of a vehicle. Porsche special tools may be necessary in order to perform certain operations identified in these bulletins. Use of tools and procedures other than those Porsche recommends in these bulletins may be detrimental to the safe operation of your vehicle, and may endanger the people working on it. Properly trained Porsche technicians have the equipment, tools, safety instructions, and know-how to do the job properly and safely. Part numbers listed in these bulletins are for reference only. The work procedures updated electronically in the Porsche PIWIS diagnostic and testing device take precedence and, in the event of a discrepancy, the work procedures in the PIWIS Tester are the ones that must be followed.

© 2022 Porsche Cars North America, Inc.