

1. Lock button
2. One finger

Figure 2. Correct Procedure

Improperly Installed Button

NOTE

Improperly installed lock button with tabs misaligned, tabs not properly engaged or upper clutch cable interfering with the lock button, is a sign of incorrect internal adjustment. See the service manual for clutch adjustment.

1. See Figure 3. Lock button tabs are not fully engaged (1) because the end of the upper clutch cable (2) is interfering with securing the button.
2. See Figure 4. The tabs on lock button are not fully secured.
 - a. Lock button tabs partially engaged (1).
 - b. Lock button tab not fully engaged (2).
3. See Figure 5. A misaligned lock button (1, 3) is a sign of an incorrect installation.

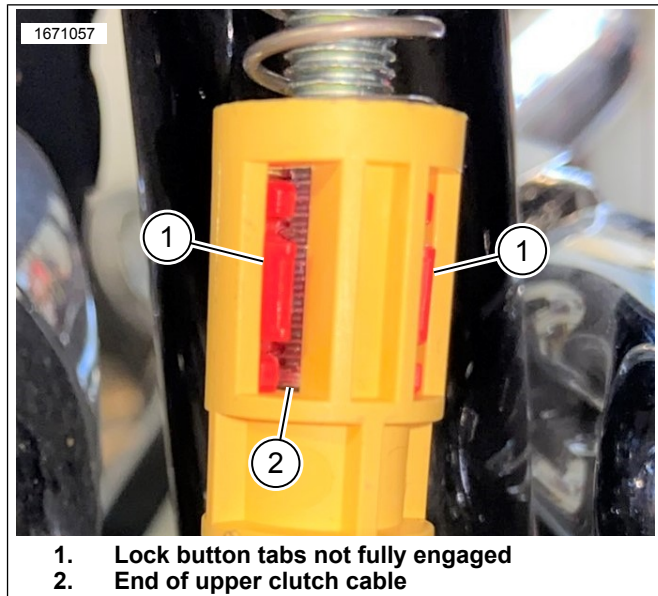

1. Lock button tabs not fully engaged
2. End of upper clutch cable

Figure 3. Improperly Installed Button

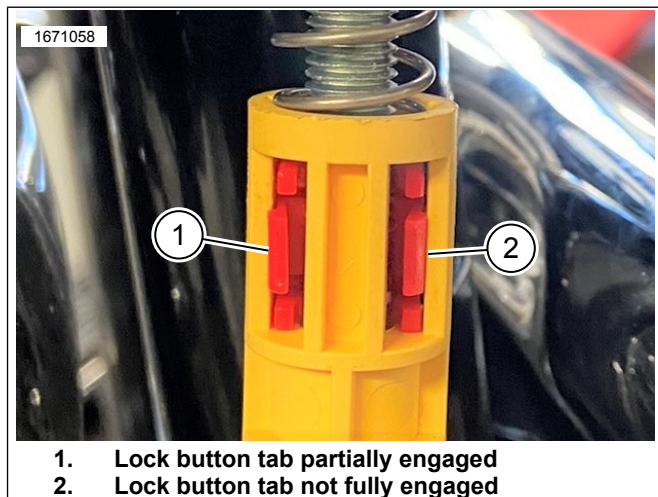

1. Lock button tab partially engaged
2. Lock button tab not fully engaged

Figure 4. Improperly Installed Button

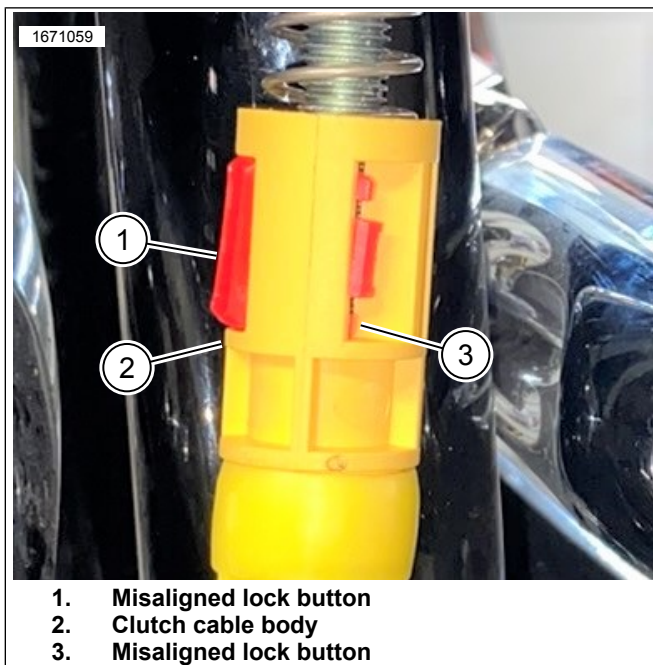

1. Misaligned lock button
2. Clutch cable body
3. Misaligned lock button

Figure 5. Improperly Installed Button

Proper Button Engagement

1. See Figure 6. Lock button tabs are fully engaged (2) to clutch cable body (1).
2. See Figure 7. A properly aligned lock button (1) should be semi-flush with the rest of the cable clutch assembly.
3. The lock button tabs should be fully engaged (2) to the body.
4. See Figure 8. Make sure the lock button (4) is installed between the ends of upper clutch cable (1, 3).

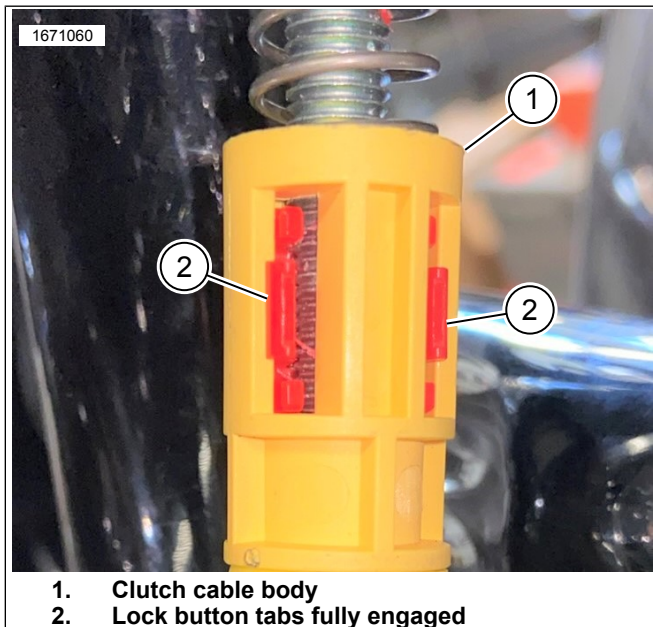

1. Clutch cable body
2. Lock button tabs fully engaged

Figure 6. Correctly Installed Button

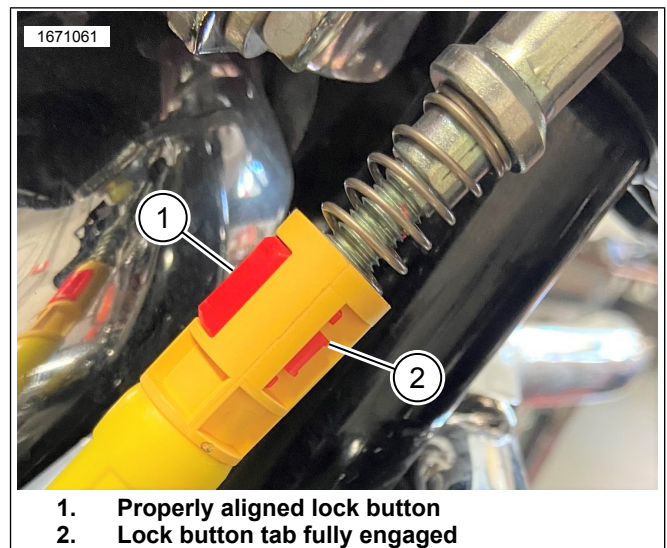

1. Properly aligned lock button
2. Lock button tab fully engaged

Figure 7. Correctly Installed Button

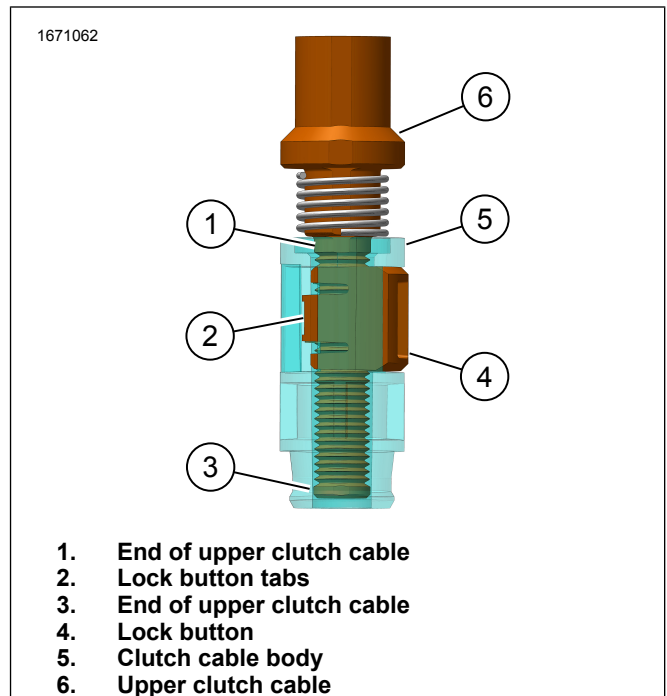

1. End of upper clutch cable
2. Lock button tabs
3. End of upper clutch cable
4. Lock button
5. Clutch cable body
6. Upper clutch cable

Figure 8. Proper Button Engagement