



## Condition

| Applicable Vehicles |           |           |             |                |              |
|---------------------|-----------|-----------|-------------|----------------|--------------|
| Model(s)            | Year      | Eng. Code | Trans. Code | VIN Range From | VIN Range To |
| ID.4                | 2021-2023 | All       | All         | All            | All          |

| Revision Table  |                |                |                       |
|-----------------|----------------|----------------|-----------------------|
| Instance Number | Published Date | Version Number | Reason For Update     |
| 2069638/1       | 3/2/2023       | 87-23-01TT     | Original publication. |

Evaporator Drain - Correct body installation location.

## Technical Background

Possibility of installing the evaporator drain tube in an incorrect location in the body.

## Service

There are two stamped holes in the passenger floor pan area. During replacement/reinstallation the evaporator drain tube can be installed incorrectly in the wrong unused stamped hole as seen in figure 1.

When replacing/reinstalling the evaporator drain use the stamped hole in the passenger floor pan to the right of the hole in the body tunnel as shown below.

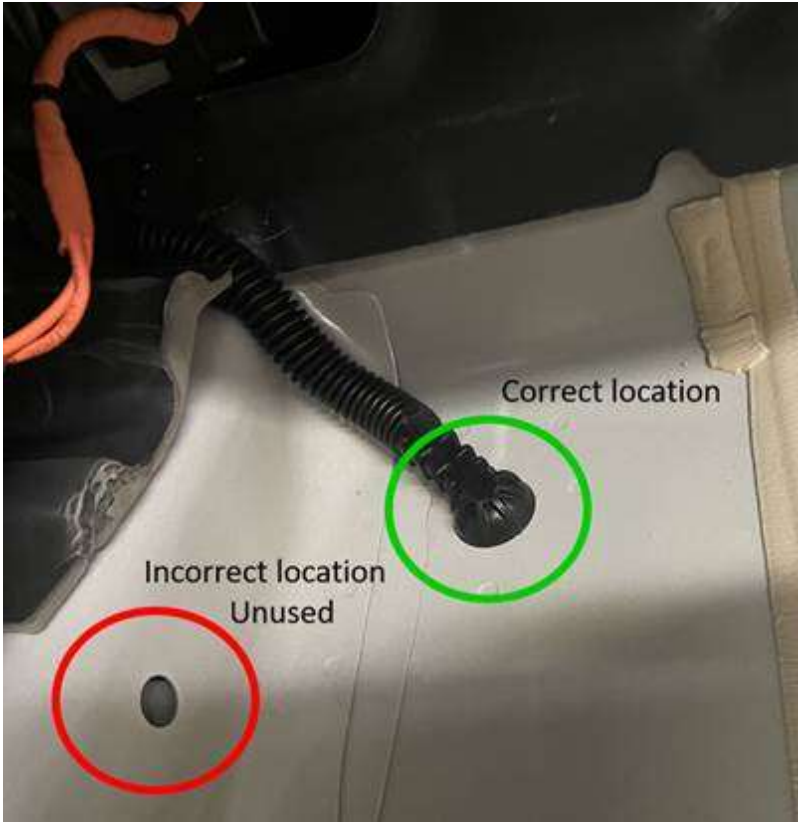

Figure 1.

### Additional Information

© 2023 Volkswagen Group of America, Inc. All rights reserved. Information contained in this document is based on the latest information available at the time of printing and is subject to the copyright and other intellectual property rights of Volkswagen Group of America, Inc., its affiliated companies and its licensors. All rights are reserved to make changes at any time without notice. No part of this document may be reproduced, stored in a retrieval system, or transmitted in any form or by any means, electronic, mechanical, photocopying, recording, or otherwise, nor may these materials be modified or reposted to other sites, without the prior expressed written permission of the publisher.