



## S-Series™

### 2.0 Front Shock Absorber and Upper Mount Update

**Date:** November 7, 2023  
**Bulletin Name:** FDM-TSIB-046  
**Model:** Oshkosh S-Series 2.0  
**Units Affected:** Serial No. 788727 - 827763

#### Purpose:

This bulletin provides instructions for installing new updated front shock absorbers and upper mounting brackets. The updated shock absorber and mounting bracket lowers the top of the shock absorber improving the allowable maximum travel of the front leaf spring pack and keeps the shock absorber in its normal travel zone reducing the time the shock absorber is in hydraulic rebound.

#### Notice:

- Read and understood bulletin in its entirety before performing this procedure.
- All procedures outlined in the bulletin must be performed by skilled service personnel. Refer to the product service manual for descriptions of maintenance procedures.

#### SAFETY NOTICE

Perform your company's Lockout/Tagout procedure. If your company does not have a Lockout/Tagout procedure, follow OSHA 1910.147 and 1910.146 Confined Space as appropriate.

#### SAFETY NOTICE

Use appropriate Personal Protective Equipment (PPE) as required by your company.

#### Tools and Equipment Required:

Customer to supply:

- Hand tools
- Torque wrench (foot pound)

#### Parts Required

Item	Part Number	Description	Qty.
1	A001E766	MOUNT, FR, SHOCK, UPPER	2
2	A001F220	ABSORBER, SHOCK, FR	2
3	A000A565*	SCR, FLG, HEX 0.62-11 X 1.75 G8 MB	4
4	A000A822*	SCR, CAP, HEX 0.75-10 X 5.00 G8 MB	2
5	A000A825*	SCR, CAP, HEX 0.75-10 X 6.50 G8 MB	2
6	A000A952*	WASH, FLT, 0.75 X 1.47 X 0.13 MB, HDN	4
7	A000D988	NUT, FLG, LKSP 0.62-11 G8 MB	4
8	A000A694	NUT, FLG, LKDT 0.75-10 G8 MB	4
9	A000F590*	WASH, FLT 0.75 X 1.38 X 0.50 MB	4

\* Hardware listed for reference. Replace hardware if worn or damaged.

## Procedure:

### Lockout/Tagout

1. Park vehicle on a flat level surface, block truck tires, and perform your company's Lockout/Tagout procedure. If your company does not have a Lockout/Tagout procedure, follow OSHA 1910.147 and 1910.146 Confined Space as appropriate.
2. The vehicle's BATTERY DISCONNECT switch is located on the left-hand side of the battery box. Use the battery disconnect switch when performing any maintenance so the vehicle cannot accidentally be started.
  - a. Turn the battery disconnect switch (Figure A, Item 1) counterclockwise so the hole on the switch aligns with the hole in the bracket (Figure A, Item 2).
  - b. Install the safety lockout device ring (Figure B, Item 1) through the holes on the battery disconnect switch and the bracket.
  - c. Install a padlock (Figure B, Item 2) onto the safety lockout device ring, lock it, and put the key in your pocket. If more than one person is working on the vehicle, each person must install his or her own padlock.

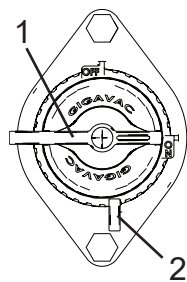

Figure A

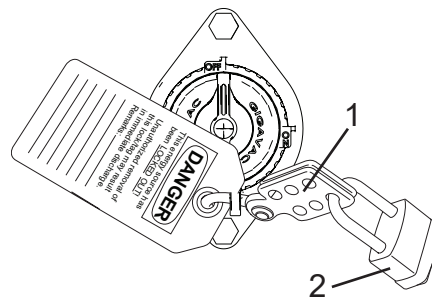

Figure B

### Shock Absorber and Upper Mount Installation

3. Loosen and remove lower mounting hardware from vehicle's left side front shock absorber. See Figure 1. The lock nut will not be reused.
4. Loosen and remove upper mounting hardware from vehicle's left side front shock absorber. See Figure 1. The lock nut will not be reused.

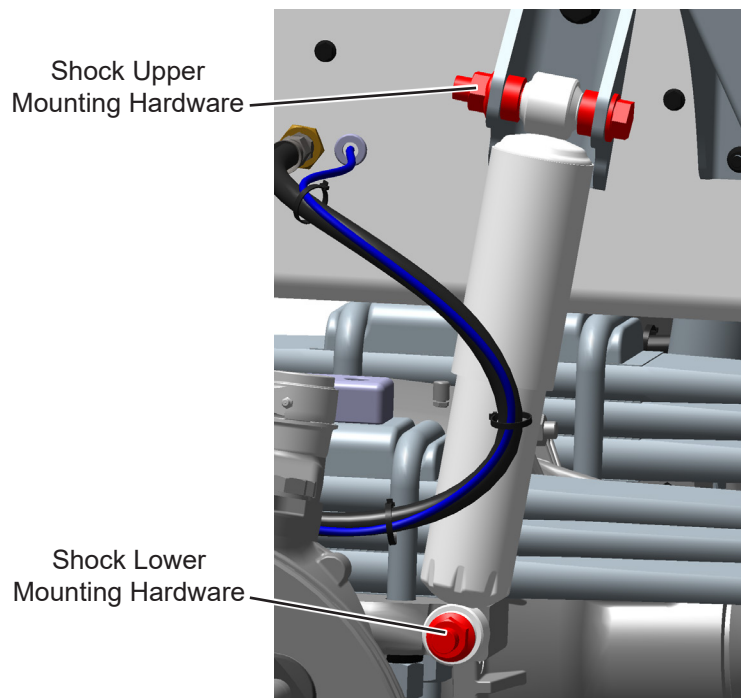

Figure 1 - Shock Absorber Removal

5. Remove shock absorber from vehicle. Shock absorber will not be reused.
6. Loosen and remove mounting hardware securing upper mounting bracket to frame rail. See Figure 2. The lock nuts will not be reused.
7. Remove upper mounting bracket from frame rail. Mounting bracket will not be reused.

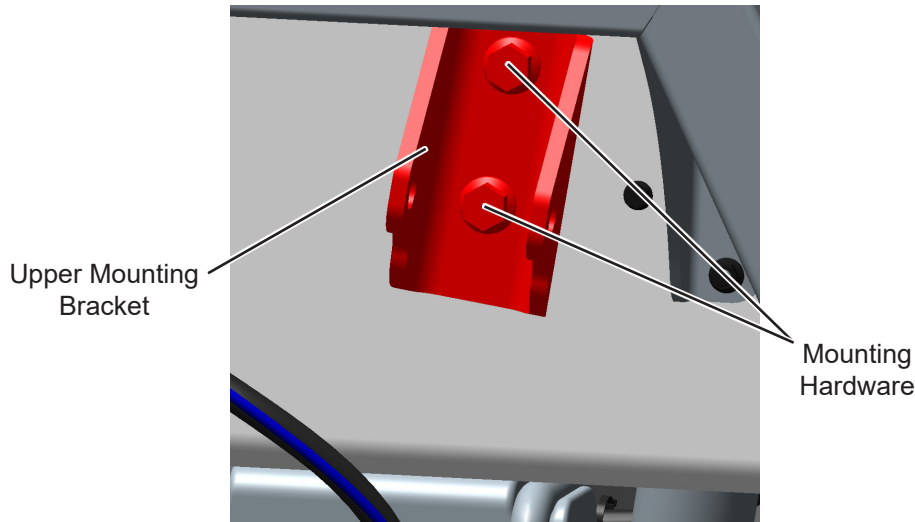

Figure 2 - Upper Mounting Bracket Removal

8. Inspect all mounting hardware. Replace any damaged or worn mounting hardware. Lock nuts must be replaced with new lock nuts.

**NOTE**

**The shock absorber upper mounting bracket does not need to be replaced when installing updated front shock absorber, but it is highly recommended. The new upper mounting bracket is longer, adjusting the allowable maximum travel of the shock absorber.**

9. Install new upper mounting bracket (A001E766) to frame rail using 0.62-11 X 1.75" flange screws (A000A565) and new lock nuts (A000D988). See Figure 3. Final tighten mounting hardware to 210 ft. lbs.

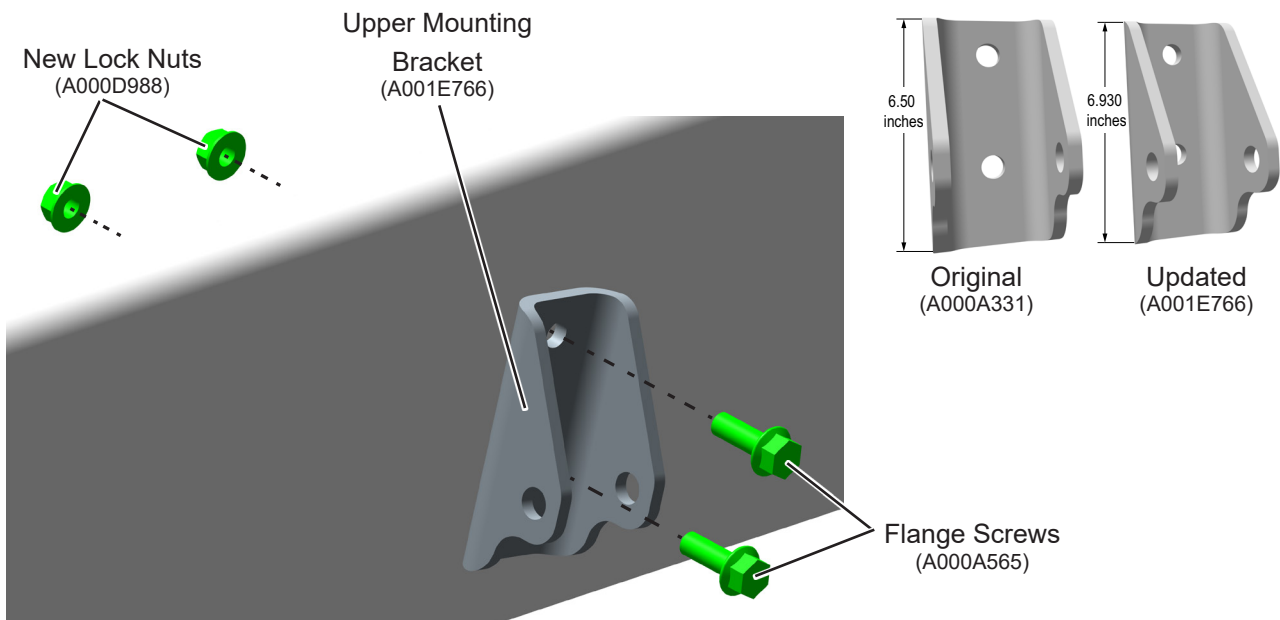

Figure 3 - Upper Mounting Bracket Installation

10. Install shock absorber (A001F220) lower eyelet to front axle using 0.75-10 X 6.50" cap screw (A000A825), flat washer (A000A952), and new lock nut (A000A694). Cap screw must be installed from inboard side. See Figure 4. Final tighten mounting hardware to 303 ft. lbs.

11. Install shock absorber (A001F220) upper eyelet into upper mounting bracket using 0.75-10 X 5.00" cap screw (A000A822), flat washer (A000A952), two spacer washers (A000F590), and new lock nut (A000A694). See Figure 4. Final tighten mounting hardware to 303 ft. lbs.

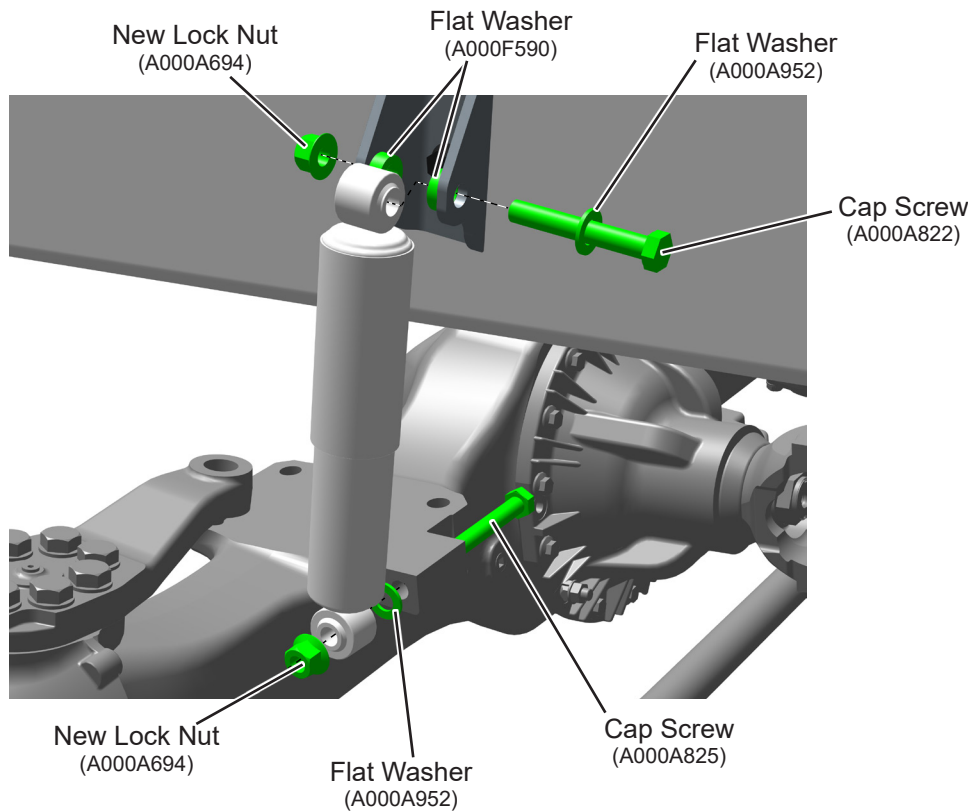

Figure 4 - Shock Absorber Installation

12. Repeat Step 3 - 11 for the vehicle's right side front shock absorber and mounting bracket.

13. Remove lockout/tag and wheel chocks.

### Continuous Improvement:

The change included in this document is part of the McNeilus Continuous Improvement Process.

*McNeilus's quality policy is providing customer satisfaction through innovative products, dedicated service, and a constant focus on continuous improvement.*



(888) 686-7278

[www.streetsmartparts.com](http://www.streetsmartparts.com)